

31F06SE0003 W9690.00086 GRIFFITH

BULLDOZER TRENCHING ON MINING CLAIM SO.1040864

Introduction:

Two Island Marble Corporation holds several claims over a white marble deposit in northwestern Griffith Township, Renfrew County. Bulldozer trenching of SO. 1040864 was done to test the projected extension of the white crystalline dolomite along strike and down dip to the northeast across the north facing slope of the main ridge containing the deposit. The geology of the north slope is obscured under galcial till in mixed forest. The worksite is 500 metres from the nearest exposure of marble which occurs in the quarry on leased claim EO 593720. Four trenches were made.

Qualifications of the Work Supervisor:

Gary H.K. Pearse holds a Bsc in Geological Engineering (Manitoba, 1961), and an Msc Geology (Manitoba, 1968). He has worked in mining, exploration and development for a variety of companies and in the last 12 years as a consultant. His experience spans over 35 years in Canada and abroad.

Assessment Work:

Four trenches were dug using a John Deere 550 G bulldozer with a 8.5 foot blade. The trenches were pushed across the projected strike of the marble bed in the northeastern part of the claim (Figure 1) . The operator was Mr. Ralph Selle of Hyndford, Ontario.

Trench No. 1, bearing 330 degrees is 24 metres long, 2.7 metres wide (Figures 1 and 2) . White dolomite marble is exposed throughout its length. Overburden is a brown silty till with sparse boulders and pebbles. It is 1 to 1.3 metres deep. The marble is coarsely crystalline and white. The outcrop is smoothly glaciated, ice direction 190 degrees. The attitude of the formation measured in the trench is a strike of 35 degrees and dip of 35 east. The strike is somewhat more easterly than is usual but this is likely due to local variation since the marble band does lie where predicted.

Trenches No. 2,3 and 4, bearing 315, 165 and 290 degrees respectively did not reach bedrock (Figures 1 and 2). The first was 1 metre deep, the other two reached 2 metres. Groundwater discharge in this general area created difficult conditions for the dozer which became mired in Trenches 2 and 3. As found in the area of the quarry, the weather resistant dolomite forms wide benches which dip into the mountain side forming wedge shaped basins for water. This condition gives rise to spring discharge at various localities along the lip of the bench. It is likely that these three trenches are located near the lip of such a bench or somewhat down dip of it. The broad terracing of the mountain slope in this vicinity also suggests the presence of a bench.

Work time and costs are shown in the attached forms.

The undersigned, Gary H.K. Pearse certifies that the work done is as described and that the costs shown in the attached forms accurately reflects incurred costs.

Two Island Marble Corporation

Herbert A. Metzger
(General Manager)

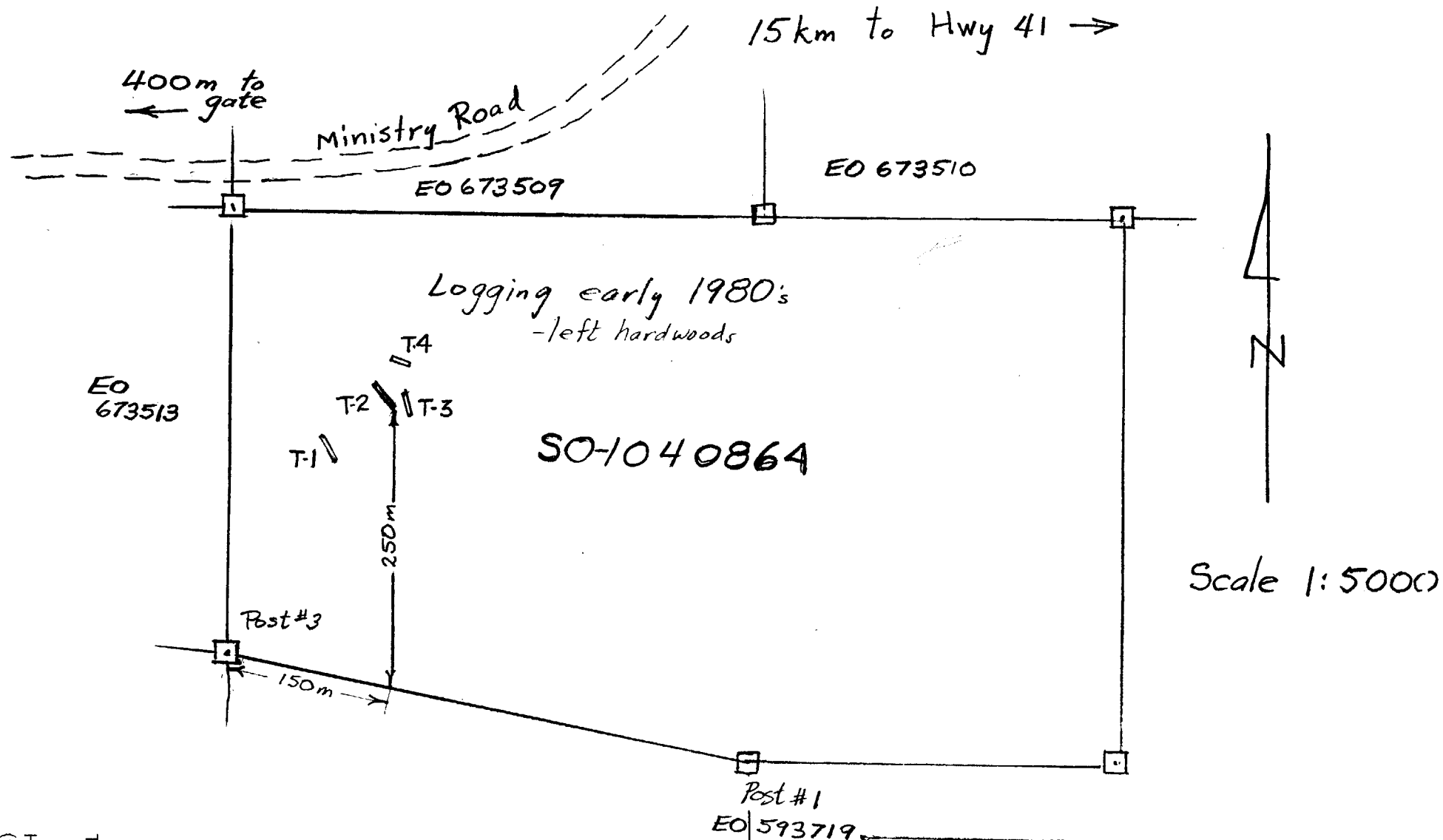

Two Island Marble Corporation
 Herbert A. Metzger
 (General Manager)

Bulldozer Trenching Fig 1 of 2
 John Deere 550 G 8.5' blade
 Operator: Ralph Selle
 Supervised by G.H.K. Pearce
 Work done - Nov 29/96
 Drawn by G.H.K. Pearce

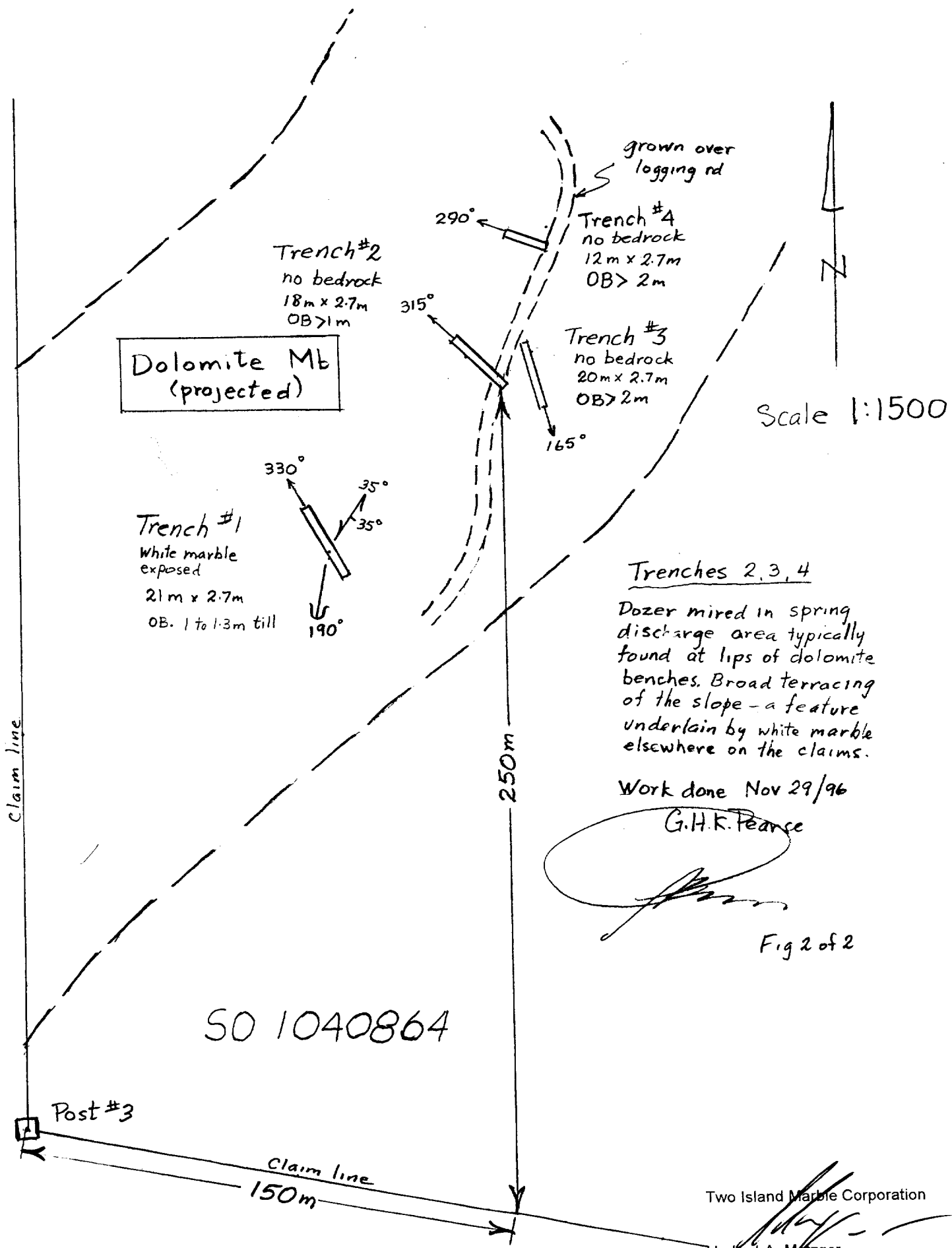
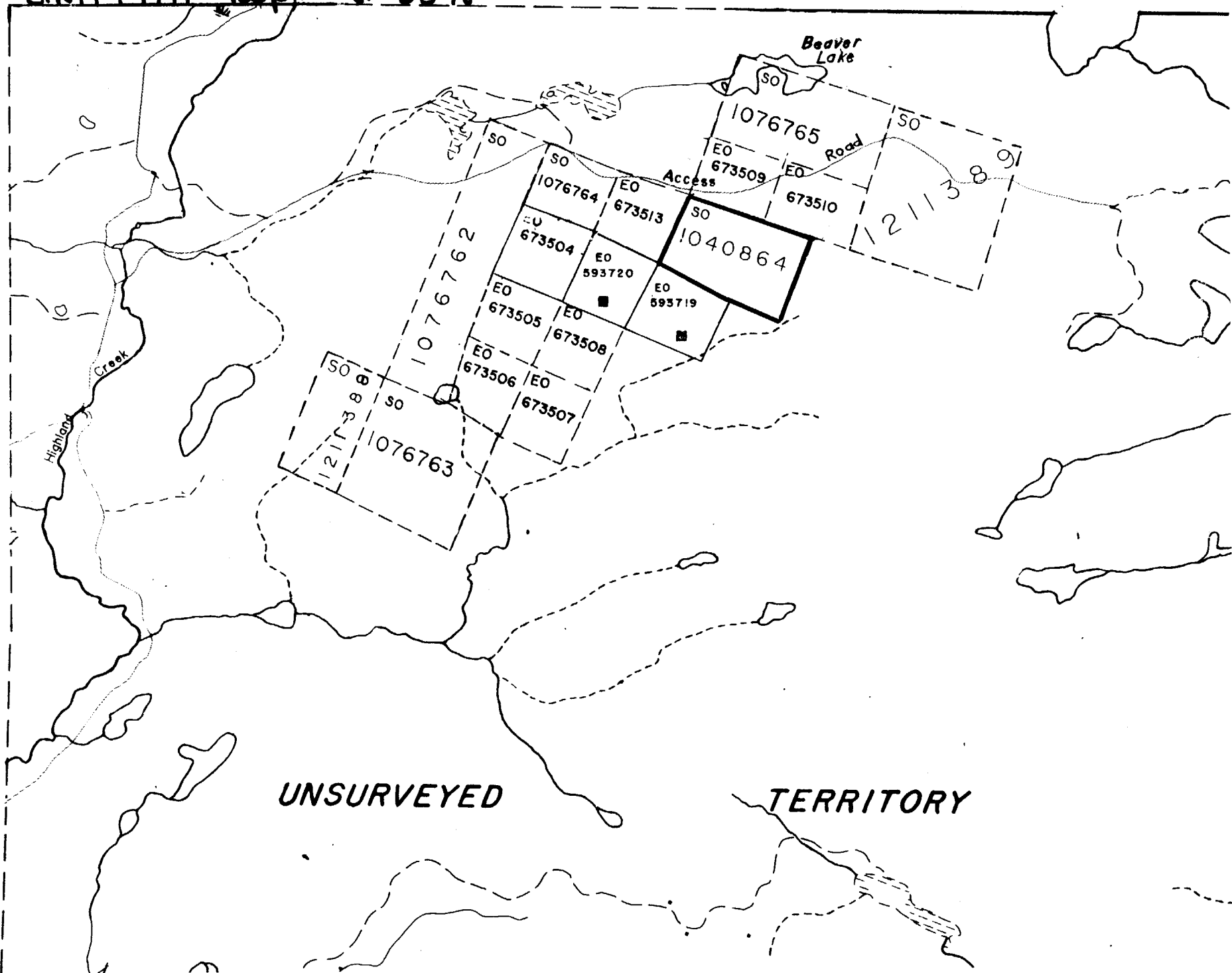

Fig 2 of 2

Two Island Marble Corporation

Herbert A. Metzger
(General Manager)

GRIFFITH Twp. G-3398



WNSHIP

Personal information collected on this form is obtained under the authority of the Mining Act, the information is a public record. This information will be used for the purposes of the Mining Act. Questions about this collection should be directed to the Chief Information Officer, 933 Ramsey Lake Road, Sudbury, Ontario, P3E 6B5.

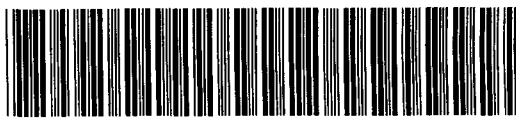

31F06SE0003 W9690.00086 GRIFFITH

900

Instructions: - For work performed on Crown Lands before recording a claim, use form U24U.
- Please type or print in ink.

1. Recorded holder(s) (Attach a list if necessary)

Name Two Island Marble Corporation	Client Number 203935
Address Residence of Glen Pearse, Dacre, Ontario K0J 1N0	Telephone Number (613) 649-2959
or P.O. Box 7032, Dacre, Ontario K0J 1N0	Fax Number (604) 594-3833
Name	Client Number
Address	Telephone Number
	Fax Number

2. Type of work performed: Check (✓) and report on only ONE of the following groups for this declaration.

Geotechnical: prospecting, surveys, assays and work under section 18 (regs)
 Physical: drilling, stripping, trenching and associated assays
 Rehabilitation

Work Type Bulldozer Trenching	Office Use
	Commodity
Dates Work Performed From 29 Day 11 Month 96 Year To 01 Day 12 Month 96 Year	Total \$ Value of Work Claimed \$1,341
Global Positioning System Data (if available)	NTS Reference
Township/Area Griffith Township	Mining Division S.O.
M or G-Plan Number G-3398	Resident Geologist District TWEED

Please remember to: - obtain a work permit from the Ministry of Natural Resources as required;
- provide proper notice to surface rights holders before starting work;
- complete and attach a Statement of Costs, form 0212;
- provide a map showing contiguous mining lands that are linked for assigning work;
- include two copies of your technical report.

3. Person or companies who prepared the technical report (Attach a list if necessary)

Name Gary H.K. Pearse	Telephone Number (613) 746-8209
Address Suite 22 - 80 Rideau Terrace, Ottawa, ON. K1M 2C6	Fax Number (613) 746-8209
Name	Telephone Number
Address	Fax Number
Name	Telephone Number
Address	Fax Number

4. Certification by Recorded Holder or Agent

I, Herbert A. Metzger (Print Name), do hereby certify that I have personal knowledge of the facts set forth in this Declaration of Assessment Work having caused the work to be performed or witnessed the same during or after its completion and, to the best of my knowledge, the annexed report is true.

Signature of Recorded Holder or Agent General Manager of Two Island Marble Corporation	Date December 10, 1996
Agent's Address Unit 11, 8456-129A Street, Surrey, B.C.V3W 1A2	Telephone Number (604) 594-8338
	Fax Number (604) 594-3833

5. Work to be recorded and distributed. Work can only be assigned to claims that are contiguous (adjoining) to the mining land where work was performed, at the time work was performed. A map showing the contiguous link must accompany this form.

Mining Claim Number. Or if work was done on other eligible mining land, show in this column the location number indicated on the claim map.	Number of Claim Units. For other mining land, list hectares.	Value of work performed on this claim or other mining land.	Value of work applied to this claim.	Value of work assigned to other mining claims.	Bank Value of work to be distributed at a future date.
eg TB 7827	18 ha	\$26,825	N/A	\$24,000	\$2,825
eg 1234567	12	0	\$24,000	0	0
eg 1234568	2	\$ 8,892	\$ 4,000	0	\$4,892
1 SO 1040864	2	\$ 1,841 \$ 1,460.20	\$ 1,841 \$ 1,460.20		
2					
3					
4					
5					
6					
7					
8					
9					
10					
11					
12					
13					
14					
15					
Column Totals		\$ 1,841 \$ 1,460.20	\$ 1,841 \$ 1,460.20		

I, Herbert A. Metzger (Print Full Name), do hereby certify that the above work credits are eligible under subsection 7 (1) of the Assessment Work Regulation 6/96 for assignment to contiguous claims or for application to the claim where the work was done.

Signature of Member or Agent Authorized in Writing: General Manager of Two Island Marble Corporation Date: December 10, 1996

6. Instructions for cutting back credits that are not approved.

Some of the credits claimed in this declaration may be cut back. Please check (✓) in the boxes below to show how you wish to prioritize the deletion of credits:

- 1. Credits are to be cut back from the Bank first, followed by option 2 or 3 or 4 as indicated.
- 2. Credits are to be cut back starting with the claims listed last, working backwards; or
- 3. Credits are to be cut back equally over all claims listed in this declaration; or
- 4. Credits are to be cut back as prioritized on the attached appendix or as follows (describe):

Note: If you have not indicated how your credits are to be deleted, credits will be cut back from the Bank first, followed by option number 2 if necessary.

For Office Use Only

Received Stamp: **SOUTHERN ONTARIO MINING DIVISION**

RECEIVED

DEC 12 1996

AM _____ PM _____

Deemed Approved Date: March 12/97

Date Approved: DEC. 27/96

Approved for Recording by Mining Recorder (Signature): _____

Date Notification Sent: _____

Total Value of Credit Approved: _____

Personal information collected on this form is obtained under the authority of subsection 6(1) of the Assessment Work Regulation 6/96. Under section 8 of the Mining Act, the information is a public record. This information will be used to review the assessment work and correspond with the mining land holder. Questions about this collection should be directed to the Chief Mining Recorder, Ministry of Northern Development and Mines, 6th Floor, 933 Ramsey Lake Road, Sudbury, Ontario, P3E 6B5.

Work Type	Units of Work <small>Depending on the type of work, list the number of hours/days worked, metres of drilling, kilometres of grid line, number of samples, etc.</small>	Cost Per Unit of work	Total Cost
Bulldozer Trenching	8 hours (Nov 29/96)	@ 66.25 per hour	\$ 530.00 + GST
Float Charge	both ways	@ 130.00	\$ 130.00 + GST
		G.S.T.	\$ 46.20
Geologist/Supervisor	2 days (Field & Office)	@ 250.00 per day	\$ 500.00
			<u>\$1,206.20</u>
Associated Costs (e.g. supplies, mobilization and demobilization).			
OFFICE - Telephone, Fax, Postage, Stationery & Overhead			\$ 50.00
Transportation Costs			
BUS - Ottawa-Renfrew			\$ 38.00
PRIVATE VEHICLE - Renfrew-Worksite & Dacre-Pembroke (re work permit)			260 km @ \$ 0.35 \$ 91.00
Food and Lodging Costs			
Food & Lodging			\$ 75.00
Total Value of Assessment Work			\$1,460.20

Calculations of Filing Discounts:

1. Work filed within two years of performance is claimed at 100% of the above Total Value of Assessment Work.
2. If work is filed after two years and up to five years after performance, it can only be claimed at 50% of the Total Value of Assessment Work. If this situation applies to your claims, use the calculation below:

TOTAL VALUE OF ASSESSMENT WORK $\times 0.50 =$ Total \$ value of worked claimed.

Note:

- Work older than 5 years is not eligible for credit.
- A recorded holder may be required to verify expenditures claimed in this statement of costs within 45 days of a request for verification and/or correction/clarification. If verification and/or correction/clarification is not made, the Minister may reject all or part of the assessment work submitted.

Certification verifying costs:

I, Herbert A. Metzger (please print full name), do hereby certify, that the amounts shown are as accurate as may reasonably be determined and the costs were incurred while conducting assessment work on the lands indicated on the accompanying Declaration of Work form as Gen. Manager of Two Island Marble Corporation (recorded holder, agent, or state company position with signing authority) authorized to make this certification.

Signature 	Date December 10, 1996
---------------	---------------------------

AREAS WITHDRAWN FROM DISPOSITION

Description	Order No.	Date	Disposition	File
M.R.O. - MINING RIGHTS ONLY				
S.R.O. - SURFACE RIGHTS ONLY				
M. & S. - MINING AND SURFACE RIGHTS				
SEC. 34/80	W. 15/82	3/11/82	M.A.B.	

THE INFORMATION THAT APPEARS ON THIS MAP HAS BEEN COMPILED FROM VARIOUS SOURCES AND ACCURACY IS NOT GUARANTEED. THOSE WISHING TO STAKE MINING CLAIMS SHOULD CONSULT WITH THE MINING RECORDER, MINISTRY OF NORTHERN DEVELOPMENT AND MINES, FOR ADDITIONAL INFORMATION ON THE STATUS OF THE LANDS SHOWN HEREON.

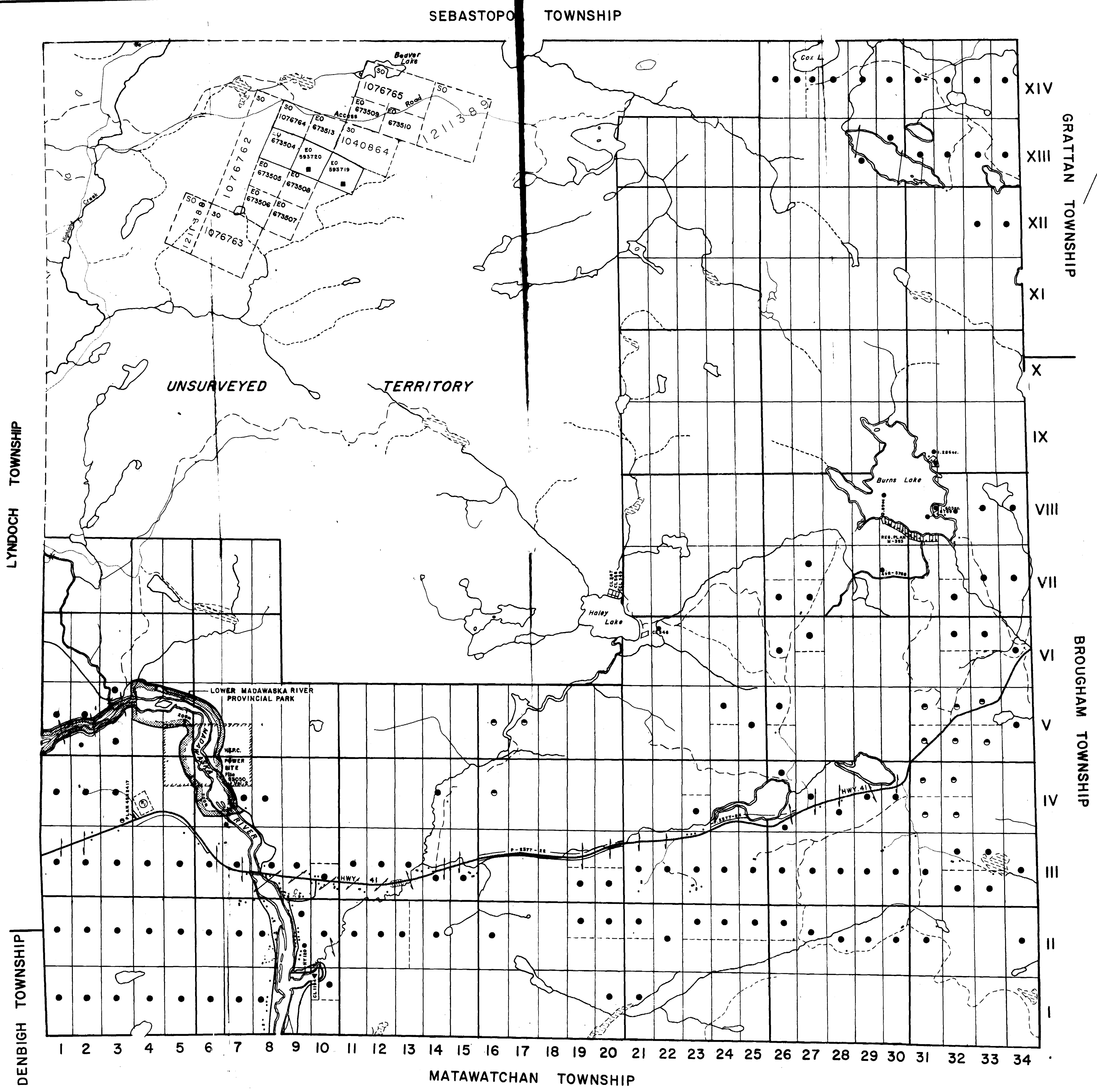

LEGEND

HIGHWAY AND ROUTE No.	
OTHER ROADS	
TRAILS	
SURVEYED LINES:	
TOWNSHIPS, BASE LINES, ETC.	
LOTS, MINING CLAIMS, PARCELS, ETC.	
UNSURVEYED LINES:	
LOT LINES	
PARCEL BOUNDARY	
MINING CLAIMS ETC.	
RAILWAY AND RIGHT OF WAY	
UTILITY LINES	
NON-PERENNIAL STREAM	
FLOODING OR FLOODING RIGHTS	
SUBDIVISION OR COMPOSITE PLAN	
RESERVATIONS	
ORIGINAL SHORELINE	
MARSH OR MUSKEG	
MINES	
TRAVERSE MONUMENT	

DISPOSITION OF CROWN LANDS

TYPE OF DOCUMENT	SYMBOL
PATENT, SURFACE & MINING RIGHTS	
" SURFACE RIGHTS ONLY	
" MINING RIGHTS ONLY	
LEASE, SURFACE & MINING RIGHTS	
" SURFACE RIGHTS ONLY	
" MINING RIGHTS ONLY	
LICENCE OF OCCUPATION	
ORDER-IN-COUNCIL	
RESERVATION	
CANCELLED	
SAND & GRAVEL	

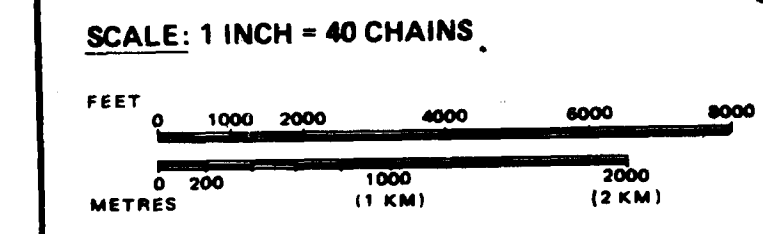

DATE OF ISSUE
DEC 27 1996
SOUTHERN ONTARIO
MINING DIVISION

AREA
GRIFFITH
M.N.R. ADMINISTRATIVE DISTRICT
PEMBROKE
MINING DIVISION
SOUTHERN ONTARIO
LAND TITLES / REGISTRY DIVISION
RENFREW

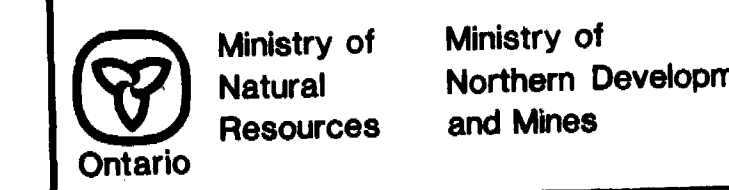

Date MARCH 1991 Number
G-335