



FEB 20 1978

PROJECTS UNIT

GEOLOGICAL REPORT
ON THE
AGNEW LAKE PROGRAM

James H. Reeves

David S. Robertson & Associates Limited
Consulting Geologists & Mining Engineers
Blind River, Ontario POR 1B0

February 15, 1978

INTRODUCTION

Norcen Energy Resources Limited (Norcen) of Calgary, Consolidated Morrison Exploration Limited (Morrison) of Toronto and David S. Robertson & Associates Limited (Robertson) entered into an agreement to explore for uranium in the Agnew Lake area. The program is managed by Robertson on claims held by Morrison (Prospecting Licence A38145) in Baldwin, Porter, Nairn and Hyman Townships.

Following the field program in 1976, of reconnaissance and detailed work, a total of 170 claims were recommended for detailed geological mapping in 1977 at a scale of 1 inch to 400 feet (1:4,800).

Geological field work was performed on the claims, from March to November inclusive. The total man-days in the field was 1,025 days.

LOCATION AND PROPERTY

At the start of the 1977 field season, the Agnew Lake project consisted of 521 claims in the five townships of Shakespeare, Nairn, Baldwin, Hyman and Porter. One claim S471615 was staked in Hyman Township. The claims lie on the north and south sides of Agnew Lake. The lake is about 35 miles west of Sudbury and 6 miles north of Espanola.

The south shore of Agnew Lake is reached by gravel roads leading north from Highway 17 at Webbwood, McKerrow, and west of Nairn Centre near the Spanish River bridge. The area north of Agnew Lake is accessible by a tote road leading west from Agnew Lake Mines to

David S. Robertson & Associates Limited

John Creek and south along the east side of John Creek to Agnew Lake. About one-half mile north of Agnew Lake a branching tote road follows the west side of the John Creek into northeastern Porter Township and Vernon Township at the west end of McAuley Lake road.

Agnew Lake Mines, which began production during the spring of 1977, is accessible by roads extending northward from Whitefish and Nairn Centre on Highway 17 to the High Falls generating station at the east end of Agnew Lake. A branching paved road 2 1/2 miles east of the power station extends northwest for 6 miles to the mine site.

GENERAL GEOLOGY

Rock distribution on the 170 claims area may be seen on Geological Maps N77-1 to N77-18 accompanying this report.

The claim group is underlain by granitic rocks of Algonian age, volcanic and gabbroic rocks of the Sudbury Series and sediments of the Huronian Series (Table 1). Basement granite is not exposed on the 170 claim group but has been mapped on adjacent claims. The granite is predominantly a massive, coarse-grained, leucocratic, porphyritic variety containing plagioclase and potash feldspars, quartz and smaller amounts of biotite, chlorite and hornblende. The granite, classified by Collins as the Birch Lake granite, was thought to intrude the sediments of the area. Later work has disproved this theory and the granite is now believed to be of Archean age.

The gabbro exposed in the area is considered by most writers

David J. Robertson & Associates Limited

TABLE 1

TABLE OF FORMATIONS

H U R O N I A N Bruce Group	Espanola Formation	Limestones, pelites and quartzites
	Bruce Formation	Conglomerates and pelites
	-----Disconformity-----	
	Upper Mississagi Formation	Quartzites and conglomerates
	Middle Mississagi Formation	Argillites, greywackes and conglomerates. (Lower 300' is Upper Economic Section).
-----Unconformity No. 2-----		
	Lower Mississagi Formation	Quartzites, and conglomerates (Lower 300' is Lower Economic Section).
-----Unconformity No. 1-----		
SUDBURY SERIES	Volcanic Sequence	Volcanics, quartzites, conglomerates, metapelites
	-----Volcanic Contact-----	
	Gabbro	
-----Unconformity, Intrusive Contact-----		
ARCHEAN Algoman	Granite	

David S. Robertson & Associates Limited

to be intrusive and younger than the Huronian sediments in the area. Field work during 1977 indicated that the gabbro is part of the basement sequence and probably represents part of the same igneous cycle as the volcanic rocks. Several reasons can be cited for this conclusion. They are as follows: 1) the gabbro remains medium-to coarse-grained up to the contact with the sedimentary rocks, 2) contact metamorphism was not observed in the sedimentary rocks along the gabbro-sedimentary contacts, 3) a regolith has been developed along most of the contact zones, 4) except where faulted the contacts are tight, and 5) the contacts showed the gabbro to be overlain unconformably by sedimentary rocks.

The mafic volcanic rocks of the Sudbury Series are assemblages of basalt flows, tuffs and breccias, locally with interbedded quartzites, pelites and conglomerates. The quartzites are dark, medium-grained and massive. The pelites generally metamorphosed to the greenschist facies contain garnets up to two inches in diameter. The conglomerates are composed of pebbles and cobbles of volcanics, sediments and vein quartz. The volcanics containing sedimentary rocks as lenses have been mapped in four areas in Baldwin Township and along the Porter-Hyman Township boundary at the Hilltop Prospect. Two of the areas in Baldwin Township, located in lot 4, concession V (Tower Showing) and lot I concession IV, were mapped as gabbro intrusives by previous mapping parties. The volcanic rocks at the Tower Showing are similar to those at the Plum, Springer-Vincent-Maki and the Hilltop Prospects, where the volcanics are overlain by greywackes and a weakly radioactive

quartz-pebble conglomerate. The volcanic unit in lot I concession IV is overlain by a nonradioactive "A" type quartzite. The basal conglomerate or quartz-pebble conglomerate were either not deposited or were eroded. The volcanics in the area are believed to be the remnants of the volcanic series which were deposited in valleys and were not subject to the same intensity of weathering as those deposited at higher elevations.

Huronian sediments of the lower Mississagi Formations unconformably overly Algoman granite and the volcanic and gabbroic rocks of the Sudbury Series.

The lower Mississagi Formation or Matinenda Formation consisting of basal conglomerates and greenish sericitic quartzites overlies the volcanic sequence at the Plum and the Springer-Vincent-Maki Prospects and the Tower Showing in Baldwin Township and the Hilltop Prospect along Porter-Hyman Township boundary. The basal conglomerate, which unconformably overlies the volcanics consists of cobble and pebbles of volcanics and quartz in an argillaceous matrix. The conglomerate overlain by massive to thinly-bedded, coarse-grained, sericitic quartzites similar to the "A" type quartzites in the Elliot Lake area. The lower three hundred feet of this formation is classified as the Lower Economic Section. A uraniferous quartz-pebble conglomerate is located near the contact between the conglomerate and quartzite at the Springer-Vincent-Maki Prospect, Hilltop Prospect and the Tower Showing. The quartz-pebble conglomerate at the Plum Prospect occurs about three hundred feet above the contact with the conglomerate and was deposited along

David S. Robertson & Associates Limited

an angular unconformity within the lower Mississagi Formation. The development of the uranium-bearing conglomerate at the Plum Prospect could be the result of reworking the lower uraniferous conglomerate exposed at the Springer-Vincent-Maki Prospect one mile to the northeast.

The lower Mississagi Formation is overlain unconformably by the McKim Formation, a pelite sequence with minor conglomerates, argillites and greywackes. The conglomerate deposited locally, varies up to three feet in thickness. The conglomerate is uraniferous at the Wilson Showing in Porter Township and at the Island, Cabin and Ridge Showings in Hyman Township. The reworking of the lower quartzite could be the source of the uranium in these areas. In other areas where the conglomerate overlies the basement gabbroic rocks, background amounts of uranium were detected. The greywackes and thinly-bedded argillites are younger than the conglomerate.

The upper Mississagi Formation, comprised of quartzites and conglomerates is conformably with the McKim Formation. The bedded to massive, fine-to coarse-grained quartzites contain little sericite and only trace in uranium. It is uncertain if these quartzites are the host rock for the ore-bearing zones at the Agnew Lake mine. The conglomerates contain pebbles to cobbles of vein quartz.

The upper Mississagi Formation is overlain disconformably by the Bruce Formation, a conglomerate which consists of boulders of white granite and quartz in a poorly sorted, slightly pyritic greywacke matrix.

SUMMARY

The 1977 field season was the second year of an ongoing uranium program in the Agnew Lake area.

Geological evidence has shown that the uranium-bearing conglomerates occur on or near the Archean-Proterozoic contact. The claims are situated along strike of known uranium occurrences and are at least as favourably for uranium-bearing conglomerates, and may be even more so.

Detailed geological mapping was completed at a scale of 1 inch to 400 feet in a study of the stratigraphic and the planning of a drilling program.



GEOPHYSICAL - GEOLOGICAL - GEOCHEMICAL TECHNICAL DATA STATEMENT

TO BE ATTACHED AS AN APPENDIX TO TECHNICAL REPORT
FACTS SHOWN HERE NEED NOT BE REPEATED IN REPORT
TECHNICAL REPORT MUST CONTAIN INTERPRETATION, CONCLUSIONS ETC.

Type of Survey(s) Geological mapping
Township or Area Baldwin, Porter, Nairn, and Hyman
Claim Holder(s) Consolidated Morrison Explorations Ltd
Suite 1700, 11 King's St. W. Toronto Ont
Survey Company D. S. Robertson Associates Ltd
Author of Report James H. Reeves
Address of Author Box 428 Blind River, Ontario
Covering Dates of Survey March to December, 1977
(linecutting to office)
Total Miles of Line Cut

MINING CLAIMS TRAVERSED
List numerically

See attached list
(prefix) (number)

If space insufficient, attach list

Table with 2 columns: SPECIAL PROVISIONS CREDITS REQUESTED, DAYS per claim. Rows include Geophysical (Electromagnetic, Magnetometer, Radiometric, Other) and Geological/Geochemical.

AIRBORNE CREDITS (Special provision credits do not apply to airborne surveys)

Magnetometer _____ Electromagnetic _____ Radiometric _____
(enter days per claim)

DATE: February 14, 1978 SIGNATURE: James H. Reeves
Author of Report or Agent

Res. Geol. L.D. Qualifications 2. 2373

Previous Surveys

Table with 4 columns: File No., Type, Date, Claim Holder

TOTAL CLAIMS

MINING CLAIMS

- ✓ S.378213 to 18 inclusive Hyman o.k.
- ✓ S.378283 to 88 inclusive Hyman
- ✓ S.378309-10 Hyman
- ✓ S.388167 to 82 inclusive all Baldwin, but 82 in Hyman o.k.
- ✓ S.388185 to 93 inclusive Hyman o.k.
- ✓ S.388195 to 98 inclusive Nairn
- ✓ S.388201 to 02 inclusive (Nairn)
- ✓ S.388204 to 50 inclusive 388204 (Hyman) 388205-388222 incl. (Nairn)
38823-50 incl. (Baldwin)
- ✓ S.388261 to 69 inclusive (Nairn TP)
- ✓ S.388279 to 312 inclusive 388279-06 incl. (Nairn) 388207-12 incl. (Baldwin)
- ✓ S.388317-18 Baldwin
- ✓ S.388323 to 37 inclusive (Baldwin)
- ✓ S.388340 Hyman
- ✓ S.388379 to 94 inclusive, 86-94 incl. (Hyman) o.k.
388379-86 incl. (Porter)
- §.471615

ASSESSMENT WORK BREAKDOWN

1. Type of Survey Geological mapping
 2. Township or Area Baldwin, Porter, Navas, and Hymen
 3. Numbers of Mining Claims Traversed by Survey See attached list

4. Number of Miles of Line Cut _____ Flown _____

*5. Number of Stations Established _____

*6. Make and type of Instrument Used _____

*7. Scale Constant or Sensitivity _____

*8. Frequency Used and Power Output _____

9. Summary of Assessment Credits (details on reverse side)

Total 8 hour Technical Days (Include Consultants, Draughting etc.) 1088.7

Total 8 hour Line-Cutting Days _____

Calculation

$$\frac{1088.7}{\text{Technical}} \times 7 = \frac{7620.9}{\text{Line-cutting}} + \frac{-}{\text{Line-cutting}} = \frac{7620.9}{\text{Line-cutting}} \div \frac{170}{\text{Number of claims}} = \frac{44.82}{\text{Assessment credits per claim}}$$

The dates listed on this form represent working time spent entirely within the limits of the above listed claims Check
 If otherwise, please explain _____

Dated: February 16, 1978

Signed: James H. Reuser

- Note: (A) * Complete only if applicable.
 (B) Complete list of names, addresses and dates on reverse side.
 (C) Submit separate breakdown for each type of survey.
 (D) Submit in duplicate.

<u>Name and Address</u>	<u>Type of Work</u>	<u>Dates Worked</u>	<u>No. of 8 hr da</u>
James H. Reeves Box 428 Blind River, Ontario	Geological Mapping	March-December	269
Nick Theis Box 428 Blind River, Ontario	Geological Mapping	November	11
Frank Racicot Box 428 Blind River, Ontario	Geological Mapping	March-May	72
James McAuley Married Students' Residence Apt. 711 Laurentian University, Sudbury	Geological Mapping	May	22
John Falconer 58 Caroline Court Sudbury, Ontario	Geological Mapping	May-September	85
Glenn Zeebregts 3634 Suzanne Street Box 176 Val Caron, Ontario	Geological Mapping	May-August	77
Mike Kelly c/o J. B. Kelly 900 Long Ridge Road Stamford, Connecticut 06902	Geological Mapping	May-August	50
Clayton Tremble Pine Street Sault Ste. Marie, Ontario	Geological Mapping	October-November	16
Rodney Sanders Theresa Street Hanmer, Ontario	Geological Mapping	August-October	48
Adelord Buswa General Delivery Blind River, Ontario	Prospecting	April-September	46
Roland Rousselle General Delivery Blind River, Ontario	Prospecting	September-November	32



Ministry of
Natural
Resources
Ontario

BALDWIN
NAIRN
HYMAN } TWRs.
PORTER

JAN 16 1978

#77-108

file 5378213

A separate form is
required for each
type of work to be
recorded.

THE MINING ACT REPORT OF WORK

To the Recorder of Subsury Mining Division

I, Consolidated Meridian Exploration Limited A-38145
name of Recorded Holder Prospector's Licence

Box 428 Blind River Ontario P.O.R. 1 B0
Post Office Address

do hereby report the performance of 6800 days of geological mapping
type of work

not before reported to be applied on the following contiguous claims

Claim No.	Days	Claim No.	Days	Claim No.	Days
..s.s. attached	schedule				

Geological Branch ODM
ASSESSMENT FILES
RESEARCH OFFICE
DEC 29 1977
RECEIVED

All the work was performed on Mining Claim (s) s.s. attached schedule
(In the case of geological and/or geophysical survey (s) where more than 18 claims are involved attach a schedule)

READ CAREFULLY: THE FOLLOWING INFORMATION IS REQUIRED BY THE MINING RECORDER.

- For Manual Work, Stripping or Opening up of Mines, Sinking Shafts or Other Actual Mining Operations - Names and addresses of the men who performed the work and the dates and hours of their employment.
- For Diamond and other Core Drilling - Frusage, No. and angle of holes and diameter of core. Name and address of owner or operator of drill. Dates when drilling was done. Signed core log and sketch in duplicate.
- For Compressed Air or Other Power Driven or Mechanical Equipment
Type of drill or equipment. Names and addresses of men engaged in operating equipment and the dates and hours of their employment.
- For Power Stripping - Type of equipment. Name and address of owner or operator. Amount expended. Dates on which work was done. Proof of actual cost must be submitted within 30 days of recording.
- With each of the above types of work sketches are required to show the location and extent of the work in relation to the nearest claim post. In the case of diamond or other core drilling the sketch must be submitted in duplicate.
- For Geophysical, Geological, Geochemical Surveys and Expenditure Credits - the name of author of report. Covering dates of survey (linecutting & office). Type of instrument used. Total amount of expenditure. Technical reports, maps, expenditure breakdown, receipts must be filed in duplicate with the Minister within 60 days of recording.
- For Land Survey - the name and address of Ontario Land surveyor.

The Required Information is as Follows: (Attach a list if this space is insufficient)

See attached list

Author J. H. Reeves
Dates May - November, 1977

SUBSURY
RECEIVED
DEC 19 1977
7:30 PM
7500 HURON ST. 456

Date December 15, 1977

James H. Reeves
Signature of Recorded Holder or Agent

The Mining Act
Certificate Verifying Report of Work

I, James H. Reeves
Box 428 Blind River Ontario P.O.R. 1 B0
(Post Office Address)

hereby certify:

- That I have a personal and intimate knowledge of the facts set forth in the report of work annexed here to, having performed the work or witnessed same during and/or after its completion.
- That the annexed report is true.

Dated December 15, 1977

James H. Reeves
Signature

THE PENALTY FOR MAKING A FALSE STATEMENT IN THIS REPORT AND/OR CERTIFICATE IS \$500. OR SIX MONTHS IMPRISONMENT OR BOTH

Geological Survey

<u>Claim No</u>	<u>Days</u>	<u>Claim No.</u>	<u>Days</u>
<u>Baldwin Township</u>			
S 388167 ✓	40	S 388242 ✓	40
S 388168 ✓	40	388243 ✓	40
388169 ✓	40	388244 ✓	40
388170 ✓	40	388245 ✓	40
388171 ✓	40	388246 ✓	40
388172 ✓	40	388247 ✓	40
388173 ✓	40	388248 ✓	40
388174 ✓	40	388249 ✓	40
388175 ✓	40	388250 ✓	40
388176 ✓	40	388323 ✓	40
388177 ✓	40	388324 ✓	40
388178 ✓	40	388325 ✓	40
388179 ✓	40	388326 ✓	40
388180 ✓	40	388327 ✓	40
388181 ✓	40	388328 ✓	40
388223 ✓	40	388329 ✓	40
388224 ✓	40	388330 ✓	40
388225 ✓	40	388331 ✓	40
388226 ✓	40	388332 ✓	40
388227 ✓	40	388333 ✓	40
388228 ✓	40	388334 ✓	40
388229 ✓	40	388335 ✓	40
388230 ✓	40	388336 ✓	40
388231 ✓	40	388337 ✓	40
388232 ✓	40	388307 ✓	40
388233 ✓	40	388308 ✓	40
388234 ✓	40	388309 ✓	40
388235 ✓	40	388310 ✓	40
388236 ✓	40	388311 ✓	40
388237 ✓	40	388312 ✓	40
388238 ✓	40	388317 ✓	40
388239 ✓	40	388318 ✓	40
388240 ✓	40		
388241 ✓	40		
		Subtotal	2640

Nairn Township

S 388195 ✓	40	S 388264 ✓	40
388196 ✓	40	388265 ✓	40
388197 ✓	40	388266 ✓	40
388198 ✓	40	388267 ✓	40
388205 ✓	40	388268 ✓	40
388206 ✓	40	388269 ✓	40
388207 ✓	40	388279 ✓	40
388208 ✓	40	388280 ✓	40
388209 ✓	40	388281 ✓	40
388210 ✓	40	388282 ✓	40
388211 ✓	40	388283 ✓	40
388212 ✓	40	388284 ✓	40
388213 ✓	40	388285 ✓	40
388214 ✓	40	388286 ✓	40
388215 ✓	40	388287 ✓	40
388216 ✓	40	388288 ✓	40
388217 ✓	40	388289 ✓	40
388218 ✓	40	388290 ✓	40
388219 ✓	40	388291 ✓	40
388220 ✓	40	388292 ✓	40

<u>Claim No</u>	<u>Days</u>	<u>claim No</u>	<u>Days</u>
S 388 221 ✓	40	S 388 303 ✓	40
388 222 ✓	40	388 304 ✓	40
388 261 ✓	40	388 305 ✓	40
388 262 ✓	40	388 306 ✓	40
388 263 ✓	40	388 386 ✓	40
388 293 ✓	40	388 387 ✓	40
388 294 ✓	40	388 388 ✓	40
388 295 ✓	40	388 389 ✓	40
388 296 ✓	40	388 390 ✓	40
388 297 ✓	40	388 391 ✓	40
388 298 ✓	40	388 392 ✓	40
388 299 ✓	40	388 393 ✓	40
388 300 ✓	40	388 394 ✓	40
388 301 ✓	40	4716 15 (Hyman)	40
388 302 ✓	40		
		subtotal	2760

Porter Township

S 388 379	40	S 388 383	40
388 380	40	388 384	40
388 381	40	388 385	40
388 382	40		
		subtotal	280

Hyman Township

S 378 283 ✓	40	S 388 190 ✓	40
378 284 ✓	40	388 191 ✓	40
378 285 ✓	40	388 192 ✓	40
378 286 ✓	40	388 193 ✓	40
378 287 ✓	40	388 201 ✓	40
378 288 ✓	40	388 202 ✓	40
378 309 ✓	40	388 204 ✓	40
378 310 ✓	40	388 340 ✓	40
388 182 ✓	40	378 213 ✓	40
388 185 ✓	40	378 214 ✓	40
388 186 ✓	40	378 215 ✓	40
388 187 ✓	40	378 216 ✓	40
388 188 ✓	40	378 217 ✓	40
388 189 ✓	40	378 218 ✓	40

Subtotal 560
 1120
 Total 6240



Ministry of
Natural
Resources

Ontario

Feb:14/79

1979 02 09

Your file:

Our file: 2.2613

R.H.

Mrs. R.M. Charnesky
Mining Recorder
Ministry of Natural Resources
174 Douglas Street West
Sudbury, Ontario
P3E 1G1

Dear Mrs. Charnesky:

Re: Mining Claims S. 378213 et al. Hyman, Baldwin, Nairn
and Porter Townships, File 2.2613

The Geological assessment work credits as listed with my
Notice of Intent dated January 19, 1979 have been
approved as of the above date.

Please inform the recorded holder of these mining claims
and so indicate on your records.

Yours very truly,

J.C. Smith
Acting Director
Lands Administration Branch

Whitney Block, Room 6450
Queen's Park
Toronto, Ontario
M7A 1W3
Phone: 416/965-6918

DN:ie

cc: David S. Robertson & Associates Limited
Blind River, Ontario
Attn: Mr. David S. Robertson

Attn: Mr. James H. Reeves

Attn: Mr. Dave M. Ross

Consolidated Morrison Exploration Limited
Blind River, Ontario

Consolidated Morrison Exploration Limited
Toronto, Ontario

Deputy Regional Director ✓
Sudbury, Ontario
Attn: Resident Geologist

VERNON TP. M.1171

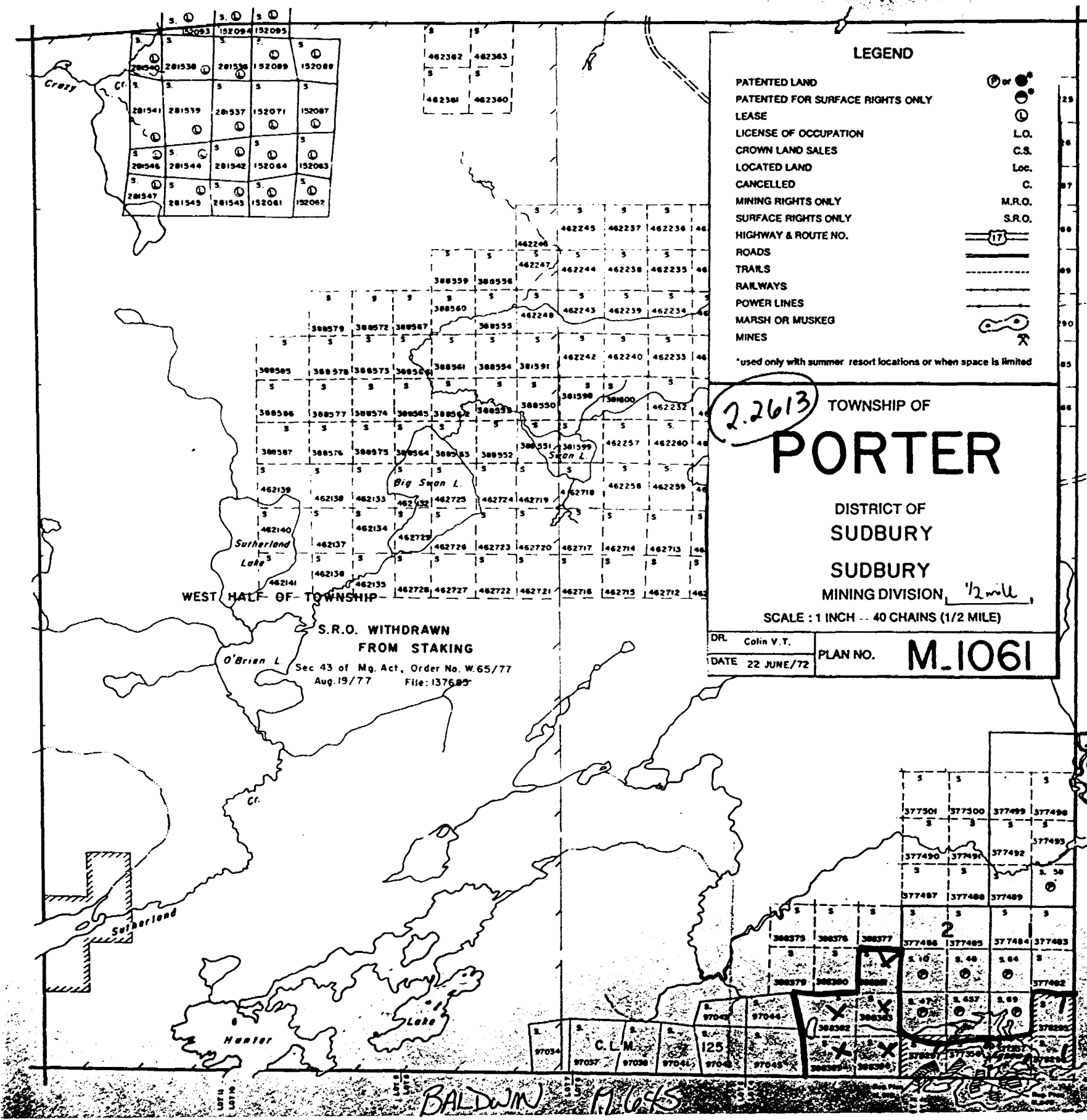

LEGEND

- PATENTED LAND
- PATENTED FOR SURFACE RIGHTS ONLY
- LEASE
- LICENSE OF OCCUPATION
- CROWN LAND SALES
- LOCATED LAND
- CANCELLED
- MINING RIGHTS ONLY
- SURFACE RIGHTS ONLY
- HIGHWAY & ROUTE NO.
- ROADS
- TRAILS
- RAILWAYS
- POWER LINES
- MARSH OR MUSKEG
- MINES

**used only with summer resort locations or when space is limited*

2.2613 TOWNSHIP OF
PORTER
 DISTRICT OF
 SUDBURY
 SUDBURY
 MINING DIVISION, *1/2 mile*
 SCALE : 1 INCH = 40 CHAINS (1/2 MILE)

DR. Colin V.T.
 DATE 22 JUNE/72 PLAN NO. **M.1061**

M-1171

HYMAN TP. M-945

WEST HALF OF TOWNSHIP
 S.R.O. WITHDRAWN
 FROM STAKING
 Sec 43 of Mg. Act, Order No. W.65/77
 Aug. 19/77 File: 1376.85

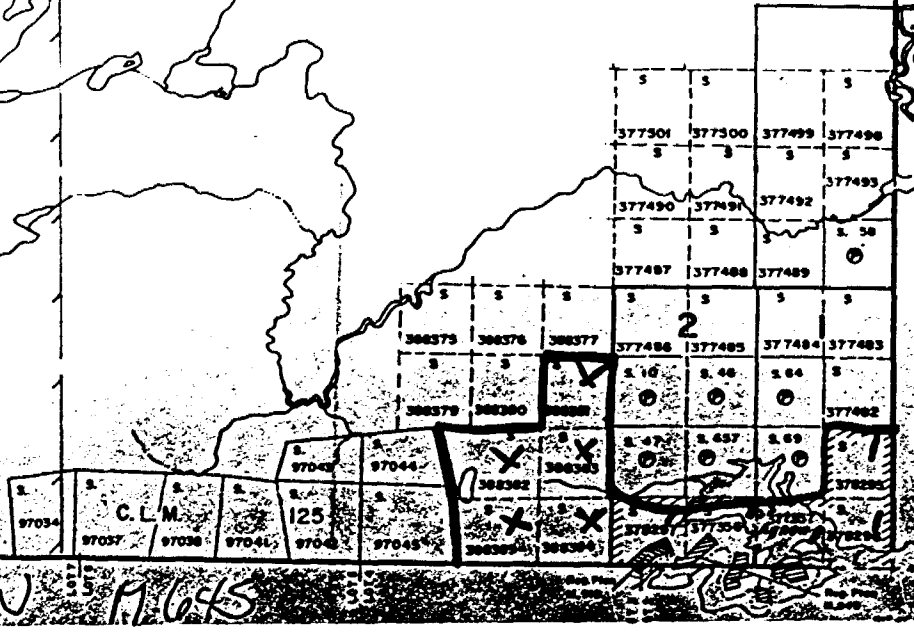

TOTTEN TP. M.1161

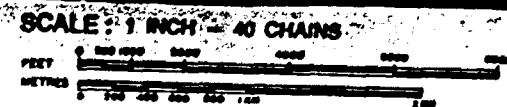

ACRES 40

HECTARES 16

TOWNSHIP 2.2613

HYMAN

DISTRICT SUDBURY
 MINING DIVISION SUDBURY

Ministry of Natural Resources
 Ontario Surveys and Mapping Branch
 Date June 13th, 1973 Plan No. M.945
 Whitney Block Queen's Park, Toronto

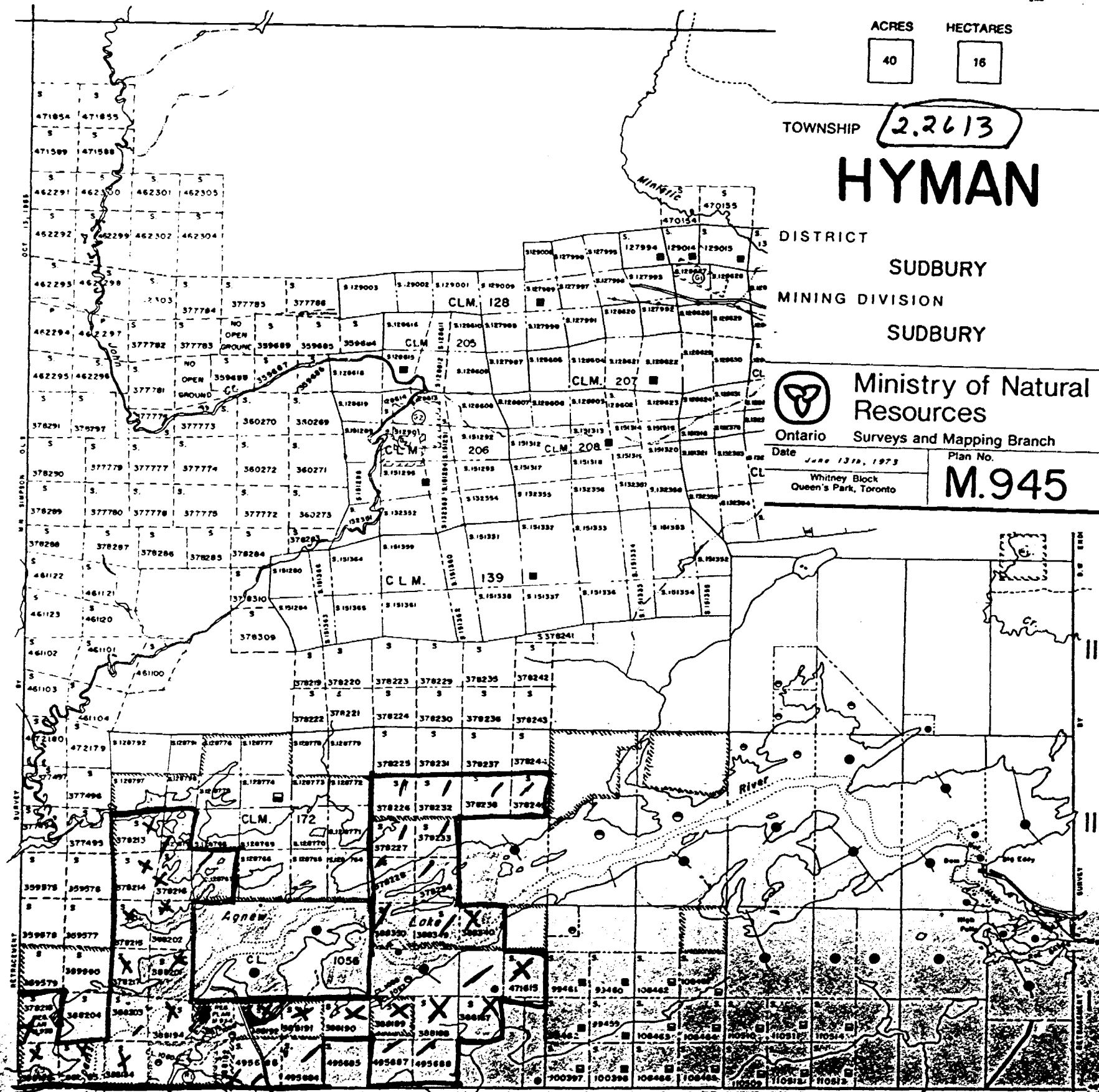

TOTTEN TP. M.1161

DRURY TP. M.765

8 7 6 5 4 3 2 1

NORTH TP. M.82

Hyman Twp. (M-945)

Baldwin Twp. (M-645)

Lorne Twp. (M-999)

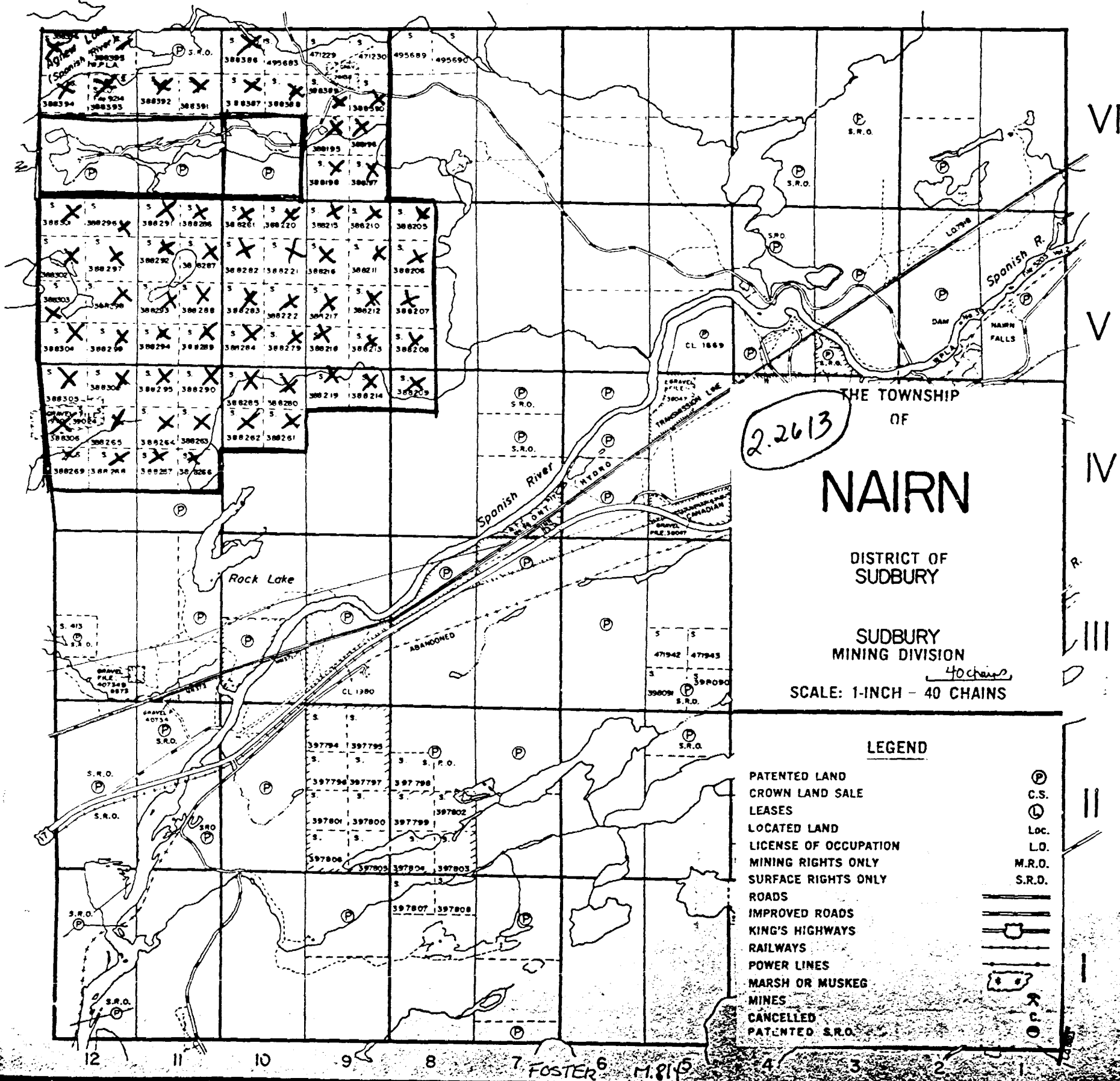

2.2613

THE TOWNSHIP OF
Nairn

DISTRICT OF
SUDBURY

SUDBURY
MINING DIVISION

SCALE: 1-INCH - 40 CHAINS

LEGEND

- PATENTED LAND ⊙
- CROWN LAND SALE C.S.
- LEASES ⊕
- LOCATED LAND Loc.
- LICENSE OF OCCUPATION L.O.
- MINING RIGHTS ONLY M.R.O.
- SURFACE RIGHTS ONLY S.R.O.
- ROADS
- IMPROVED ROADS
- KING'S HIGHWAYS
- RAILWAYS
- POWER LINES
- MARSH OR MUSKEG
- MINES
- CANCELLED
- PATENTED S.R.O.

FOSTER M. 819

Porter Twp.-M.1061

GRAVEL PILE FILE: 79042

Plan M.C. 1049

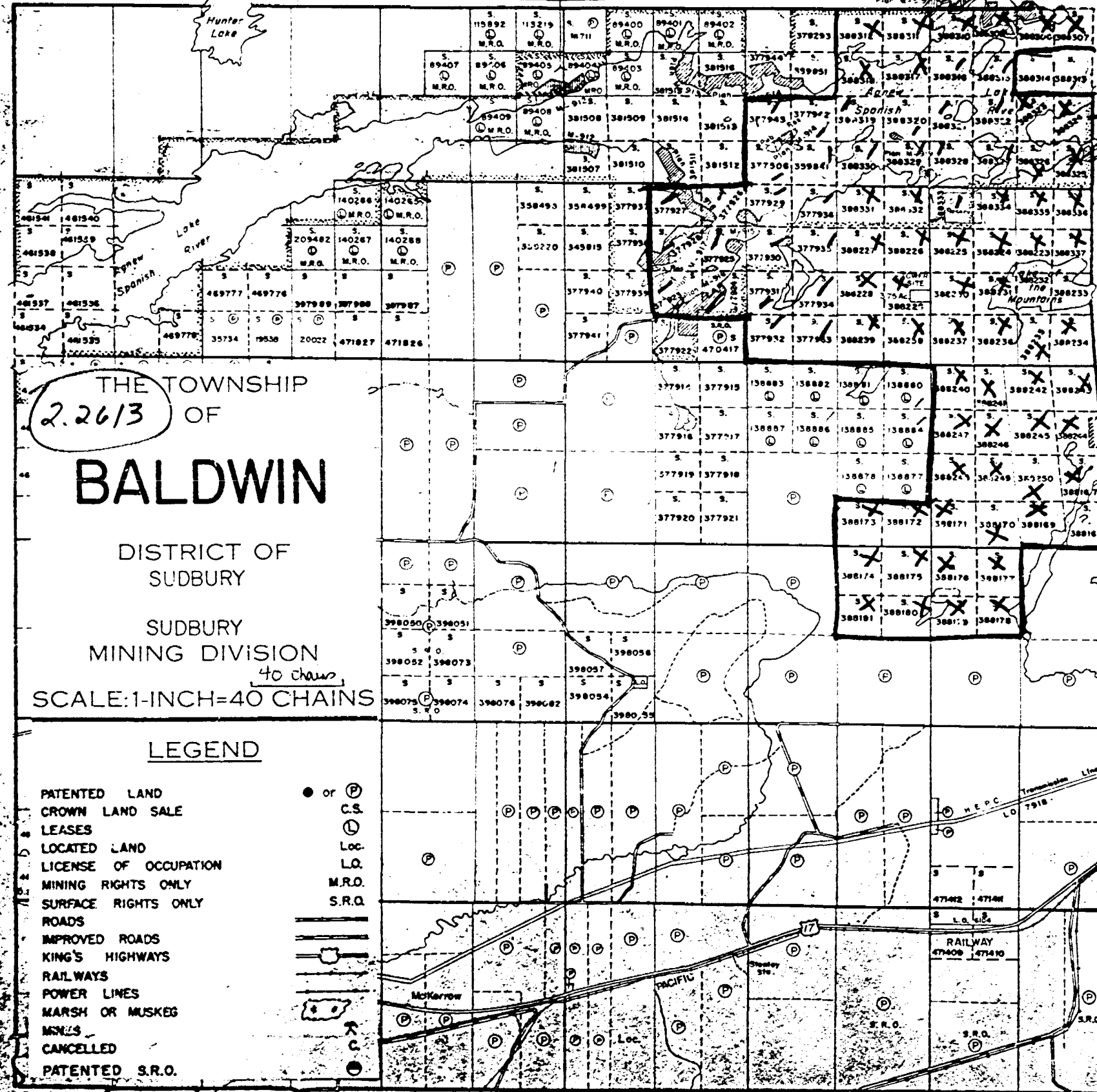

THE TOWNSHIP OF 2.2613

BALDWIN

DISTRICT OF SUDBURY

SUDBURY MINING DIVISION

SCALE: 1-INCH=40 CHAINS

LEGEND

- PATENTED LAND ● or ⊕
- CROWN LAND SALE C.S.
- LEASES ⊙
- LOCATED LAND Loc.
- LICENSE OF OCCUPATION L.O.
- MINING RIGHTS ONLY M.R.O.
- SURFACE RIGHTS ONLY S.R.O.
- ROADS ———
- IMPROVED ROADS ———
- KING'S HIGHWAYS ———
- RAILWAYS ———
- POWER LINES ———
- MARSH OR MUSKEG [Symbol]
- MINES [Symbol]
- CANCELLED [Symbol]
- PATENTED S.R.O. [Symbol]

Shakespeare Twp.-M.1104

V

V

IV

NATRU M 883

MERRITT M-1061

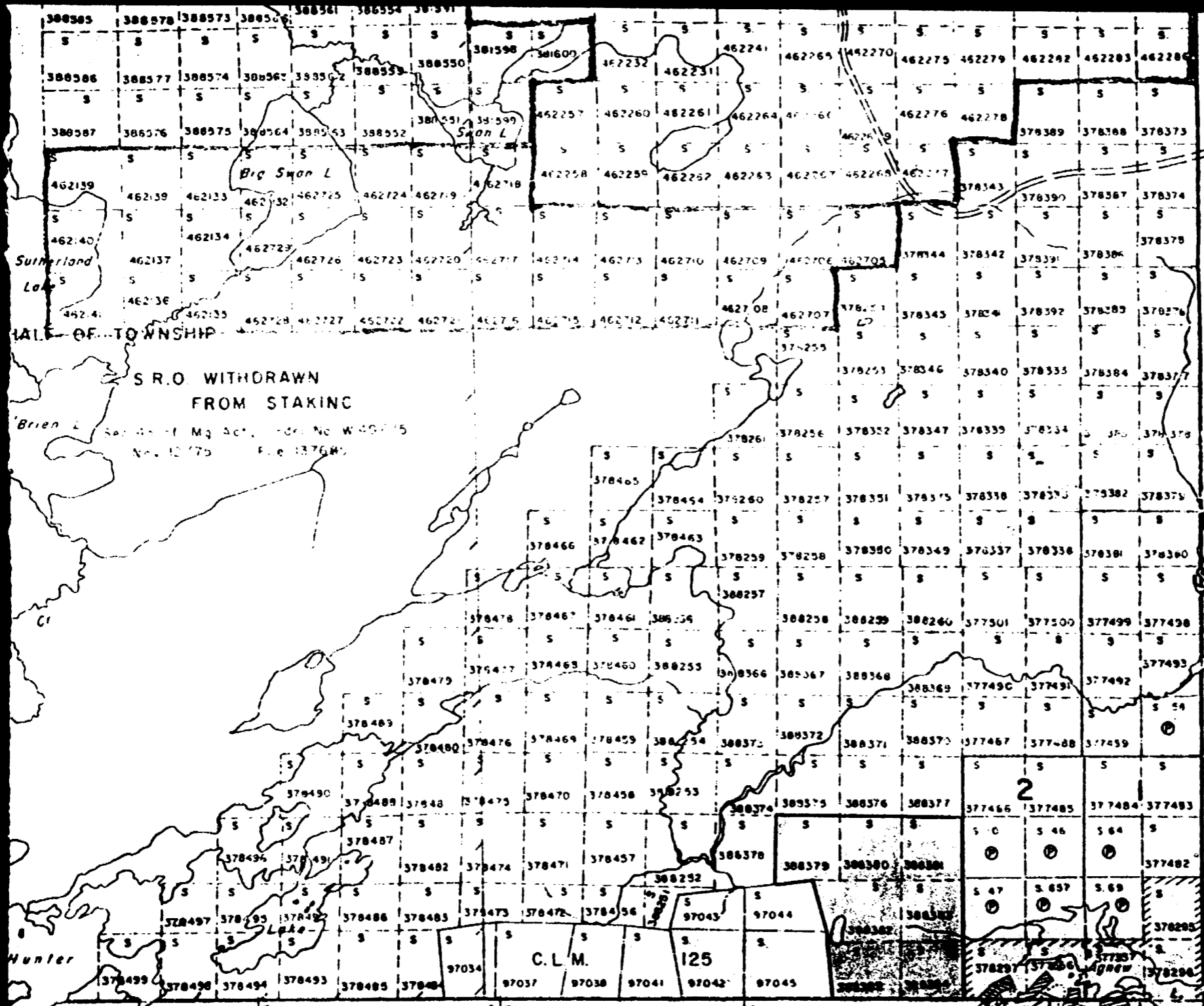

HALF OF TOWNSHIP

S.R.O. WITHDRAWN
FROM STAKING

Brien L. Sec. 45-11 Mg. Act. - Ord. No. W49715
No. 12179 File 13764

C.L.M. 125

HYMAN TP. M-945

Porter Tp.

Consolidated
Morrison Exptl

Dec. 15/77

164 mapping

PA
PA
LE
LI
CR
LC
CA
M
SU
HR
RO
TR
PO
M
M

TOTTEN TP. M.1161

HYMAN TWP
CONSOLIDATED
MORRISON EXPL. CO.
DEC 15/77
GL MAPPING.

Consolidated M
Expl. Ltd.
Dec. 15/77-0

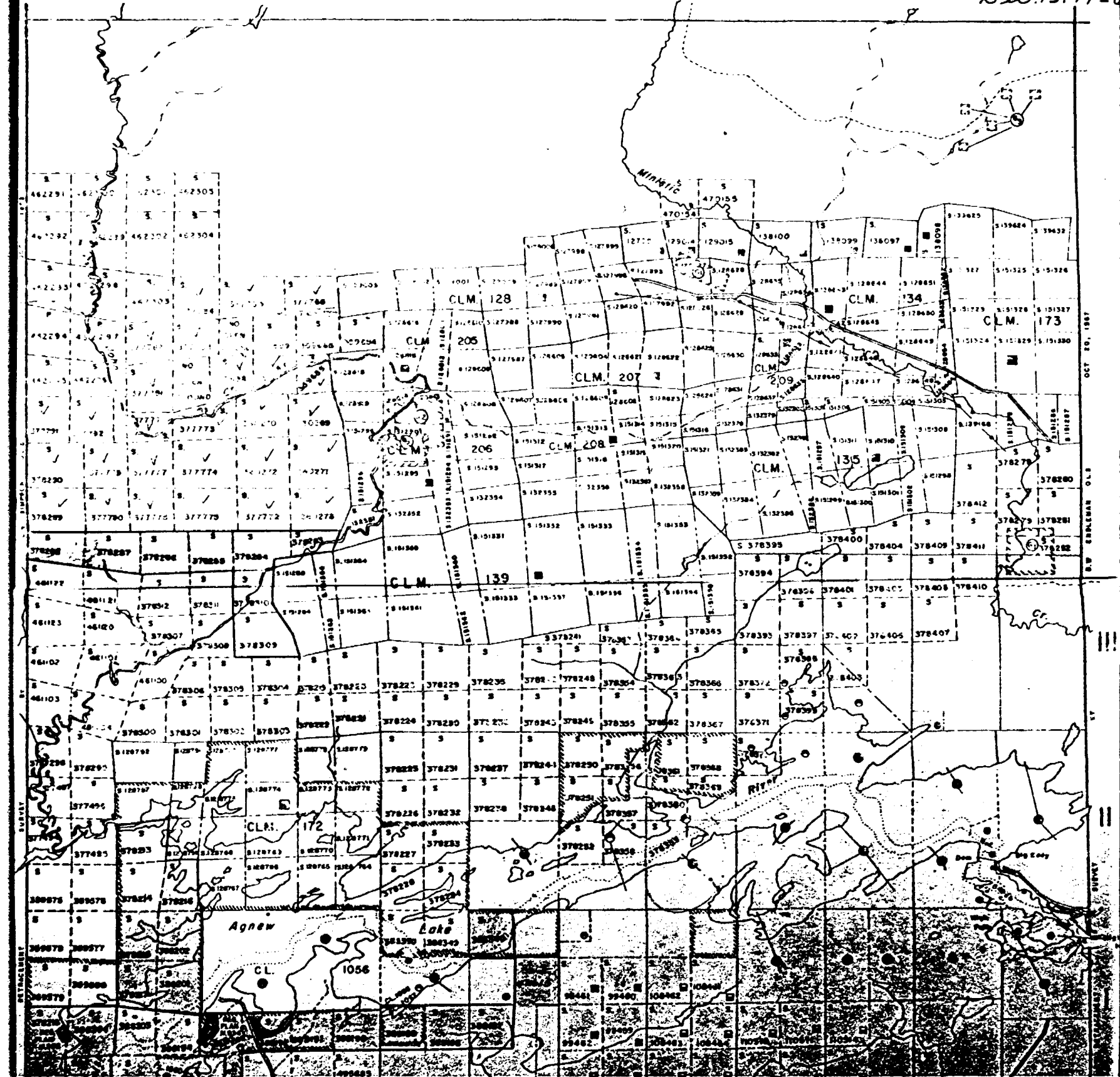

SEE ACCOMPANYING
MAP(S) IDENTIFIED AS

BALDWIN-0039-A1, #1-3

LOCATED IN THE MAP
CHANNEL IN THE FOLLOWING
SEQUENCE (X)

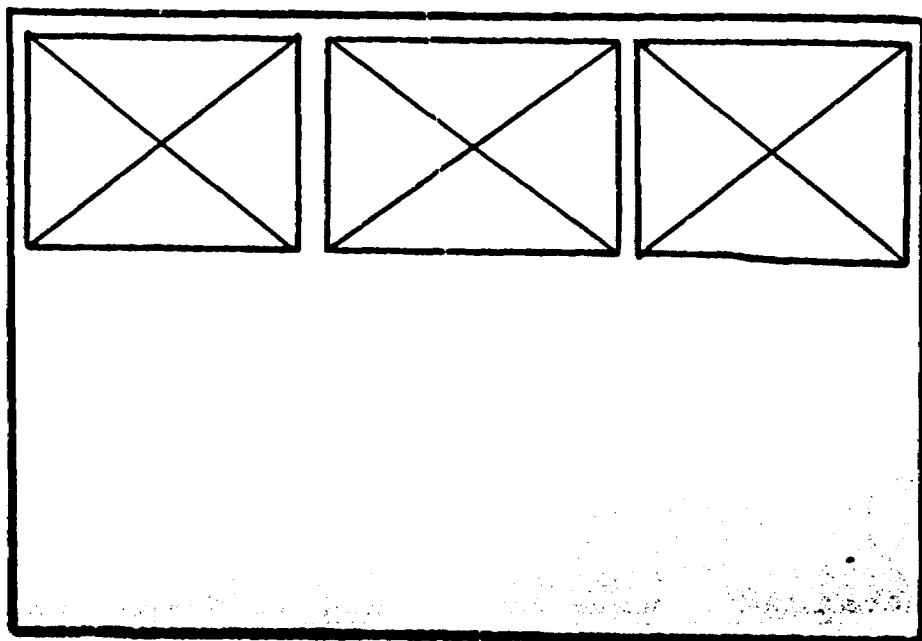

FOR ADDITIONAL
INFORMATION

SEE MAPS:

BALDWIN-0039-A1 #4-13