



IDZIAK COPPER PROPERTY
SHIELDS TOWNSHIP
SAULT STE. MARIE AREA
ONTARIO

During the week of August 27th, 1966, the writer, accompanied by the owner Mr. Bon Idziak, visited and examined the surface showings on this six claim copper prospect. The following brief report contains the results of this examination.

History Summary:

By trenching at three points and using geophysics, Mr. Idziak has exposed copper and gold mineralization in a north west trending zone of weakness for a distance of 2,000 feet. The width of the fracture zone has not been determined; however, in pits at zone "A" and zone "B", it is exposed over a width of six to fifteen feet.

The beforementioned zone deserves attention as it is similar in geological character to that of the Superior Copper Mine in the south west corner of Township 24 which has produced close to one million pounds of copper from an ore body of average grade - from 2.53% to 4% copper.

Recommendations:

1. Cut chain and picket a N 45° W base line through the zone for a distance of 3,000 feet and cross grid this line at 200 foot intervals to extend 500 feet on either side of the base line. Total line approximately 15,000 feet or 2.8 miles.

Approximate cost = \$250.00

2. Complete a detailed, vertical, magnetic intensity survey over the zones already outlined by the preliminary reconnaissance survey and trace possible extensions of the zone. Total line approximately 9,000 feet or 1.7 miles.

Approximate cost = \$600.00

3. Complete a detailed, narrow spread induced polarization survey over the anomalous magnetic areas. Total line approximately 9,000 feet or 1.7 miles.

Approximate cost = \$1,250.00

- 2 -

4. Diamond drill zones with coinciding magnetic and induced polarization anomalies at 100 foot intervals.

Extent - Location and Access:

The property, consisting of six unpatented claims No. SSM 80943 - 47, SSM 81879, is located in the north central part of Shields Township at a distance, by gravel road, of 8 miles north of Searchmont which, in turn, is located 26 miles north of Sault Ste. Marie, Ontario. The Algoma Central railroad passes through the property at a distance of 1,000 feet east of the mineralized zone.

Topography:

The property is covered by hardwood with some coniferous growth present. A lake is located 200 feet west of zones "A" and "B". The Achigan river flows south through claim SSM - 81879.

General Geology:

Any available geology on the area is provided through the Mines Department of the Algoma Central railroad. The Ontario Department of Mines has published a preliminary sheet # P.302 on this Michawana area, on a scale of 1 inch to 2 miles; however, both of these sources do not offer any resemblance of detail and, as such, the area is locally unmapped.

The general geology of the area indicates that the rocks consist of Keewatin lavas which have been intruded by Algonian acid intrusives. The area is lightly drift covered, obscuring 90% of the rock formation.

Structurally, the shearing attains a north west trend and dips vertically to 70° east or west.

Local and Economic Geology:

The exposed rocks on the property are "greenstones", grading from massive andesite to chlorite hornblende schist which has been intruded by syenite porphyry or granodiorite along the strike of the shear.

The mineralization, consisting of chalcopyrite, magnetite, bismuth, and gold, occurs in a north west trending shear zone in Keewatin lavas of an andesitic nature. This zone varies in an exposed width of from 12 to 15 feet and dips vertically to 70° east or west. The sulphides occur along the fracture planes in the presence of quartz gangue over a width of 6 to 12 feet.

- 3 -

As indicated on the attached plan, the quartz grab sampling will assay from 2.17% to 12.48% copper with gold running approximately .04 ozs to the ton. On spectrographic analysis, bismuth is indicated from .05% to .50%.

Grab samples from the adjacent greenstone host rock average from .67% to 1.01% copper. One 15 foot channel sample containing mineralization in the greenstone across the zone at location "B" ran .67% copper. At location "A", an intrusive rock which appears to be a syenite, located on the west side of the shear zone, ran 2.01% copper across the exposed 3 feet.

Magnetic Survey:

As shown on the attached magnetic overlay, the presence of magnetite along the shear zone has been indicated through a reconnaissance magnetic survey. The instrument used was an Arvela Magnetometer with a sensitivity of 100 gammas per scale division and a top range of 60,000 gammas. At locations "A" and "B", considerable magnetite is exposed in the zone and is associated with the quartz and copper mineralization.

It is the opinion of the writer that, considering the present price of copper, the length of the zone, and the ease and low cost of evaluation, the property warrants further exploration in order to determine its total length and locate economic sections along its length.

Respectfully submitted,

W. C. Barrett, geologist

80944
80947

80944
80947

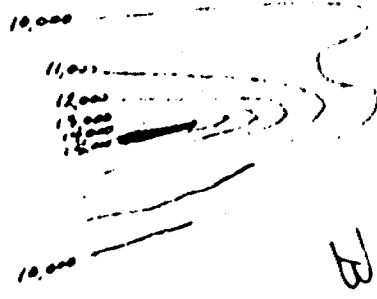

80944
81879

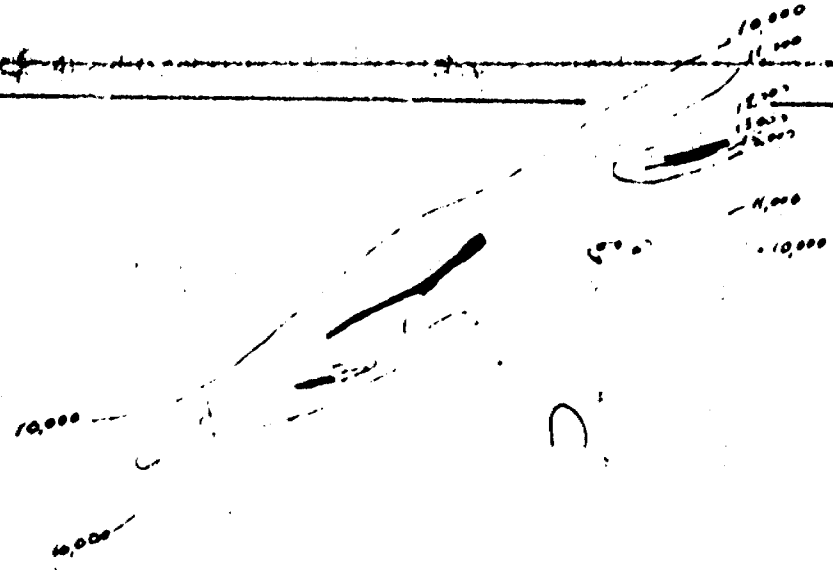

Thyridites



41K16SE0024 0011A1 SHIELDS

900

ASSESSMENT WORK BREAKDOWN

1. FIELD WORK

<u>Type of Work</u>	<u>Name & Address</u>	<u>Dates Worked</u>	<u>Number of 8 hour days</u>
Property Evaluation	W. G. Barrett 18 Henderson Ave. Wilkes-Barre, Pa.	Aug 27/66	1.5

2. CONSULTANTS

<u>Name & Address</u>	<u>Dates Worked (specify in field or office)</u>	<u>Number of 8 hour days</u>
W. G. Barrett	Aug 30, 31, 1966 (Office)	2

3. DRAUGHTSMAN, TYPING, OTHERS (specify)

<u>Name & Address</u>	<u>Type of Work</u>	<u>Dates Worked</u>	<u>Number of 8 hour days</u>
W. G. Barrett	Typing	Sept 1, 1966	1
W. Barrett	Draughting		1

TOTAL 8 HOUR TECHNICAL DAYS _____

4. LINE-CUTTING

<u>Name</u>	<u>Address</u>	<u>Dates Worked</u>	<u>Number of 8 hour days</u>

TOTAL 8 HOUR LINE-CUTTING DAYS _____

MARNE TWP.

SHIELDS TWP
M. 1344

Scale
1" = 40 chs.

TUPPER TWP.

GAUDETTE TWP.

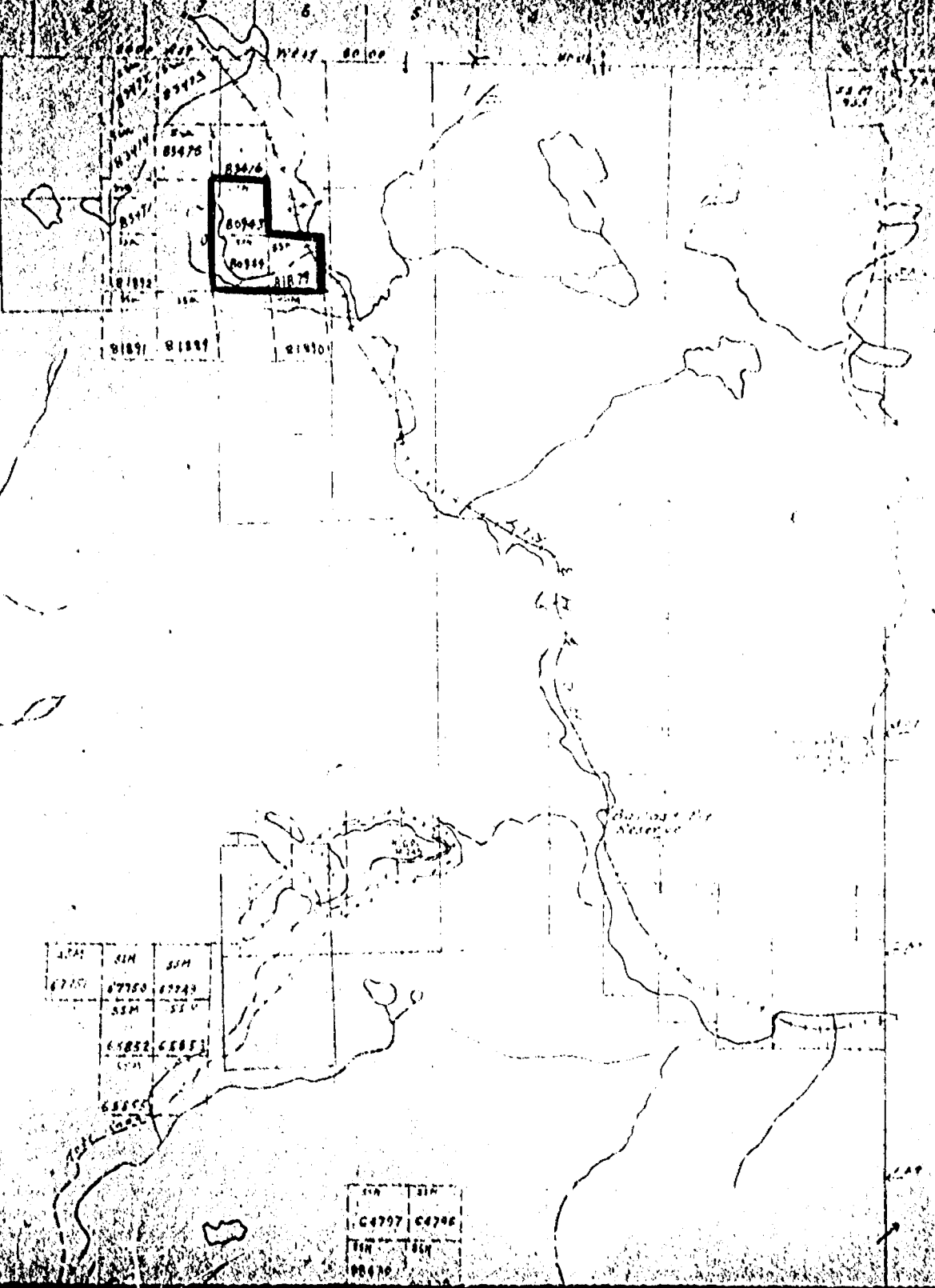

64797	64798
64799	64800

SEE ACCOMPANYING
MAP(S) IDENTIFIED AS

SHIELDS - 0011-A1 #1

LOCATED IN THE MAP
CHANNEL IN THE FOLLOWING
SEQUENCE (X)

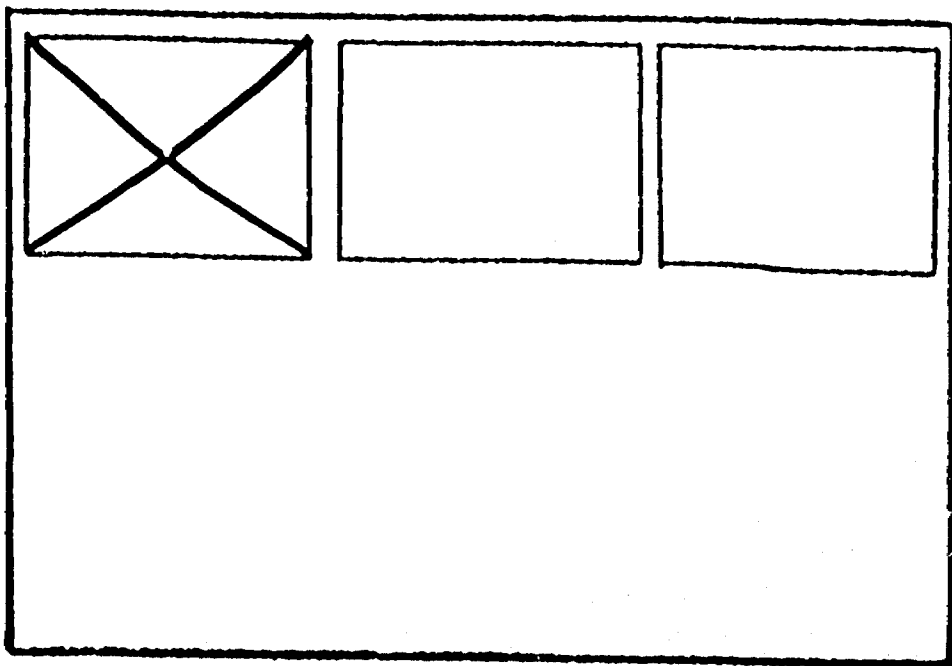

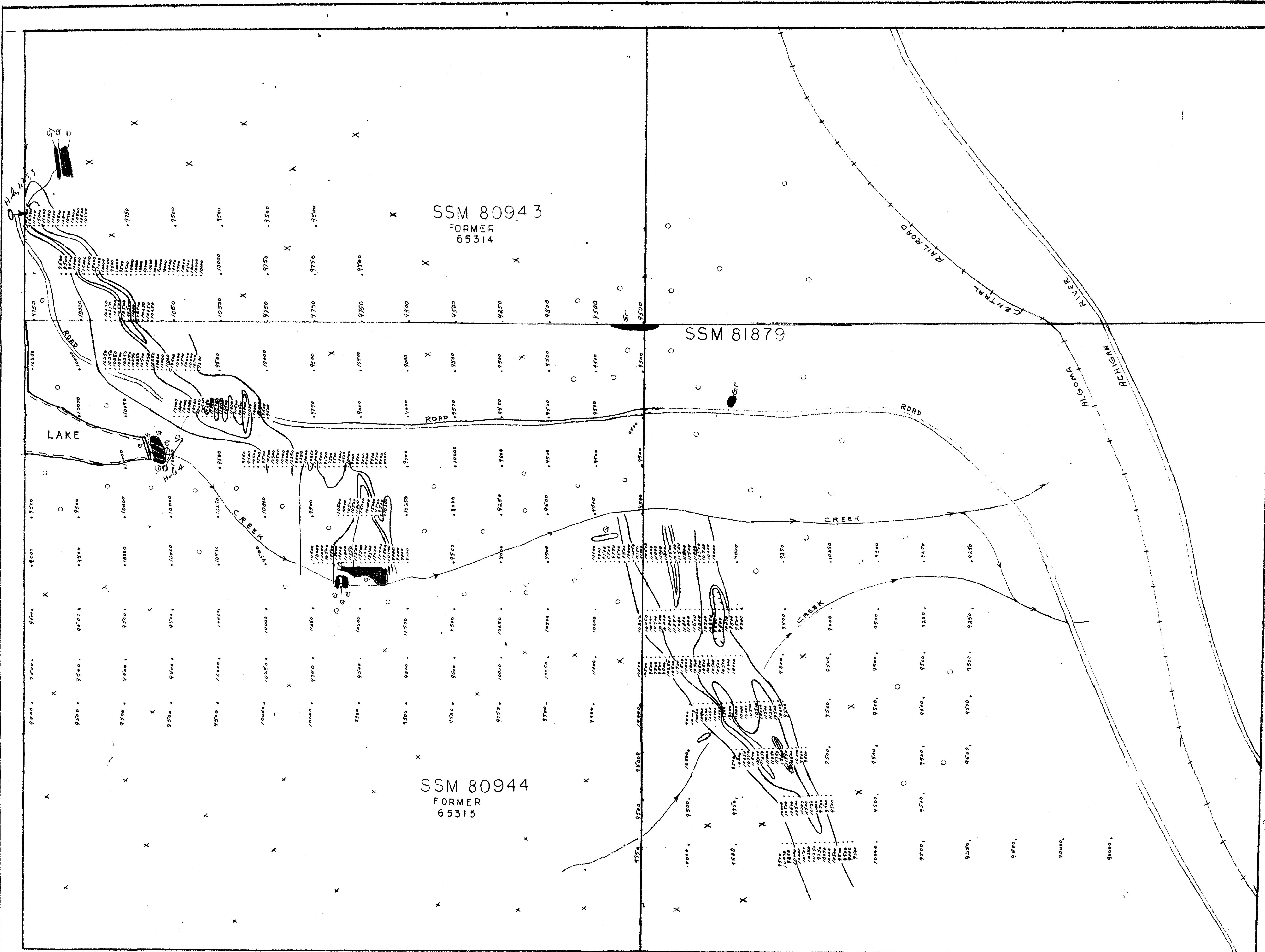

SSM 80943
FORMER
65314

SSM 81879

SSM 80944
FORMER
65315

SHIELDS
TOWNSHIP

ARVELA MAGNETOMETER
SURVEY

LEGEND

- Q ○ QUARTZ
- G ● GREENSTONE
- Sy ● SYENITE
- Gr ● GRANITE
- OB ○ OVERBURDEN
- X — SECOND GROWTH MAPLE
- O — BALSAM

1" = 100 FEET

Bon Sejnal



41K1650024 0011A1 SHIELDS