



41K16SE0029 SHIELDS10A1 SHIELDS

010

**DIAMOND DRILL LOG**  
Property of Boniface Idzia k.

D. D. Hole No. I

Page - - - - I

Location: Shields Twp.  
Bearing: E. & W. ( mg)  
Dip: 45 Degrees

Depth of Hole, 63.0 ft.  
Started..... Jan. 23, 1964  
Completed, Jan. 27 - 1964  
Drilled By: Jan. Grenten  
Bruce Mines, P.O., Ontario.

From	To	Description
"0"	9.0	Casing.
9.0	9.3	Greenstone ( Keewatin) altered schist.
9.3	10.0	Porphyry & Hornblende schist, with Quartz brecciation
10.0	10.2	<del>Porphyry &amp; Hornblende schist</del> Quartz, white, Barren, out normal.
10.2	11.0	Porphyry, Hornblende schist & quartz brecciation.
11.0	14.0	Andesite, dense.
14.0	25.0	Ground core.
25.0	26.0	Quartz, cherty
26.0	27.2	Ground core
27.2	27.3	Porphyry & Hornblende schist
27.3	31.0	Ground core
31.0	34.0	Porphyry and stringers cherty white quartz, barren
34.0	35.5	Ground core
35.5	53.5	Porphyry, red sparse dissemination Cu. fe. s2, <del>core</del> <u>split</u>
53.5	58.5	Porphyry & Hornblende schist, fair disseminated, mineralization Cu fo s2.
58.5	62.0	Porphyry & Hornblende schist, dense
62.0	63.0	Porphyry, red, with inclusions brecciated quartz blue.

( Core stored at B. Idziak Residence)  
Hwy. 556.

Core Logged By:

J.G. Pollard

Wabos, Ontario

February 10 - 1964.

**RECEIVED**

MAY 26 1964

RESIDENT GEOLOGIST  
SAULT STE. MARIE

ASSESSMENT WORK

NOT TO BE REMOVED FROM  
THE OFFICE OF THE RESIDENT  
GEOLOGIST, ONT. DEPT. OF MINES  
SAULT STE. MARIE, ONT.

DIAMOND DRILL LOG  
Property of Bon Idziak

Location: Shields Twp.  
Mining Claim No. SSM 65314  
Bearing: E. & W. ( Mg)  
Dip. 55 Degrees.

D.D. Hole # 2  
Page 1

NOT TO BE REMOVED FROM  
THE OFFICE OF THE RESIDENT  
GEOLOGIST, ONT. DEPT. OF MINES  
SAULT STE. MARIE, ONT.

Depth of hole 70.0 ft.  
Started: Jan. 28, 1964  
Completed: Feb. 1th. 64  
Drilled By: Jas Grexton  
Bruce Mines, Ontario.

From	to	description
"0"	6.0	Casing.
6.0	6.9	Hornblende schist with Hematite stains.
6.9	14.9	Porphyry & Hornblende schist, in places pitted with oxidization.
14.9	18.5	Andesite, with magnetite mineralization.
18.5	21.6	Porphyry with Hornblende schist.
21.6	24.0	Porphyry schist (altered) stock work, calcite quartz and barite, some magnetite and Sphalerite.
24.0	25.1	Porphyry and Hornblende schist.
25.1	29.0	Hornblende schist, porphyry band 1" at 25.8 ft.
29.0	31.0	Ground core.
31.0	31.7	Porphyry - Hornblende and pyroxene schist.
31.7	33.0	Porphyry - red, quartz seams out longitudinally.
33.0	34.6	Quartz- white out normal, cherty, fractures filled porphyritized inclusions.
34.6	37.1	Quartz and porphyry- 50/50
37.1	52.5	porphyry- red & hornblende schist 46.5 to 47.6 fairly well mineralized magnetite.
52.5	53.9	porphyritized, hornblende schist fairly well mineralized magnetite.
53.9	55.1	Porphyry- red, narrow seams Cu Fe S <sub>2</sub> , plus fair min. magnetite.
55.1	57.5	Andesite with inclusions hornblende schist & porphyry, fairly well mineralized magnetite.
57.5	63.9	Andesite & porphyry 60 to 61.0 ft. dissemination <u>Cu Fe S<sub>2</sub> &amp; Fe S<sub>2</sub></u> .
63.9	64.6	Andesite with porphyritized inclusions, a few fairly large cubes Fe S <sub>2</sub> .
64.6	69.2	Porphyry with hornblende schist.
69.2	70.0	porphyry - red- dense.

( note: all the above porphyry's been subjected to intensive fracturing except the last 8" all fractures mineralized magnetite, and some Cu. Fe S<sub>2</sub>.

( all the above core is stored at the residence of B. Idziak. Hwy. 556 )

LOGGED BY:

*J.G. Pollard*  
J.G. Pollard  
Wabos, Ontario.

ASSESSMENT WORK

February 10, 1964.

DIAMOND DRILL LOG

Property of Bon Idziak.

Location: Shields Twp.

Mining Claim No. SSM 65314

Bearing: E & W. ( Mg)

Dip: 65 degrees

NOT TO BE REMOVED FROM  
THE OFFICE OF THE RESIDENT  
GEOLOGIST, ONT. DEPT. OF MINES  
GAULT STE. MARIE, ONT.

D.D. Hole # 3

Page I

Depth of hole, 101.0

Started: Feb. 2, 1964

Completed: Feb. 10, 1964.

Drilled By: Jas. Grexton

Bruce Mines, Ontario.

From	To	Description
"0"	9.0	Casing.
9.0	9.3	porphyritized hornblende schist.
9.8	11.0	porphyry - red, fractures filled with Hornblende schist.
11.0	14.9	Andesite & altered porphyry, sprinkling Fe s2.
14.9	19.0	porphyry, fractures filled with Hornblende & pyroxene.
19.0	23.1	Andesite schist with dev. of chloritization, calcite seam I/I6 at 23.0 feet.
23.1	26.4	-- porphyry ped, fractures filled with Hornblende, at 26.3 ft, calcite seam $\frac{1}{2}$ ? CUT normal.
26.4	29.0	Porphyry altered, intensely fractured stock calcite & barite some magnetite & sphalerite.
29.0	31.0	porphyry-red, fractures filled with hornblende, magnetite and some hematite
31.0	33.4	andesite, fair development chloritization.
33.4	33.5	quartz, white, fair mineralization fe. s2.
33.5	34.2	andesite with some pyroxene fair min. fe. s2 & magnetite.
34.2	34.3	porphyry fractures filled with hornblende.
34.3	34.6	ground core.
34.6	35.0	porphyry schisted, dev. chloritization fair mineralization cu. fe. s2 magnetite.
35.0	37.8	porphyry & hornblende schist at 36.8 to 37.0 quartz white, fractures filled with hornblende & magnetite
37.8	42.0	andesite, development chloritization, seams blue quartz some magnetite
42.0	44.0	porphyry, fractures filled with hornblende & magnetite.
44.0	45.9	ground core.
45.9	46.0	porphyry, fractures filled with hornblende & magnetite.
46.0	53.6	" " " fairly large cubes fe. s2.
53.6	56.7	andesite with dev. chloritization, fairly well mineralized magnetite cu, fe. s2 in fractures.
56.7	68.8	porphyry-red fractures filled with hornblende & magnetite.
68.8	78.5	" " " appears near margin E-W fault, slight dev. chloritization hematite along fracture planes.
78.5	79.0	andesite schisted, dev. chloritization along fractures.
79.0	100.0	porphyry-hornblende schist, disseminated pyrite cubes throughout fair dev. chloritization, a few narrow seams blue quartz, cut normal some magnetite.
100.0	101.0	porphyritized andesite, schisted, thin calcite dev. along fractures some fe. s2.

core stored at Bon Idziak (hwy 556)

Logged by *J. P. Poccia*  
Feb. 10 th, 1964, Wabos, Ontario

DIAMOND DRILL LOG  
Property of Bon Idziak

Drill hole # 4  
Shields Twp.  
Mining Claim No. SSM 65315  
Angle: 45 degrees.

Strike: N.E.  
Started: Feb. 11, 1964  
Finished: Feb. 20, 1964  
Drilled By:  
Jas. Grexton  
Bruce Mines, Ontario.

From	to	Description
0.0	6.0	Casing
6.0	12.0	Granite, dense
12.0	13.0	Hornblende & Mica schist, the only fracture slight dev. chloritization.
13.0	18.0	Granite.
18.0	20.0	Volcanic, few large crystals Fe s2
20.0	70.5	Granite, 36.0 to 38.0 Quartz
70.5	72.5	Hornblende Granite, fairly coarse grained.
72.5	73.7	Quartz, one large bleb Fe s2
73.7	83.0	Granite, dense
83.0	84.5	Hornblende Granite
84.5	91.5	Granite
91.5	91.8	Hornblende Granite
91.8	93.9	Granite
93.9	96.9	Hornblende Granite
96.9	97.9	Granite
97.9	99.9	Hornblende Granite
99.9	100.9	Granite
100.9	101.9	Hornblende granite
101.9	104.9	Granite
104.9	105.9	Hornblende granite
105.9	113.8	Granite
113.8	123.3	Hornblende granite
123.3	124.5	Granite
124.5	125.0	Hornblende Granite
125.0	129.5	Granite
129.5	142.5	Hornblende granite
142.5	146.5	Granite
146.5	198.0	Meta volcanic, at 176 ft. fracture with content, hematite at 180.5 " " high content hematite at 151.0 " " " " at 156.0 to 156.5 bands Epidote at 192.4 " two bands magnetite 1/2" widths
198.0	203.0	Granite Note: entire core intersection of meta volcanic slightly magnetic magnetic.

NOT TO BE REMOVED FROM  
THE OFFICE OF THE RESIDENT  
GEOLOGIST, ONT. DEPT. OF MINES  
SAULT STE. MARIE, ONT.

**ASSESSMENT WORK**

FINIS

Core is stored at Bon Idziak, Searchmont, Ont.

Logged by: *J. G. Pollard*

April 29, 1964

J. G. Pollard--Wabos, Ont



41K16SE0029 SHIELDS10A1 SHIELDS

900

**REPORT OF EXPLORATION WORK FOR ASSESSMENT CREDIT**

Name of Company or Claim Holder B. Idzyski

Address Seachmont Ont

The following exploration work has been carried out in the Province of Ontario during the calendar year 19 67

Mining Division South St. Thome

Township Shields Concession \_\_\_\_\_ Lot \_\_\_\_\_

or ~~NW~~ ~~NE~~ ~~SW~~ ~~SE~~ quarter of township

Area Map \_\_\_\_\_ Latitude \_\_\_\_\_ Longitude \_\_\_\_\_

Number of claims in property or group 3

Type of Work Performed (use check marks where possible)

Stripping  Trenching \_\_\_\_\_ Test Pitting \_\_\_\_\_

Open Cutting \_\_\_\_\_ Shaft \_\_\_\_\_ Adit \_\_\_\_\_

Sampling \_\_\_\_\_ Claim Surveys \_\_\_\_\_

Diamond Drilling: Number of Holes \_\_\_\_\_ Total Footage \_\_\_\_\_

Geological Mapping \_\_\_\_\_ Geochemical Work \_\_\_\_\_

Geophysical Work: Ground \_\_\_\_\_ Airborne \_\_\_\_\_

Method(s) \_\_\_\_\_

Other Work \_\_\_\_\_

Submitted by [Signature]  
Mining Recorder

Date July 19/67

Please complete this form for each property or claim group and forward to Director, Mining Lands Branch.

SSM  
80943

SSM  
80944

6'W x 12'L x 2'D

9'W x 10'L x 2'D

500'

↑  
N

Removal of  
Overburden

NOT TO BE REMOVED FROM  
THE OFFICE OF THE RESIDENT  
GEOLOGIST, ONT. DEPT. OF MINES  
SAULT STE. MARIE, ONT.

*None*

RECEIVED

JUL 24 1957

RESIDENT GEOLOGIST  
SAULT STE. MARIE

Shields Twp.  
Boniface R. Dyjak Sr  
D12495

NOT TO BE REMOVED FROM  
THE OFFICE OF THE RESIDENT  
GEOLOGIST, ONT. DEPT. OF MINES  
SAULT STE. MARIE, ONT.

SSM  
65315  
5000

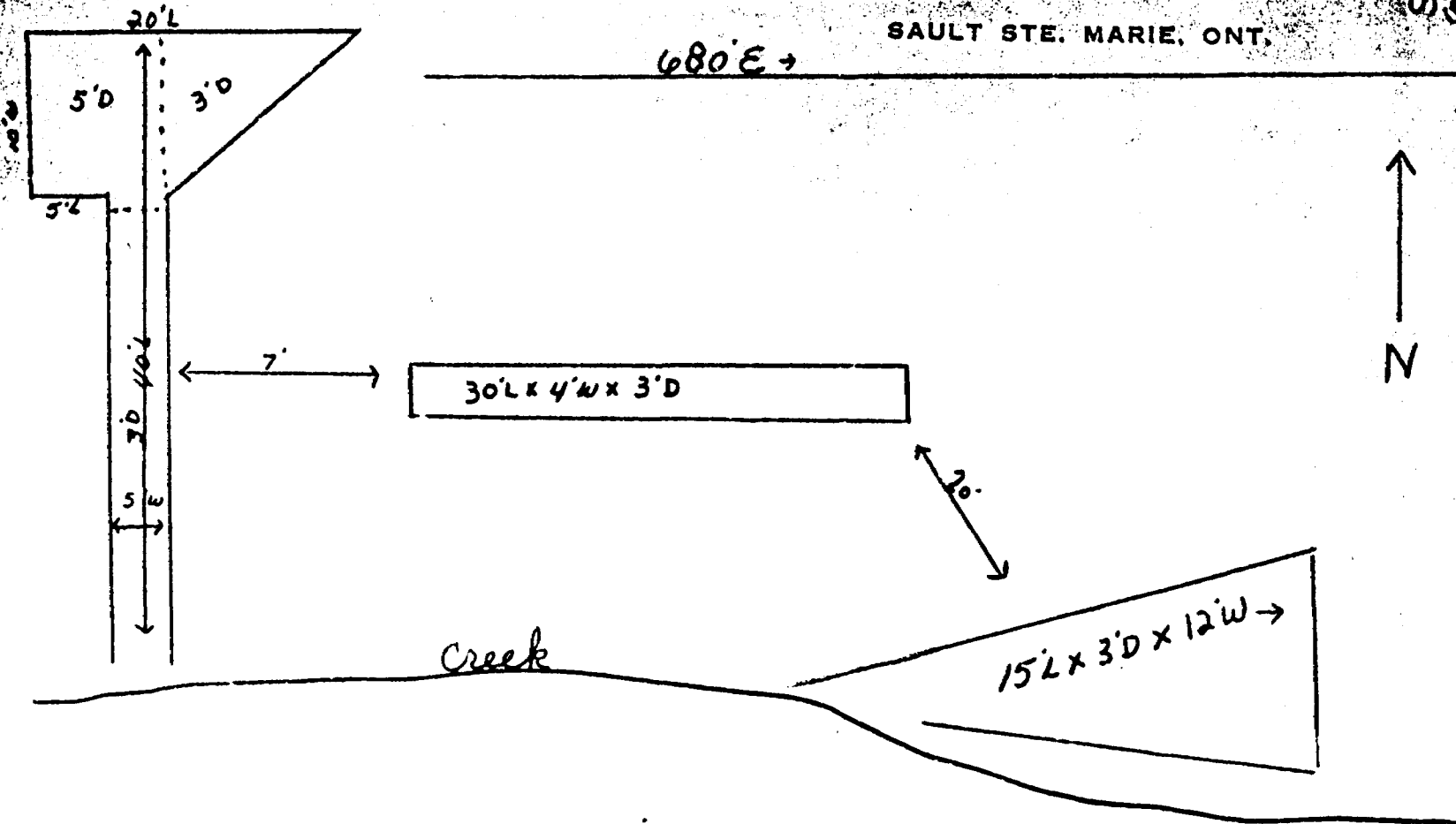

RECEIVED  
JUN 29 1965  
RESIDENT GEOLOGIST  
SAULT STE. MARIE

Trenching + Stripping  
Shields Twp.  
June 23-65 CLAIM SSM 65315  
Bon Schink

RESIDENT GEOLOGIST

A ——— N

Shields  
Twp.

May 23-1964  
Don Lygink

SSM  
65314

Hole #1 - 63' - 45"  
" 2 - 70' - 35"  
" 3 - 101' - 65"  
267  
437

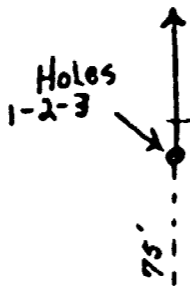

SSM  
65316

490'

Road

LAKE

325'

BORDER  
DRAIN →

SSM  
65315

Hole #4  
203' - 45"

Hole

RECEIVED

MAY 26 1964

RESIDENT GEOLOGIST  
SAULT STE. MARIE

ASSESSMENT WORK

NOT TO BE REMOVED FROM  
THE OFFICE OF THE RESIDENT  
GEOLOGIST, ONT. DEPT. OF MINES  
SAULT STE. MARIE, ONT.

SSM  
65317