



010

3.6027

**DIAMOND DRILLING
SWEDE CREEK PROPERTY
PIC TOWNSHIP
HEMLO AREA, ONTARIO
NTS 42 D 9
LATITUDE 48°43'N, LONGITUDE 86°13'W**

**Prepared for
FOURSTAR PETROLEUM RESOURCES LTD.**

ARCTEX ENGINEERING SERVICES

**Locke B. Goldsmith, P.Eng.
Consulting Geologist**

October 6, 1990

0M90-002



42D09NE0131 63.6027 PIC

010C

TABLE OF CONTENTS

SUMMARY	1
INTRODUCTION	2
DIAMOND DRILLING	2
LOCATION MAP	3
CLAIM MAP	4
DISCUSSION	5
CONCLUSIONS	5
RECOMMENDATIONS	5
COST ESTIMATE	6
ENGINEER'S CERTIFICATE	7
REFERENCES	8

APPENDIX:

PLAN OF DIAMOND DRILL HOLES
DRILL SECTIONS
DRILL LOGS
ANALYTICAL PROCEDURES
GEOCHEMICAL ANALYSES

MAPS:

(Pocket inside back cover)

GEOLOGY, SHOWING DIAMOND DRILL HOLES
MAGNETICS, SHOWING DIAMOND DRILL HOLES
VLF-EM, SHOWING DIAMOND DRILL HOLES
SOIL GEOCHEMISTRY, SHOWING DIAMOND DRILL HOLES

**DIAMOND DRILLING
SWEDE CREEK PROPERTY
PIC TOWNSHIP
HEMLO AREA, ONTARIO**

SUMMARY

Six holes totalling 370.28 metres were drilled to test three geophysical and geochemical targets which had been suggested by previous surveys. All holes intersected sheared and foliated metavolcanics and chlorite schist. No economic gold values were detected.

Drilling has tested only a corner of the claim group. Additional drilling is recommended to explore the remainder of the property.

INTRODUCTION

The property owned by Fourstar Petroleum Resources Ltd., 4 — 2630 Bourquin Way, Abbotsford, B.C., V2S 5N7, consists of twelve unpatented 40-acre claims (480 acres, 195 hectares) numbered 862791 to -794 inclusive, -797 to -802 inclusive, and -804 to -806 inclusive, in Surveyed Range VIII, Lots 5 and 6 and in unsurveyed land to the north of Range VIII, Pic Township, Thunder Bay Mining Division, Claim Map G630, Northwestern Ontario.

The area of the claims is located approximately 21 km west-northwest of the important Williams gold deposit of Lac Minerals at Hemlo. Marathon, the nearest supply centre, is approximately 15 km west. Thunder Bay is some 300 km to the west. A disused 4-wheel drive road (not shown on any published map, but directly opposite to a short road which leads southerly into a gravel pit) departs from Highway 17 approximately 1.6 km (1 mi) west of a bridge over Black River and trends northerly, passing 430 m (1400') west of the property (see property geology map). The southern boundary of the claim is approximately 1 km north of Highway 17. A light boat can be launched easily into the Black River at Highway 17; the river and Swede Creek are navigable, thus providing ready access to the southern and central portions of the property.

Water and timber are adequate for exploration requirements. An electrical transmission line passes within 100 metres of the southwest corner of the claims. Prior to the rock geochemical and geological surveys (Goldsmith, 1984) there is no recorded history of exploration, nor are there any known mineral deposits on the property.

Geological, rock geochemical, magnetometer, VLF-EM, and soil geochemical surveys were completed in previous years (Goldsmith, 1984, 1985, 1988).

DIAMOND DRILLING

Holes were positioned to test multiple anomalous conditions wherever possible. Holes SW-90-1, -2, and -3 probed a VLF-EM conductor with a coincident linear magnetic high; hole -1 also passed beneath elevated gold values in soil. Hole -4 crossed a VLF-EM conductor with a weak magnetic low association. Holes -5 and -6 crossed a VLF-EM conductor with a magnetic high and an anomalous gold value in rock near the margin of the Gowan Lake pluton.

Offsets in a 010°-020° direction are suggested by geophysical and outcrop patterns; holes SW-90-1 to -4 were oriented at 340° to cross these possible fault or shear zones.

FOURSTAR Petroleum Resources Ltd.

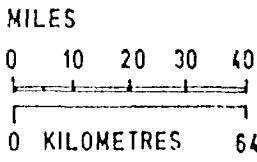
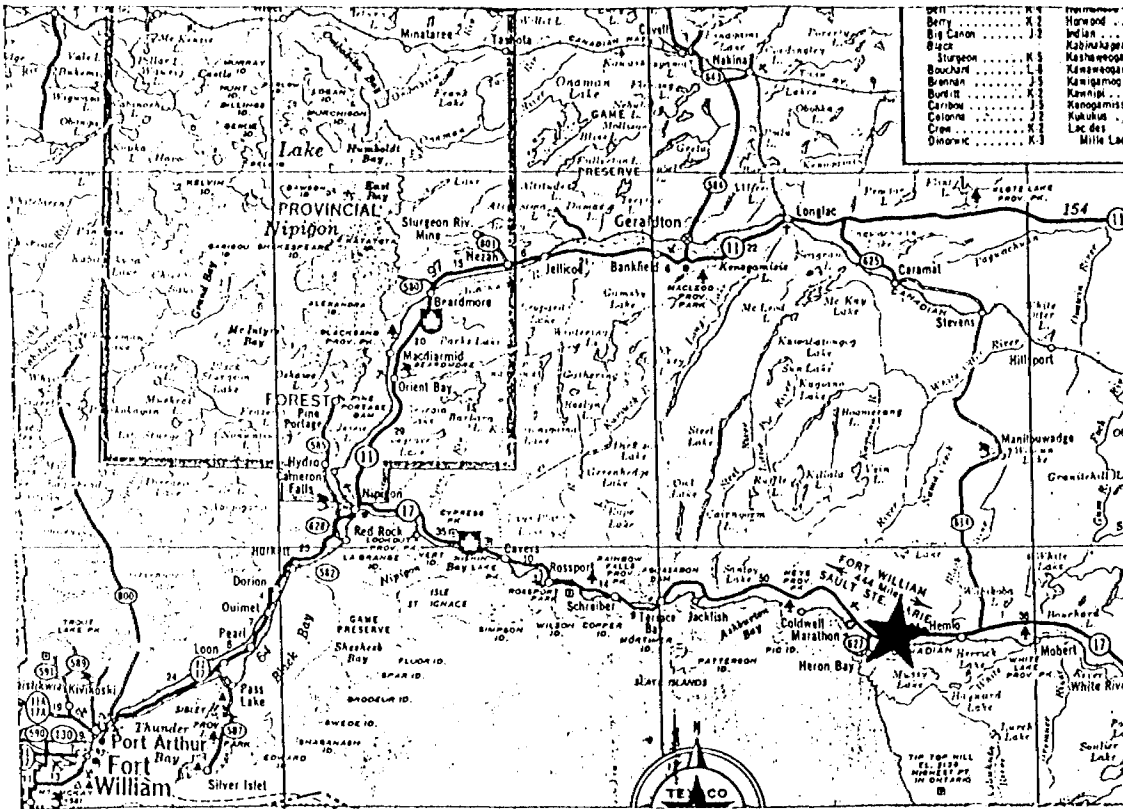

LOCATION MAP

Range VIII & IX, Lots 5 & 6
Pic Township, Map G630
Thunder Bay Mining Division

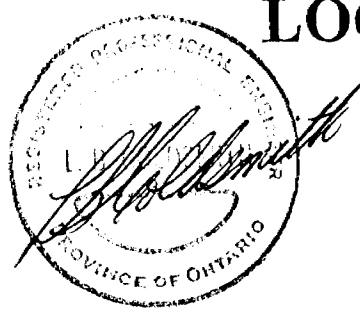

To accompany report by
LOCKE B. GOLDSMITH, P.Eng.
CONSULTING GEOLOGIST
ARCTEX ENGINEERING SERVICES
October 1990

SWEDE CREEK PROPERTY
Hemlo area, Ontario
Thunder Bay M.D.

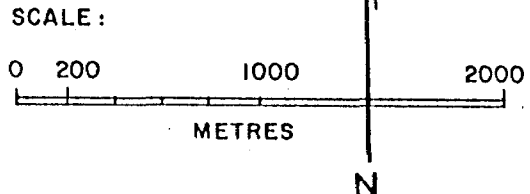
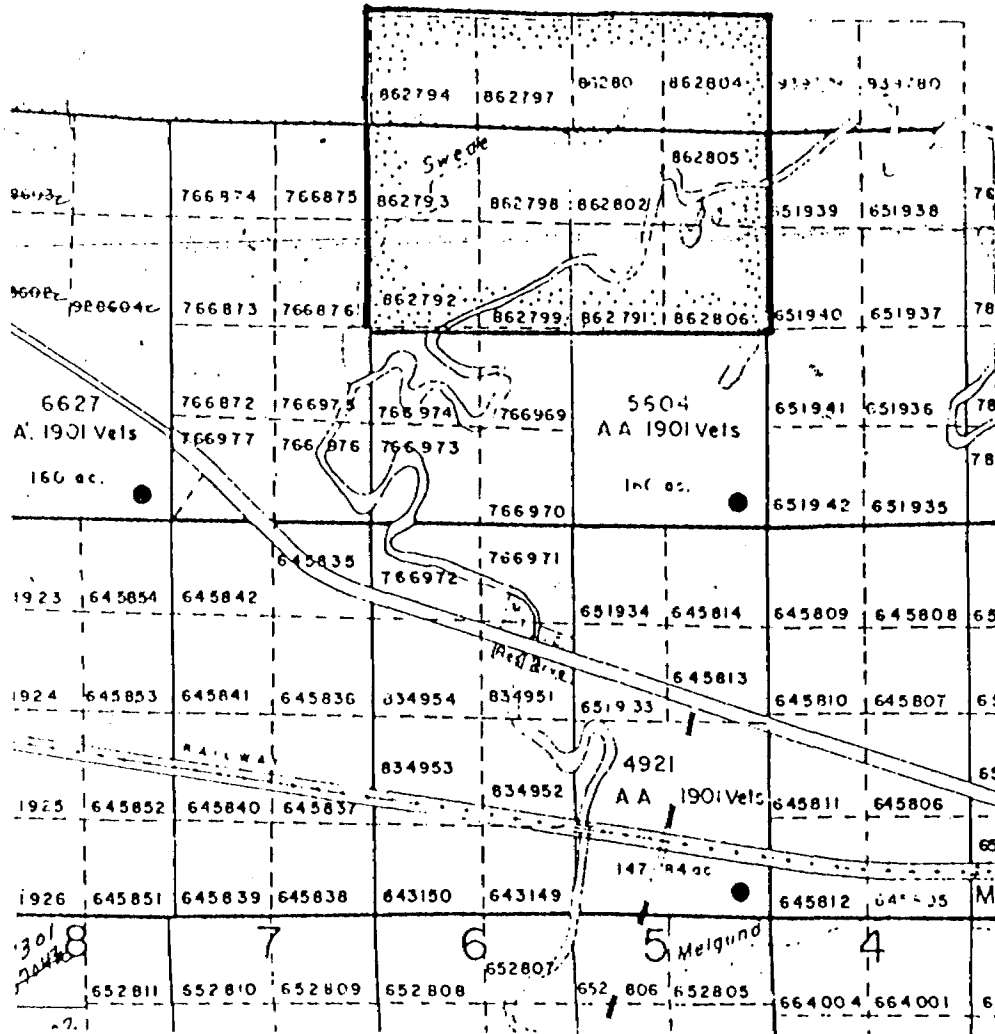

FOURSTAR
Petroleum Resources Ltd.

CLAIM MAP

Range VIII & IX, Lots 5 & 6
Pic Township, Map G630
Thunder Bay Mining Division

To accompany report by
LOCKE B. GOLDSMITH, P.Eng.
CONSULTING GEOLOGIST

ARCTEX ENGINEERING SERVICES
October 1990



SWEDE CREEK PROPERTY
Hemlo area, Ontario
Thunder Bay M.D.

A total of 370.28 metres was drilled in six holes. Twelve intervals were split and geochemically analysed for Au (ppb)-Ag (ppm)-As (ppm) by Chemex Labs Ltd. Selected specimens were deposited with the OGS core lab in Thunder Bay. Core is stored in wooden boxes at the drill sites.

DISCUSSION

Intensity of shearing and foliation (which were encountered in each hole) is much greater than has been observed in outcrop. It is inferred that the VLF-EM anomalies, which trend along topographically low linears, reflect structural discontinuities which may be splays of the Lake Superior Shear Zone. Alteration (silicification, carbonatization) is minimal, and precious metal values are not elevated.

Rocks have been structurally prepared to receive mineralization, but apparently no system has acted to introduce gold into the shear zones in the areas of drilling.

CONCLUSIONS

Shear zones which could host gold deposits are present on the claims. Drilling has been restricted to one corner of the property where overburden is relatively shallow. Geophysical patterns to the south of Swede Creek suggest that overburden is deeper and hence bedrock conditions have not been detected. Drilling fences of holes in the southern and southeastern parts of the claim block could encounter shear zones which may be mineralized.

RECOMMENDATIONS

A trial fence of holes in the vicinity of line 8+00E should be drilled between the Black River and Swede Creek. Approximately 1200 metres of drilling might be required. Sand overburden could be more than 60 metres in depth.

COST ESTIMATE

Drilling, allow	80,000
Support services	20,000
Supervision	<u>20,000</u>
	120,000
Contingencies at 20%	<u>24,000</u>
Total	<u>\$144,000</u>

Respectfully submitted,

*Locke B. Goldsmith*
Locke B. Goldsmith, P.Eng.
Consulting GeologistOctober 6, 1990
Vancouver, B.C.

ENGINEER'S CERTIFICATE
LOCKE B. GOLDSMITH

1. I, Locke B. Goldsmith, am a registered Professional Engineer in the Province of Ontario and the Northwest Territories, and a Registered Professional Geologist in the State of Oregon. My address is 301, 1855 Balsam Street, Vancouver, B.C.
2. I have a B.Sc. (Honours) degree in Geology from Michigan Technological University, a M.Sc. degree in Geology from the University of British Columbia, and have done postgraduate study in Geology at Michigan Tech and the University of Nevada. I am a graduate of the Haileybury School of Mines, and am a Certified Mining Technician. I am a Member of the Society of Economic Geologists, the AIME, and the Australasian Institute of Mining and Metallurgy, and a Fellow of the Geological Association of Canada.
3. I have been engaged in mining exploration for the past 32 years.
4. I have authored the report entitled, "Diamond Drilling, Swede Creek Property, Pic Township, Hemlo Area, Ontario", dated October 6, 1990. The report is based upon fieldwork and research supervised by the author.
5. I have no ownership in the property, nor in the stocks of Fourstar Petroleum Resources Ltd.
6. I consent to the use of this report in a prospectus, or in a statement of material facts related to the raising of funds. Sheets of analyses in the Appendix could be omitted from a prospectus because all values are plotted on maps.

Respectfully submitted,



Locke B. Goldsmith
Locke B. Goldsmith, P.Eng.
Consulting Geologist

Vancouver, B.C.
October 6, 1990

REFERENCES

- Goldsmith, L.B. 1984. Geology and rock geochemistry, Swede Creek property, Pic Township, Hemlo Area, Ontario. Prepared for Fourstar Petroleum Resources Ltd.
- Goldsmith, L.B. 1985. Magnetic and VLF-EM surveys, Swede Creek property, Pic Township, Hemlo Area, Ontario. Prepared for Fourstar Petroleum Resources Ltd.
- Goldsmith, L.B. 1988. Soil geochemical survey, Swede creek property, Pic Township, Hemlo Area, Ontario. Prepared for Fourstar Petroleum Resources Ltd.

APPENDIX

CLAIM TB 862794

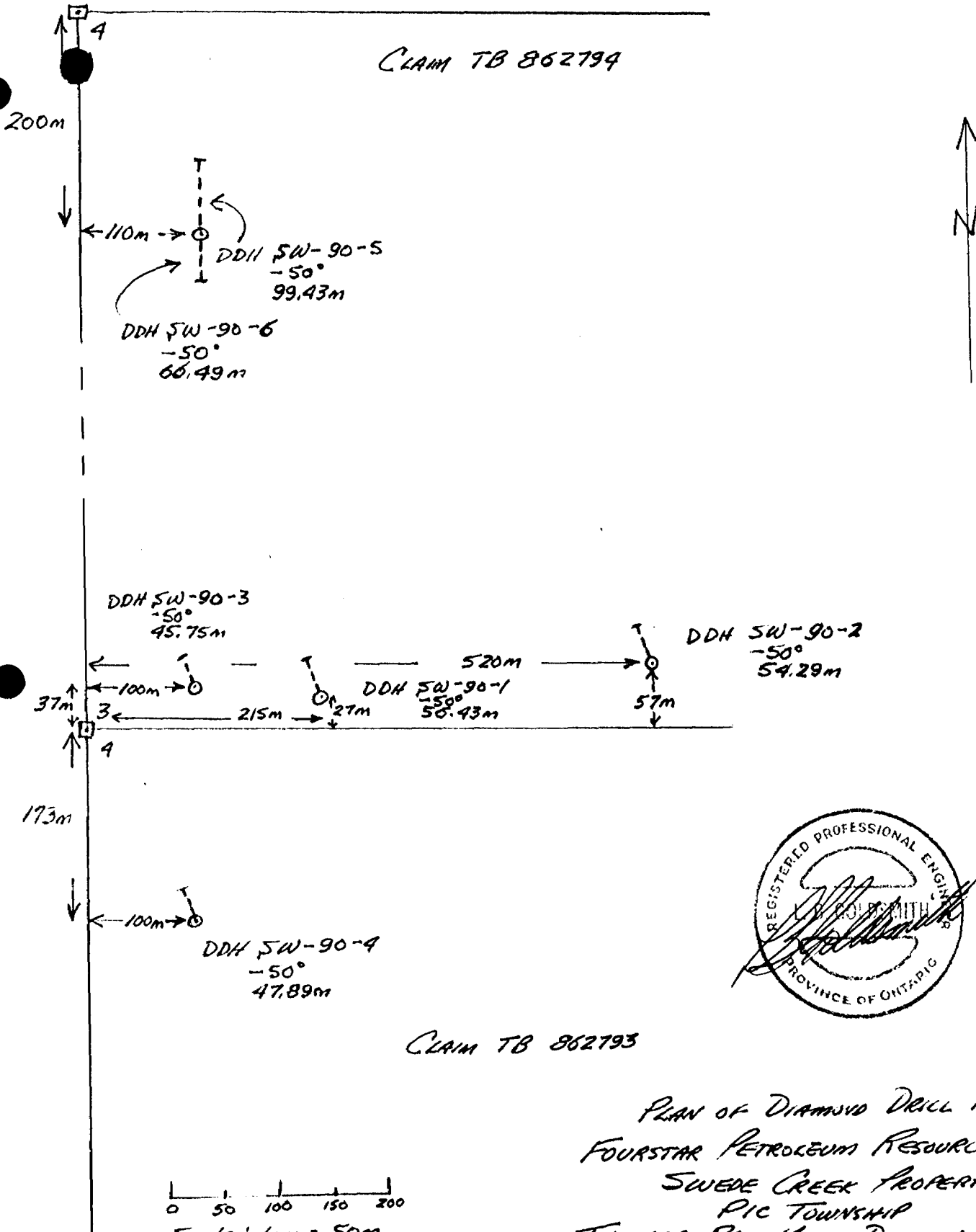

CLAIM TB 862793

PLAN OF DIAMOND DRILL HOLES
FOURSTAR PETROLEUM RESOURCES LTD.
SWEDE CREEK PROPERTY
PIC TOWNSHIP
THUNDER BAY MINING DIVISION, ONTARIO

Locke B. Goldsmith, P. Eng.
Consulting Geologist
October 5, 1990

340° ←

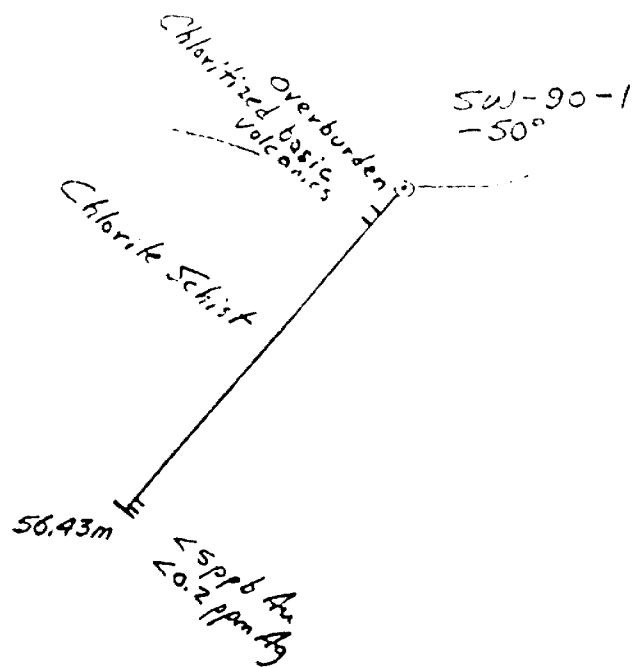

Claim TB 802799
Grid Coord: 2+15E
6+25S

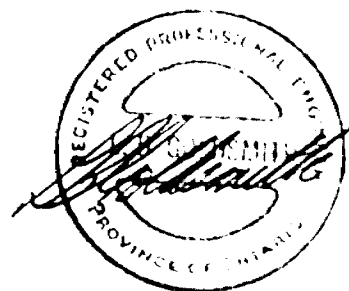

DIAMOND DRILL SECTION
FOURSTAR PETROLEUM RESOURCES LTD
SWEDE CREEK PROPERTY
PIC TOWNSHIP
THUNDER BAY MINING DIVISION, ONTARIO

Scale: 1cm = 10m
1: 1000

LOCKE B. GOLDMANN P. ENG
Consulting Geologist
October 5, 1990

340° ←

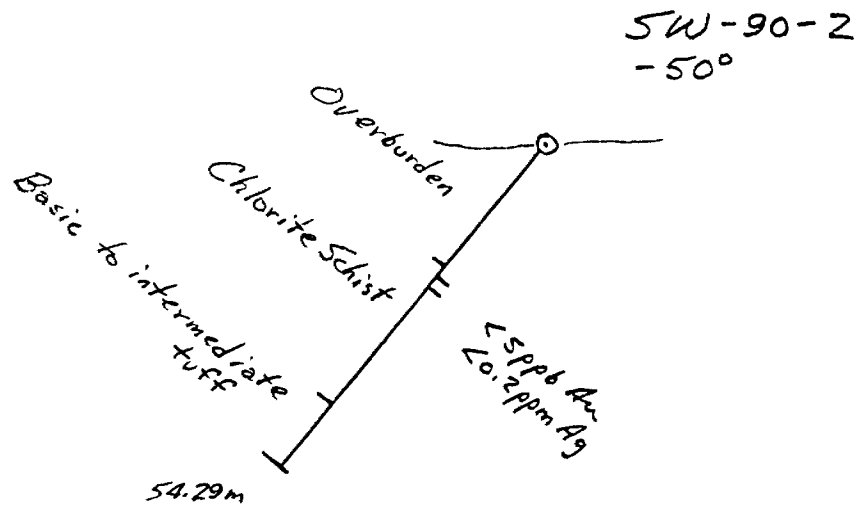

Claim TB 862794
GRID Coord: 5+20E
5+95S



DIAMOND DRILL SECTION
FOURSTAR PETROLEUM RESOURCES LTD
SWEDE CREEK PROPERTY
PIC TOWNSHIP
THUNDER BAY MINING DIVISION, ONTARIO

Scale: 1cm = 10m
1: 1000

Locke B. Goldsmith, P. Eng
Consulting Geologist
October 5, 1990

340° ←

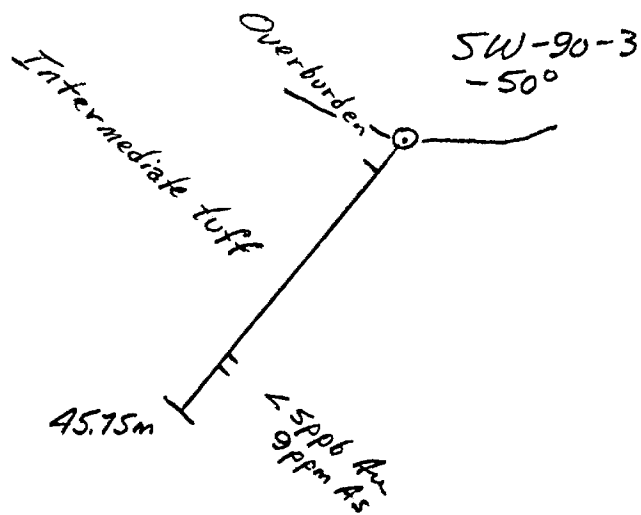

Claim TB 862794
GRID COORD: 1400E
6+15S



DIAMOND DRILL SECTION
FOURSTAR PETROLEUM RESOURCES LTD
SWEDE CREEK PROPERTY
PIC TOWNSHIP
THUNDER BAY MINING DIVISION, ONTARIO

Scale: 1cm = 10m
1: 1000

LOCKE B. GOLDSMITH, P. ENG
Consulting Geologist
October 5, 1990

340° ←

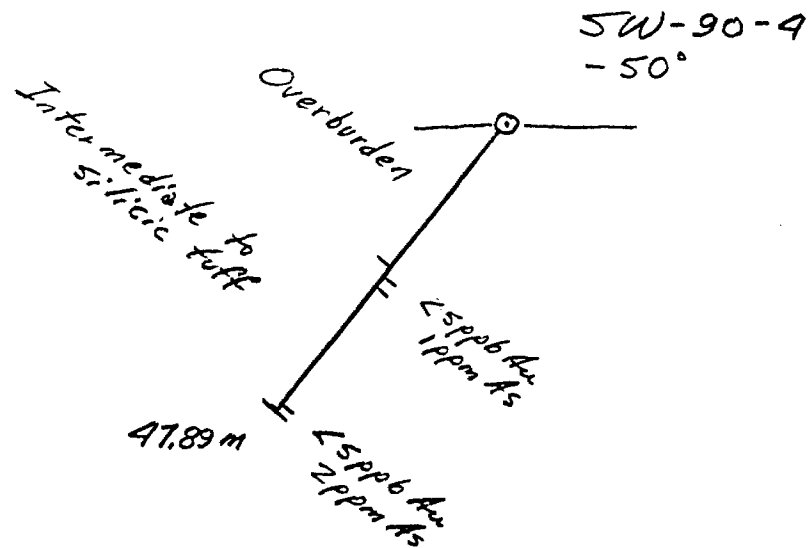

Claim TB 862793
Grid Coord: 1+00E
8+25S



DIAMOND DRILL SECTION
FOURSTAR PETROLEUM RESOURCES LTD
SWEDE CREEK PROPERTY
PIC TOWNSHIP
THUNDER BAY MINING DIVISION, ONTARIO

Scale: 1cm = 10m
1:1000

LOCKE B. GOLDSMITH P. ENG
Consulting Geologist
October 5, 1990

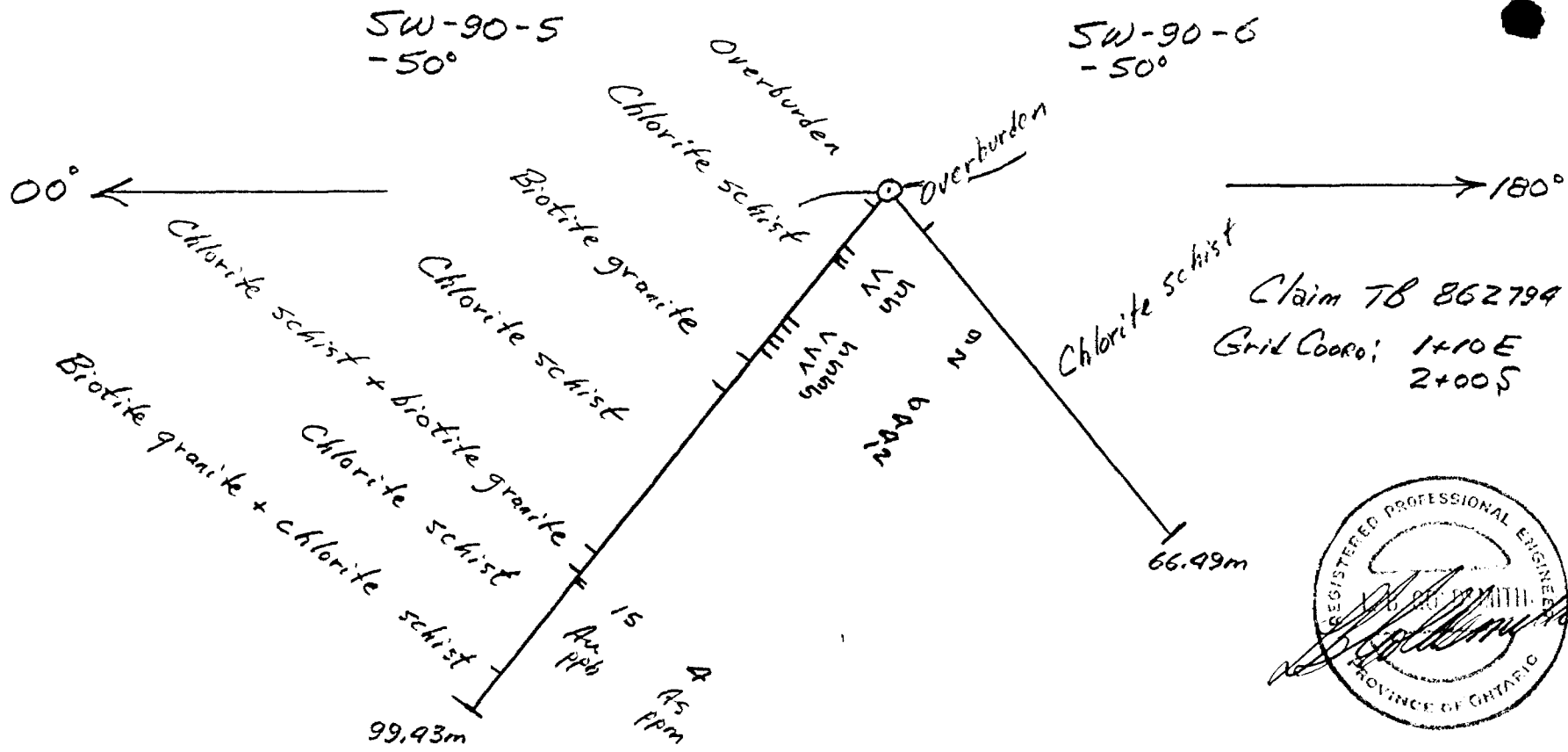

DIAMOND DRILL SECTION
 FOURSTAR PETROLEUM RESOURCES LTD
 SWEDE CREEK PROPERTY
 PIC TOWNSHIP
 THUNDER BAY MINING DIVISION, ONTARIO

Scale: 1cm = 10m
 1:1000

LOCKE B. GOLDSMITH P. ENG
 Consulting Geologist
 October 5, 1990

DIAMOND DRILL LOG
 FOURSTAR PETROLEUM RESOURCES LTD.
 SWEDE CREEK PROPERTY - PIC TOWNSHIP, HEMLO AREA
 THUNDER BAY MINING DIVISION, ONTARIO

Hole No.:	SW-90-1				Core Storage: Drill Site
Azimuth:	340°	Grid Coordinates:	2+15E	Core Size:	BO
Dip:	-50°		6+25S	Drill:	Longyear 34
Length:	56.43 m	Claim No.:	TB 862794	Contractor:	Mel Swereda
					Commenced: March 24, 1990
					Completed: March 30, 1990
					Logged By: L.B. Goldsmith

Interval, metres	From	To	Description	Au ppb	As ppm	Ag ppm
	0	4.27	Casing.			
	4.27	6.86	Chloritized basic volcanics. Lightly foliated at 60° to CA.			
	6.86	56.43	Fine-grained chlorite schist after basic to intermediate tuff. Foliated and sheared at 60° to CA. Disseminate pyrite on slip planes. 16.07 m: 2 cm pyrite in calcite. Chlorite blebs in both walls. 27.69-28.06 m: Pegmatitic quartz with minor diss. pyr. 34.77-37.82 m: Coarse-grained metatuff with pegmatitic quartz blebs. 46.36-46.82 m: Pegmatitic quartz + K-spar with chlorite patches. 53.07-56.43 m: Sericitic with diss pyrite. End of hole.			
			Sample: 54.41-55.84 m.	<5		<0.2

Specimens Submitted to OGS Core Lab

Interval, metres
 4.42 - 4.50
 11.68 - 11.77
 22.14 - 22.23
 30.68 - 30.77
 38.89 - 38.98
 46.74 - 46.82
 55.94 - 56.03

DIAMOND DRILL LOG
 FOURSTAR PETROLEUM RESOURCES LTD.
 SWEDE CREEK PROPERTY - PIC TOWNSHIP, HEMLO AREA
 THUNDER BAY MINING DIVISION, ONTARIO

Hole No.:	SW-90-2	Grid Coordinates:	5+20E	Core Size:	BO	Core Storage:	Drill Site
Azimuth:	340°			Drill:	Longyear 34	BO Commenced:	March 30, 1990
Dip:	-50°		5+95S	Contractor:	Mel Swereda	Completed:	April 5, 1990
Length:	54.29 m	Claim No.:	TB 862794			Logged By:	L.B. Goldsmith

Interval, metres		Description	Au	As	Ag
From	To		ppb	ppm	ppm
0	20.44	Casing.			
20.44	43.31	Foliated and sheared chlorite schist after basic to intermediate tuff. Folia at 50° to CA. Minor diss pyrite. Occasional quartz segregation on slip planes.			
43.31	54.29	Basic to intermediate tuff, lightly foliated at 50° to CA. Chloritic.			
		End of hole.			
		Sample: 21.96-23.49 m.	<5		<0.2

Specimens Submitted to OGS Core Lab

Interval, metres
 20.53 - 20.63
 26.35 - 26.44
 32.67 - 32.76
 38.19 - 38.28
 43.62 - 43.71
 49.11 - 49.20
 54.08 - 54.20

DIAMOND DRILL LOG
 FOURSTAR PETROLEUM RESOURCES LTD.
 SWEDE CREEK PROPERTY - PIC TOWNSHIP, HEMLO AREA
 THUNDER BAY MINING DIVISION, ONTARIO

Hole No.:	SW-90-3	Grid Coordinates:	1+00E	Core Size:	BO	Core Storage:	Drill Site
Azimuth:	340°			Drill:	Longyear 34	Commenced:	April 7, 1990
Dip:	-50°		6+15S	Contractor:	Mel Swereda	Completed:	April 10, 1990
Length:	45.75 m	Claim No.:	TB 862794			Logged By:	L.B. Goldsmith

Interval, metres			Au	As	Ag
From	To	Description	ppb	ppm	ppm
0	9.76	Casing.			
9.76	10.37	Granite boulder.			
10.37	10.68	Intermediate tuff, foliated at 40° to CA. Possibly a boulder.			
10.68	11.44	Mud + sand.			
11.44	34.74	Intermediate tuff, foliated at 40° to CA, chloritized. 12.81-12.99 m: Pegmatitic quartz. 13.05 m: Folia at 40° to CA. 13.42-13.73 m: Coarse tuff. 13.73-14.03 m: Low angle fractures. 20° to CA. 23.49-23.64 m: Mud. 23.79-24.10 m: Low angle fractures. 20° to CA. with minor cubic pyrite. 25.32-25.41 m: White quartz with K-spar pegmatite on lower contact. 28.06 m: Folia at 50° to CA. 32.79-34.62 m: 1 cm bands of K-spar alt'n. 34.62-34.74 m: Pale green silicification and pink K-spar at 60° to CA. 1 cm white quartz and K-spar in crosscutting stringer.			
34.74	45.75	Fracture zone. Foliated intermediate tuff with serpentinite and chlorite on fractures at 20-30° to CA. Disseminated pyrite + minor silicification. Moderate to intense fracturing. Very blocky. 34.74-35.99 m: chloritized basalt porphyry dyke with calcite stringers to 6 cm wide. 50° to CA. Disseminated pyrite. End of hole.			

Interval, metres			Au	As	Ag
From	To	Description	ppb	ppm	ppm

Sample: 35.99-37.52 m.

<5 9

Specimens Submitted to OGS Core Lab

Interval, metres

11.68 - 11.80

17.69 - 17.78

23.69 - 23.79

29.89 - 29.98

35.87 - 35.99

45.26 - 45.35

DIAMOND DRILL LOG
 FOURSTAR PETROLEUM RESOURCES LTD.
 SWEDE CREEK PROPERTY - PIC TOWNSHIP, HEMLO AREA
 THUNDER BAY MINING DIVISION, ONTARIO

Hole No.:	SW-90-4	Grid Coordinates:	1+00E	Core Size:	BQ	Core Storage:	Drill Site
Azimuth:	340°			Drill:	Longyear 34	BQ Commenced:	April 11, 1990
Dip:	-50°		8+25S	Contractor:	Mel Swereda	Completed:	April 12, 1990
Length:	47.89 m	Claim No.:	TB 862793			Logged By:	J.P. Goldsmith

Interval, metres	From	To	Description	Au	As	Ag
				ppb	ppm	ppm
	0	23.49	Casing.			
	23.49	23.79	Quartz at 20° to CA in foliated and feldspathic intermediate tuff.			
	23.79	47.89	Intermediate to silicic tuff. Feldspathic. Foliated at 50° to CA. Pyrite, disseminated + blebs + cubes, often with greenish epidote alt'n. Bands of K-spar or feldspathization. Chlorite on folia. Shear and elongation along foliation.			
			End of hole.			
			Samples:			
			25.01-26.54	<5	1	
			46.36-47.89 m	<5	2	

Specimens Submitted to OGS Core Lab

Interval, metres
 23.73 - 23.82
 28.37 - 28.46
 33.02 - 33.11
 37.30 - 37.42
 42.06 - 42.21
 46.27 - 46.36

DIAMOND DRILL LOG
 FOURSTAR PETROLEUM RESOURCES LTD.
 SWEDE CREEK PROPERTY - PIC TOWNSHIP, HEMLO AREA
 THUNDER BAY MINING DIVISION, ONTARIO

Hole No.:	SW-90-6	Grid Coordinates:	1+10E	Core Size:	BQ	Core Storage:	Drill Site
Azimuth:	180°			Drill:	Longyear 34	Commenced:	April 23, 1990
Dip:	-50°		2+00S	Contractor:	Mel Swereda	Completed:	April 24, 1990
Length:	66.49 m	Claim No.:	TB 862794			Logged By:	L.B. Goldsmith

Interval, metres	From	To	Description	Au	As	Ag
				ppb	ppm	ppm
	0	7.93	Casing.			
	7.93	66.49	Banded dark green to brownish biotite-chlorite schist. Round blebs of translucent white to ivory feldspar. Folia at 40° to CA. 12.2 m: Folia at 10° to CA. 11.29-15.71 m: Boundins of white quartz + feldspar. 15.71-17.63 m: White feldspar blebs. Granitized? Folia at 30° to CA. 17.63-20.44 m: Quartz + feldspar boudins to 2 cm wide. 20.44-22.27 m: White feldspar blebs. 22.63-22.80 m: " " " 23.94-24.40 m: " " " 24.40-48.19 m: Quartz + feldspar boudins. Folia at 30° to CA. 48.19-50.63 m: Ptygmatic folding. Numerous white quartz-feldspar boundins. Folia average 30° to CA. 50.63-53.57 m: Folia at 30° to CA. 53.57-53.84 m: Quartz segregation. Lesser feldspar + chlorite schist. End of hole.			

Specimens submitted to OGS Core Lab:

Interval, metres			
8.54-8.63		45.05-45.14	
15.86-15.95		54.17-54.29	
24.00-24.10		60.39-60.48	
32.82-32.94		66.22-66.31	

DIAMOND DRILL LOG
 FOURSTAR PETROLEUM RESOURCES LTD.
 SWEDE CREEK PROPERTY - PIC TOWNSHIP, HEMLO AREA
 THUNDER BAY MINING DIVISION, ONTARIO

Hole No.:	SW-90-5	Grid Coordinates:	1+10E	Core Size:	BO	Core Storage:	Drill Site
Azimuth:	000°			Drill:	Longyear 34	Commenced:	April 17, 1990
Dip:	-50°			Contractor:	Mel Swereda	Completed:	April 22, 1990
Length:	99.43 m	Claim No.:	TB 862794			Logged By:	L.B. Goldsmith

Interval, metres	From	To	Description	Au	As	Ag
				ppb	ppm	ppm
	0	3.37	Casing.			
	3.97	30.29	Banded brown to greenish-brown biotite-chlorite schist. Sheared. Boudins to 1 cm x 4 cm of quartz or quartzite. Ptygmatic folds in 1-10 cm scale. Banding and foliation at 65-75° to CA. Minor disseminated pyrite on foliation. 10.98-21.66 m: Very blocky, talcose or serpentized on fractures at 30° to CA and on foliation at 70° to CA. Less distinct banding. 12.35-12.51 m: Quartz with diss. pyrite and pyrrhotite. 21.66-28.06 m: Sericitic. 28.06-30.29 m: Granitized with bands of quartz and white feldspar. Possibly sheared granite.			
	30.29	34.83	Biotite granite. Contact foliated at 65° to CA. Sericite on foliations. Gray-white. No microcline or K-spar. Diss. pyr-pyrrh. Occasional speck chalcopyrite.			
	34.83	36.30	Sheared biotite (hornblende?) granite. Pale pink garnets from 35.69-36.30.			
	36.30	38.74	Intensely sheared and foliated granite or biotite schist with granitization. Chloritic. Occasional speck pyrite. Gands of quartz or gray granite + garnet at 70° to CA.			
	38.74	69.08	Banded brown to greenish-brown biotite-chlorite schist. Boudins of quartz + garnet to 1 cm x 6 cm. Banding and foliation at 65-75° to CA. Occasional diss. and cubic pyrite. Chlorite + serpentine on folia (shearing). 65.58 m: Folia at 55° to CA.			
	69.08	69.54	As above + quartz and white feldspar blebs and diss. pyrite.			

Interval, metres		Description	Au	As	Ag
From	To		ppb	ppm	ppm
69.54	73.26	As above + numerous bands of white biotite-sericite granite in 3 cm to 0.5 m intervals.			
73.26	92.66	Banded brown to greenish-brown biotite-chlorite schist. Scattered sericite. Foliation at 70° to CA. 74.42-74.57 m: Banded pyrrhotite iron formation. 5-10% sulphides. Occasional 0.5 to 1.0 cm bands of white granite or quartz. 80.22 m: Foliation at 75° to CA.			
92.66	94.18	White biotite + sericite granite with two 4 cm bands of biotite-chlorite schist.			
94.18	95.47	Banded biotite-chlorite schist, with occasional 4 cm band of white granite.			
95.47	96.84	White biotite + sericite granite.			
96.84	98.52	Banded biotite-chlorite schist. bands and foliation at 85° to CA.			
98.52	98.82	White biotite + sericite granite.			
98.82	99.06	Banded biotite + chlorite schist.			
99.06	99.43	White biotite + sericite granite. Occasional speck pyrite.			
		End of hole.			
		Samples:			
		10.83-12.35 m	<5	0	
		12.35-12.51 m	<5	2	
		24.10-25.62 m	<5	6	
		25.62-27.15 m	<5	4	
		27.15-28.67 m	<5	4	
		28.67-30.29 m	5	12	
		74.42-74.57 m	15	4	

Interval, metres			Au	As	Ag
From	To	Description	ppb	ppm	ppm

Specimens submitted to OGS Core Lab

Interval, metres

5.87-5.96					
14.70-14.79		61.00-61.12			
27.03-27.13		68.63-68.72			
31.20-31.29		76.16-76.25			
37.82-37.31		84.07-84.18			
45.58-45.67		91.39-91.50			
53.22-53.31		99.19-99.28			



Chemex Labs Ltd.

Analytical Chemists * Geochemists * Registered Assayers
212 Brooksbank Ave., North Vancouver
British Columbia, Canada V7J 2C1
PHONE: 604-984-0221

To: ARCTEX ENGINEERING SERVICES

506 - 540 BURRARD ST.
VANCOUVER, BC
V6C 2K1

A9014191

Comments:

CERTIFICATE

A9014191

ARCTEX ENGINEERING SERVICES

Project:
P.O. #:

Samples submitted to our lab in Mississauga, ON.
This report was printed on 25-APR-90.

SAMPLE PREPARATION

CHEMEX CODE	NUMBER SAMPLES	DESCRIPTION
205	3	Geochem ring to approx 150 mesh
294	3	Crush and split (0-10 pounds)

ANALYTICAL PROCEDURES

CHEMEX CODE	NUMBER SAMPLES	DESCRIPTION	METHOD	DETECTION LIMIT	UPPER LIMIT
100	3	Au ppb: Fuse 10 g sample	FA-AAS	5	10000
13	3	As ppm: HNO ₃ -aqua regia digest	AAS-HYDRIDE/EDL	1	10000



Chemex Labs Ltd.

Analytical Chemists * Geochemists * Registered Assayers
212 Brooksbank Ave., North Vancouver
British Columbia, Canada V7J 2C1
PHONE: 604-984-0221

To: ARCTEX ENGINEERING SERVICES

506 - 540 BARRARD ST.
VANCOUVER, BC
V6C 2K1

A9014088

Comments:

CERTIFICATE

A9014088

ARCTEX ENGINEERING SERVICES

Project:
P.O. #:

Samples submitted to our lab in Mississauga, ON.
This report was printed on 23-APR-90.

SAMPLE PREPARATION

CHEMEX CODE	NUMBER SAMPLES	DESCRIPTION
205	2	Geochem ring to approx 150 mesh Crush and split (0-10 pounds)
294	2	

ANALYTICAL PROCEDURES

CHEMEX CODE	NUMBER SAMPLES	DESCRIPTION	METHOD	DETECTION LIMIT	UPPER LIMIT
100	2	Au ppb: Fuse 10 g sample	FA-AAS	5	10000
6	2	Ag ppm: HNO ₃ -aqua regia digest	AAS-BKGD CORR	0.2	100.0



Chemex Labs Ltd.

Analytical Chemists * Geochemists * Registered Assayers
212 Brooksbank Ave., North Vancouver
British Columbia, Canada V7J 2C1
PHONE: 604-984-0221

To: ARCTEX ENGINEERING SERVICES

506 - 540 BURRARD ST.
VANCOUVER, BC
V6C 2K1

Project :
Comments:

Page Number : 1
Total Pages : 1
Invoice Date : 23-APR-90
Invoice No. : 4088
P.O. Number :

CERTIFICATE OF ANALYSIS

A9014088

SAMPLE DESCRIPTION	PREP CODE		Au ppb	Ag ppm								
			FA+AA	Aqua R								
SW-90-1	205	294	< 5	< 0.2								
SW-90-2	205	294	< 5	< 0.2								

CERTIFICATION:

Hank Buchler



Chemex Labs Ltd.

Analytical Chemists * Geochemists * Registered Assayers
212 Brooksbank Ave., North Vancouver
British Columbia, Canada V7J 2C1
PHONE: 604-984-0221

To: ARCTEX ENGINEERING SERVICES

506 - 540 BARRARD ST.
VANCOUVER, BC
V6C 2K1

Page Number : 1
Total Pages : 1
Invoice Date : 25-APR-90
Invoice No. : 14191
P.O. Number :

Project :
Comments:

CERTIFICATE OF ANALYSIS

A9014191

SAMPLE DESCRIPTION	PREP CODE	Au ppb FA+AA	As ppm								
SW-90-3-118-123	205 294	< 5	9								
SW-90-4-082-087	205 294	< 5	1								
SW-90-4-152-157	205 294	< 5	2								

CERTIFICATION : Hart Bichler



Chemex Labs Ltd.

Analytical Chemists * Geochemists * Registered Assayers
212 Brooksbank Ave., North Vancouver
British Columbia, Canada V7J 2C1
PHONE: 604-984-0221

To: ARCTEX ENGINEERING SERVICES

506 - 540 BARRARD ST.
VANCOUVER, BC
V6C 2K1

Project :
Comments:

Page Number : 1
Total Pages : 1
Invoice Date : 3-MAY-90
Invoice No. : 014688
P.O. Number :

CERTIFICATE OF ANALYSIS

A9014688

SAMPLE DESCRIPTION	PREP CODE	Au ppb FA+AA	As ppm								
SW90-5 35.5-40.5	205 294	< 5	9								
SW90-5 40.5-41.0	205 294	< 5	2								
SW90-5 79.0-84.0	205 294	< 5	6								
SW90-5 84.0-89.0	205 294	< 5	4								
SW90-5 89.0-94.0	205 294	< 5	4								
SW90-5 94.0-99.3	205 294	5	12								
-5 244.0-244.5	205 294	15	4								

CERTIFICATION

Jan H. Bickler

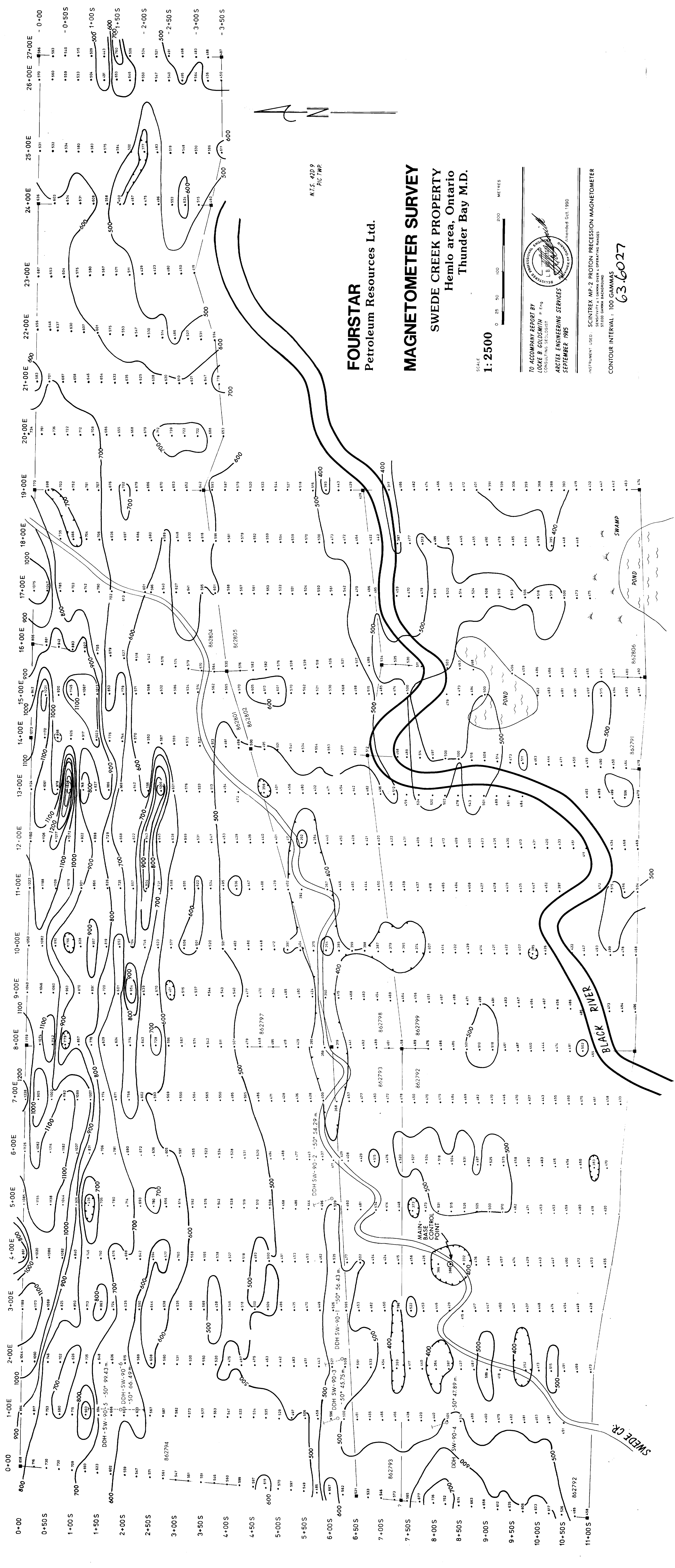

N.T.S. 429.9
P.L.C. T.M.P.

FOURSTAR
Petroleum Resources Ltd.

MAGNETOMETER SURVEY
SWEDE CREEK PROPERTY
Hemlo area, Ontario
Thunder Bay M.D.

SCALE
1:2500
0 25 50 100 200 METRES

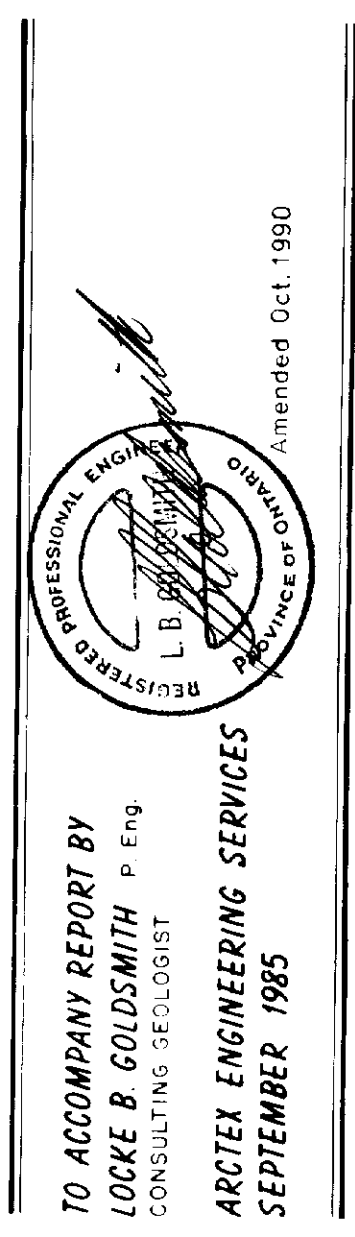

TO ACCOMPANY REPORT BY
L. E. WILSON, P. Eng.
CONSULTING ENGINEER
ARCTEC ENGINEERING SERVICES
September 1985

INSTRUMENT USED: SCINTREX MP-2 PROTON PRECISION MAGNETOMETER
FIELD DATA ACQUISITION: L. WILSON
CONTOUR INTERVAL: 100 GAMMAS

63.6027

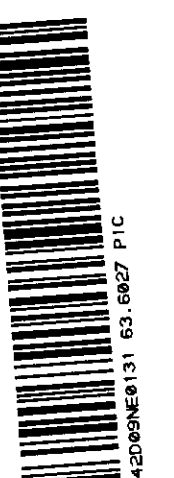

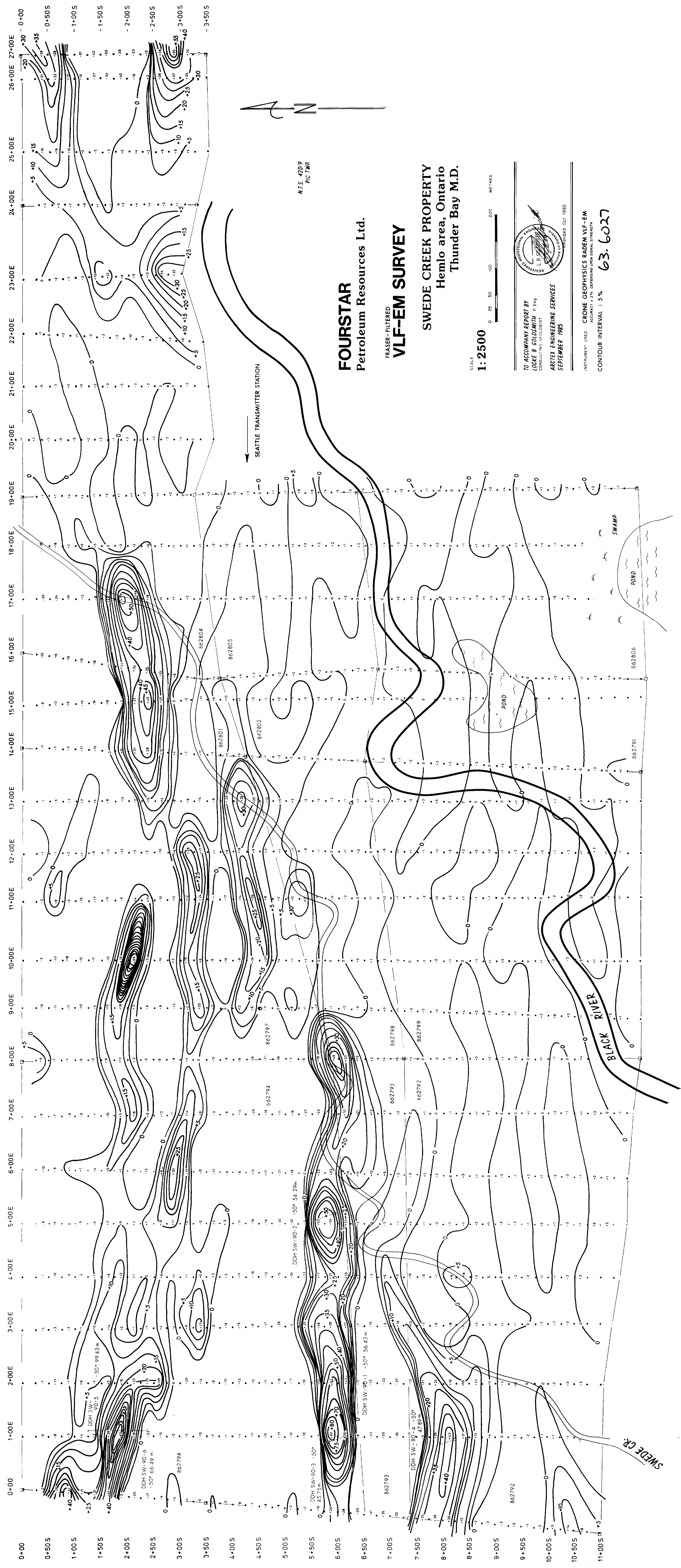

FOURSTAR
Petroleum Resources Ltd.

FRASER-FILTERED
VLF-EM SURVEY

SWEDE CREEK PROPERTY
Hemlo area, Ontario
Thunder Bay M.D.

SCALE
1:2500
0 25 50 100 200 400 METRES

TO ACCOMPANY REPORT BY
CRONE & ASSOCIATES P. ENG.
CONSULTING GEOLOGIST
ARTTEL ENGINEERING SERVICES
SEPTEMBER 1985

INSTRUMENT USED: **CRONE GEOPHYSICS BADEN VLF-EM**
ACCURACY: ± 2% DEFENDING UNIONS ONLY
CONTOUR INTERVAL: 5% **63.6027**

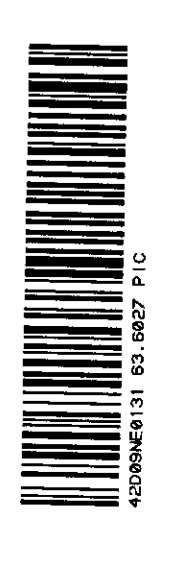



CLAIM INFORMATION
862794
CLAIM POST

KEY

.10 ppb Au
soil sample location
VALUES 5ppb NOT SHOWN.

AXES OF VIF-EM HIGHS
AXES OF MAGNETIC LOWS

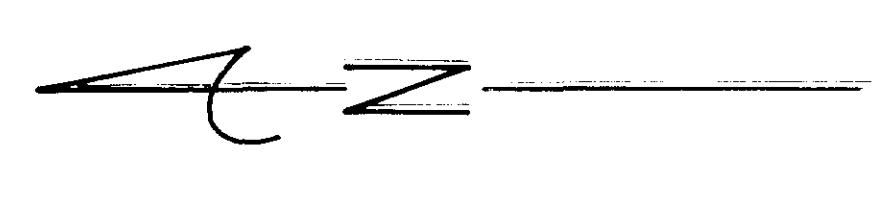

N.T.S. 625.9
P.L.C. M.P.

FOURSTAR
Petroleum Resources Ltd.

SOIL
GOLD GEOCHEMISTRY

SWEDE CREEK PROPERTY
Hemlo area, Ontario
Thunder Bay M.D.

SCALE
1:2500

0 25 50 100 200 METRES

TO ACCOMPANY REPORT BY
LOCKE B. GOLDSMITH P. Eng.
CONSULTING GEOLOGIST
ARCTEN ENGINEERING SERVICES
JULY 1998 Amended Oct. 1999

63.6027

