



42E12NE0103 2.10669 WALTERS

010

REPORT ON THE GEOLOGY
OF THE BEARSKIN (8) PROPERTY

FOR

COULSON EXPLORATION INC.

IRWIN TOWNSHIP

DISTRICT OF THUNDER BAY

RECEIVED

1987

MINING LANDS SECTION

DATE: October, 1987

BEARSKIN (8) PROPERTY

(1) LOCATION, DESCRIPTION

The Bearskin (8) Property consists of eight contiguous claims located in west central Walters Township and east central Irwin Township, N.W. Ontario. Highway 801 is situated 1 mile east of the property and connects with Trans Canada Highway 11, 5 miles to the south. The town of Jellicoe is found 13 miles south and east of the property. (Fig. 1)

The property includes the following claims:

747049 - 747056 inclusive. (Fig. 2)

(2) OWNERSHIP

The Bearskin (8) Property is owned and operated by Coulson Exploration Inc., Suite 401, 15 Toronto Street, Toronto, Ontario.

(3) EXPLORATION HISTORY

There is no known record of previous exploration activity on these claims. Several pits and trenches have been found indicating some previous work was performed. An old camp was found on the north east shore of Bearskin Lake and may have been the base for earlier work on the property.

Metalore Resources hold the property directly to the west of the Bearskin Property, which includes

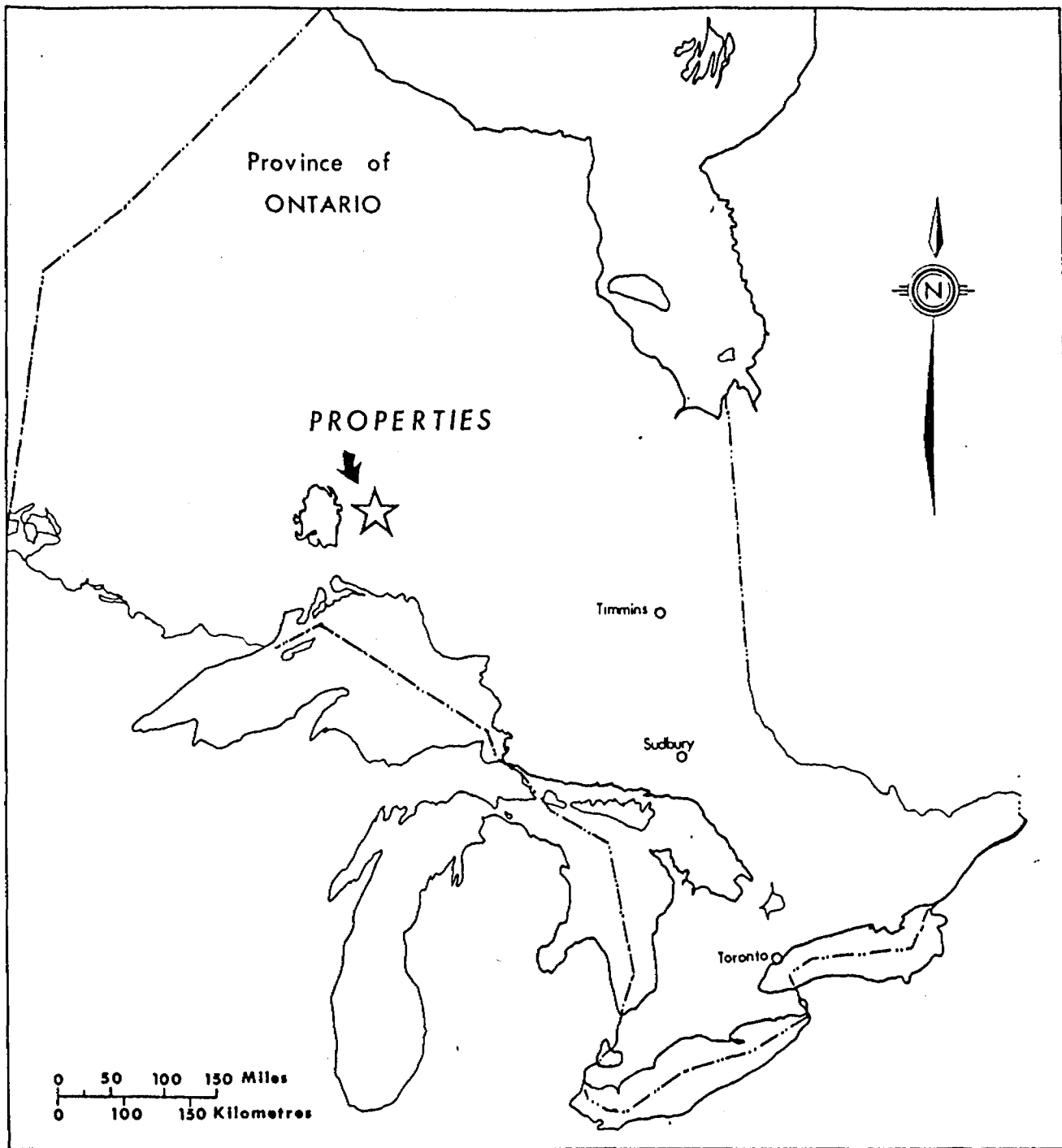
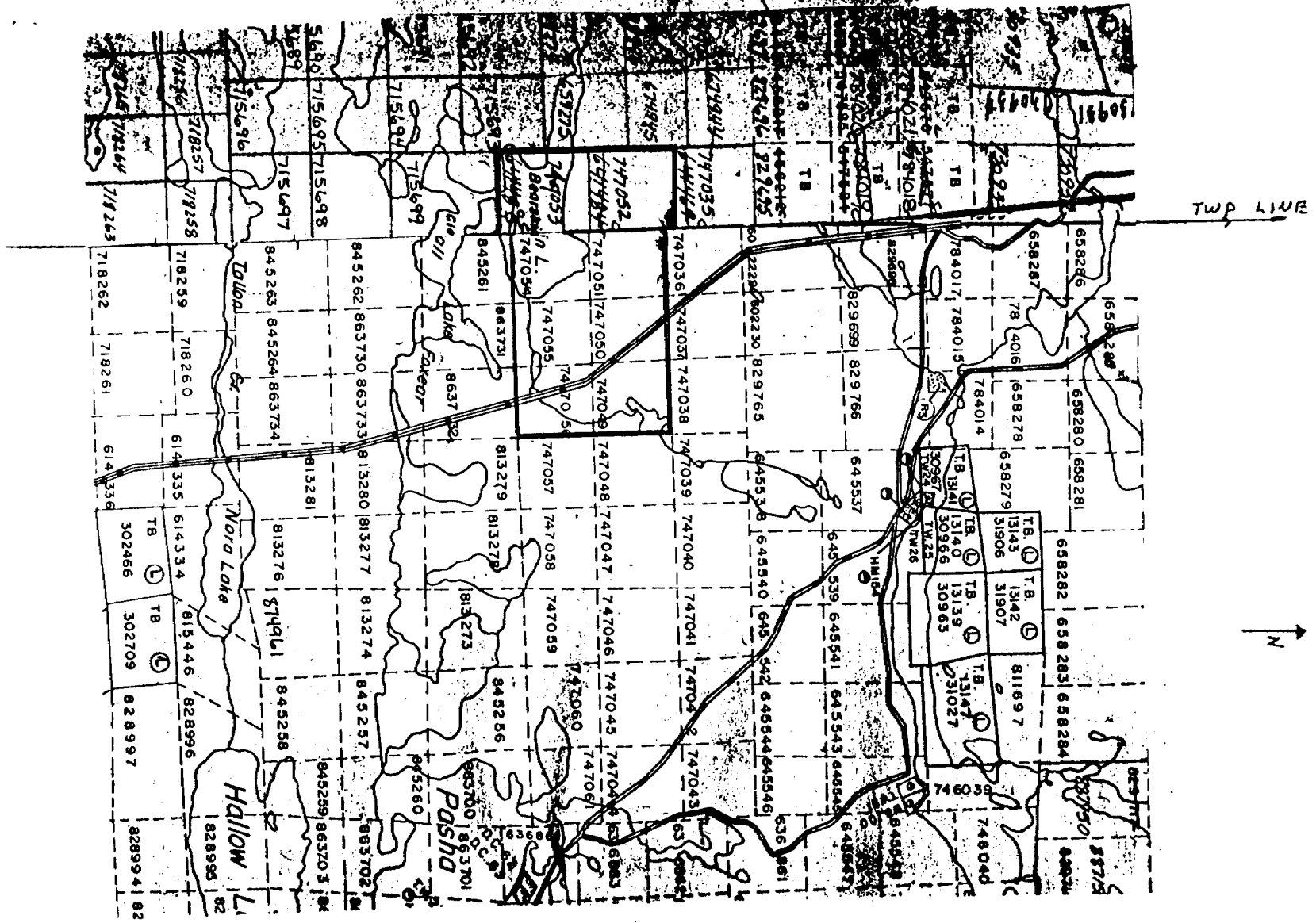

Figure 1: Location Map

Irwin Twp. (G-164)



WALTERS TWP. - G-171

FIG. 2 - CLAIM MAP
BEARSKIN (8) PROPERTY

the Brookbank zone. The Quebec Sturgeon Mine and the Brenbar Mine are 3 and 4 miles, respectively north west of this group of claims.

DESCRIPTION OF SURVEY

A grid was cut across the entire property excluding that area covered by Bearskin Lake in the south west corner. The base line bisects the property trending east-west with grid lines at 400 foot intervals. Stations are located every 100 feet along the lines. A total of 5.3 miles of line was cut.

These lines were used for control in the course of the geological survey. Several thousand square feet of bulldozer stripping are also located on the map included with this report.

GEOLOGY

The geology of the Bearskin Property is characterized by massive, medium to fine grained mafic volcanic flows. These units are rarely fractured and foliated. A single horizon of pillowed flow was noted in the north central portion of the block striking east northeast. These pillows were moderately stretched with epidotized selvages. A ridge just north of these pillowed flows consists of an andesite or silicified basalt. This unit strikes east northeast.

Two outcrops of chlorite sericite and carbonate schist were located in the south eastern corner of the group. Schistosity strikes 090° to 100° and dips 75° to the north. A crenulation cleavage was developed in the rock plunging 42° west.

Several quartz veins were located in the bulldozer stripping and in an old trench. These we found within a central east-west corridor, north and south of the baseline. The quartz veins are typically one to two feet wide, milky white in colour with occasional sulphide mineralization. On Line 8W, 100N an old blasted trench contains an east-west trending quartz vein with pyrite and chalcopyrite mineralization.

Epidote was noted in several outcrops throughout the property. Epidote occurred as vein material and fracture filling as well as a weak to moderate alteration of the matrix. Potassium feldspar was found in several outcrops as well. This occurred mainly as vein material associated with quartz veinlets but also as a weak alteration adjacent to the veining. Occasionally both epidote and K-spar were found in the same rock giving it a distinctive pink and green colour.

CONCLUSIONS

The Bearskin (8) Claim Group shows considerable potential for gold mineralization. The schistose rock located in the southeast corner of the group indicates the

close proximity of a major structural break along the volcanic-sedimentary contact. These faults and associated deformation zones are significant factors in gold mineralization within the Beardmore-Geraldton belt. The crenulation cleavage noted in the southeast corner indicates a second deformation regime separate from the original break.

The epidote and potassium feldspar enrichment may be a result of early syngenetic fumarolic activity as mentioned by W. O. Mackasey (1976), but it is believed to be a result of epigenetic-hydrothermal activity. The presence of the enrichment within fractures and with quartz veining suggests a later syn to post-tectonic emplacement. The major break, that passes through Bearskin Lake and the southern portion of the property, may, in fact, be the source of the enrichment and/or provide the mechanism to release epidote and potassium feldspar rich metamorphic fluid in the local rock. Potassium feldspar enrichment has been found to be a significant component within the ore body of Metalore Resources' Brookbank zone.

The central corridor of quartz veining indicates further, the extent of hydrothermal fluid activity in the group. The narrow zone of ubiquitous veining may indicate an area of weakness caused by normal tensional forces or parallel compression or shear. By any means, their presence and associated sulphides is an encouraging sign for gold mineralization.

All in all, the Bearskin (8) Group contains many of the ingredients for a substantial gold deposit and thus warrants a more extensive investigation.

REFERENCES

Mackasey, W. O.

- 1975 Geology of Dorthea, Sandra and Irwin Townships, District of Thunder Bay; Ontario Department of Mines, Geoscience Report 122,83 p. Accompanied by Map 2294, scale 1 inch to 1/4 mile.
- 1976 The Geology of Walters and Leduc Township, District of Thunder Bay; Ontario, Division Mines, GR 149, 60 p. Accompanied by Map 2373; scale 1 inch to 1/2 mile.

CERTIFICATION

The Report and Map was prepared jointly with Warren G. Wade and, Frederick J. Swanson, and Jeffrey S. Ackert.

I HEREBY CERTIFY THAT:

- (a) I am a qualified geologist possessing a Bachelor of Science Degree in Geology obtained from the University of Toronto, where I graduated in 1985.
- (b) My residences and offices are located at 117 Parkside Drive, Toronto, Ontario. M6R 2Y8.
- (c) I have practised my profession as a geologist since graduation in 1985.
- (d) This report is based on personal knowledge gained from property visits.
- (e) To the best of my knowledge, all of the information contained above and within the pages of this report is factual, correct and true.

DATE:

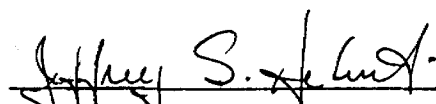
Jeffrey S. Ackert, B.Sc.

CERTIFICATION

I HEREBY CERTIFY THAT:

- (a) I am a qualified geologist possessing a Bachelor of Science Degree in Geological Sciences from Brock University where I graduated in 1983.
- (b) I have practised as a geologist since 1983.
- (c) My residence and offices are located at 915 Sweetwater Crescent, Mississauga, Ontario.
- (d) This report is based on personal knowledge gained from property visits.
- (e) To the best of my knowledge all the information above and within the report is factual, correct and true.

DATE:

Warren G. Wade

Warren G. Wade, B.Sc.

Jul 2 1996

CERTIFICATION

I HEREBY CERTIFY THAT:

- (a) I am a qualified geologist possessing a Bachelor of Science Degree in Geological Sciences from Brock University where I graduated in 1984.
- (b) That I have practised as a geologist since that time.
- (c) My residence and offices are located at 351 Book Rad, Grimsby, Ontario.
- (d) This report is based on personal knowledge gained from property visits.
- (e) To the best of my knowledge, all of the information contained above and within the report is factual, correct and true.

DATE:

Frederick J. Swanson, B.Sc.



Ontario

Ministry of
Northern Development
and Mines

Ministère du
Développement du Nord
et des Mines



42E12NE0103 2.10669 WALTERS

900

June 20, 1988

Your File: W8804-209
Our File: 2.10669

Mining Recorder
Ministry of Northern Development and Mines
435 James Street South
P.O. Box 5000
Thunder Bay, Ontario
P7C 5G6

Dear Madam:

Re: Notice of Intent dated May 27, 1988
Geological Survey
submitted on Mining Claims TB 757053-54
in the Township of Irwin and Walters

The assessment work credits, as listed with the above-mentioned Notice of Intent, have been approved as of the above date.

Please inform the recorded holder of these mining claims and so indicate on your records.

Yours sincerely,

W.R. Cowan, Manager
Mining Lands Section
Mines & Minerals Division

Whitney Block, Room 6610
Queen's Park
Toronto, Ontario
M7A 1W3

Telephone: (416) 965-4888

SH:p1
Enclosure: Technical Assessment Work Credits

cc: Mr. G.H. Ferguson
Mining and Lands Commissioner
Toronto, Ontario

Resident Geologist
Thunder Bay, Ontario

Mr. Hugh Coulson
Box 300
Beardmore, Ontario
POT 1G0

Recorded Holder
Hugh Coulson

Township ~~XXXXX~~
Irwin and Walters

Type of survey and number of Assessment days credit per claim	Mining Claims Assessed
Geophysical Electromagnetic _____ days Magnetometer _____ days Radiometric _____ days Induced polarization _____ days Other _____ days Section 77 (19) See "Mining Claims Assessed" column Geological <u>0</u> _____ days Geochemical _____ days Man days <input checked="" type="checkbox"/> Airborne <input type="checkbox"/> Special provision <input type="checkbox"/> Ground <input checked="" type="checkbox"/> <input type="checkbox"/> Credits have been reduced because of partial coverage of claims. <input type="checkbox"/> Credits have been reduced because of corrections to work dates and figures of applicant.	TB-947053-54

Special credits under section 77 (16) for the following mining claims

No credits have been allowed for the following mining claims

not sufficiently covered by the survey insufficient technical data filed

- No credits approved as work previously submitted and approved on January 25, 1988.

The Mining Recorder may reduce the above credits if necessary in order that the total number of approved assessment days recorded on each claim does not exceed the maximum allowed as follows: Geophysical - 80; Geological - 40; Geochemical - 40; Section 77(19) - 60.



Ministry of Northern Development and Mines

Report of Work
(Geophysical, Geological, Geochemical and Expenditures)

DOCUMENT No. *209*
W8804

Field Management
Instructions: - Please type or print.
- If number of mining claims traversed exceeds space on this form, attach a 2nd sheet.
Note: - Only days credits calculated in the "Expenditures" section may be entered in the "Expend. Days Cr." columns.
- Do not use shaded areas below.

2,10669 Mining Act

Type of Survey(s) **Geological** Township **644**
 Claim Holder(s) **HUGH COULSON** Prospector's Licence No. **A45563**
 Address **Box 300 Beardmore ONT POTIGO**
 Survey Company **COULSON EXPLORATION** Date of Survey (from & to) _____ Total Miles of line Cut _____
 Name and Address of Author (of Geo-Technical report) **JEFF ACKERT**

Credits Requested per Each Claim in Columns at right

Special Provisions	Geophysical	Days per Claim
For first survey: Enter 40 days. (This includes line cutting)	- Electromagnetic	
	- Magnetometer	
	- Radiometric	
	- Other	
For each additional survey: using the same grid: Enter 20 days (for each)	- Other	
	Geological	
	Geochemical	
Man Days Complete reverse side and enter total(s) here	- Electromagnetic	
	- Magnetometer	
	- Radiometric	
	- Other	
	Geological	12.5
	Geochemical	
Airborne Credits Note: Special provisions credits do not apply to Airborne Surveys.	Electromagnetic	
	Magnetometer	
	Radiometric	

Mining Claims Traversed (List in numerical sequence)

Mining Claim			Mining Claim		
Prefix	Number	Expend. Days Cr.	Prefix	Number	Expend. Days Cr.
76	441052	*			
	053				
	051	*			
	054				
	050	*			
	055	*			
	049	*			
	050	*			

RECEIVED THUNDER BAY MINING DIVISION '88 MAR 24 PM 4 30

RECEIVED APR 8 1988

Expenditures (excludes power stripping)

Type of Work Performed _____
 Performed on Claim(s) _____

Calculation of Expenditure Days Credits

Total Expenditures \$ _____ ÷ 15 = Total Days Credits _____

Instructions
Total Days Credits may be apportioned at the claim holder's choice. Enter number of days credits per claim selected in columns at right.

Date **Mar 22 1988** Recorded Holder or Agent (Signature) *[Signature]*

* Maximum Geological Credits used

Total number of mining claims covered by this report of work. **2**

For Office Use Only
 Total Days Cr. Recorded **25** Date Recorded **March 24, 1988**
 Mining Recorder **Catherine J. Allan**
 Branch Director *[Signature]*
 See *[Signature]* work statement.

Certification Verifying Report of Work

I hereby certify that I have a personal and intimate knowledge of the facts set forth in the Report of Work annexed hereto, having performed the work or witnessed same during and/or after its completion and the annexed report is true.

Name and Postal Address of Person Certifying **HUGH COULSON**

Assessment Work Breakdown

Man Days are based on eight (8) hour Technical or Line-cutting days. Technical days include work performed by assistants, draftsmen, etc..

Type of Survey												
Technical Days	X	7	=	Technical Days Credits	+	Line-cutting Days	=	Total Credits	+	No. of Claims	=	Days per Claim
12				84		16		100		8		12.5

Type of Survey												
Technical Days	X	7	=	Technical Days Credits	+	Line-cutting Days	=	Total Credits	+	No. of Claims	=	Days per Claim

Type of Survey												
Technical Days	X	7	=	Technical Days Credits	+	Line-cutting Days	=	Total Credits	+	No. of Claims	=	Days per Claim

Type of Survey												
Technical Days	X	7	=	Technical Days Credits	+	Line-cutting Days	=	Total Credits	+	No. of Claims	=	Days per Claim



Ministry of
Northern Development
and Mines

Ontario

Ministère du
Développement du Nord
et des Mines

January 25, 1988

Your File: 534 & 535
Our file: 2.10669

Mining Recorder
Ministry of Northern Development and Mines
435 James Street South
P.O. Box 5000
Thunder Bay, Ontario
P7C 5G6

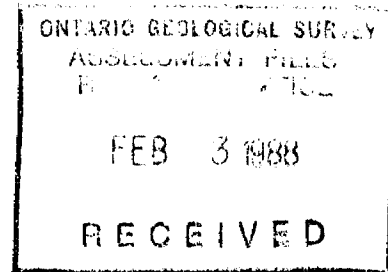

Dear Madam:

RE: Notice of Intent dated January 5, 1988
Geological Survey submitted on Mining Claims
TB 747049 et al in the Townships of Irwin and Walters

The assessment work credits, as listed with the above-mentioned
Notice of Intent, have been approved as of the above date.

Please inform the recorded holder of these mining claims and so
indicate on your records.

Yours sincerely,

W.R. Cowan, Manager
Mining Lands Section
Mines and Minerals Division

Whitney Block, Room 6610
Queen's Park
Toronto, Ontario
M7A 1W3

Telephone: (416) 965-4888

DK:p1

Enclosure: Technical Assessment Work Credits

cc: Mr. G.H. Ferguson
Mining & Lands Commissioner
Toronto, Ontario

Resident Geologist
Thunder Bay, Ontario

Mr. Hugh Coulson
62 Wellesley Street West
Toronto, Ontario
M5S 2X3



Recorded Holder
H. Coulson

Township or ~~XXX~~
Irwin and Walters

Type of survey and number of Assessment days credit per claim	Mining Claims Assessed
Geophysical Electromagnetic _____ days Magnetometer _____ days Radiometric _____ days Induced polarization _____ days Other _____ days Section 77 (19) See "Mining Claims Assessed" column Geological <u>40</u> days Geochemical _____ days Man days <input type="checkbox"/> Airborne <input type="checkbox"/> Special provision <input checked="" type="checkbox"/> Ground <input checked="" type="checkbox"/> <input type="checkbox"/> Credits have been reduced because of partial coverage of claims. <input type="checkbox"/> Credits have been reduced because of corrections to work dates and figures of applicant.	TB 747049 to 51 inclusive 747055-56 747052

Special credits under section 77 (16) for the following mining claims

10 Days Geological
TB 747053 - 54

No credits have been allowed for the following mining claims

not sufficiently covered by the survey insufficient technical data filed

The Mining Recorder may reduce the above credits if necessary in order that the total number of approved assessment days recorded on each claim does not exceed the maximum allowed as follows: Geophysical - 80; Geological - 40; Geochemical - 40; Section 77(19) - 60.

534
2.10669
Mining Act

Instructions: - Please type or print
- If number of mining claims traversed exceeds space on this form, attach a list.
Note: - Only days credits calculated in the "Expenditures" section may be entered in the "Expend. Days Cr." columns.
- Do not use shaded areas below.

File: 747049

Type of Survey(s): **Geological MAPPING** Township or Area: **WALTERS. (G171)**
 Claim Holder(s): **HUGH COULSON** Prospector's Licence No.:
 Address: **62 WELLESLEY ST. WEST TORONTO M5S 2X3**
 Survey Company: **COULSON EXPLORATION INC** Date of Survey (from & to):
 Day Mo. Yr. Day Mo. Yr. Total Miles of line Cut:
15 10 87 22 10 87
 Name and Address of Author (of Geo-Technical report):
JEFF ACKART 117 PARKSIDE DR. TORONTO ONT M6R 2Y8

Credits Requested per Each Claim in Columns at right

Special Provisions	Geophysical	Days per Claim
For first survey: Enter 40 days. (This includes line cutting)	- Electromagnetic	
	- Magnetometer	
For each additional survey: using the same grid: Enter 20 days (for each)	- Radiometric	
	- Other	
	Geological	40
	Geochemical	
Man Days	Geophysical	Days per Claim
Complete reverse side and enter total(s) here	- Electromagnetic	
	- Magnetometer	
	- Radiometric	
	- Other	
	Geological	
	Geochemical	
Airborne Credits	Geophysical	Days per Claim
Note: Special provisions credits do not apply to Airborne Surveys.	- Electromagnetic	
	- Magnetometer	
	- Radiometric	

Mining Claims Traversed (List in numerical sequence)

Mining Claim		Expend. Days Cr.	Mining Claim		Expend. Days Cr.
Prefix	Number		Prefix	Number	
	747049				
	50				
	51				
	747054				
	55				
	56				

RECEIVED

NOV 02 1987

MINING LANDS SECTION

THUNDER BAY MINING DIVISION
RECEIVED
OCT 27 1987
AM 7 18 9 10 11 12 1 2 3 4 5 6 PM

Expenditures (excludes power stripping)

Type of Work Performed:
Performed on Claim(s):

Calculation of Expenditure Days Credits

Total Expenditures: \$ ÷ 15 = Total Days Credits

Total number of mining claims covered by this report of work: **6**

Instructions: Total Days Credits may be apportioned at the claim holder's choice. Enter number of days credits per claim selected in columns at right.

Date: **Oct 26 87** Recorded Holder or Agent (Signature): *[Signature]*

For Office Use Only

Total Days Cr. Recorded: **240** Date Recorded: **Oct 27 1987** Mining Recorder: *[Signature]*
 Date Approved as Recorded: _____ Branch Director: _____

I hereby certify that I have a personal and intimate knowledge of the facts set forth in the Report of Work annexed hereto, having performed the work or witnessed same during and/or after its completion and the annexed report is true.

Name and Postal Address of Person Certifying: **HUGH COULSON**
Box 300 BEARINORD ONT Date Certified: **Oct 26 87** Certified by (Signature): *[Signature]*

Elmhirst Twp.(G - 162)

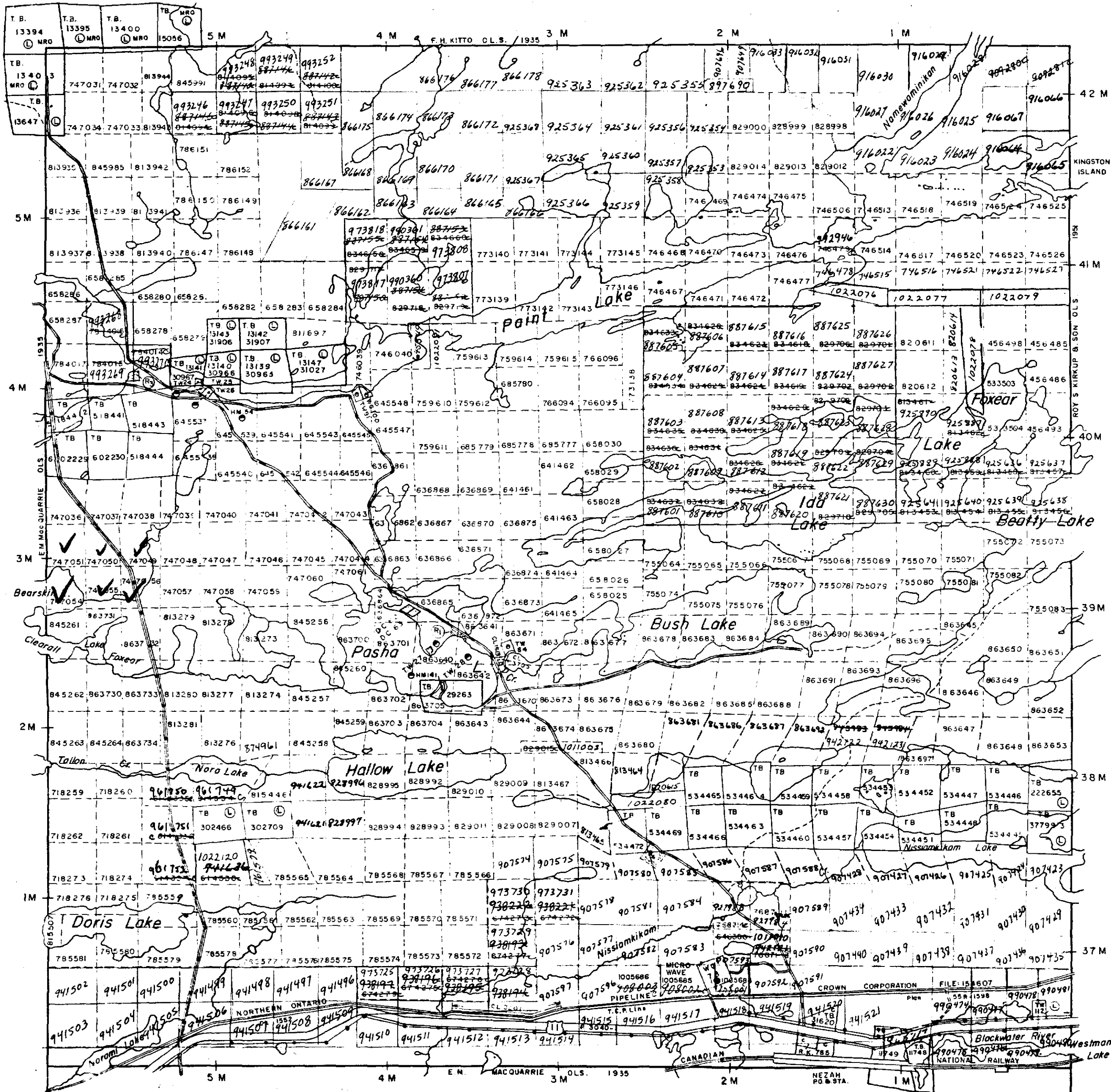

AREAS WITHDRAWN FROM

Description	Order No.	Date	Drawn By
(R) M.N.R. RES.			
(R) SEC 36/80	W 14/8	9/11/91	S.
(R) SEC. 36/80	W.N.C.R. 23/84		S.R.

LEGEND

- PATENTED LAND (P)
- CROWN LAND SALE (C.S.)
- LEASES (L)
- LOCATED LAND (Loc.)
- LICENSE OF OCCUPATION (L.O.)
- MINING RIGHTS ONLY (M.R.)
- SURFACE RIGHTS ONLY (S.R.O.)
- ROADS
- IMPROVED ROADS
- KING'S HIGHWAYS
- RAILWAYS
- POWER LINES
- MARSH OR MUSKEG
- MINES
- CANCELLED
- PATENT, SURFACE & MINING RIGHTS (---)
- SURFACE RIGHTS ONLY (---)

SCALE: 1 INCH = 40 CHAINS

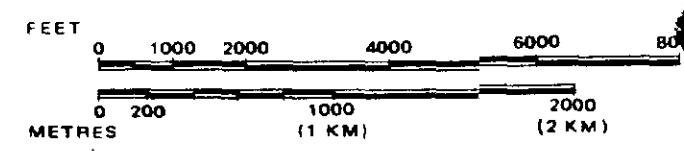

TOWNSHIP OF
WALTERS
 M.N.R. ADMINISTRATIVE DISTRICT
NIPIGON
 MINING DIVISION
THUNDER BAY
 LAND TITLES / REGISTRY DIVISION
THUNDER BAY

Ministry of Land Management
 Natural Resources Branch
 Ontario
 December 10, 1985

February, 1981

G-17 T

Irwin Twp. (G - 164)

Leduc Twp. (G - 169)

Vincent Twp.(G - 163)

PIFHER TWP. - G-141

TOWNSHIP

IRWIN

M.N.R. ADMINISTRATIVE DISTRICT

NIPIGON

MINING DIVISION & GERALDTON

THUNDER BAY

LAND TITLES / REGISTRY DIVISION

THUNDER BAY

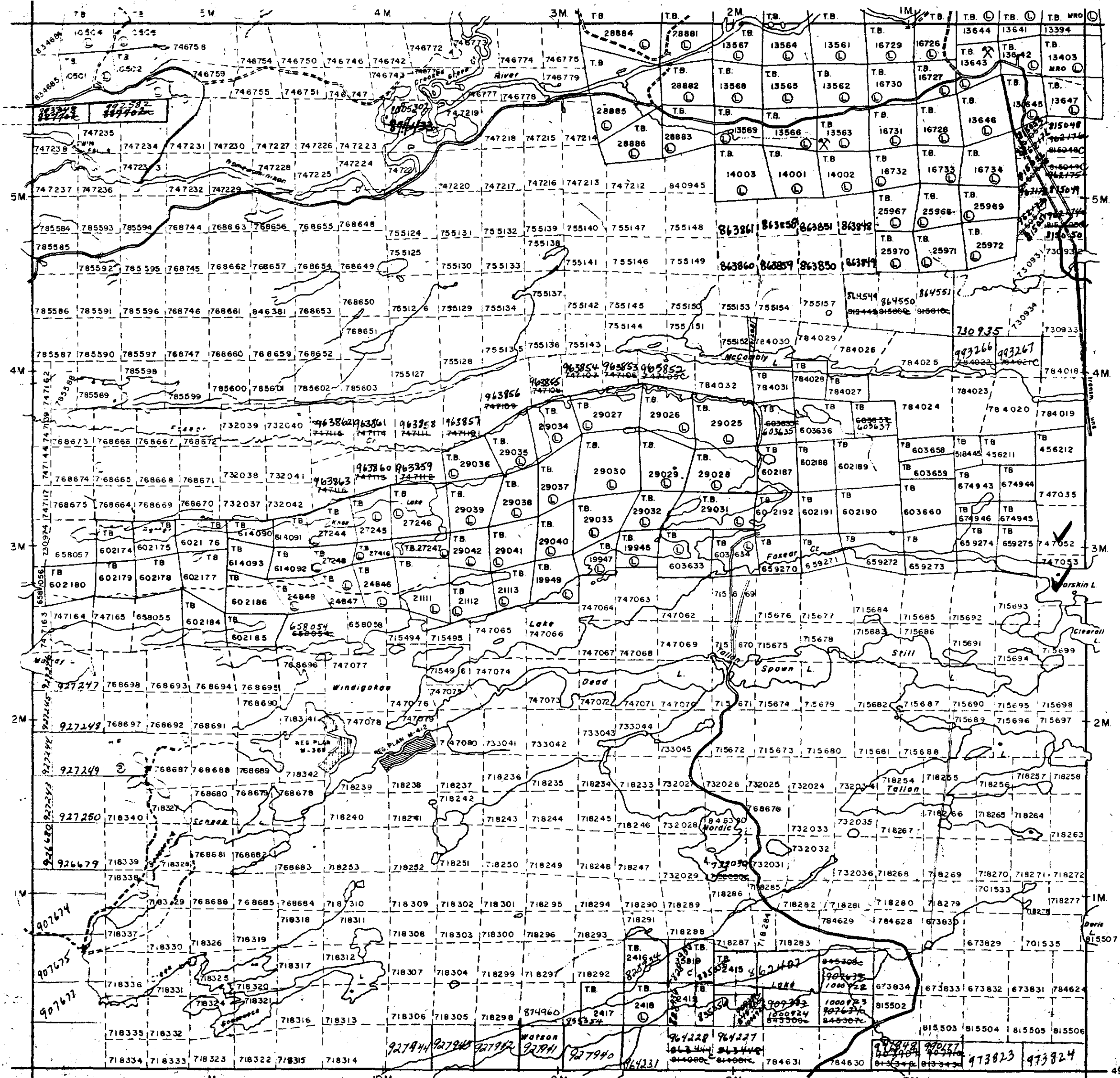

SANDRA TWP. - G-167

WALTERS TWP. - G-171

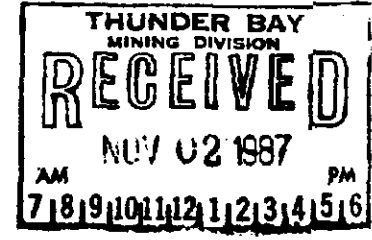

LEGEND

- PATENTED LAND (P or ●*)
- PATENTED FOR SURFACE RIGHTS ONLY (●*)
- LEASE (L)
- LICENSE OF OCCUPATION (L.O.)
- CROWN LAND SALES (C.S.)
- LOCATED LAND (Loc.)
- CANCELLED (C.)
- MINING RIGHTS ONLY (M.R.O.)
- SURFACE RIGHTS ONLY (S.R.O.)
- HIGHWAY & ROUTE NO. (17)
- ROADS (—)
- TRAILS (---)
- RAILWAYS (—+—)
- POWER LINES (—+—+—)
- MARSH OR MUSKEG (—+—+—)
- MINES (X)

*used only with summer resort locations or when space is limited

SCALE: 1 INCH = 40 CHAINS

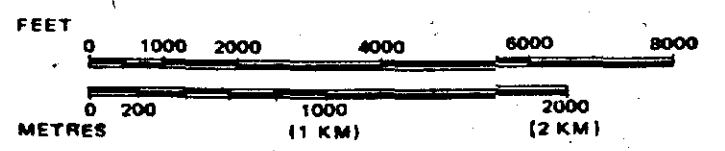

Ministry of Natural Resources
Land Management Branch

Ontario Nov 1, 1985

Date FEBRUARY 6th, 1981

Number

G-164

McCOMBER TWP. - G-166



