



2.17384

ELMHIRST TOWNSHIP

GOLD PROSPECT

RECEIVED
JUN 12 1997
MINING LANDS BRANCH

PROPERTY LOCATION

Elmhirst Township
Beardmore - Geraldton District
Thunder Bay Mining Division

Claim Map G161
NTS 42E13/SE
Latitude 49°47' Longitude 87°40'

David Kindla

Box 104,
Beardmore, Ontario. P0T 1G0

*Qual #
2.17384*

CLAIM NUMBERS

TB1209268 (8 units)

TB1209269 (3 units)

TB1204930 (1 unit)

TB1204931 (1 unit)

TB1204933 (4 units)

Total 5 claims, 17 units

ACCESS

The property is located northeast of Beardmore. Travel east from Beardmore on Highway #11 for 15 miles then north on secondary Highway #801 for 8 miles, then northeast on a lumber road for about 5 miles. This road runs through the northeast corner of the claim.

A new logging road intersects the main road at this corner and progresses SW through the claim group.

PROSPECTING TARGETS

Commodity: Main Au: Secondary: Cu, Pb, Zn

DEPOSIT TYPE & GEOLOGY

The project area is completely within the Coyle Lake Stock, granite granodiorite. The contact with the intermediate to felsic metavolcanics to the north are just south of the Sturgeon river and are within the north-east corner of the claim group. The wide gold bearing quartz vein east of East Coyle Lake is on a north-east trending break possibly coming up from the main regional Paint Lake fault. This vein is hosted by a medium to coarse grained quartz diorite or granodiorite. An intensely sheared intermediate volcanic lies along the north contact of the vein. The quartz vein is well fractured with considerable malachite staining throughout. Fine disseminated chalcopyrite is found periodically throughout the vein and in some places the chalcopyrite occurs in massive blebs and seams. Some coarse patches of pyrite are found but mostly the pyrite occurs as finely disseminated throughout.

Floats found in the drift, down ice of a series of north-east trending conductors in the central and eastern portion of TB1209268, were of a very hard, brittle silicious nature almost like a rhyolite with very fine disseminated pyrite throughout. The fine pyrite is heavily concentrated in places and would be considered semi-massive to massive in some cases, undoubtedly the cause of this series of NE trending VLF signatures.

GEOLOGY

My 1996 OPAP prospecting has not added to the geology of the property. Granite-Granodiorite blanket the entire claim group, except for the area hosting the discovery vein. This is a 16ft wide gold bearing quartz vein and is on a north-east trending break. The vein is hosted by a medium to coarse grained quartz diorite or granodiorite. An intensely sheared intermediate volcanic lies along the north contact of the vein. The quartz vein is well fractured with disseminated pyrite and calcopyrite. The calcopyrite is sometimes found in massive blebs and seams.

Heavily mineralized felsic floats are scattered throughout the entire claim group. This would indicate a very wide band of volcanics trending north east and in the conductive areas on the east side of the claim group; however, these targets could not be reached because of heavy overburden. The floats were assayed for gold and returned nil results.

REPORT on 1996 DPAP Exploration Program
O.P.A.P. # OP96-027 Dave Kindla - Elmhirst T.W.P.

My program began in late June. Extensive traversing was done in the new cut over areas and along the new road right of ways. The equipment used in the logging operation revealed many outcrops in the central and south western part of TB-1209268; however, the majority of outcrops observed were all granite.

Prospecting and traverses across the formation were also done in the cut over areas and new road ways on TB -1209269 and TB-1204933.

With the exception of numerous well mineralized floats that are scattered all over the claim group, all of the outcrops exposed are granite.

Many days were spent trying to gain access to the discovery vein from the east, however this is very rough mountainous country, and access for the backhoe would be too time consuming, dangerous, and costly.

A new road was put in and logging operations started in the south west part of TB-1209268. This made it possible to gain access to the west end of the vein.

Backhoe trenches were put down in the approximate location of Airborne conductors, most targets could not be reached because of water or heavy overburden.

The discovery vein was stripped off for approximately 400 feet before pinching out. The trench was continued for another 300 feet following a narrow shear zone, the main vein did not reappear.

The main vein was cross trenched and washed for almost its full length and also sampled.

Values seem to be confined to the shaft area. Samples taken away from the shaft did not assay.

On October 23 the resident geologist, John Mason was taken on a property visit. The samples taken on his visit were sent for assay to MNDM but the results were not back in time for this report.

A junior company is interested in optioning the property; however, nothing was signed at the time of this report.

RECOMMENDATIONS

The only area that was not thoroughly investigated is claim TB1204930

The logging operation was moving into that area when I finished my program.

The rest of the area has been gone over pretty thoroughly.

The property is now ready for a drill program to investigate the discovery vein at depth. A Junior company has visited the property and I am waiting for a letter of intent.

CLAIM No -

NAME -

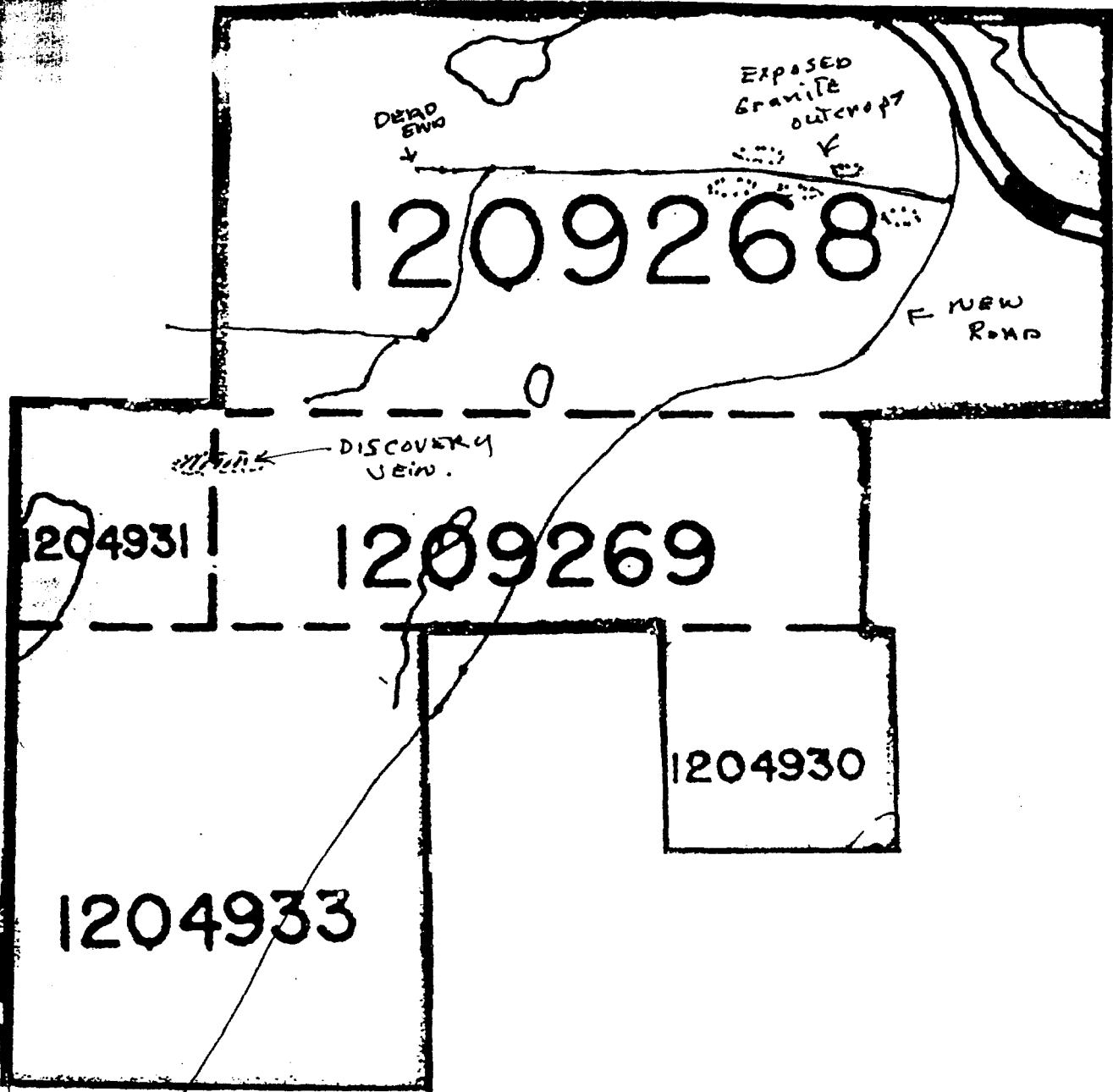

NOTES: June 29-30 - Prospect ALONG NEW ROAD IN central

PART OF TB-1209268 - ALL outcrops ARE GRANITE

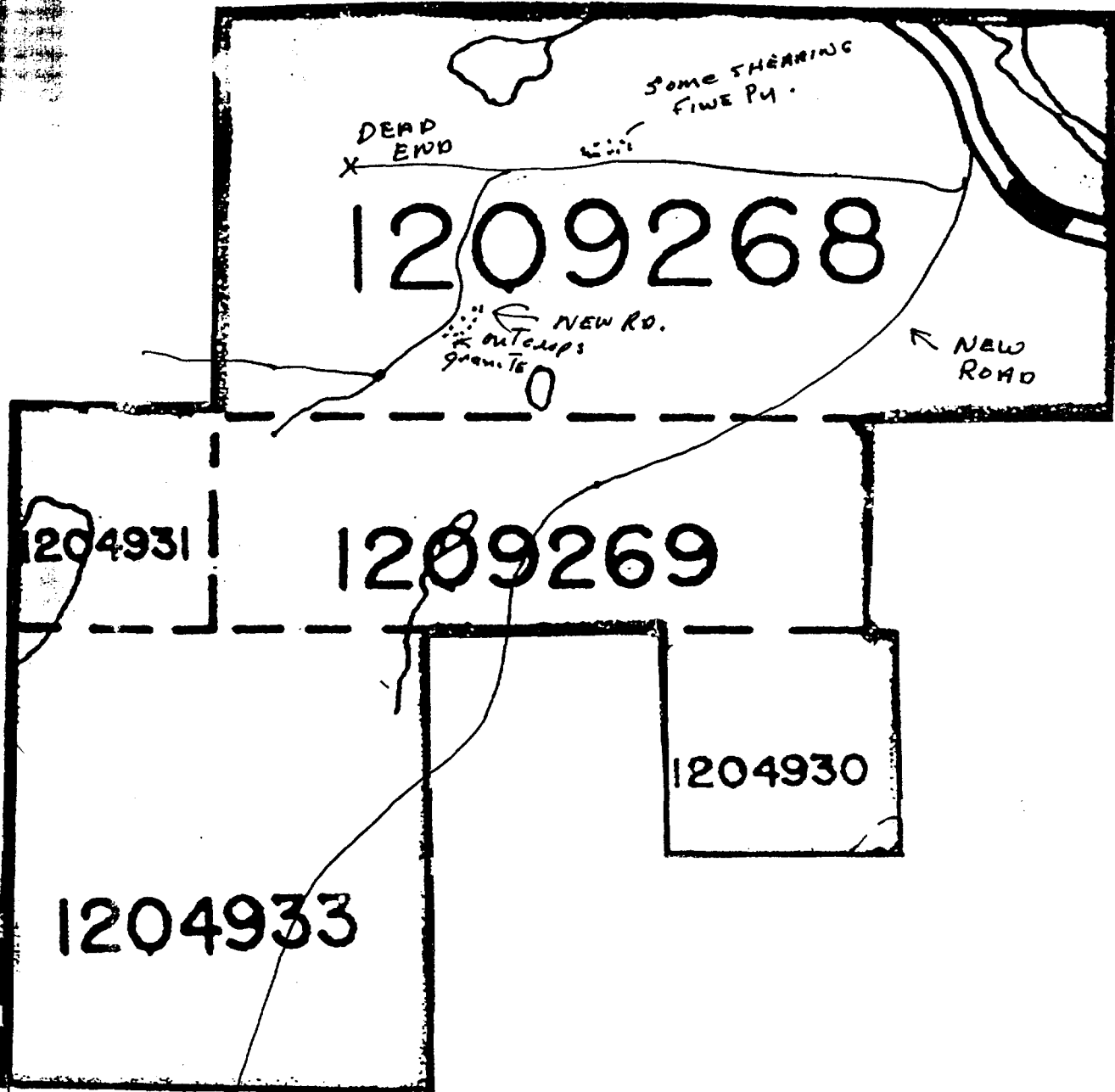

NOTES: July 6-7-8 - Prospected ALONG The NEW ROADS
 AND behind The MACHINERY on Top PART OF TB-1209268
 SOME SHEARING IN ONE outcrop WITH FINE PY. VERY NARROW
 Rammed shear - NO colours

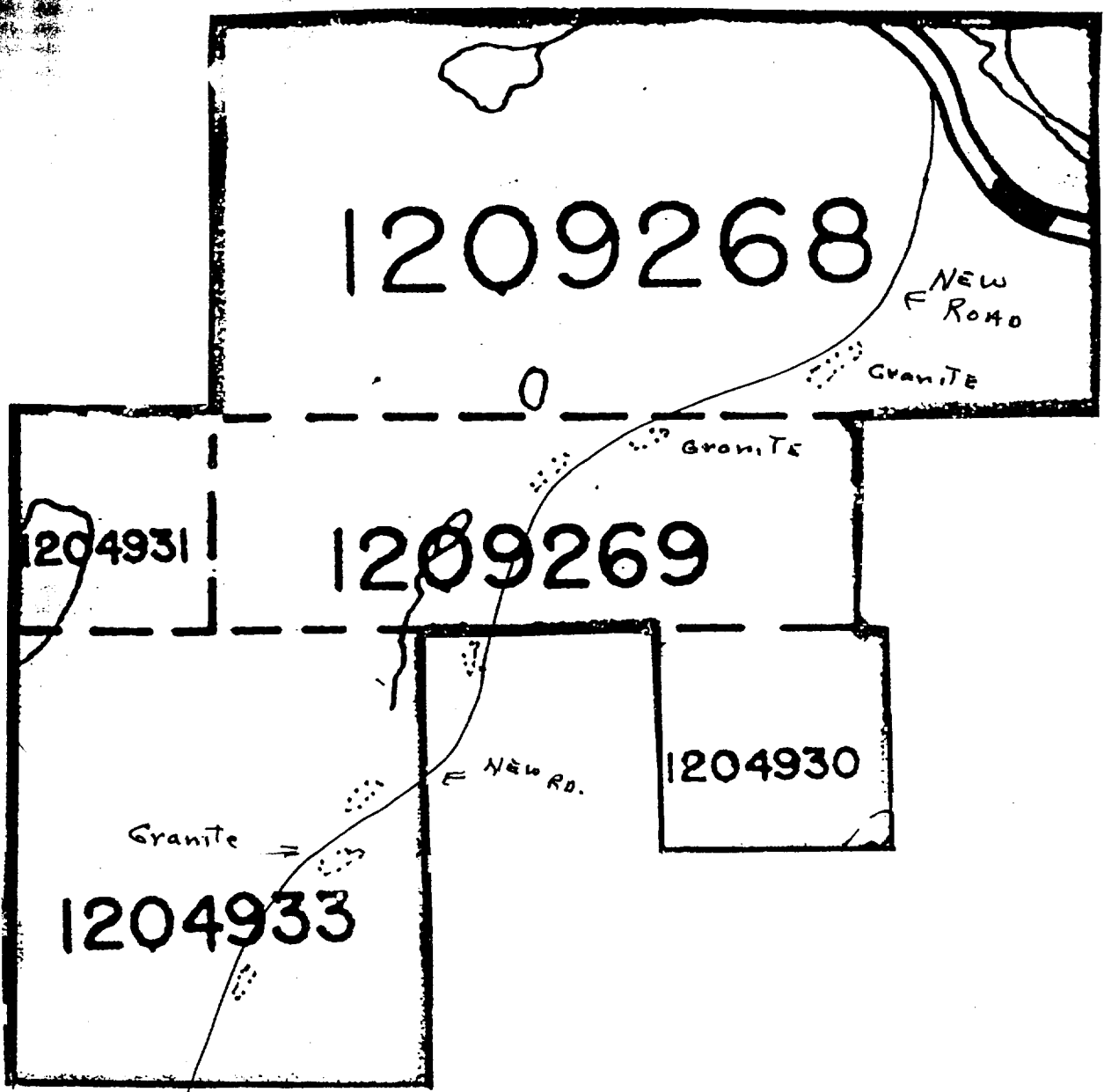

NOTES: July 12-13-14-15 - Prospected along the NEW ROAD

From the RIVER to the South end of TB-1204933
 numerous outcrops uncovered with Tractor while building road
 ALL Granite - no SHEARINGS observed along road.

numerous felsic floats WELL MINERALIZED with Py are
 scattered through the Property. most were assayed last season
 with Nil results.

Logging operation.

DEAD END
X

1209268

EXPOSED
Granite

E NEW RD

1204931

1209269

1204930

1204933

NOTES: Aug 3-4-5 - Prospect behind machines doing logging operations on south west end of TB-1209268 numerous outcrops were exposed however nothing of interest was found. Straight Granite.

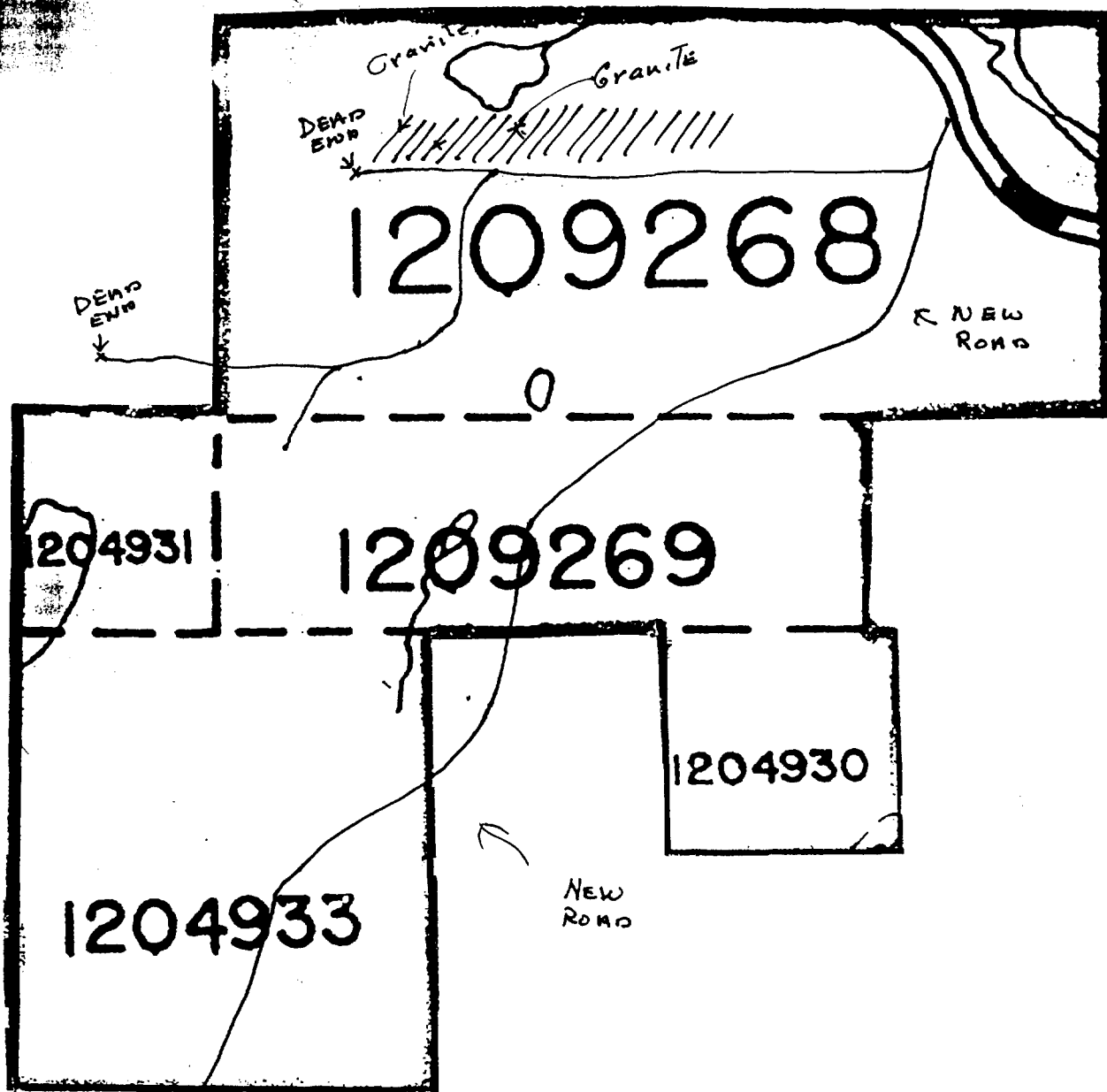

NOTES: Aug 16-17 - Prospect behind SKIDERS ON TOP
 PART of TB-1209268 - FEW outcrops exposed, ALL Granite.
 FOUND MANY Large felsic floats with fine disseminated Py.

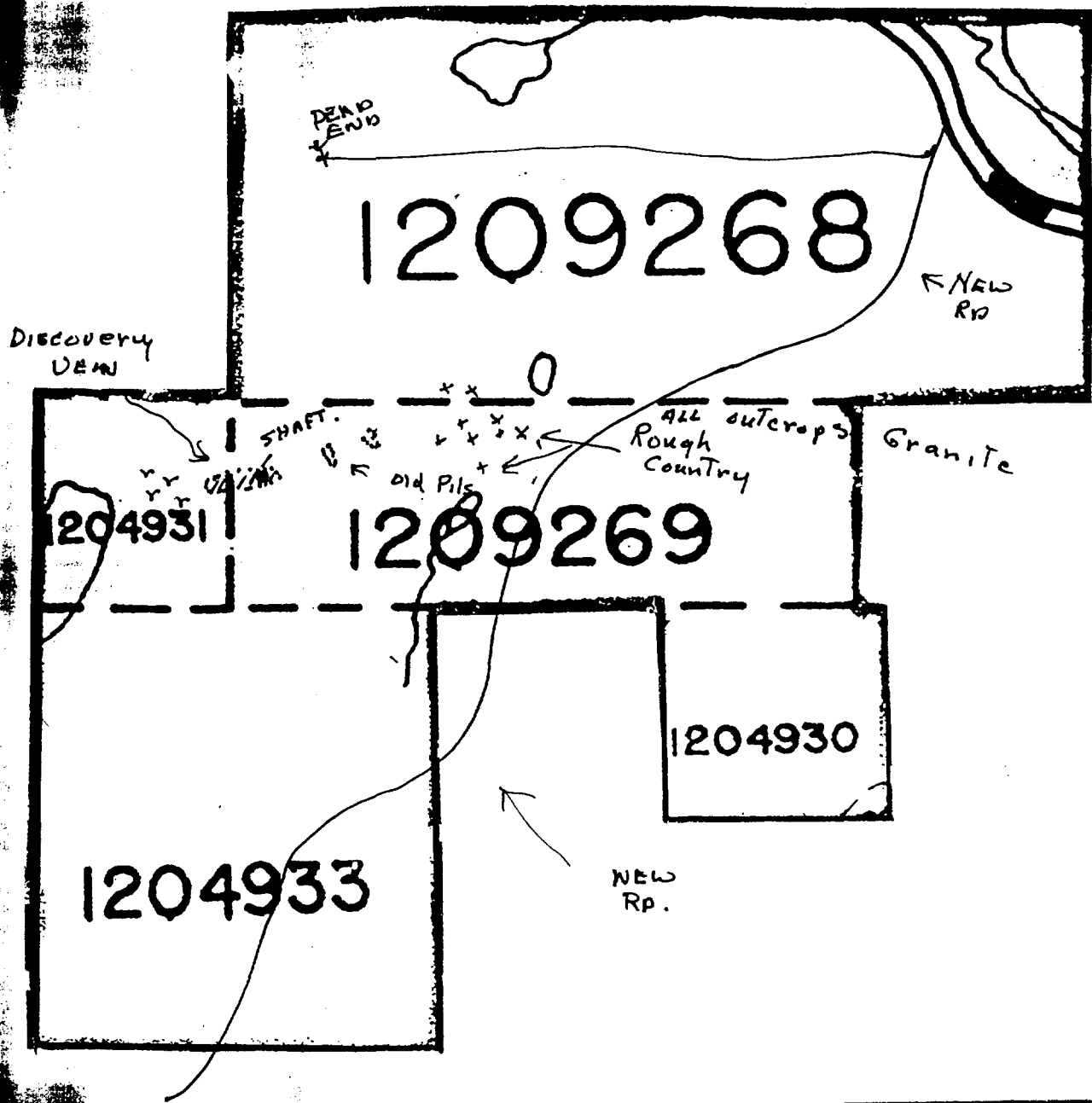

NOTES: SEPT. 1-2-3-4 - PROSPECTING ON STRIKE OF DISCOVERY VEIN
 east ALSO TRYING TO FIND ACCESS TO EAST END OF VEIN
 The Terrain is too rough To bring machine to Vein from the east.
 Found a few old Explorations trenches on strike to the east.
 however the Vein has PINCHED DOWN. very high mountains
 access impossible from The east.

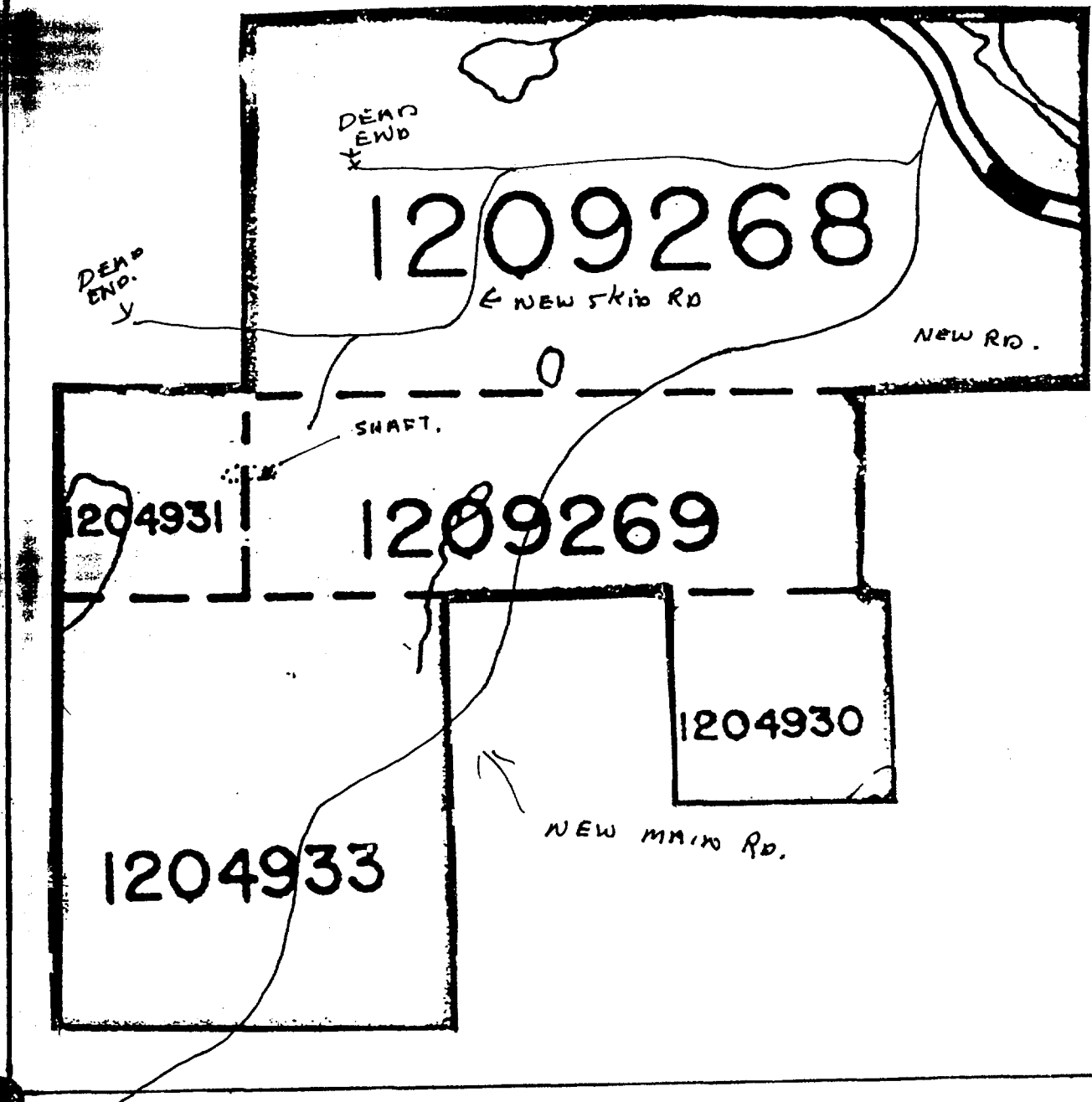

NOTES: Sept. 7-8 - Pump out SHAFT. AND SET UP Pumping Equipment. Also brought in DRILL AND Dynamite.

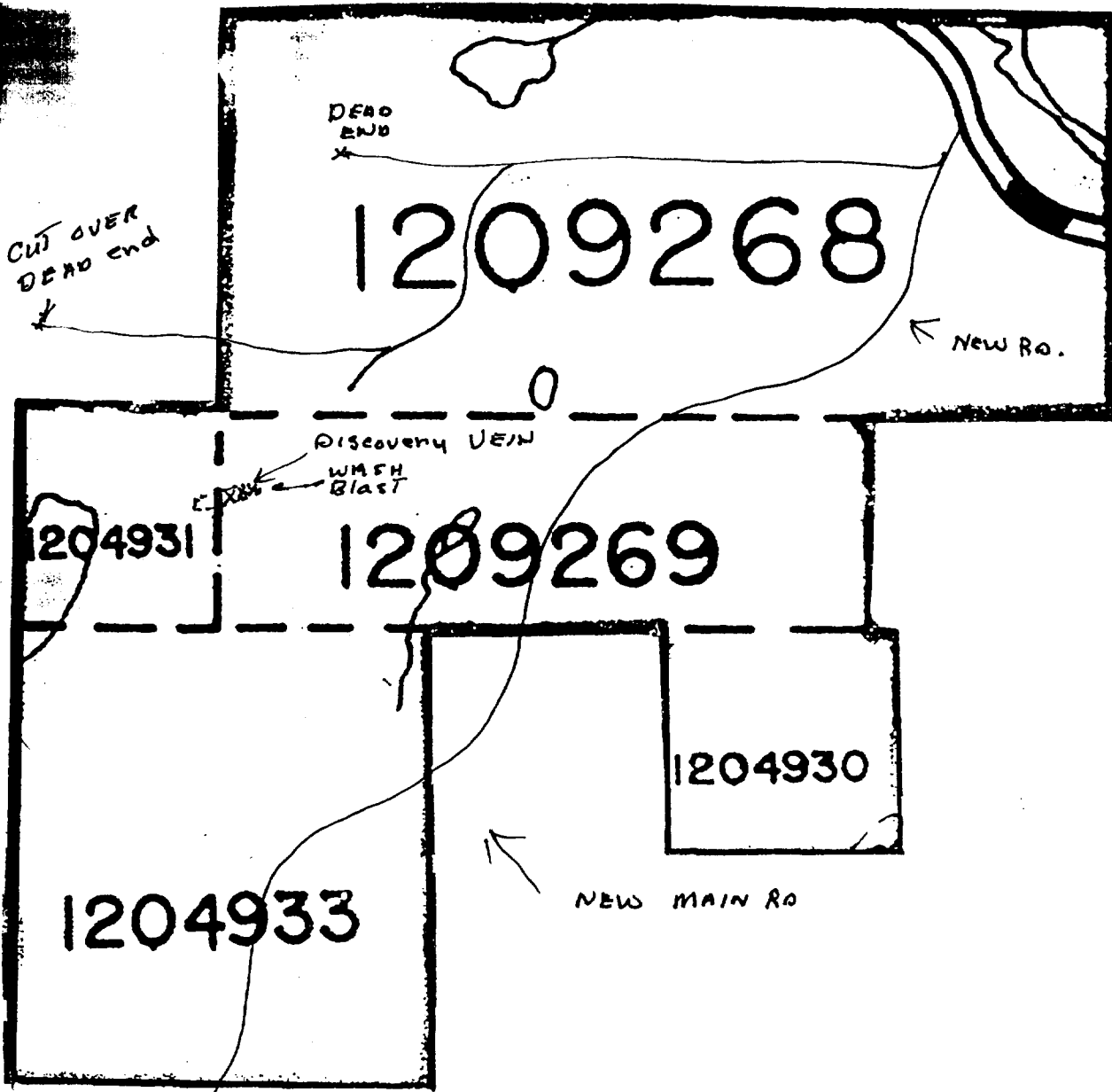

NOTES: SEPT. 9-11-14 - DRILLING - BLASTING AND
 WASHING DOWN SHAFT VEIN:- SAMPLING + MAPPING.
 VEIN WASHED FOR 500 FT.

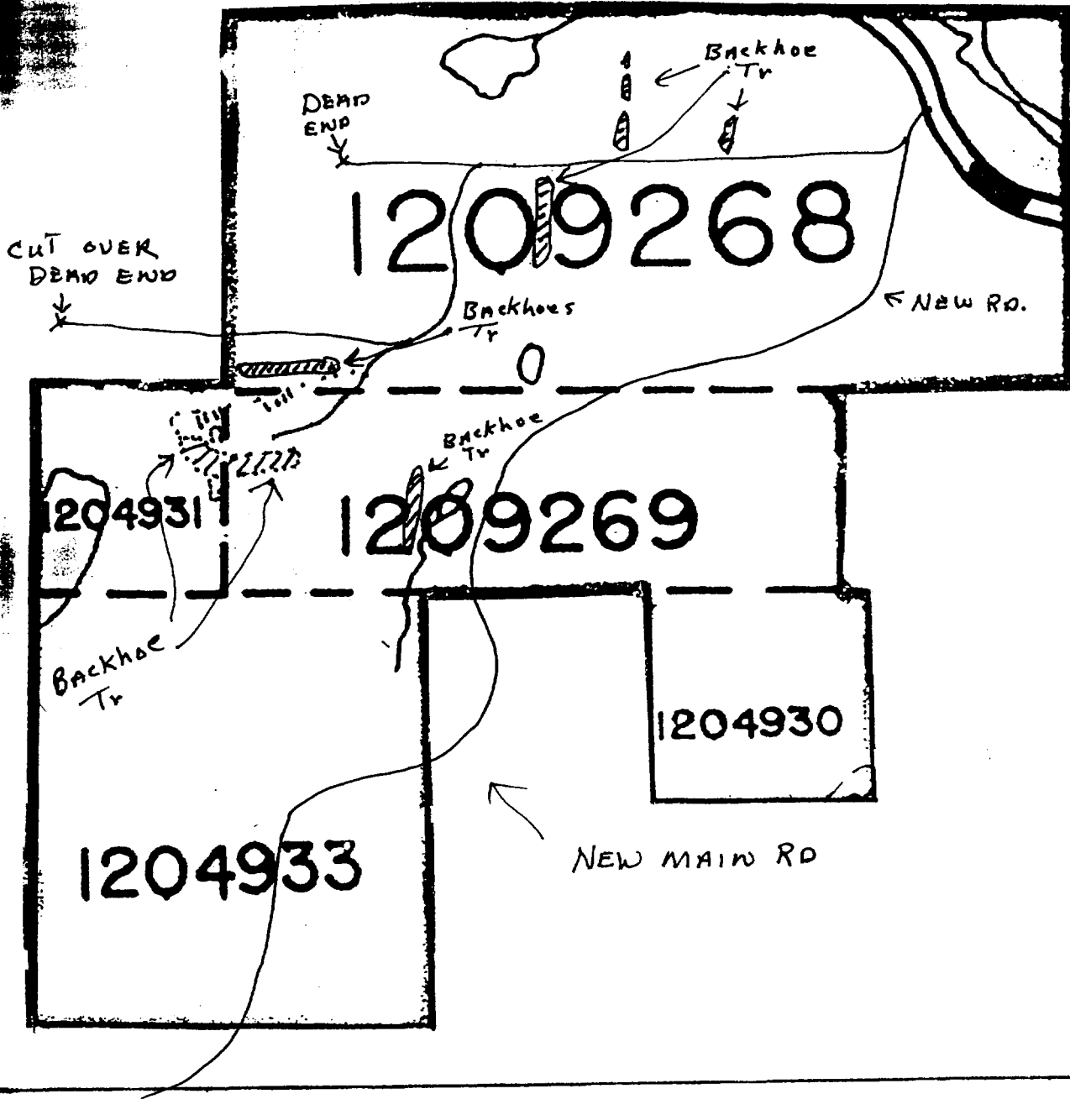

NOTES: Oct. 15-16-17-18.

Working behind Backhoe in Trenches

Also flagging Backhoe access to Trenching TARGETS

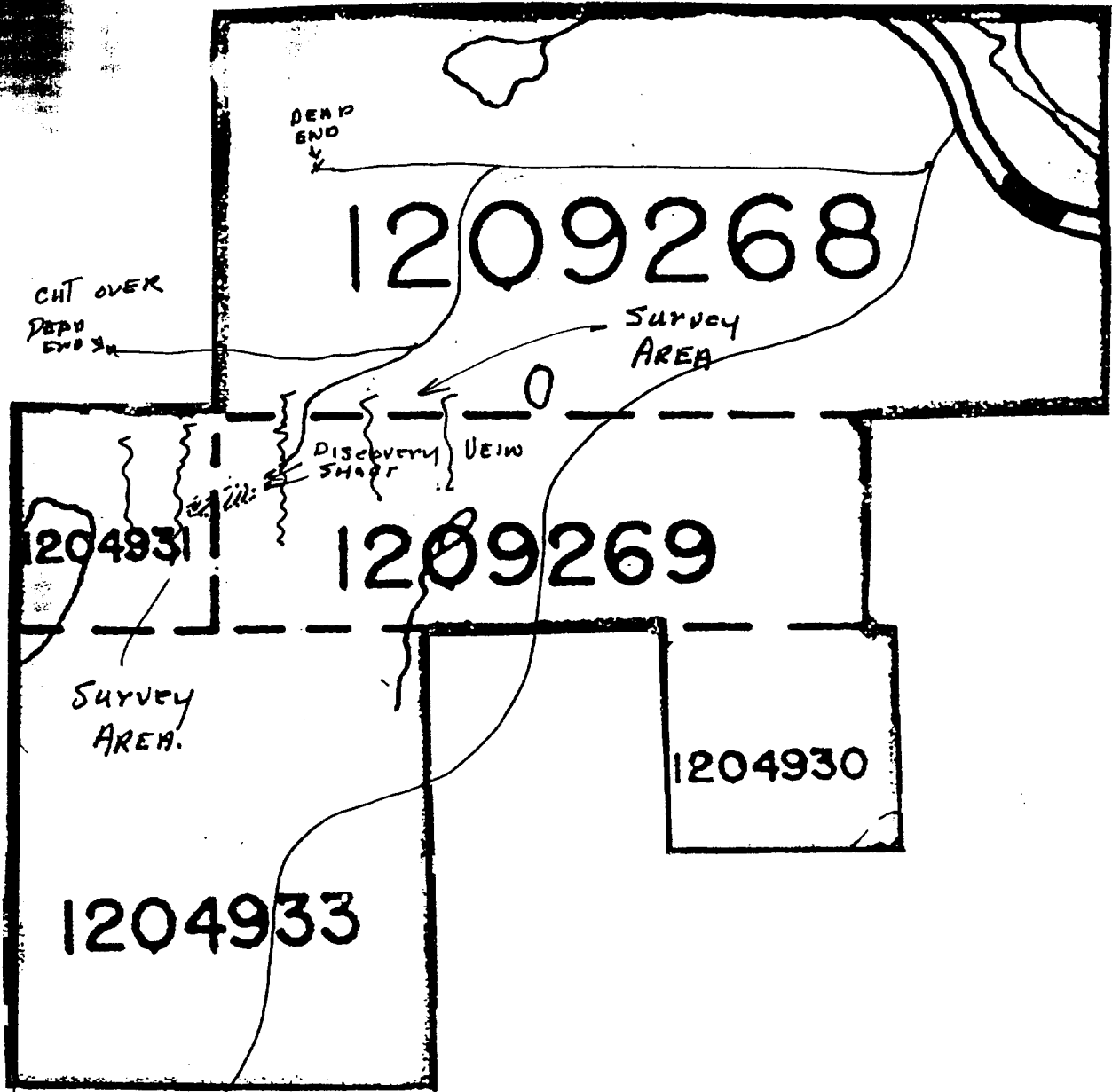

NOTES: Oct. 19/96 - ASSIST PENT. LASILKA WITH
VLF SURVEY

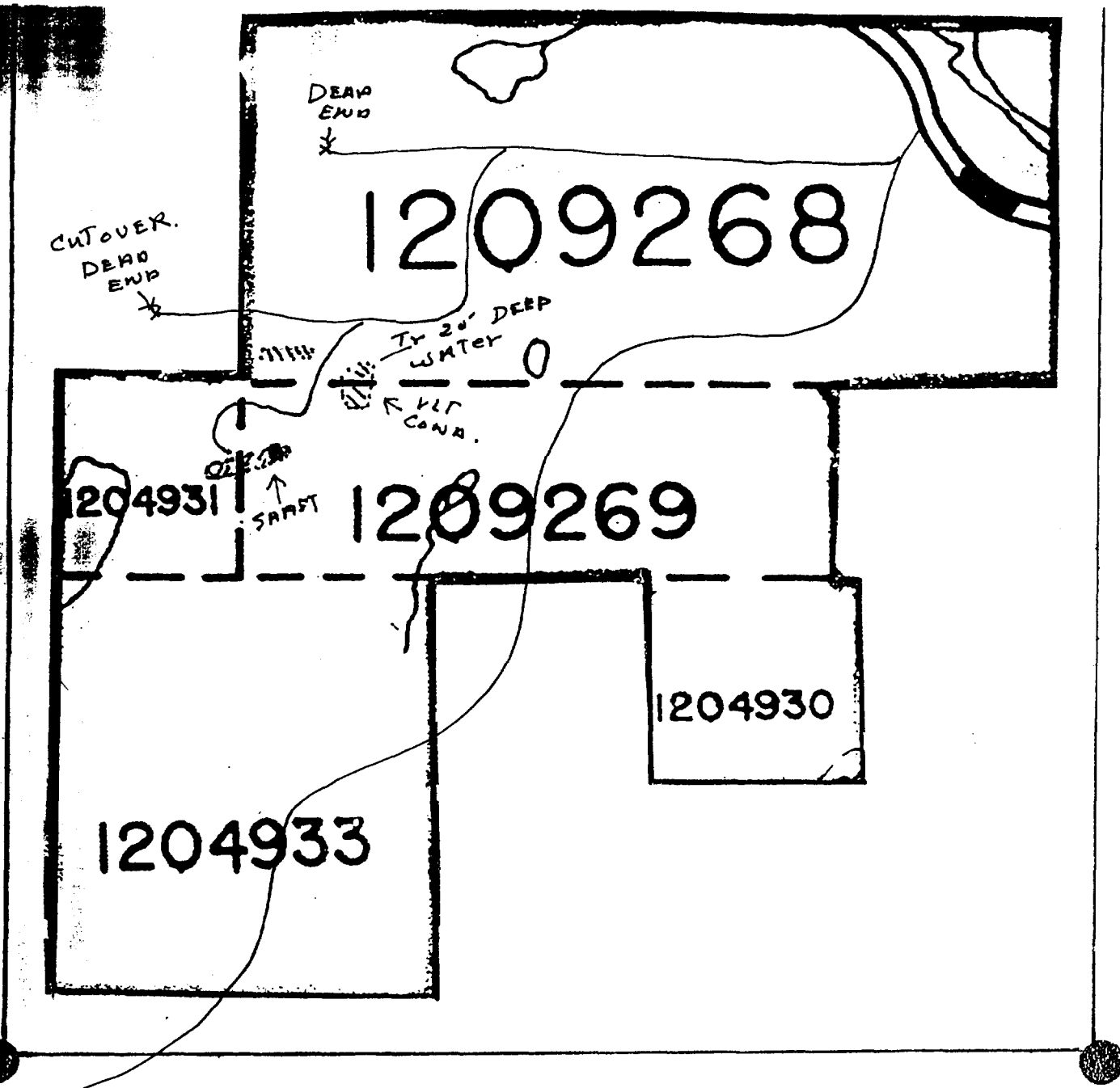

NOTES: Oct. 20-21-22 - WORK behind Backhoe
 IN Trench - FLAG ACCESS.
 TRENCH VLF CONDUCTORS OUTLINED by Penti.
 CONDUCTORS NOT REACHED BECAUSE OF WATER



ACCURASSAY LABORATORIES

A DIVISION OF ASSAY LABORATORY SERVICES INC.

1070 LITHIUM DRIVE, UNIT 2
THUNDER BAY, ONTARIO P7B 6G3
PHONE (807) 623-6448
FAX (807) 623-6820

Page 1

D. KINDLA
P.O. BOX 104
BEARDMORE, ONTARIO
P0T 1G0
(807) 875-2108

Oct. 21, 1996

Job# 9641357

Accurassay	SAMPLE # Customer	Gold ppb	Gold Oz/t
1	4576	18	<0.001
2	4577	<5	<0.001
3	4578	<5	<0.001
4	4579	<5	<0.001
5	4580	<5	<0.001
6	4581	<5	<0.001
7 Check	4581	<5	<0.001

Certified By: 



ACCURASSAY LABORATORIES

A DIVISION OF ASSAY LABORATORY SERVICES INC.

1070 LITHIUM DRIVE, UNIT 2
THUNDER BAY, ONTARIO P7B 6G3
PHONE (807) 623-6448
FAX (807) 623-6820

Page 1

Mr. DAVID KINDLA
Box 104
Beardmore, Ontario
P0T 1G0

Nov. 29, 1996

Job# 9641517

Accurassay	SAMPLE # Customer		Gold ppb	Gold Oz/t
	1	4582	9	<0.001
	2	4583	20	<0.001
	3	4584	7	<0.001
	4	4585	<5	<0.001
	5	4586	<5	<0.001
	6	4587	<5	<0.001
	7	4588	<5	<0.001
	8	4589	6	<0.001
	9	4590	<5	<0.001
	10	4591	<5	<0.001
	11 Check	4591	<5	<0.001
	12	4592	12	<0.001

Certified By: _____



EIMHIRST
OPAP-96

Area No. I

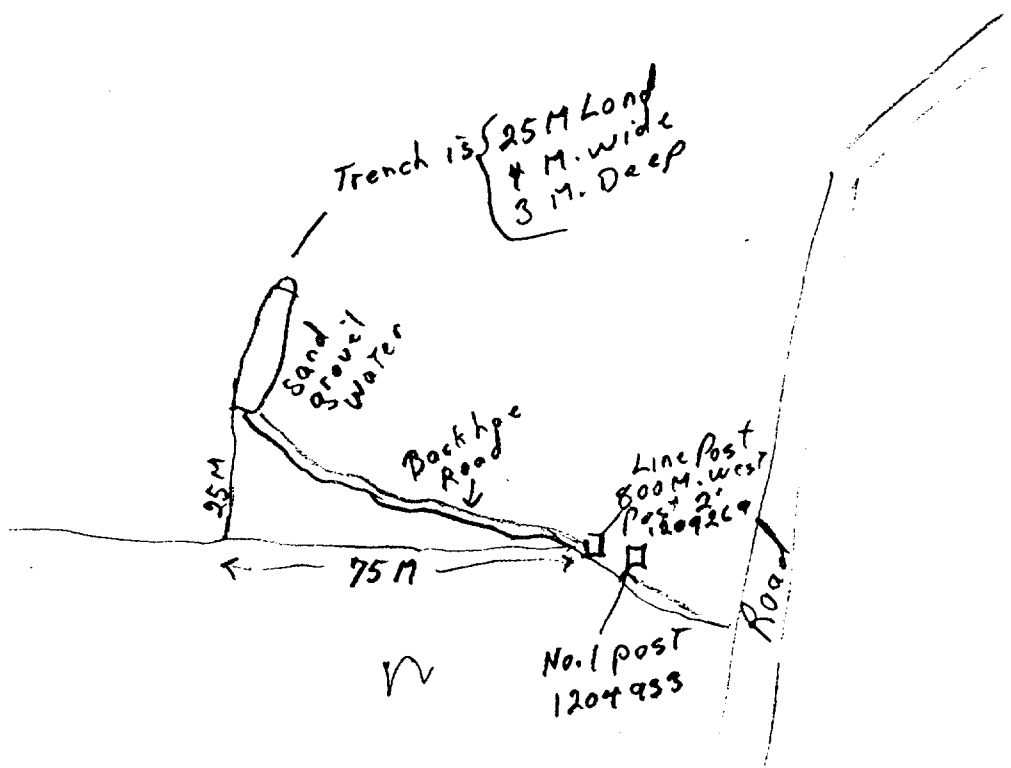

Area No. 2



line post
800 M. EAST
of #4 post
1209268

300 M To Road

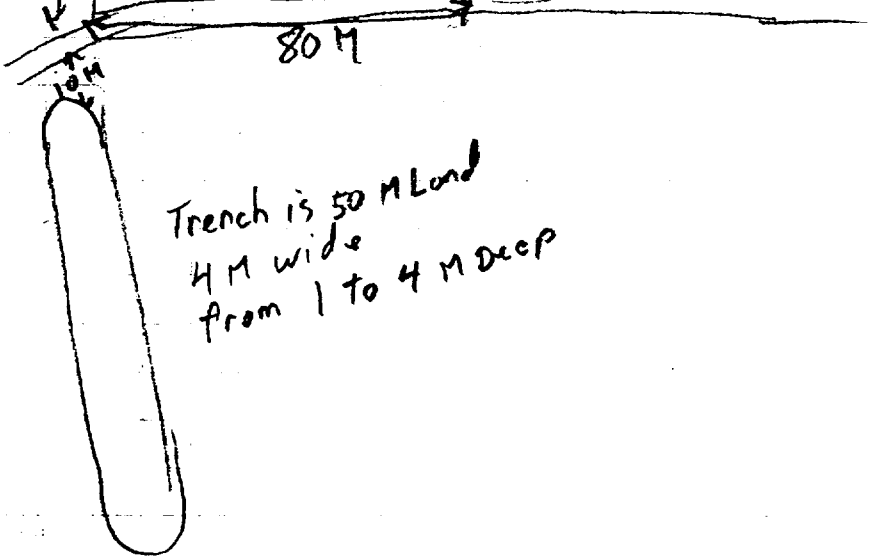
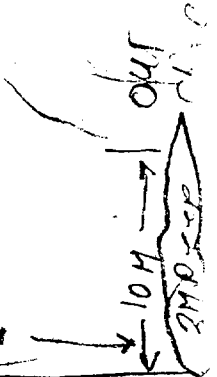
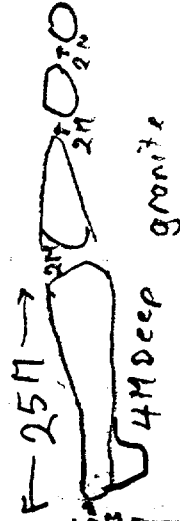

Trench is 50 M Long
4 M wide
from 1 to 4 M deep

Area No. 3

Backhoe Road

Au
.001
.001
.001
.001
.001
.001
.001

Au
.001
.001
.001

Au
.001
.001
.001
.001
.001
.001
.001
.001
.001
.001
.001

clam line

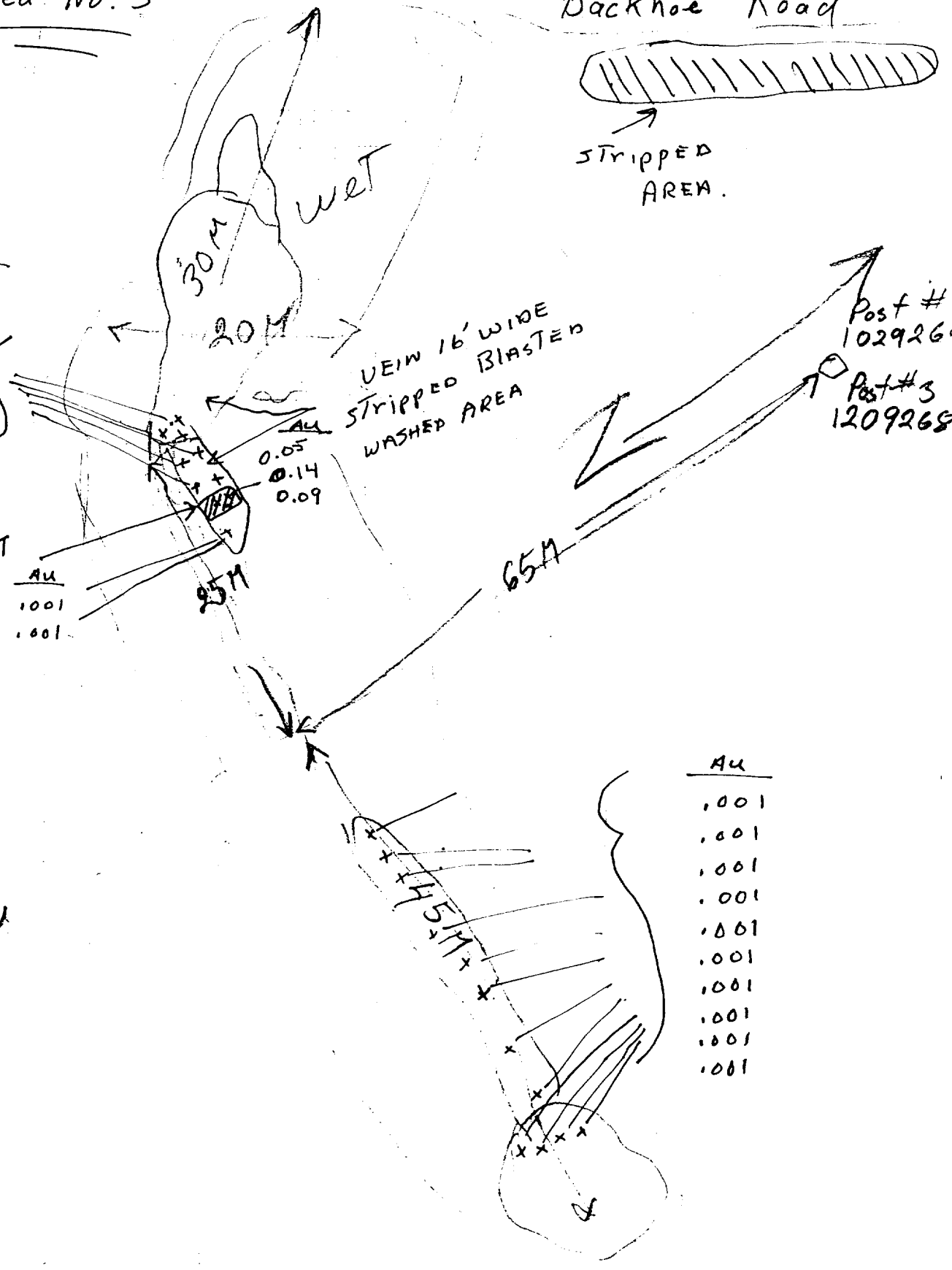

Post # 4
1029269
Post # 3
1209268

VEIN 16' WIDE
STRIPPED
BLASTED
WASHED AREA

STRIPPED
AREA.

Au
0.05
0.14
0.09

Au
0.001
0.001
0.001

Au
.001
.001
.001
.001
.001
.001
.001
.001
.001
.001
.001

clam line

Area No. 4



5M x 10M

from 1 to 4
Meters Deep

1.13M

#3 Post
1029269

#4 Post

1029269

Four Samples
TAKEN

Back hoe Road

Clear Cut

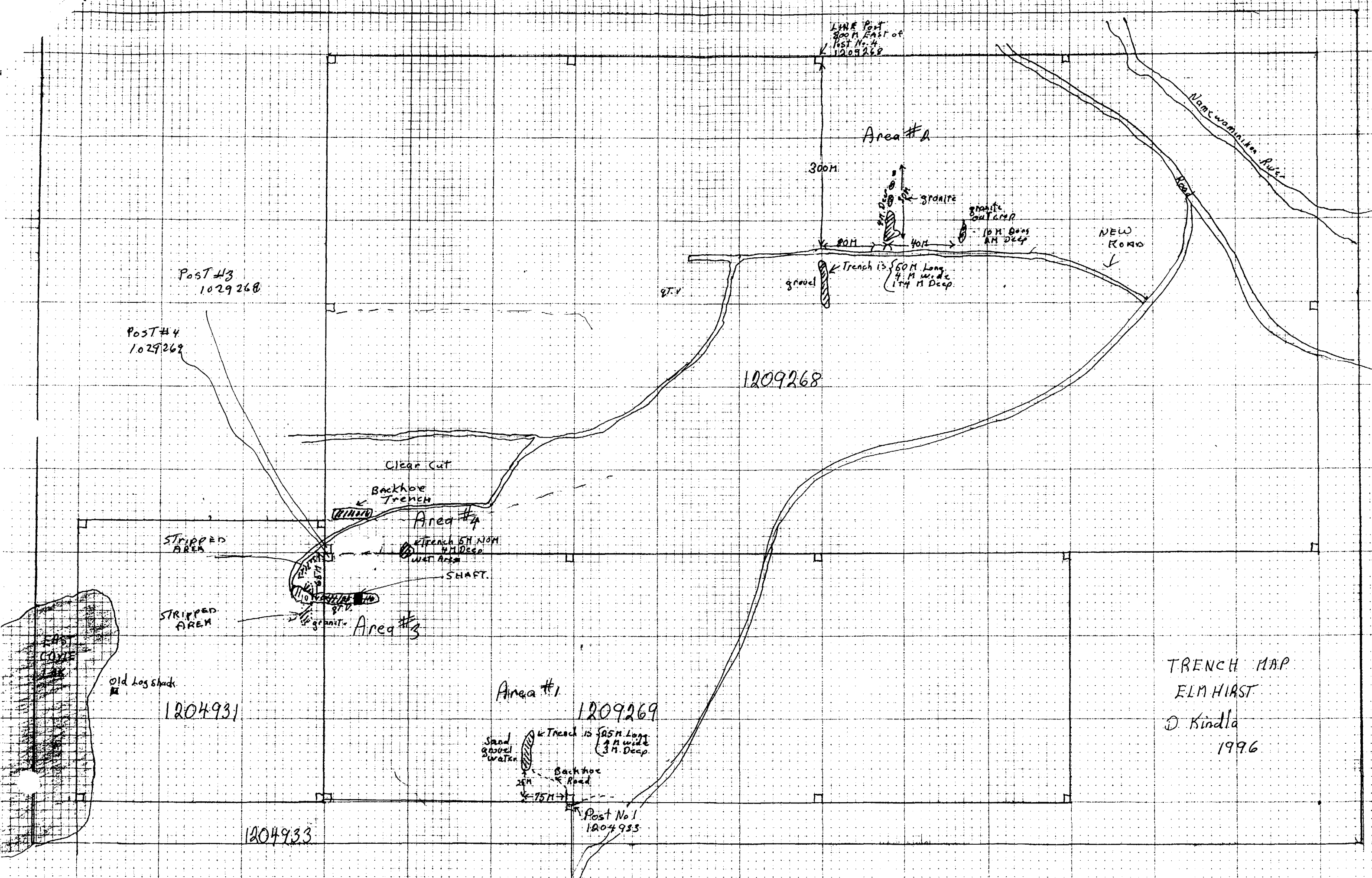

TRENCH MAP
 ELM HIART
 D. Kindla
 1996

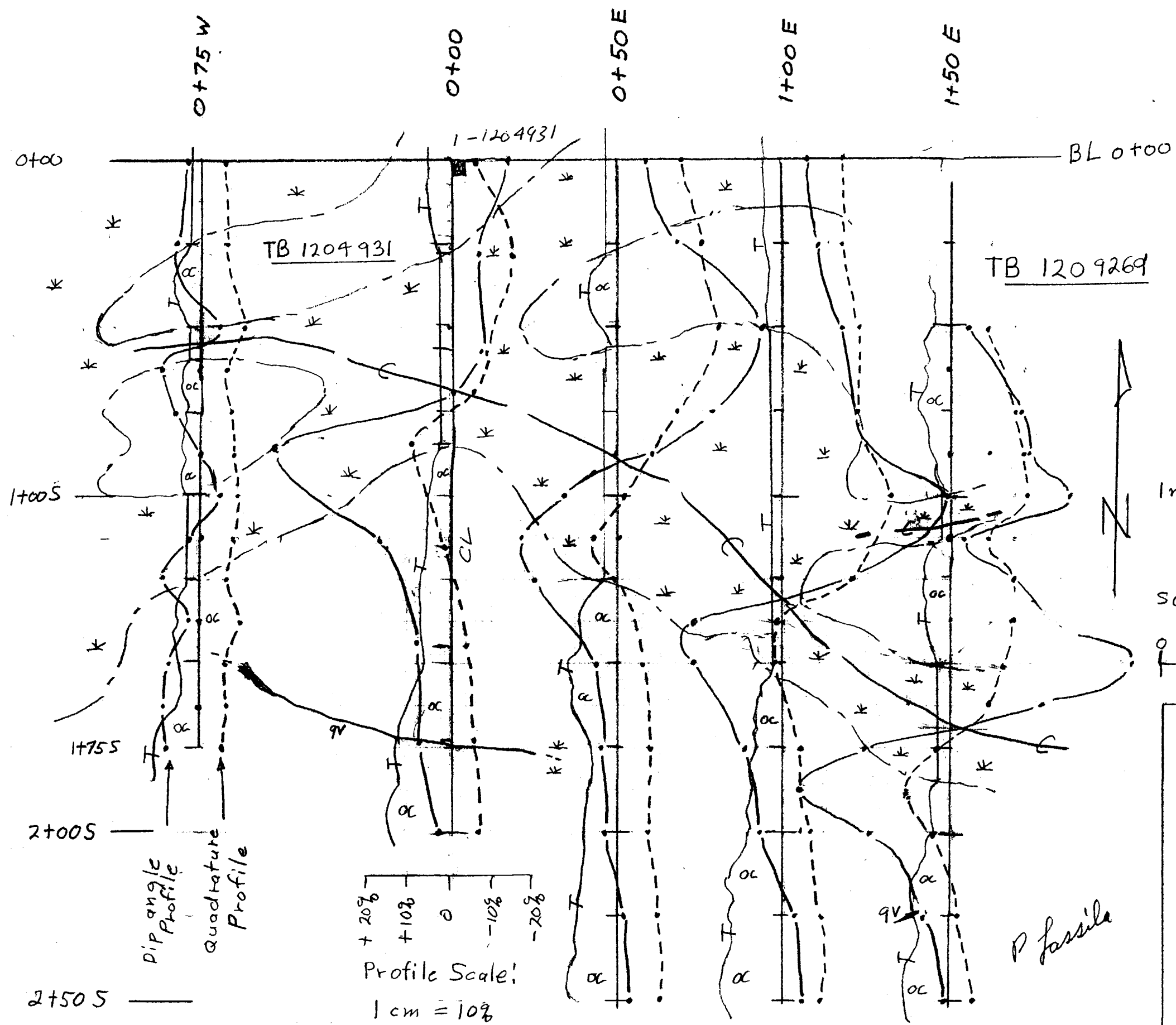

LEGEND

- Claim Post
- * Swamp
- ~ Topographic Profile
- oc outcrop
- ⊂ VLF EM Conductor
- qv Quartz Vein

Instr: Geonics EM-16 VLF
 Sta: Seattle, Wash
 Freq: 24 KHz

Scale: 1 cm = 12 1/2 m

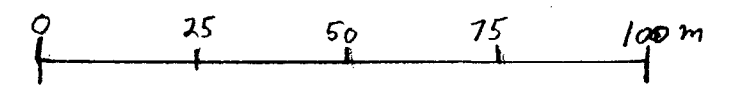

VLF SURVEY MAP
 D. KINDLA PROPERTY
 Elmhurst Twp.: G-162
 Lat. 49° 47' Long 87° 42'

By: P. Lassila Oct, 19, 1996

MAP 1

P. Lassila

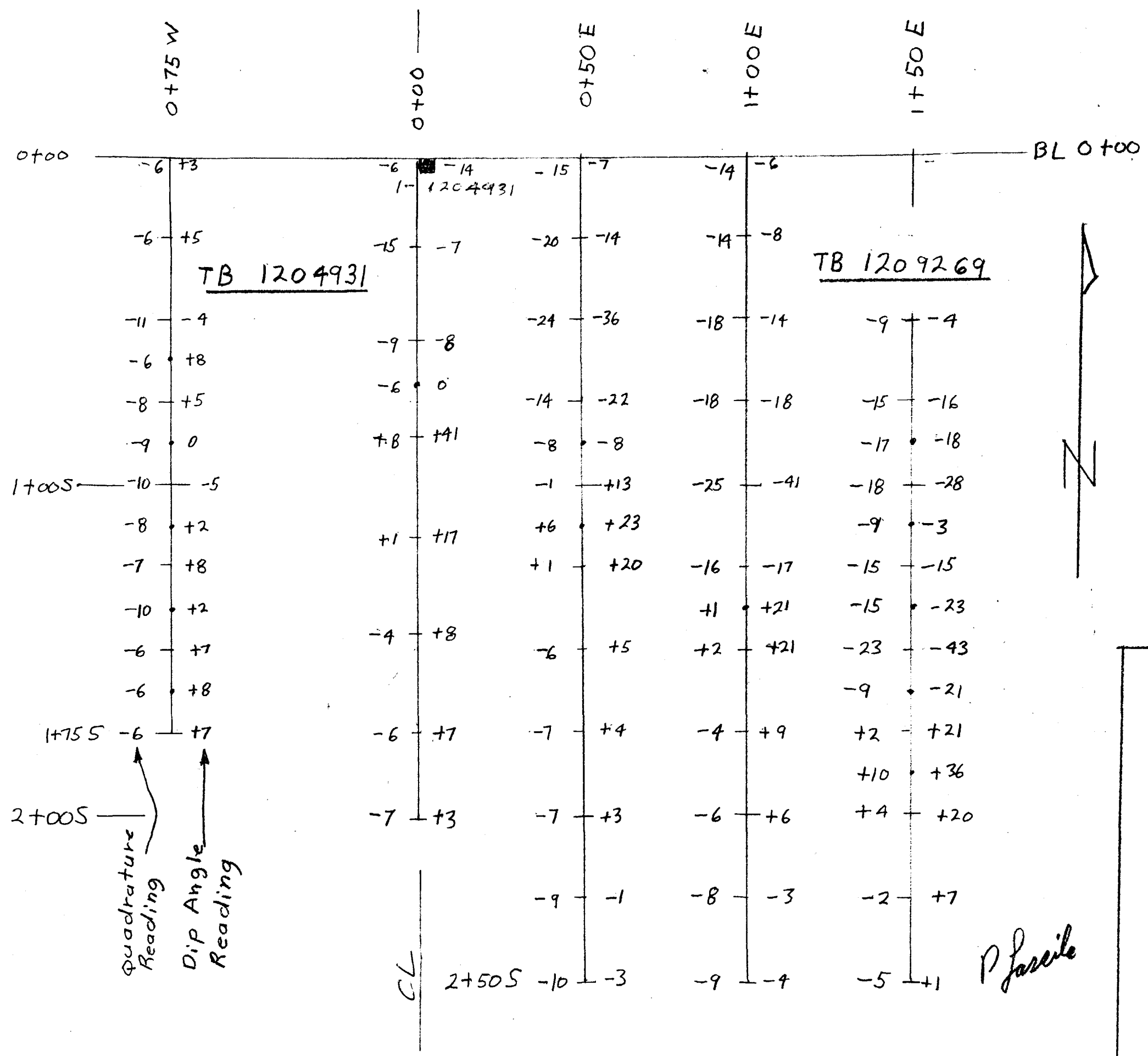

see Map 1 for
Legend
and instrument data



VLF READINGS MAP
D. KINDLA PROPERTY
Elmhurst Twp. G-162
Lat. 49° 41' Long 87° 42'
By P. Lassila Oct. 19, 1996
MAP 2

P. Lassila

KINDLA
PROPERTY

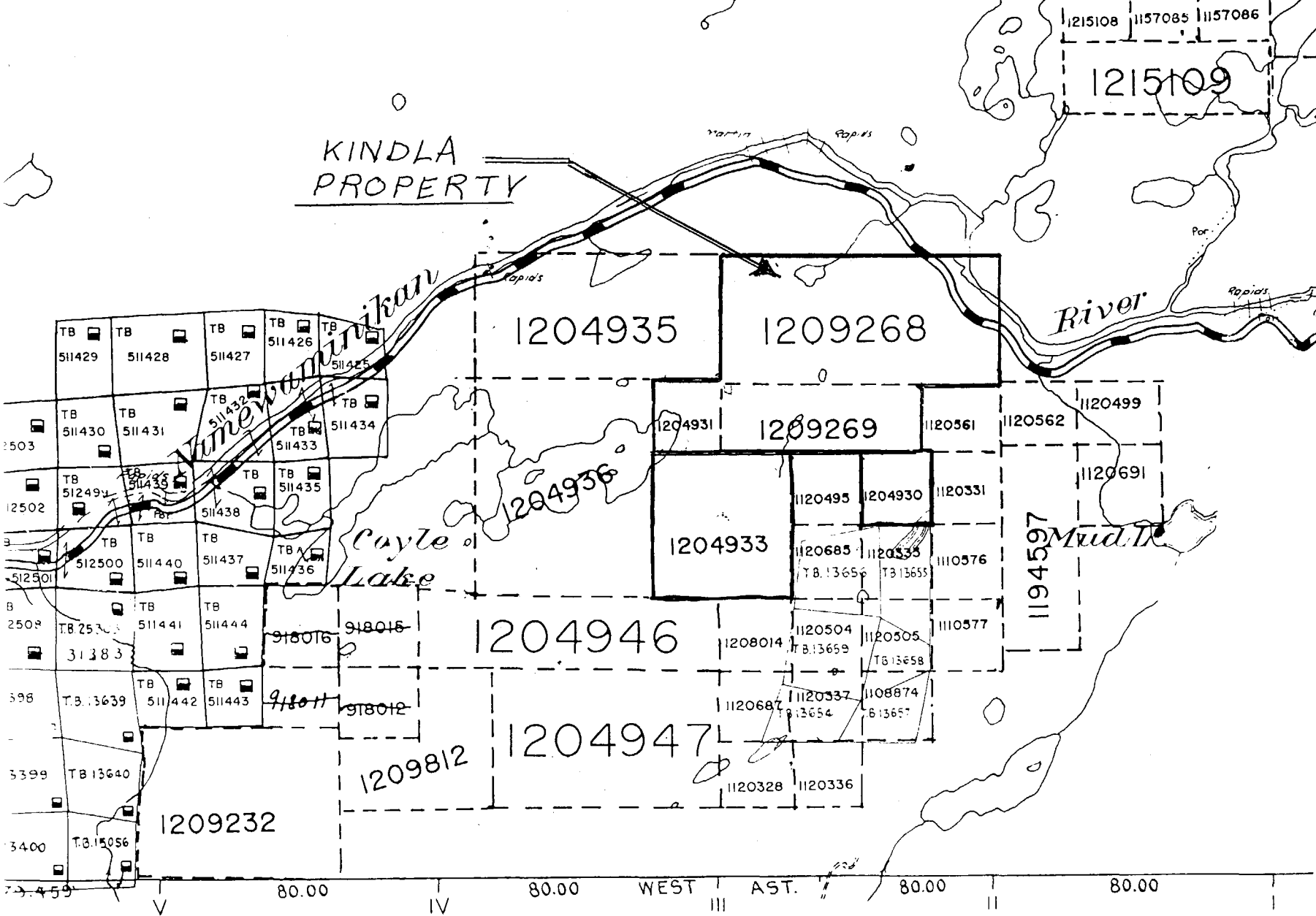

SCALE: 1 INCH = 40 CHAINS

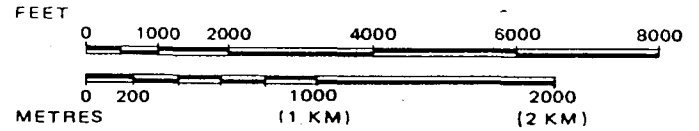

TOWNSHIP

ELMHIRST

M.N.R. ADMINISTRATIVE DISTRICT

NIPIGON

MINING DIVISION

THUNDER BAY

LAND TITLES / REGISTRY DIVISION

THUNDER BAY



Ontario

Ministry of
Natural
Resources

Land
Management
Branch

Date JANUARY 29th, 1981

Number
G-162

in Service Nov. 20/95. (LA)

WALTERS TR. G-171

CLAIM MAP

Figure 1

Declaration of Assessment Work Performed on Mining Land

Mining Act, Subsection 65(2) and 66(3), R.S.O. 1990

Transaction Number (office use) W9740-183
Assessment Files Research Imaging

Personal information collected under the Access to Information Act, the information collected for this collection is available at 933 Ramsey Lake Road, S



1) of the Mining Act. Under section 8 of the Act and correspond with the mining land holder. Ministry of Northern Development and Mines, 6th Floor,

900

2.17384

Instructions: - For work performed on Crown Lands before recording a claim, use form 0240.
- Please type or print in ink.

1. Recorded holder(s) (Attach a list if necessary)

Name David Kindla	Client Number 152127
Address Box 104	Telephone Number 807 875-2108
Beardmore Ont POT 1G0	Fax Number
Name	Client Number
Address	Telephone Number
	Fax Number

(WA 10) (PTRNCH)

2. Type of work performed: Check (✓) and report on only ONE of the following groups for this declaration.

Geotechnical: prospecting, surveys, assays and work under section 18 (regs) Physical: drilling, stripping, trenching and associated assays Rehabilitation

Work Type Trenching	Office Use
	Commodity
	Total \$ Value of Work Claimed \$4413
Dates Work Performed From 15 10 96 To 22 10 96	NTS Reference
Global Positioning System Data (if available)	Mining Division THUNDER BAY
Township/Area Elmhirst twp	Resident Geologist District BEARDMORE GERALDTON
M or G-Plan Number G-0162	

Please remember to: - obtain a work permit from the Ministry of Natural Resources as required;
- provide proper notice to surface rights holders before starting work;
- complete and attach a Statement of Costs, form 0212;
- provide a map showing contiguous mining lands that are linked for assigning work;
- include two copies of your technical report.

3. Person or companies who prepared the technical report (Attach a list if necessary)

Name David Kindla	Telephone Number 807 875 2108
Address Beardmore Ont POT 1G0	Fax Number
Name	Telephone Number
Address	Fax Number
Name	Telephone Number
Address	Fax Number

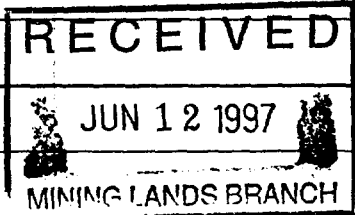

4. Certification by Recorded Holder or Agent

I, **David Kindla** (Print Name), do hereby certify that I have personal knowledge of the facts set forth in this Declaration of Assessment Work having caused the work to be performed or witnessed the same during or after its completion and, to the best of my knowledge, the annexed report is true.

Signature of Recorded Holder or Agent David Kindla	Date June 10/97
--	---------------------------

5. Work to be recorded and distributed. Work can only be assigned to claims that are contiguous (adjoining) to the mining land where work was performed, at the time work was performed. A map showing the contiguous link must accompany this form.

Mining Claim Number. Or if work was done on other eligible mining land, show in this column the location number indicated on the claim map.	Number of Claim Units. For other mining land, list hectares.	Value of work performed on this claim or other mining land.	Value of work applied to this claim.	Value of work assigned to other mining claims.	Bank. Value of work to be distributed at a future date.
eg TB 7827	16 ha	\$26,825	N/A	\$24,000	\$2,825
eg 1234567	12	0	\$24,000	0	0
eg 1234568	2	\$8,892	\$4,000	0	\$4,892
1 1209268	8	1960	1960	0	0
2 1209269	3	1960	1200	400	360
3 1204930	1	0	400	0	0
4 1204931	1	493	493	0	0
5					
6					
7					
8					
9					
10					
11					
12					
13					
14					
15					
Column Totals		4413	4053	400	360

I, David Kindla, do hereby certify that the above work credits are eligible under subsection 7 (1) of the Assessment Work Regulation 6/96 for assignment to contiguous claims or for application to the claim where the work was done.

Signature of Recorded Holder or Agent Authorized in Writing: David Kindla Date: Apr 10/97

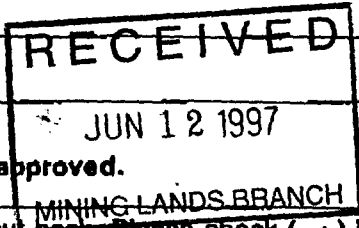

6. Instructions for cutting back credits that are not approved.

Some of the credits claimed in this declaration may be cut back. Please check (✓) in the boxes below to show how you wish to prioritize the deletion of credits:

- 1. Credits are to be cut back from the Bank first, followed by option 2 or 3 or 4 as indicated.
- 2. Credits are to be cut back starting with the claims listed last, working backwards; or
- 3. Credits are to be cut back equally over all claims listed in this declaration; or
- 4. Credits are to be cut back as prioritized on the attached appendix or as follows (describe):

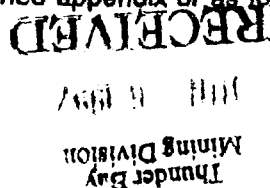

Note: If you have not indicated how your credits are to be deleted, credits will be cut back from the Bank first, followed by option number 2 if necessary.



Ministry of Northern Development and Mines

Declaration of Assessment Work Performed on Mining Land

Mining Act, Subsection 65(2) and 66(3), R.S.O. 1990

MINING LANDS
 Transaction Number (office use)
 W9740-184
 Assessment Files Research Imaging

Personal information collected on this form is obtained under the authority of subsections 65(2) and 66(3) of the Mining Act. Under section 8 of the Mining Act, the information is a public record. This information will be used to review the assessment work and correspond with the mining land holder. Questions about this collection should be directed to the Chief Mining Recorder, Ministry of Northern Development and Mines, 6th Floor 933 Ramsey Lake Road, Sudbury, Ontario, P3E 6B5.

Instructions: - For work performed on Crown Lands before recording a claim, use form 0240.
 - Please type or print in ink.

1. Recorded holder(s) (Attach a list if necessary)

2.17384

Name <i>David Kindla</i>	Client Number <i>152127 POC1</i>
Address <i>Box 104</i>	Telephone Number <i>807 875 2108</i>
<i>Beardmore Ont POT 1G0</i>	Fax Number
Name	Client Number
Address	Telephone Number
	Fax Number

(WA 10) (PROSP) (VLF) (ASSAY)

2. Type of work performed: Check (✓) and report on only ONE of the following groups for this declaration.

<input checked="" type="checkbox"/> Geotechnical: prospecting, surveys, assays and work under section 18 (regs)	<input type="checkbox"/> Physical: drilling, stripping, trenching and associated assays	<input type="checkbox"/> Rehabilitation
Work Type <i>Prospecting</i> <i>VLF</i> <i>ASSAYS</i>	Office Use	Commodity
Dates Work Performed From <i>29 06 96</i> To <i>22 09 96</i>	Total \$ Value of Work Claimed <i>\$6947</i>	NTS Reference
Global Positioning System Data (if available)	Township/Area <i>Elmhirst twp</i>	Mining Division <i>THUNDER BAY</i>
	M or G-Plan Number <i>G 16d</i>	Resident Geologist District <i>BEARDMORE</i>

Please remember to: - obtain a work permit from the Ministry of Natural Resources as required;
 - provide proper notice to surface rights holders before starting work;
 - complete and attach a Statement of Costs, form 0212;
 - provide a map showing contiguous mining lands that are linked for assigning work;
 - include two copies of your technical report.

RECEIVED
 JUN 12 1997
 MINING LANDS BRANCH
 807 875 2108

3. Person or companies who prepared the technical report (Attach a list if necessary)

Name <i>David Kindla</i>	Telephone Number <i>807 875 2108</i>
Address <i>Beardmore Ont POT 1G0</i>	Fax Number
Name <i>Pentti Lassila</i>	Telephone Number
Address <i>68 Albany Cresc, ATXAY Ont</i>	Fax Number
Name <i>Accurassay Laboratories</i>	Telephone Number <i>807 623 6448</i>
Address <i>Thunder Bay Ont P7B 6G3</i>	Fax Number <i>- 6820</i>

4. Certification by Recorded Holder or Agent

I, *David Kindla* (Print Name), do hereby certify that I have personal knowledge of the facts set forth in this Declaration of Assessment Work having caused the work to be performed or witnessed the same during or after its completion and, to the best of my knowledge, the annexed report is true.

Signature of Recorded Holder or Agent <i>David Kindla</i>	Date <i>Apr 10/97</i>
Telephone Number	Fax Number

5. Work to be recorded and distributed. Work can only be assigned to claims that are contiguous (adjoining) to the mining land where work was performed, at the time work was performed. A map showing the contiguous link must accompany this form.

Mining Claim Number. Or if work was done on other eligible mining land, show in this column the location number indicated on the claim map.	Number of Claim Units. For other mining land, list hectares.	Value of work performed on this claim or other mining land.	Value of work applied to this claim.	Value of work assigned to other mining claims.	Bank. Value of work to be distributed at a future date.
eg TB 7827	16 ha	\$26,825	N/A	\$24,000	\$2,825
eg 1234567	12	0	\$24,000	0	0
eg 1234568	2	\$8,892	\$4,000	0	\$4,892
1 1209268	8	3164	1240	1714	200
2 1209269	3	2795	0	2795	0
3 1204930					
4 1204931	1	811	707	104	0
5 1204933	4	177	4800	0	0
6					
7					
8					
9					
10					
11					
12					
13					
14					
15					
Column Totals		6947	6747	4613	200.

I, _____, do hereby certify that the above work credits are eligible under subsection 7 (1) of the Assessment Work Regulation 6/96 for assignment to contiguous claims or for application to the claim where the work was done.

Signature of Recorded Holder or Agent Authorized in Writing: David Lindla Date: APR 10/97

6. Instructions for cutting back credits that are not approved.

Some of the credits claimed in this declaration may be cut back. Please check (✓) in the boxes below to show how you wish to prioritize the deletion of credits:

- 1. Credits are to be cut back from the Bank first, followed by option 2 or 3 or 4 as indicated.
- 2. Credits are to be cut back starting with the claims listed last, working backwards; or
- 3. Credits are to be cut back equally over all claims listed in this declaration; or
- 4. Credits are to be cut back as prioritized on the attached appendix or as follows (describe):

RECEIVED
 JUN 12 1997
 MINING LANDS BRANCH

Thunder Bay Mining Division

RECEIVED

Note: If you have not indicated how your credits are to be deleted, credits will be cut back from the Bank first, followed by option number 2 if necessary.

For Office Use Only

Received Stamp Thunder Bay Mining Division	Deemed Approved Date <u>JULY 13, 1997</u>	Date Notification Sent
---	--	------------------------



W9740-184

Personal information collected on this form is obtained under the authority of subsection 6(1) of the Assessment Work Regulation 6/96. Under section 8 of the Mining Act, the information is a public record. This information will be used to review the assessment work and correspond with the mining land holder. Questions about this collection should be directed to the Chief Mining Recorder, Ministry of Northern Development and Mines, 6th Floor, 933 Ramsey Lake Road, Sudbury, Ontario, P3E 6B5.

2.17384

Work Type	Units of Work Depending on the type of work, list the number of hours/days worked, metres of drilling, kilometres of grid line, number of samples, etc.	Cost Per Unit of work	Total Cost
Prospecting	3 days @ 7 hrs 5 days helper @ 7	150 100	5150.00
VLF Survey	1 day		268.00
Assays	17 samples		264.00
Associated Costs (e.g. supplies, mobilization and demobilization).			
Pumping Equipment Rental			428.00
Transportation Costs			
By Road - 2790 km @ 30¢			837.00
Food and Lodging Costs			
Thunder Bay Mining Division			
Total Value of Assessment Work			6947.00

MAY 1 1997

RECEIVED

Calculations of Filing Discounts:

1. Work filed within two years of performance is claimed at 100% of the above Total Value of Assessment Work.
2. If work is filed after two years and up to five years after performance, it can only be claimed at 50% of the Total Value of Assessment Work. If this situation applies to your claims, use the calculation below:

TOTAL VALUE OF ASSESSMENT WORK x 0.50 = Total \$ value of worked claimed.

Note:

- Work older than 5 years is not eligible for credit.
- A recorded holder may be required to verify expenditures claimed in this statement of costs within 45 days of a request for verification and/or correction/clarification. If verification and/or correction/clarification is not made, the Minister may reject all or part of the assessment work submitted.

RECEIVED
JUN 12 1997
MINING LANDS BRANCH

Certification verifying costs:

I, David Kindla (please print full name), do hereby certify, that the amounts shown are as accurate as may reasonably be determined and the costs were incurred while conducting assessment work on the lands indicated on the accompanying Declaration of Work form as recorded holder I am authorized (recorded holder, agent, or state company position with signing authority) to make this certification.

Ministry of
Northern Development
and Mines

Ministère du
Développement du Nord
et des Mines



Geoscience Assessment Office
933 Ramsey Lake Road
6th Floor
Sudbury, Ontario
P3E 6B5

Telephone: (888) 415-9846
Fax: (705) 670-5863

August 28, 1997

DAVID KALJO KINDLA
148 WALKER STREET
P.O. BOX 104
BEARDMORE, Ontario
P0T-1G0

Dear Sir or Madam:

Submission Number: 2.17384

	Status
Subject: Transaction Number(s): W9740.00183	Approval
W9740.00184	Approval

We have reviewed your Assessment Work submission with the above noted Transaction Number(s). The attached summary page(s) indicate the results of the review. **WE RECOMMEND YOU READ THIS SUMMARY FOR THE DETAILS PERTAINING TO YOUR ASSESSMENT WORK.**

If the status for a transaction is a 45 Day Notice, the summary will outline the reasons for the notice, and any steps you can take to remedy deficiencies. The 90-day deemed approval provision, subsection 6(7) of the Assessment Work Regulation, will no longer be in effect for assessment work which has received a 45 Day Notice.

Please note any revisions must be submitted in DUPLICATE to the Geoscience Assessment Office, by the response date on the summary.

If you have any questions regarding this correspondence, please contact Bruce Gates by e-mail at gates_b@torv05.ndm.gov.on.ca or by telephone at (705) 670-5856.

Yours sincerely,

A handwritten signature in black ink, appearing to read "Blair Kite".

ORIGINAL SIGNED BY
Blair Kite
Supervisor, Geoscience Assessment Office
Mining Lands Section

Work Report Assessment Results

Submission Number: 2.17384

Date Correspondence Sent: August 28, 1997

Assessor: Bruce Gates

General Comment:

As the work was logically presented it has been approved on this occasion. For similar submissions in the future please make the following changes:

- 1) Add a bar graph to all maps.
- 2) Include sample numbers on the location maps.
- 3) The prospecting maps are at too large a scale of @1:11,111. Use a more appropriate scale between 1:10 and 1;5,000.

Transaction Number	First Claim Number	Township(s) / Area(s)	Status	Approval Date
W9740.00183	1209268	ELMHIRST	Approval	August 28, 1997

Section:

10 Physical PTRNCH
10 Physical PSTRIP

Transaction Number	First Claim Number	Township(s) / Area(s)	Status	Approval Date
W9740.00184	1209268	ELMHIRST	Approval	August 28, 1997

Section:

9 Prospecting PROSP
14 Geophysical VLF

Correspondence to:

Resident Geologist
Thunder Bay, ON

Recorded Holder(s) and/or Agent(s):

DAVID KALJO KINDLA
BEARDMORE, Ontario

Assessment Files Library
Sudbury, ON

Notes

AREAS WITHDRAWN FROM DISPOSITION

M.R.O. - MINING RIGHTS ONLY
 S.R.O. - SURFACE RIGHTS ONLY
 M.+S. - MINING AND SURFACE RIGHTS

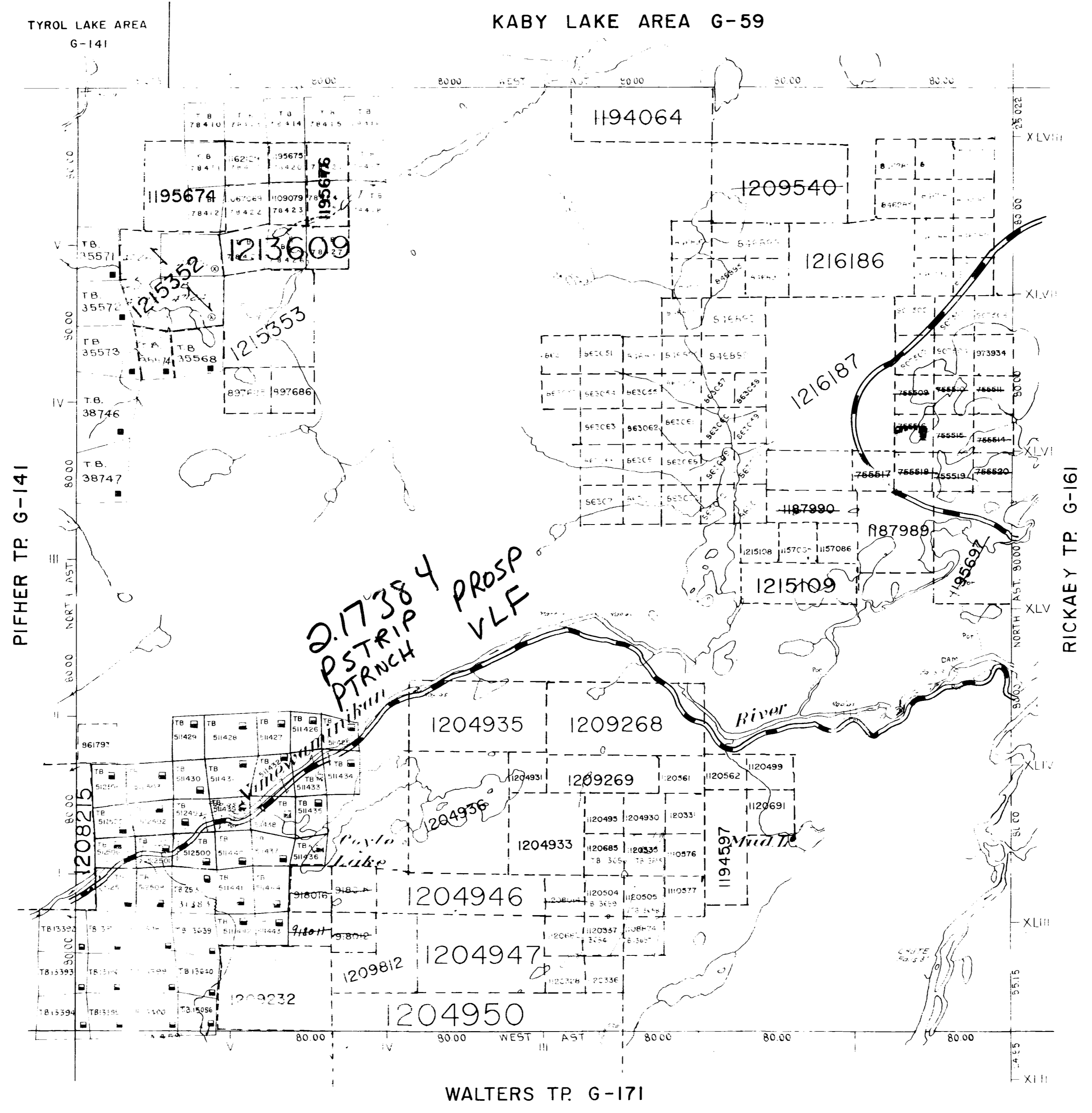

DISPOSITION OF CROWN LANDS

TYPE OF DOCUMENT	SYMBOL
PATENT SURFACE & MINING RIGHTS	●
SURFACE RIGHTS ONLY	○
MINING RIGHTS ONLY	◐
LEASE SURFACE & MINING RIGHTS	■
SURFACE RIGHTS ONLY	□
MINING RIGHTS ONLY	◑
LICENSE OF OCCUPATION (LONG TERM)	▼
ORDER IN COUNCIL	OC
RESERVATION	⊙
CANAL FEED	⊗
SAND TRAVEL	⊕
LAND USE PERMITS FOR COMMERCIAL TOURISM, OUTPOST CAMPS	⊘

NOTE: MINING RIGHTS IN THIS AREA PATENTED PRIOR TO MAY 6, 1962, ARE INVESTED IN THE PUBLIC UNDER THE MINING ACT, R.S.O. 1960, CHAP. 380, SECT. 63, SUBSECT. 1.

LEGEND

HIGHWAY AND ROUTE NO.	—●—
OTHER ROADS	—
TRAILS	- - -
SURVEYED LINES	—
TOWNSHIPS, BASE LINES, ETC.	—
LOTS, MINING CLAIMS, PARCELS, ETC.	—
UNSURVEYED LINES	—
LOT LINES	—
PARCEL BOUNDARY	—
MINING CLAIMS ETC.	—
RAILWAY AND RIGHT OF WAY	—
UTILITY LINES	—
NON PERENNIAL STREAM	—
FLOODING OR FLOODING RIGHTS	—
SUBDIVISION OR COMPOSITE PLAN	—
RESERVATIONS	—
ORIGINAL SHORELINE	—
MARSH OR MUSKEG	—
MIN.	—
TRAVERSE MONUMENT	⊕

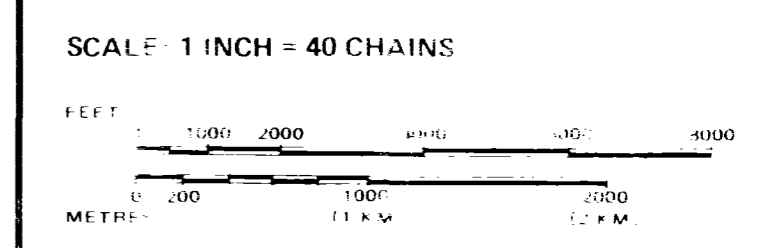

TOWNSHIP
ELMHIRST
 M.N.R. ADMINISTRATIVE DISTRICT
NIPIGON
 MINING DIVISION
THUNDER BAY
 LAND TITLES / REGISTRY DIVISION
THUNDER BAY

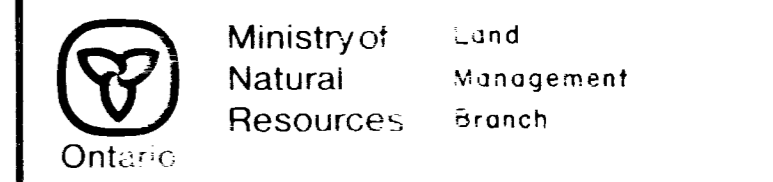

Date: JANUARY 29th, 1981
 Number: **G-162**

NOTICE-
 The information that appears on this map has been compiled from various sources and accuracy is not guaranteed. Those wishing to stake MINING CLAIMS should consult with the MINING RECORDER, Ministry of Northern Development and Mines, for additional information on the status of the lands shown hereon.



Notes

AREAS WITHDRAWN FROM DISPOSITION

M.R.O. - MINING RIGHTS ONLY
 S.R.O. - SURFACE RIGHTS ONLY
 M.+S. - MINING AND SURFACE RIGHTS

TYROL LAKE AREA
 G-141

KABY LAKE AREA G-59

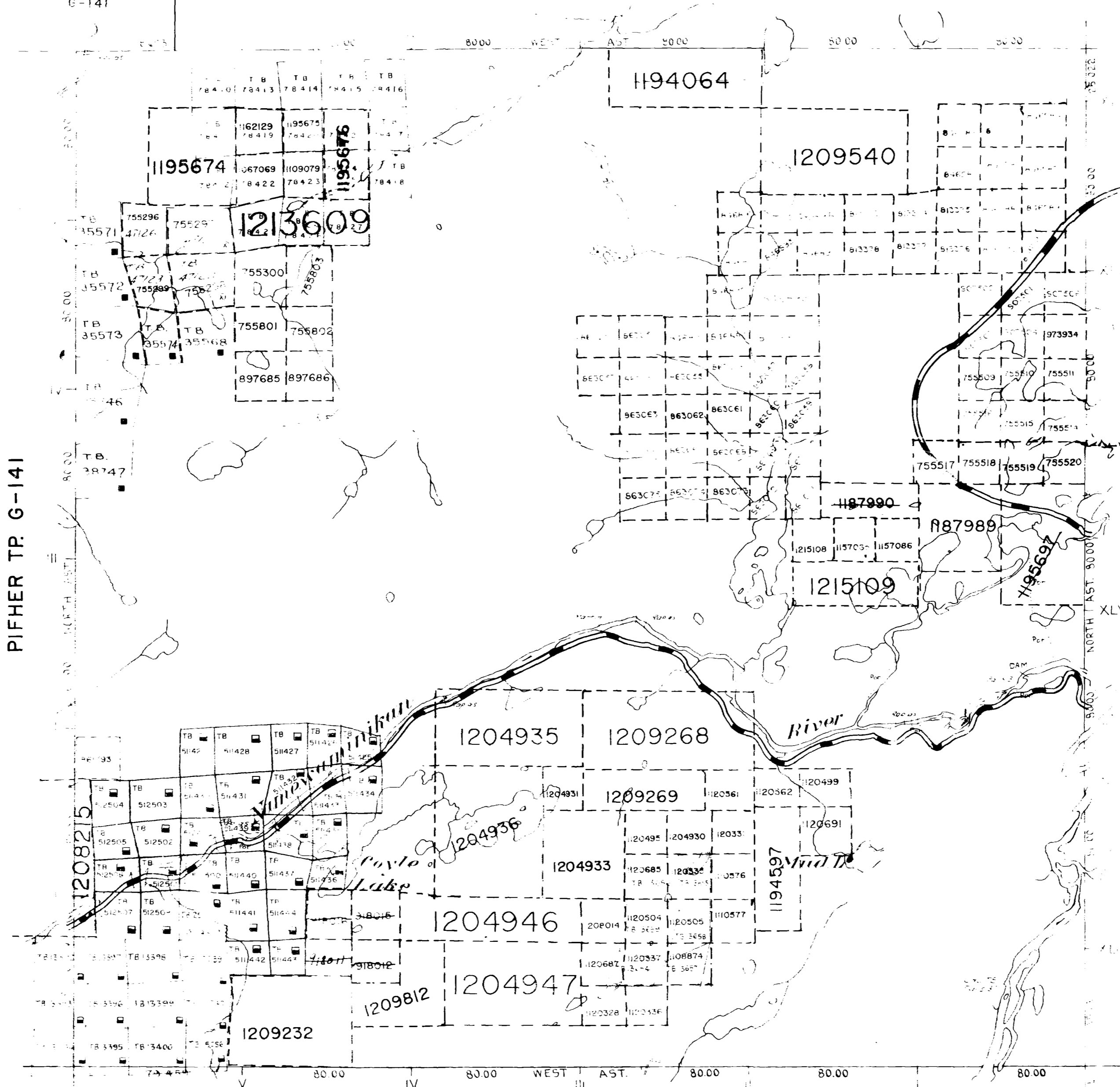

DISPOSITION OF CROWN LANDS

TYPE OF DOCUMENT	SYMBOL
PATENT, SURFACE & MINING RIGHTS	●
SURFACE RIGHTS ONLY	○
MINING RIGHTS ONLY	◐
LEASE, SURFACE & MINING RIGHTS	◑
SURFACE RIGHTS ONLY	◒
MINING RIGHTS ONLY	◓
EVIDENCE OF DEED, MORTGAGE	○
ORDER IN COURSE	○
RESERVATION	○
CANCELLED	○
LAND & GRAVEL	○
AND USE PERMITS FOR COMMERCIAL TOURISM, OUTPOST CAMPS	○
NOTE: MINING RIGHTS IN PARCELS PATENTED PRIOR TO MAY 1, 1913 VESTED IN ORIGINAL PATENTEE BY THE PUBLIC LANDS ACT, R.S.O. 1970, CHAP. 380, SEC. 63 SUBSECTION 1	

LEGEND

HIGHWAY AND ROUTE No.	
OTHER ROADS	
TRAILS	
SURVEYED LINES	
TOWNSHIPS, BASE LINES, ETC.	
LOTS, MINING CLAIMS, PARCELS, ETC.	
UNSURVEYED LINES	
LOT LINES	
PARCEL BOUNDARY	
RAILWAY AND RIGHT OF WAY	
UTILITY LINES	
NON-PERENNIAL STREAM	
FLOODING OR FLOODING RIGHTS	
SUBDIVISION OR COMPOSITE PLAN	
RESERVATIONS	
ORIGINAL SHORELINE	
MARSH OR MUSKEG	
MINES	
TRAVERSE MONUMENT	

SCALE: 1 INCH = 40 CHAINS

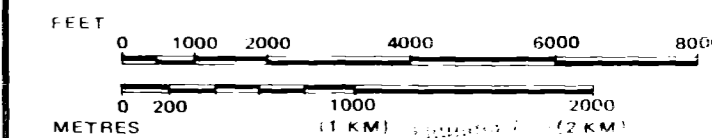

TOWNSHIP

ELMHIRST

M.N.R. ADMINISTRATIVE DISTRICT

NIPIGON

MINING DIVISION

THUNDER BAY

LAND TITLES / REGISTRY DIVISION

THUNDER BAY



210

Date JANUARY 29th, 1981

Number

G-162

Service No.

NOTICE - The information that appears on this map has been compiled from various sources and accuracy is not guaranteed. Those wishing to stake MINING CLAIMS should consult with the MINING RECORDER, Ministry of Northern Development and Mines, for additional information on the status of the lands shown hereon.

WALTERS TP. G-171