



52107NW0001 10 WHIDDON LAKE

010

Diamond Drilling

Area of WHIDDON LAKE

Report N^o 10

Work performed by: Panther-Armstrong

Claim N ^o	Hole N ^o	Footage	Date	Note
KK-20199	14-43-1	245.0'	Jan/59	
	14-43-2	157.0'	Jan/59	
	14-43-3	375.0'	Jan/59	
		177		

Notes:

WHIDDON LAKE N. 2520

LONG - 88° 45' 45"

LAT. - 50° 26' 40"

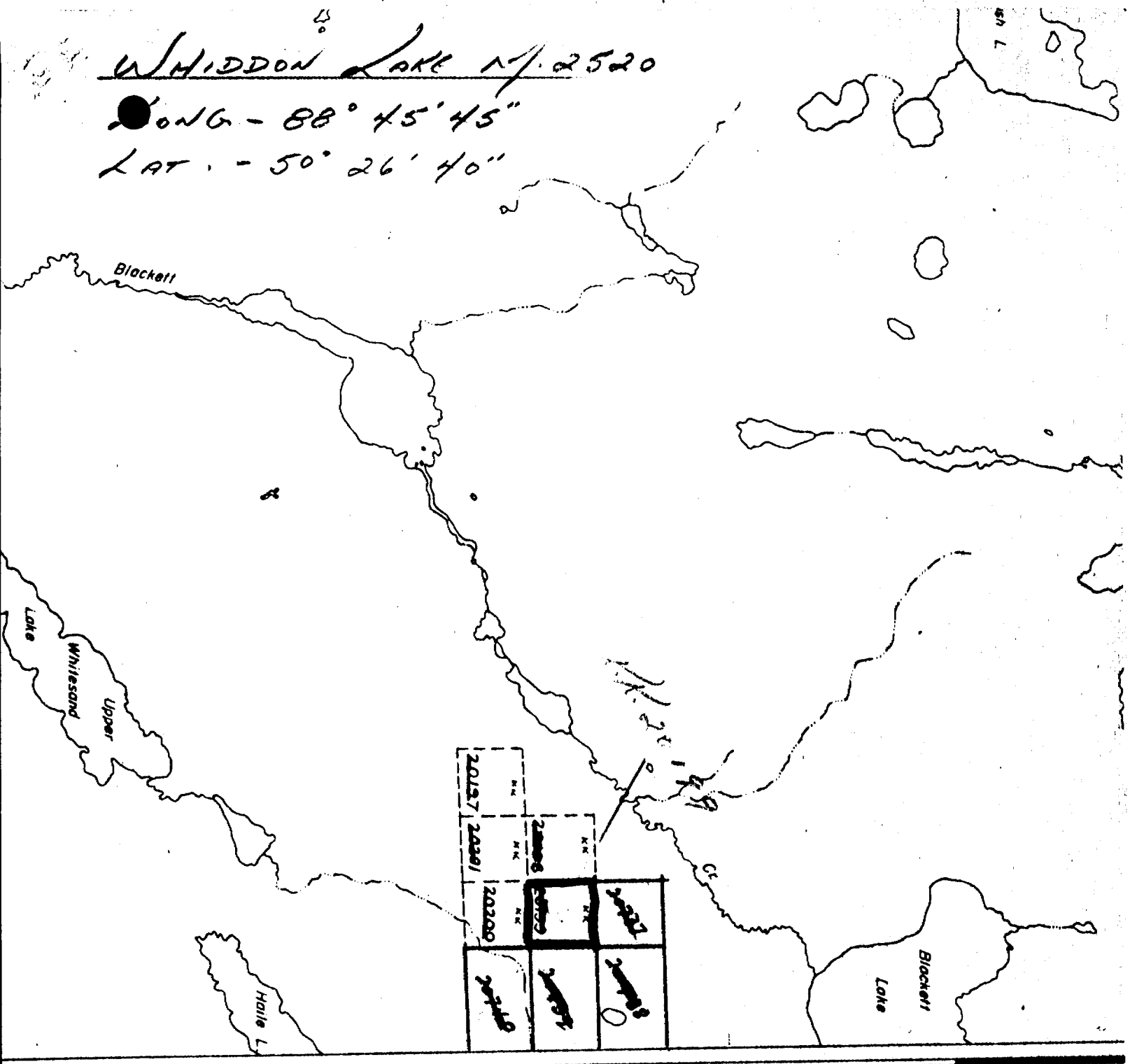

25' 26' 27' 28'

PATENTED
CROWN LAND
LEASES
LOCATED LAND
LICENSE OF
MINING RIGHT
SURFACE RIGHTS
ROADS
IMPROVED ROADS
KING'S HIGHWAYS
RAILWAYS
POWER LINES
MARSH OR
MINES
CANCELLED

400' Reserve
of Lands & Forests

BORE HOLE LOCATION NO - U-43-1,2,3.
DIAGRAMATIC

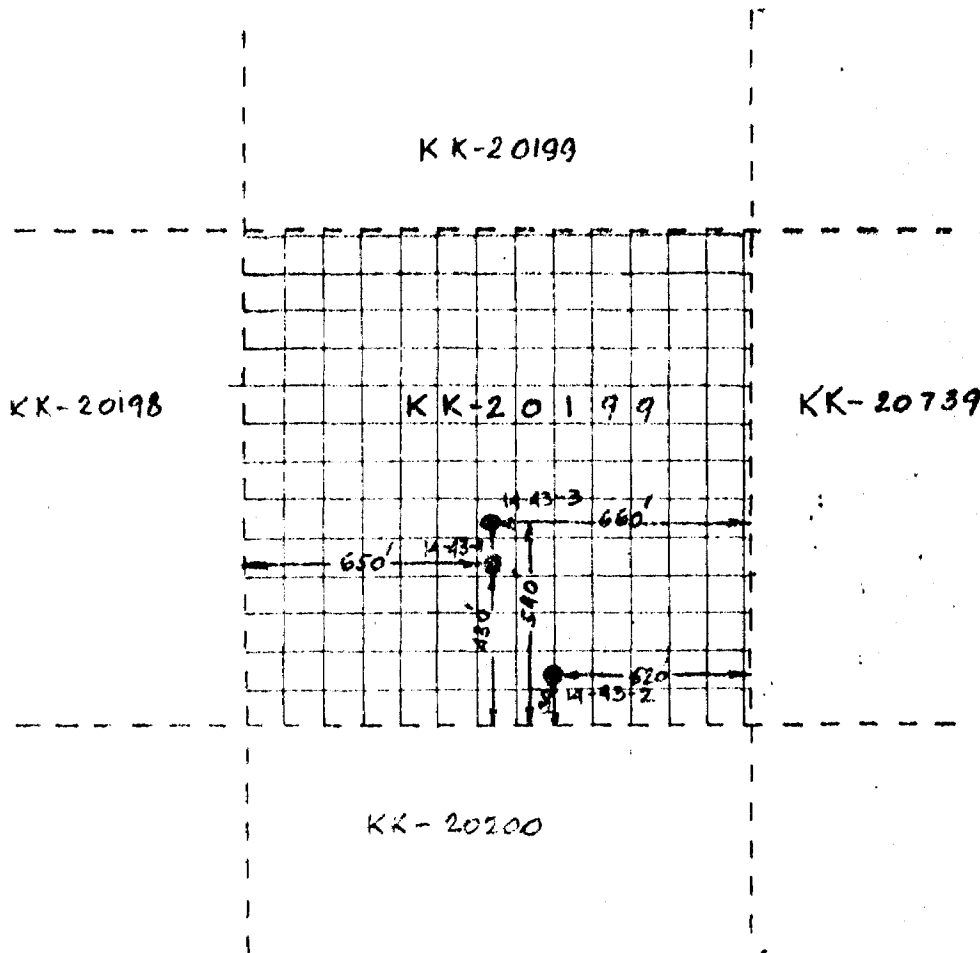

SULMAC EXPLORATION SERVICES LIMITED

PROPERTY **Panther - Armstrong**

SAMPLING RECORD

SHEET NO. **2 of 2**HOLE NO. **14-43-1** DEPTH _____ ANGLE _____ STRIKE _____ ELEVATION _____

CO-ORDINATES _____

DEPTH FEET	FORMATION	SAMPLE NO.	LENGTH FT.	ANALYSIS			LENGTH FEET	PROGRESSIVE TOTALS		
				Cu. %	Ni. %	Au. %		FEET X PER CENT		
150.3	Finely banded silic. tuff									
152.0	1/10 - 1/20 Sulphide Py 100% 1/4 sulphide repl. brecciated tuff 70% Po, 30% Py sample length 1.7'	4185		.19	.45	Tr.	✓ 1.7			
158.6	Fine to med. banded green tuff 1/20 - 1/100 sulphide, 100% Py.									
160.6	1/5 sulphides 95% Py, 5% Po. in dark chloritic schist some graphite	4186		.06	.06	Tr.				
162.0	Aph. Lt. Gy. Siliceous									
162.8	1/5 sulp. 99% Po. Repl. brecciated tuff (sample length 0.8')	4187		.12	.20	Tr.				
211.0	Med. to coarsely banded dk. green tuff Bands at 75° - 80°									
211.5	Chlorite shear									
213.5	Banded tuff									
214.0	Graphitic shear									
220.0	Dk. Gy. finely banded tuff									
245.0	Purplish by. imp. quartzite or silic. tuff									
END OF HOLE										
Started: Jan. 2/59 Completed Jan. 5/59										
AX Core tests taken at 100' -43° corrected										
245' -41° "										
Drilled by Midwest Diamond Drilling Co. Ltd.										
Casing pulled										

C.W. Grant.

PROPERTY

Armstrong
Selassie Lake

SAMPLING RECORD

SHEET NO. 3 of 3

HOLE NO. 14-43-3 DEPTH 375' ANGLE -45° STRIKE 160° ELEVATION

CO-ORDINATES
0 + 00 3 + 10N

DEPTH FEET	FORMATION	SAMPLE NO.	LENGTH FT.	ANALYSIS			LENGTH FEET	PROGRESSIVE TOTALS	
				%	%	%		FEET X PER CENT	
275.0	Fine to medium grained andesite								
295.2	Green-gray finely banded tuff.								
	291.4-295.2 1/20 sulphides								
	100% pyrrhotite. Few garnets banding @ 85°								
319.0	Coarsely banded greenish gray tuff. Fine bands pyrrhotite & pyrite 1/100 - 1/20.								
321.0	Dark Gray banded tuff. pyrite in 2 mm. seams & fractures 1/20								
343.6	Fine to medium banded variegated tuff @ 75° - 85°.								
345.0	Lost core								
368.2	Finely banded variegated tuff - 3' quartz @ 366.2 & 366.9'								
375.0	Fine to medium grained andesite.								
	END OF HOLE								
	Started: Jan. 21, 1959								
	Completed: Jan. 26, 1959								
	AX Core Tests @ 150' - 37°								
	300' - 36°								
	Drilled By: Midwest Diamond Drilling Co. Ltd.								
	Drilling on Claim ER 20199								
	Casing pulled								
	Core recovery 99%								