

2. 26170

# Kingsbay Gold Corporation

Property :	GARNET LAKE
Township :	Belanger Twp. ONT.
Claim No. :	KRL 1143537

Drill Hole GL-01

Date Drilled

Start : July 05 - 2002

Completed : July 10 - 2002

Drill Supervision:

Name : Ken Rivet

Core Logging

Date Logged : Feb 10th 2003

Logged by : D.M. Riggs

Assay Lab.:

2002 - Acarassay, T. Bay

Special Comments: {Casing, water, etc.}

Casing pulled

BO. Inhouse drilling service

Core stored: Kenora, MNDM

*David M Riggs*

## Location

### Collar Co-ordinates

Grid 1 : <u>UTM 17</u>			Grid 2 : .....			Grid 3 : .....		
Northing	Easting	Elevation	Northing	Easting	Elevation	Northing	Easting	Elevation
<u>5651631</u>	<u>513549</u>	<u>445</u>						

### Deviation Measurements :

Method: N/A

Collar Azimuth : 122° Collar Dip : -55°

Depth	Azimuth	Dip	Depth	Azimuth	Dip	Depth	Azimuth	Dip
<u>0</u>	<u>122°</u>	<u>-55°</u>						



**Kingsbay Gold Corporation**

Property: GARNET LAKE

Logger: D. Riggs  
Date: 6/3/2003

DDH: GL-01  
Page No: 1 Core Size: 30

From	To	Feature	Relationships	Sample	From	To	Au
0.00	46.0	Gabbro Medium grained massive gabbro with patchy white to pinkish white feldspar mottling - gradational contacts. Minor veining.					
46.0	61.0	Metabasalt Finer grained and moderately foliated @ 60°C/w weakly-mild carbonatized with 1-5% lg grey to brown carbonate veining & weakly biotitic - moderately biotitic. Transitional contact with above - metabasalt? or foliated microgabbro? Cr-1/2% dissemin py.					
61.0	116.0	Metabasalt - intermediate volcanics. Similar to 46.0-61.0 but greater compositional variation veining and carbonatization. Moderately foliated @ 70°C/w with moderate biotite 3-5% carbonate veining, 3-5% grey veining, occasional white gl veins and patchy irregular siliceous sections - all transposed by fabric. Local 1-3% dissemin py ± cpy associated w @U's (?)	1% cpy Trpy, Cr sphalerite	27098	76.0	77.5	
				27099	81.5	85.5	
				27100	96.0	101.0	
		81.5-86.5 Mottled grey, siliceous & glassy - felsic-intermed. volcanic/silicification? Relatively well defined contacts. - minor sericitic partings @ 70°C/w					
116.0	134.5	Box 7 - LOST IN TRANSPORT. 25% core recovered & similar to boxes 8, containing.					
134.5	196.4	Intermediate to Felsic Volcanics Variable section from green to white glassy to dark grey/black glassy on a 1' to 3' basis - with common sericitic partings & weakly carbonatized. Occasional 6-9" sections similar to					



# Kingsbay Gold Corporation

Property : <i>GARNET LAKE</i>
Township : <i>Belanger Twp., Ont</i>
Claim No. : <i>KRL 1143537</i>

**Location**  
**Collar Co-ordinates**

Grid 1 : <i>WTM 15</i>			Grid 2 : .....			Grid 3 : .....		
Northing	Easting	Elevation	Northing	Easting	Elevation	Northing	Easting	Elevation
<i>5651681</i>	<i>513549</i>	<i>445</i>						

**Deviation Measurements :**  
Method: *N/A*

Collar Azimuth : <i>072</i>	Collar Dip : <i>-55</i>
-----------------------------	-------------------------

Depth	Azimuth	Dip	Depth	Azimuth	Dip	Depth	Azimuth	Dip
	<i>N/A</i>							
<i>0</i>	<i>072</i>	<i>-55</i>						

Drill Hole *GL-02*

Date Drilled  
Start : *JULY 10th 2002*  
Completed : *JULY 12th 2002*

Drill Supervision:  
Name : *Ron Riet*

Core Logging  
Date Logged : *February 10th 2003*  
Logged by : *David M. Rigg*

Assay Lab.:  
*2002 - Accuracy T. Bay*

Special Comments: (Casing, water, etc.)  
*Casing pulled*  
*BQ, In house drilling service*  
*Core Stored: Kenora, MNDM*

*David M. Rigg*



**Kingsbay Gold Corporation**

Property: GARNET LAKE

Logger: JMRijs

DDH: GL02

Date: 10/2/03

Page No. 1 Core Size: BQ

From	To	Feature	Relationships	Sample	From	To	Au		
0.00	2.00'	Overburden / casing							
2.00	55.0	Gabbro - mg Medium grained to coarse grained amphibole in fsp matrix, massive and non-magnetic. Occasional Qc veins @ ~45°CA, 1/4" wide - <1%. Trace interstitial vfg py ± cpy Local sections buff greenish alteration fsp with pink Ksp or replaces gabbro in texture and assoc with QVs. - 0 to 1/2" wide Local sections become finer grained and moderately foliated at 55°CA & with minor biotite.							
55.0	59.9	Gabbro - fg Similar to fg foliated sections above with fabrics @ 45°CA - minor biotite ± 1% fg py ± cpy.							
59.9	68.6	Granophyre Gabbro? Alternating sections of glassy, mottled Qtz-fsp with minor 5-10% amphibole and common 3-6" sections more mafic and foliated @ 45°CA (similar to foliated fg sections above). Sharp contacts. 2-3% fg py ± cpy - silicified gabbro or granophyre gabbro or sheared QFP?		27401	59.9	64.9	15		
				27402	64.9	68.6	12		
	68.6	END OF HOLE							

2.26170

# Kingsbay Gold Corporation

Property :	GARNET LAKE
Township :	Belong 25 Twp, ONT
Claim No. :	KRL 1143537

Drill Hole ...GL-03...

Date Drilled  
 Start : .....  
 Completed : .....

Drill Supervision:  
 Name : Ron Ruet

Core Logging  
 Date Logged : February 10th, 2003  
 Logged by : David M. Rigg

Assay Lab.:  
 2002 - Accurad, T. Bay

Special Comments: (Casing, water, etc.)  
 Casing pulled, BQ Casing  
 In house drilling services  
 Boxes 21-22 Missing  
 Core stored: Kenora, MNDM

David M. Rigg

Location  
 Collar Co-ordinates

Grid 1 : ...UTM 15.....			Grid 2 : .....			Grid 3 : .....		
Northing	Easting	Elevation	Northing	Easting	Elevation	Northing	Easting	Elevation
5651628	513554	AAA						

Deviation Measurements : Collar Azimuth : ...168..... Collar Dip : ...-55.....

Method: N/A

Depth	Azimuth	Dip	Depth	Azimuth	Dip	Depth	Azimuth	Dip
	N/A							
0'	168	-55						



**Kingsbay Gold Corporation**

Property: .....

Logger: D. Rigg

DDH: GL-003

Date: 10/2/2003

Page No. 1 Core Size: BQ

From	To	Feature	Relationships	Sample	From	To	Au	g/t
0	2.5'	Overburden/casing.						
2.5'	23.75	Gabbro - mg Massive medium grained local salt & pepper texture with local Kspars & small amphibolitic sections.						
23.75	56.80	Gabbro (?) fg Relatively massive with 2-5% mm-cm cpx patches & veins moderately foliated @ 45°CA. Moderate to weak biotite & 1-2% foliation po. Common sections of quartz. thin 1" v. QV's. Weakly carbonatized.		27403	27.0	32.0	15	
	46.70-53.80	Quartz Vein Massive white quartz with 1% threads (occasional) of green chlorite and rare 1-1% py ± cpx as mg patches - well developed at lower contact. Sharp contacts @ 45°CA.		27404	46.70	50.0	58	
				27405	50.0	53.80	10	
56.80	129.20	Mafic Volcanic Fine grained, moderately foliated @ 70°CA. Moderately carbonatized and biotite protitic with patches/lenses <math>\frac{1}{4}</math>" - some 3-5% CO veinlets - flattened into foliation and late mylonite QV's <math>\frac{1}{2}</math>" to 1". Weak color & compositional banding may suggest tight folding. Numerous more siliceous "bands" with variable composition 60.1-65.9 Mottled Silicification Massive, grey silica locally fine stringers of cpx-sph up to 3-5% but overall 1%. Gradational contacts						
	77.75-78.10	Chert Sharp contacts @ 60°CA and fine microlensing in dark grey chert bands? Tr vfg py. 3 Bands of <math>< 1</math>" - exhalite?						
			Au, Cu, Zn	27406	60.1	63.9	1.037	ft. 3.8
			Au, Cu, Zn	407	63.9	65.9	4.414	2.0

2.20/5.8'

**Kingsbay Gold Corporation**

Property: Garnet Lake

Logger: DMR

DDH: 6203

Date: 10/2/2003

Page No. 2 Core Size: 30

From	To	Feature	Relationships	Sample	From	To	Au		
		79.4-79.9 Quartz vein Grey massive Qtz @ 60°Cf.							
		80.5 to 81.0, 81.4 to 82.0, 83.3 to 83.9, 85.5 to 86.0, 89.0 to 90.3 "Felsite" A Sharp contacts, vfg - glassy and brownish green, very siliceous and massive with v. micro-fine fabric. Unif. foliated.							
		90.80-92.25 Silicification Similar to 60.1-65.90							
		110.6 to 112.8, 121.4 to 122.8, 123.1 to 123.4 "Felsite" B Grey-red-brown mottled, coarse patches and intrusive.							
129.20	152.0	Granophyre Green mottled - siliceous.							
152.0	162.0	Gabbro - mg-cg. typical.							
162.0	177.5	Granophyre typical - several Q-T veins 1" to 3" are the most siliceous areas - often with gradational contacts suggesting silicification = granophyre							
177.5	216.5	Fg Gabbro Dark green, med - well foliated with shearing at 183P (gauge = 3"). Occasional QV's and Quartz vein-silicified zones (199.0 to 201.5).							
216.5	242.6	Granophyre - typical Green massive mottled.							
242.6	356.0	Gabbro - 7 1/2 boxes - 4 boxes with mixed core (dropped) Some boxes missing core (local prospector), some tag errors do not line up. Most core is gabbro (granophyre) - fg gabbro.	Impossible to detail log.						

356.0 E.O.H.

# Kingsbay Gold Corporation

Property : <i>GARNET LAKE</i>
Township : <i>Belanger Twp, ONT</i>
Claim No. : <i>KRL 1143537</i>

Drill Hole *GL-05*

Date Drilled  
 Start : .....  
 Completed : .....

Drill Supervision:  
 Name : *Ron Riet*

Core Logging  
 Date Logged : *February 11th 2003*  
 Logged by : *David M. Rigg*

Assay Lab.:  
*2002 - Accuassay, T. Bay*  
 .....  
 .....

Special Comments: {Casing, water, etc.)  
*Casing pulled*  
*BQ Inhouse drilling services*  
*Core stored: Kenora MN2M*

David M. Rigg

**Location**  
**Collar Co-ordinates**

Grid 1 :	<i>NTM 15</i>	Grid 2 :	.....	Grid 3 :	.....
Northing	Easting	Elevation	Northing	Easting	Elevation
<i>5651461</i>	<i>513343</i>	<i>453</i>			

Deviation Measurements :      Collar Azimuth : *170°*      Collar Dip : *-50°*

Method: *N/A*

Depth	Azimuth	Dip	Depth	Azimuth	Dip	Depth	Azimuth	Dip
<i>0</i>	<i>170</i>	<i>-50</i>						



**Kingsbay Gold Corporation**

Property: ..... GARNET LAKE .....

Logger: ..... DMZ .....

DDH: ..... G705 .....

Date: ..... 10/2/2003 .....

Page No. ..... 1 ..... Core Size: 30

From	To	Feature	Relationships	Sample	From	To	Au		
0	0.5	CASING							
0.5	187.0'	DIORITE							
	E.O.H.	Fine grained massive mafic intrusive with locally (47.0-66.0' & 95.0-159.0') fsp 1-3% poobovig.							
		Numerous mg. granodiorite dykes and dykelets occasionally with very clear bluegrey quartz content ~30%.							
		11.5-14.5 Milky QV							
		14.5-20.8 Sulphide Stringers - diorite with network of sub <sup>tle</sup> GD dykelets - weakly chl - appears amphibolized <sup>a</sup> with well developed stringers network po + pb ± cpy - up to 25% S. S = stringers less developed in proximity to dykelets.	M. Seve	27408	11.5	14.5			
				27409	14.5	17.5	123		
				27410	17.5	20.8	74		
		23.0-40.5 GD - silica rich around Qtz veins							
		25.5-27.0 QV							
		27.75-30.0 50% QV							
		45.8-52.5 GD - narrow wall rock fragments or multiple dykes (4). ~45% A							
		68.9-71.7 GD							
		73.0 to 80.5 Sulphide Stringers Po + cpy + pb Similar to 14.5-20.8		27411	73.0	77.0	407		
		79.25-80.2 GD cpy dissem & fractures to massive P <sub>2</sub> at lower contact.		412	77.0	80.5	350		
		80.6-87.5 GD		413	85.5	90.0	2A		
		85.5-92.8 Sulphide Stringers Sulphides appear more constrained into conjugate sets (late) at ±15°C.A.		414	90.0	92.8			



# Kingsbay Gold Corporation

Property : <u>GARNET LAKE</u>
Township : <u>Belanger Twp, ONT</u>
Claim No. : <u>KRL/1143537</u>

**Location**

**Collar Co-ordinates**

Grid 1 : <u>UTM 15</u>			Grid 2 : .....			Grid 3 : .....		
Northing	Easting	Elevation	Northing	Easting	Elevation	Northing	Easting	Elevation
<u>5651487</u>	<u>15343</u>	<u>458</u>						

**Deviation Measurements :**

Method: N/A

Collar Azimuth : <u>142</u>	Collar Dip : <u>-50</u>
-----------------------------	-------------------------

Depth	Azimuth	Dip	Depth	Azimuth	Dip	Depth	Azimuth	Dip
<u>0</u>	<u>142°</u>	<u>-50</u>						

Drill Hole GL-06

**Date Drilled**

Start : July 29, 2002  
 Completed : August 04, 2002

**Drill Supervision:**

Name : Ron Ruit

**Core Logging**

Date Logged : February 10, 2003  
 Logged by : David M Rigg

**Assay Lab.:**

2002 Accwassey, T. Bay  
 .....  
 .....

**Special Comments: {Casing, water, etc.}**

Casing Pulled  
BQ Inhouse drilling services  
Core stored: Kenora MNM

David M Rigg



**Kingsbay Gold Corporation**

Property: GARNET LAKE

Logger: DMR

Date: 10/2/2003

DDH: 6706

Page No. 1

Core Size: 30

From	To	Feature	Relationships	Sample	From	To	Au
0.5		Carina					
0.5	147.0	Diorite					
		fin-crained, massive diorite with locally more gabbroic texture; fsp matrix and medium grained amphibole. Diopside exhibits local 1-3% relict, 5% fsp phenocrysts (57.5 to 147.0)					
	2.0 - 14.0	Granodiorite					
		Typical mg-cs texture @ 30°C (some may have been lost from box)					
	11.2 - 12.0	Granodiorite with 20% quartz-dolomite					
	17.20 - 17.60	Granodiorite					
	52.0 - 58.6	Sulfide Zone		27415	52.0	55.3	
		Slightly more biotitic w/ 5-10% fsp ± pyrite traces & clinopy. Less strain than holes #4, #5		27416	55.3	58.6	
	58.6 - 61.75	Granodiorite @ 45°		27417	102.8	107.8	
	66.6 - 69.60	" @ 30°C Pinkish		27418	107.8	112.5	
	84.10 - 84.40	Calcite-Qtz Vein @ 60°C					
	88.75 - 89.75	Granodiorite @ 45°C. Plin-Kspar.					
	90.5 - 91.5	Granodiorite (regular) @ ~15°C					
	113.5 - 134	Dior-Gabbro					
		Patches more gabbroic in texture - diffuse contacts					
	137.0 - 140	Qtz-Feldspar Veins					
		- 3 veins - possible conjugate set of coarse fsp (plag) in quartz 1/2", 3", 1/2" @ 20°, 60° & 20°C					
147.0		END OF BOXES - NO END OF HOLE TAG					

# Kingsbay Gold Corporation

Property : <u>GARNET LAKE</u>
Township : <u>Belonger Twp., ONT</u>
Claim No. : <u>KRL 1143537</u>

Drill Hole GL-08

Date Drilled  
 Start : Aug 05 2002  
 Completed : Aug 12, 2002

Drill Supervision:  
 Name : Ron Ruet

Core Logging  
 Date Logged : February 11th 2003  
 Logged by : David M. Rigg

Assay Lab.:  
2002 - Accurassay T. Bay  
 .....  
 .....

Special Comments: {Casing, water, etc.}  
Casing pulled  
BO Inhouse drilling services  
Core stored: Kenora MNDM

*David M. Rigg*

**Location**  
**Collar Co-ordinates**

Grid 1 : <u>UTM 15</u>			Grid 2 : .....			Grid 3 : .....		
Northing	Easting	Elevation	Northing	Easting	Elevation	Northing	Easting	Elevation
<u>5651447</u>	<u>513337</u>	<u>450</u>						

Deviation Measurements : Collar Azimuth : 172 Collar Dip : -50

Method: .....

Depth	Azimuth	Dip	Depth	Azimuth	Dip	Depth	Azimuth	Dip
<u>0</u>	<u>172</u>	<u>-50</u>						



**Kingsbay Gold Corporation**

Property: GARNET LAKE

Logger: DMR

Date: 10/21/2003

DDH: GT08

Page No: 1

Core Size: BQ

From	To	Feature	Relationships	Sample	From	To	Au
0	0-5	Casing					
0.5	207.0	Diorite Typical for dark mafic intrusives with relatively common wide patches with plagioclase phenocrysts - euhedral up to 1/4". Massive, amphibolitic. 15.50-16.0 Granodiorite, very irregular contacts, pinkish 46.0-54.5 Granodiorite, pale greenish hue contacts @ ±90° CA. Mg and 10-15% amphibole.		27270	20	22	
				27271	22	24	
				27272	24	26	
				27273	26	27	
		61.2-70.5 Sulphide Zone Disseminated to with disseminated stringers py-cpx 5-10% Local coarse bladed amphibole up to 1/4" locally, with euhedral X sections of amphibole in sulphides. - cumulates?		27274	61	62	
				27275	62	64	
				27276	64	66	
				27277	66	68	
		80.0-99.0 Sulphide Zone Locally 20% po+cpx - avg 10-15%. Sulphides in threads, patches & disseminated throughout section, cpx commonly with Qz's but also more prevalent with gtzs-fsptln rich sections.		27278	80	83	
				27279	83	85	
				27280	85	87	
				27281	87	90	
		90.0-91.5 G Diorite		27282	90	92	
		99.5-102.8 Granodiorite @ 45° CA		27283	92	94	
		102.8-112.5 Sulphide Zone 3-5% Py (± po ± cpx) - stringers and mod. foliated.		27284	94	96	
		115.5-117.5 Granodiorite / Granophyre Gradational contacts - granophyre? - lacks typical mg texture.		27285	96	98	
				27286	98	100	
		123.0-124.0 Granodiorite / Granophyre		27287	100	102	
		128.4-129.2 " " " " Sharp contacts @ 20° CA					



2.26170

# Kingsbay Gold Corporation

Property :	GARNET LAKE
Township :	Belonge Twp. ONT
Claim No. :	KRE 1143/537

Drill Hole GL-10.....

Date Drilled

Start : August 13, 2002

Completed : August 20, 2002

Drill Supervision:

Name : Ron Rivet.....

Core Logging

Date Logged : March 05, 2003

Logged by : David M. Rigg.....

Assay Lab.:

2002 - Accuracy, T. Bay.....

Special Comments: (Casing, water, etc.)

Casing pulled - no tags  
BQ in house drilling services  
Core stored: Kenora, MNDM.

## Location

### Collar Co-ordinates

Grid 1 : <u>WTM 15</u> .....			Grid 2 : .....			Grid 3 : .....		
Northing	Easting	Elevation	Northing	Easting	Elevation	Northing	Easting	Elevation
<u>5651466</u>	<u>513350</u>							

Deviation Measurements :

Collar Azimuth : 142..... Collar Dip : -55.....

Method: N/A.....

Depth	Azimuth	Dip	Depth	Azimuth	Dip	Depth	Azimuth	Dip
<u>0</u>	<u>142</u>	<u>-55</u>						

*David M. Rigg*



**Kingsbay Gold Corporation**

Property: .....

Logger: D. Rigg

Date: 6/3/2003

DDH: GL-10

Page No. 1 Core Size: BQ

From	To	Feature	Relationships	Sample	From	To	Au		
0-0	2-0	Caving	(Hole originally had no tags) (Hole depth verified by prior sampling).						
2-0	4-0	Diorite Typical f <sub>g</sub> mafic, massive with minor carbonate & gtz veining Lower contact @ 60° CA							
4-0	14-8	Granodiorite mg, massive Qtz-feldspathic with ≤10% amphibols, 5-10% blue grey gtz. Lower contact @ 50° CA.							
14-8	41-7	Diorite f <sub>g</sub> massive, medium green mafic intrusive with 3-10% 1mm to 3mm feldspar phenocrysts spotted patchily throughout. Minor late calcite fractures ± veins.							
		24.2-25.4 Granodiorite @ 50° CA Same as 4-0-14.8							
		26.0-27.2 Granodiorite Same as 4-0-14.8 Contact @ 20° & 150° CA.							
		28.5-33.8 Granodiorite Same as 4-0-14.8							
		34.0-34.4 Granodiorite Similar to 4-0-14.8, silicified? glassy, less well crystalline							
		35.3-36.0 Quartz Ven Milky Qtz with distinct 1-3mm irregular Tourmaline bands							
41-7	52-5	Gabbro - carbonitized f <sub>g</sub> -mg amphibole rich gabbro massive with calcite microfractures and carbonitized pale interstices. Minor fop phenos							
52-5	64-5	Diorite f <sub>g</sub> massive mafic with 1-3% fop phenos and minor sheeters similar							

**Kingsbay Gold Corporation**

Property: .....

Logger: DMR

Date: 6/3/2003

DDH: GL-10

Page No. 2 Core Size: BQ

From	To	Feature	Relationships	Sample	From	To	Au
		to previous section.					
		< 3% Carbonate veining with associated biotite alteration					
64.5	108.0	Amphibolite - mineralized Most commonly a medium-dark green amphibole rich rock with moderate chloritization & common thin up to 1cm needles of amphibole in semi-alignment parallel to moderate banding @ 45° CA and spotted with euhedral magnetite crystals < 10%. Variable composition with local sections more dioritic in composition and often with up to 10% mg amphibole spotted throughout. ± fsp spots. Minor brown biotite & minor (?) ilmenite. Common throughout is 5-10% disseminated to stringers of po, and < 1% to 3% cpy. Cpy often associated with 1-3% calcite & Qtz veining which is commonly deformed - see damaged & folded with cpy in pressure shadows & rocks of banding in Qtz veins.	Split core 85.0' - 117.0' OK Am Ag Cu	27453	64.5	67.5	
				54	67.5	72.5	
				55	72.5	76.0	
				56	76.0	78.5	
				27332	92	94	
				33		95	
				34		96	
				35		97	
				36		98	
				37		100	
				38		101	
				39		102	
		102.4-103.1 Granodiorite Grey to 10% amphibole.		27340		104	
		107.0-108.0 Granodiorite Similar to 102.4-103.1 w 1" Xenoliths		41		105	
				42		106	
108.0	125.0	Diorite fg massive diorite with < 3% fsp phenocrysts and 3-5% amphibole phenocrysts. Minor calcite veining ± biotite alt. & -1% cpy in stringers & GD in lower 11.0 feet.		43		107	
		109.7-111.0 Granodiorite mg massive & crystalline with 10-15% amphibole & minor cpy - calcite fractures @ 30° CA.		44		108	
				45		110	
				46		112	
				47		113	
				48		115	
				49		116	
125.0	140.5	Granodiorite Massive mg with 10-15% calc & pepper amphibole. ± occasional Xenoliths up to 1"		27350		117	



**Kingsbay Gold Corporation**

Property: .....

Logger: DMZ

DDH: GL-10

Date: 7/3/2003

Page No. 4

Core Size: BQ

From	To	Feature	Relationships	Sample	From	To	Au
293.0	300.5	<p>Mag. Dyke (?) Amphibolite @ 45°C</p> <p>Dark green/black banded @ 45°C, distinct intergrowth of amph-plag with dark black, semi-metallic, non-magnetic mineral - ilmenite? ± 35%. Fine grained with 1% fgs. po.</p>	<p>1% fgs. by Au</p> <p>ICP Au</p> <p>ICP Au</p>	27457	280	285	
300.5	317.2	<p>Int-Felsic Volcanics (Granophyre?)</p> <p>Similar to 255.0-293.0.</p>		27458	293.0	296.0	
317.2	335.6	<p>Amphibolite</p> <p>Medium green, generally massive and fine grained locally flecked with amphibolite to moderately chloritic-carbonatized sections.</p>		59	296.0	300.5	
335.6	343.0	<p>Granodiorite (?) - Granophyre</p> <p>Mottled grey textured with minor sericitic partings rather than crystalline texture of GD. Somewhat similar to mottled sections of 300.5-317.2. Weakly banded at 45°C w/ 15-25% darker - fmg minerals.</p> <p>Sharp contacts @ 45°C</p>					
343.0	411.0	<p>Gabbro</p> <p>fo - Medium grained &amp; massive Gabbro. 1% pyroxene (qtz/ps) matrixed areas carry 35% ilmenite (non magnetic), minor leucocrine.</p> <p>343-356.0 finer grained &amp; similar to 317.2-335.6 - &amp; amphibolitic</p>					
411.0	445.0	<p>Amphibolite</p> <p>Similar to 343-356, fo massive with occasional 1-3mm ilmenite seams, local patches with irregular interstitial fgs (white) disseminated fgs.</p>					
445.0	475.0	<p>Granodiorite - Granophyre</p> <p>Same as 335.6-343.0, 25-30% blue grey qtz &lt; 5mm. to mottled</p>					

Box 24 dropped  
75% core recovered  
454.0 - 474.0.

Kingsbay Gold Corporation

Property: .....

Logger: DMR

Date: 7/3/2003

DDH: GL-10

Page No: 5

Core Size: BQ

From	To	Feature	Relationships	Sample	From	To	Au		
		milky gtz-fsp.							
475.0	486.0	Differentiated Mafic Intrusion. Banded amphibole-biotite mafic intrusion becoming more gtz-feldspathic and medium grained with distinct blue grey gtz with 1-3% fsp & minor ilmenite. Gradational contacts - Differentiated - tops down hole?							
486.0	563.0	Differentiated Mafic Intrusion - similar to various sections in lower part of hole							
		486.0-504.0 Amphibolite same as 343-356, 411-445.							
		504.0-517.0 Microgabbro gradational between the two adjacent sections							
		517.0-534.0 Gabbro same as 343-411 generally fsp-mg with increasing fsp & blue grey gtz content and gradational into next section							
		534.0-553.4 "Granodiorite" Similar to mg. grey GD of previous section with heavy amphibole content 25% 50% - minor 1" Qtz veins - gradational contacts							
		553.4-556.5 Felsic Int Volcs (Granophyre) Similar in part to 255-293 banded							
		556.5-563 "Granodiorite" Same as 534-553.4							



# Kingsbay Gold Corporation

Property : <u>GARNET LAKE</u>
Township : <u>Belanger Twp. DNT</u>
Claim No. : <u>KRL 1143537</u>

Drill Hole GL-11

Date Drilled  
 Start : AUGUST 21, 2002  
 Completed : AUGUST 25, 2002

Drill Supervision:  
 Name : Ron Ruet

Core Logging  
 Date Logged : MARCH 06, 2003  
 Logged by : David M. Rigg

Assay Lab :  
2002 - Accuramex T. Bay  
 .....  
 .....

Special Comments: {Casing, water, etc.)  
Casing Palled  
BQ Inhouse drilling services  
Core stored: Kenora, MNDM

David M. Rigg

**Location**  
**Collar Co-ordinates**

Grid 1 : <u>UTM 15</u>	Grid 2 : .....	Grid 3 : .....																		
<table border="1" style="width: 100%; border-collapse: collapse;"> <tr> <th style="width: 33%;">Northing</th> <th style="width: 33%;">Easting</th> <th style="width: 33%;">Elevation</th> </tr> <tr> <td><u>5651484</u></td> <td><u>513381</u></td> <td><u>449</u></td> </tr> </table>	Northing	Easting	Elevation	<u>5651484</u>	<u>513381</u>	<u>449</u>	<table border="1" style="width: 100%; border-collapse: collapse;"> <tr> <th style="width: 33%;">Northing</th> <th style="width: 33%;">Easting</th> <th style="width: 33%;">Elevation</th> </tr> <tr> <td> </td> <td> </td> <td> </td> </tr> </table>	Northing	Easting	Elevation				<table border="1" style="width: 100%; border-collapse: collapse;"> <tr> <th style="width: 33%;">Northing</th> <th style="width: 33%;">Easting</th> <th style="width: 33%;">Elevation</th> </tr> <tr> <td> </td> <td> </td> <td> </td> </tr> </table>	Northing	Easting	Elevation			
Northing	Easting	Elevation																		
<u>5651484</u>	<u>513381</u>	<u>449</u>																		
Northing	Easting	Elevation																		
Northing	Easting	Elevation																		

Deviation Measurements : Collar Azimuth : 142 Collar Dip : -40

Method: .....

Depth	Azimuth	Dip	Depth	Azimuth	Dip	Depth	Azimuth	Dip
<u>0</u>	<u>142</u>	<u>-40</u>						



**Kingsbay Gold Corporation**

Property: .....

Logger: DMR

Date: 5/3/2003

DDH: GL-11

Page No. 1 Core Size: 3.0

From	To	Feature	Relationships	Sample	From	To	Au
3.0	138.5	Diorite - feldspar-phyrice fine grained medium green massive diorite with 3-5% feldspar phenocrysts spotted throughout. 1-3% Calcite ± gtz veins @ 45° CA. Very locally becomes weakly-moderately foliated with minor biotite					
		Minor narrow Granodiorite dykes @: 22.5-22.8, 30.5-30.7, 45.0-45.5, 45.7-46.0, 46.4-46.7, 66.5-66.8, 70.7-71.0, 72.2-73.6, 75.2-75.4, 77.7-82.7, 87.0-104.4, 106.1-106.4 107.7-112.7, 113.1-113.4, 115.6-117.0, 117.4-118.5 120.9-121.2 -spotted with blue grey gtz.					
		71.0-72.2 Green silicified Diorite? fa grey silicified diorite? - non porphyritic, w/ky foliated 60 to 70° CA		27079	105.0	108.4	
		115.0-115.6 Grey silicified Diorite? Same as 71.0-72.2		80		111.4	
		105.0-107.7 Chl-Sulphide zone Silicified mafic from GD contact at 104.4 to contact @ 105.0. Complex section with generally chloritic v/gy mafics faintly banded @ 45° with more siliceous blue grey sections, local mgt. ± ilmenite (± amphibole) needles & euhedra in chloritic sections ≤ 10% fa po ± cpy disseminations & threads. From 107.7 to 108.4 3% stringer spy cutting GDiorite.		81		113.6	
		111.2-115.6 Chl Sulphide zone Similar to 105-107.7 but weaker sulphide & chlorite. Mafic rocks fsp porphyritic Diorite		82		116.0	

**Kingsbay Gold Corporation**

Property: .....

Logger: DMR

DDH: GL-11

Date: 3/3/2003

Page No. 2 Core Size: EQ

From	To	Feature	Relationships	Sample	From	To	Au
138.5	140.1	GRANODIORITE / QV 60% massive milky gtz coarsening granodiorite - contacts irregular @ ~80°C.					
140.1	168.0	Metavolcanic - similar to "Granophyre" in holes #14 & #16. Very varied section, moderately to strongly carbonitized with pink granitisation between 146-148. Mod-strong colour & compositional banding @ 75-80°C, locally biotitic/charitic/amphibolitic to gtz-feldspathic to "cherty" on a mm-cm scale. Tr-2% fg disseminated locally associated with siliceous sections.					
		162.5 - 166.8 - Felsite - gtz-feldspathic, glassy, minor sericite.					
168.0	177.0	Diorite Non-porphyratic fine grained, massive with mottled - 40% dark green amphibole & blue-grey gtz-fsp textured in upper part. Locally 3% fg po + epu over 6".	QV Check Bt, carb & disseminated Py, Silic & Tr Py.	27083	138.5	140.0	
				27084	154	158.5	
				85	158.5	162.5	
177.0	190.0	Granophyre Pale grey, fine grained, mottled gtz-feldspathic rock with local biotitic partings @ 80°C. Weakly carbonitized and sericitic with trace - 2% fg disseminated in patches.					
	EQ4	- mottled look almost porphyritic locally & similar to "Granodiorite-Granophyre" in part.					
		189.0 - 189.6 Qtz-Tourmaline Ven. @ 30°C. Tr Py.					
		190.0 END OF HOLE					

# Kingsbay Gold Corporation

Property : <u>GARNET LAKE</u>
Township : <u>Belanger Exp., QNT</u>
Claim No. : <u>KRL 1143837</u>

**Location**

**Collar Co-ordinates**

Grid 1 : <u>...WTM...15.....</u>			Grid 2 : .....			Grid 3 : .....		
Northing	Easting	Elevation	Northing	Easting	Elevation	Northing	Easting	Elevation
<u>5651462</u>	<u>513354</u>	<u>451</u>						

**Deviation Measurements :**

Method: ...N/A.....

Collar Azimuth : <u>...197.....</u>	Collar Dip : <u>...-55.....</u>
-------------------------------------	---------------------------------

Depth	Azimuth	Dip	Depth	Azimuth	Dip	Depth	Azimuth	Dip
<u>0</u>	<u>197</u>	<u>-55</u>						

Drill Hole GL-12

**Date Drilled**

Start : Sept 02, 2002  
 Completed : Sept 07, 2002

**Drill Supervision:**

Name : Ron Riset

**Core Logging**

Date Logged : March 06, 2003  
 Logged by : David M. Rigg

**Assay Lab.:**

Acuarassay, T. Bay  
 .....  
 .....

**Special Comments: (Casing, water, etc.)**

Casing pulled  
BQ, Inhouse drilling services  
Core stored, Kenora, MNDM

David M. Rigg



**Kingsbay Gold Corporation**

Property: .....

Logger: *D.M. Rigg*

Date: *6/3/2003*

DDH: *GL-12*

Page No. *1*

Core Size: *BQ*

From	To	Feature	Relationships	Sample	From	To	Au		
<i>6</i>	<i>1.0</i>	<i>Carthage</i>							
<i>1.0</i>	<i>24.6</i>	<i>Gabbro</i> <i>fg-mg, massive gabbro. Weakly carbonatized and 1% fsp phenocrysts. Minor CA veining &amp; occasional narrow granodiorite dykelets &lt; 3" @ 30°C.A. &amp; foliated @ 30°C.A.</i> <i>- non magnetic</i>							
		<i>1.0 - 2.0 Granodiorite</i> <i>mg Qtz-fsp, pink granodiorite @ 30°C.A. Rare blue grey Qtz veins @ 45°C.A.</i>							
<i>24.6</i>	<i>85.7</i>	<i>Microgabbro / Diorite</i> <i>fa, massive, medium-dark green with weak-moderate carbonatization, 3-5% carbonatite veining and local mg sections more reminiscent of gabbro.</i> <i>- non magnetic</i> <i>Generally 1-3% &lt; 1.2mm fsp phenocrysts spotted irregularly throughout. From 65.0 feet - 3-5% fsp. phenocrysts up to 5mm.</i>							
		<i>45.8-46.0 &amp; 47.4-47.7 Qtz-Fsp. Dykelets</i> <i>Mg white to pink (roper) fsp rich contacts with Qtz rich cores @ 45°C.A.</i>							
		<i>78.7-80.0 Granodiorite</i> <i>mg to glassy, grey granodiorite &lt; 10% ferromagnesian @ 45°C.A</i> <i>- amphibole</i>							
<i>85.7</i>	<i>92.8</i>	<i>Diorite - Intermediate Dyke</i> <i>Massive, fine grained medium green dyke with overprinting pinkish tinge to groundmass areas around mafic crystals - locally strongly developed adjacent to microfractures</i>							

**Kingsbay Gold Corporation**

Property: .....

Logger: DJR

DDH: GL-12

Date: 6/3/2003

Page No. 2

Core Size: BQ

From	To	Feature	Relationships	Sample	From	To	Au	Cu
92.8	94.75	Amphibolitic - sulphide zone Vfg, black amphibolite, strongly magnetic with <25% fg crystalline magnetite ± ilmenite and <5% fg cpy ± po disseminations and threads in foliation parallel seams @ 60°CA. Massive						
94.75	98.0	Granodiorite Dark Grey, glassy and locally mg(-silicified?) granodiorite. Lower 12" marked by 2-4% fg dissem. cpy and v. fine cpy films on fractures - remobilised. Contacts sharp at 60°CA.		27086	92.8	94.75		
				87	94.75	98.0		
98.0	137.10	Diorite - non magnetic fg, massive medium grained diorite. V. rare <1mm fsp phenocrysts. with up to 5% from 117.0-129.0 - but patchy, minor veining, increasing towards lower contact - calcite. 115/116.0 Feldspar Dyke Several narrow, fg amorphous white-pink fsp dykelets @ 30°CA V. minor quartz.		27088	151.7	156.7		
				89	156.7	159.2		
				90	159.2	161.7		
				91	161.7	166.7		
				92	166.7	171.7		
137.10	173.0	Mafic Metavolcanics fg, dark green banded metavolcanics with banding defined by amphibol-pyroxene & paler grey qtz-carbonate rich seams - transparent veins & alteration (?) @ 70°CA Local narrow bands silicified with 1-3% dissem. py. <1/2% fg dissem py throughout.						
		138.70 - 143.50 Granodiorite Similar to 78.7-80.0 with local pinkish alteration and 20% fg dark green diorite xenoliths - some demonstrate feldspathization (see below).						
		143.5 - 147.4 Feldspathized Diorite (?) Strange textured dyke like intrusive with 60% irregular						

**Kingsbay Gold Corporation**

Property: .....

Logger: DMR

Date: 6/3/2003

DDH: GL-12

Page No. 3 Core Size: 30

From	To	Feature	Relationships	Sample	From	To	Au		
		to blebby vfg feldspar masses, rounded to angular and often with rounded amphibole to embayed amphibole, to locally intergrow.							
		≤40% dark green amphibole, fgs.							
173.0	215.0	Intermediate to Felsic Volcanics.		27093	174.0	179.0			
	E.O.H.	Variable section of pale grey, fine grained siliceous rocks locally glassy with buff grey coloration. Common sericitic partings @ 70°C or weakly biotitic in more intermediate areas.		94	179.0	184.0			
		Zr pyrox, vfg disseminated in glassy sericitic section.		95	184.0	189.0			
				96	189.0	194.0			
				97	204.7	209.0			
		198.8-204.7 Microgabbro							
		Massive, dark green fine grained mafic dyke with dark amphibole. Weakly chloritic. Weak-moderate contact parallel foliation @ 30° - best developed at contact's							
		212.9-214.1 Chl-Bt Altered Mafic							
		Strong brown biotitisation and moderate chloritisation (weak carbonate) of amphibolitic rock possibly similar to 198.8-204.7 (?). 5% milky grey to blue grey quartz veins.							

# Kingsbay Gold Corporation

Property : <u>GARNET LAKE</u>
Township : <u>Belanger Twp, ONT</u>
Claim No. : <u>KRL 1143537</u>

**Location**

**Collar Co-ordinates**

Grid 1 : <u>...UTM 15...</u>			Grid 2 : .....			Grid 3 : .....		
Northing	Easting	Elevation	Northing	Easting	Elevation	Northing	Easting	Elevation
<u>5651459</u>	<u>513356</u>	<u>451</u>						

**Deviation Measurements :**

Collar Azimuth : <u>...142.....</u>	Collar Dip : <u>...-43.....</u>
-------------------------------------	---------------------------------

Method: .....

Depth	Azimuth	Dip	Depth	Azimuth	Dip	Depth	Azimuth	Dip
<u>0</u>	<u>142</u>	<u>-43</u>						

Drill Hole GL-13

**Date Drilled**

Start : Sept 08, 2002  
 Completed : Sept 14, 2002

**Drill Supervision:**

Name : Ron Ruet

**Core Logging**

Date Logged : March 07, 2003  
 Logged by : David M. Rigg

**Assay Lab.:**

2002 - Accursay T. Bay  
 .....  
 .....

**Special Comments: {Casing, water, etc.}**

Casing Pulled  
B.O. Inhouse drilling services  
Core stored : Kenora, MNDM

David M. Rigg



Kingsbay Gold Corporation

Property: ... GARNET LAKE .....

Logger: DMRig  
Date: 4/3/2003

DDH: GT-13  
Page No. 1

Core Size: BQ

From	To	Feature	Relationships	Sample	From	To	Au
0	53-25	Gabbro fg-mg massive gabbro, weakly-moderately carbonatized 1-3% plagioclase phenocrysts, spotted irregularly throughout. Amphibole up to 1/4" most clearly observed in more carbonate rich areas. Non-magnetic. 1-3% Calcite ± Qtz veins Becomes finer grained towards lower contact with mg sections. 31.6-33.2 Felsic Dyke 30% patchy to semi-crystalline Qtz in buff feldspathic matrix, <5% amphibole/bt Contacts @ 70°C. 34.4-34.8 Granodiorite mg granodiorite @ 70°C.					
53-25	13A-90	Microgabbro Relatively fine grained and massive with local <1% feldspar phenocrysts, local patches more mg gabbro, local magnetite and rare titanite defining foliation @ 50°C. 3-5% Qtz veins. 53-25-60.20 Contact phase? Amphibolite More granular to moderately foliated chloritic section with local 3-5% po, py wisps & threads along foliation. High density with up to 1/4" amphibole needles. Foliation @ 50°C. 56.70-58.0 15% Py+po, 1-3% cpy. 58.1-58.60 Granodiorite (-granophyre?) Dominantly Qtz-feldspar with 5-10% mg amph-biot. DF is not well crystalline almost amorphous and contacts can be indistinct @ 70°C. 60.2-67.7 Granodiorite - granophyre Same as 58.1-58.6 - local blue grey Qtz, local veinlets Qtz with minor pink (Ksp?) staining.		27057	53-25	56-70	
				27058	56-70	58-0	

**Kingsbay Gold Corporation**

Property: GARNET LAKE

Logger: DMR

DDH: 67-13

Date: 5/3/2003

Page No. 2 Core Size: BQ

From	To	Feature	Relationships	Sample	From	To	Au
		69.0 - 74.8 Granophyre - Granodiorite Similar to 60.2 - 67.7 with increasing ferromagnesian content towards indistinct lower contact. Local sections < 6" similar to 56.7 - 58.0 with up to 5% cby over 6"					
		73.2 - 74.8 Alternating bands of fg amphibolite & gtz-fsp granophyre - contacts do not look intrusive		27059	73.2	74.8	
		88.8 - 93.0 Granophyre - Granodiorite Same as 69.0 - 74.8. Weak foliation @ 60° d. & parallel cardinal					
		94.9 - 104.9 Granophyre - Granodiorite Same as 88.8 - 93.0					
		106.3 - 107.0 Same as 88.8 - 93.0					
		Similar narrow Granophyre - GTD at 116.2 - 116.4, 116.6 - 117.0, 126.1 - 126.6, 128.6 - 129.0, 131.1 - 131.40 and 132.7 to 134.90					
134.90	155.0	Metabasalt - carbonitised E.O.H. Fine grained light green to very pale green carbonitised basalt with moderate banding @ 70° CA = biotite & Qtz veins. Common irregular patches up to 6-9" long with up to 50% pink to white fsp-gtz irregular patches & networked veins - granitisation? - contact phase of Gabbro.					

# Kingsbay Gold Corporation

Property : <u>GARNET LAKE</u>
Township : <u>Bdagar Twp, ONT</u>
Claim No. : <u>KRL 1143537</u>

Drill Hole GL-14

Date Drilled

Start : Sept 15, 2002  
 Completed : Sept 25, 2002

Drill Supervision:

Name : Ron Riet

Core Logging

Date Logged : March 07, 2003  
 Logged by : David M. Rigg

Assay Lab.:

Accurassay, Thunder Bay  
 .....  
 .....

Special Comments: (Casing, water, etc.)

Casing Pulled  
BQ / Inhouse drilling services  
Core stored: Kenora, MNDM

David M. Rigg

**Location**

**Collar Co-ordinates**

Grid 1 : <u>UTM 15</u>			Grid 2 : .....			Grid 3 : .....		
Northing	Easting	Elevation	Northing	Easting	Elevation	Northing	Easting	Elevation
<u>5651479</u>	<u>513333</u>	<u>458</u>						

Deviation Measurements :

Collar Azimuth : <u>142</u>	Collar Dip : <u>-45</u>
-----------------------------	-------------------------

Method: .....

Depth	Azimuth	Dip	Depth	Azimuth	Dip	Depth	Azimuth	Dip
<u>0</u>	<u>142°</u>	<u>-45°</u>						



**Kingsbay Gold Corporation**

Property: GARNET LAKE

Logger: DM Riggs  
Date: 5/3/2003

DDH: GL 14  
Page No. 1

Core Size: BQ

From	To	Feature	Relationships	Sample	From	To	Au
0.00	7.00	CASING		27119	57	58	
7.00	55.80	GABBRO Typical medium to coarse grained gabbro massive & non-magnetic. Weakly - moderately carbonated with minor calcareous + Qtz veining @ 30°C.A. Common 1-5% fsp. phenocrysts 1/16 to 1/8 inch		27120		59	
		37.2 - 39.9 Granodiorite mg crystalline Qtz-fsp-5% Amph Sharp contacts @ 80' with large 3" xenoliths at lower contact.		21		60	
				22		62	
				23		63	
				24		65	
				25		68	
				26		70	
				27		71	
				28		72	
				29		73	
55.80	58.0	Granodiorite Small Xenolith at upper contact - 1" Similar to 37.2-39.9 mg crystalline becoming less clearly crystalline & grey in colour with local patches of pink-Ksp Contacts @ 75°C.A.		27130		74	
				31		75	
				32		76	
				33		77	
				34		78	
				35		79	
58.0	93.0	Amphibolite - microgabbro. - mineralized fg-mg dark amphibolite with needle-like amphibole and disseminated magnetite. Locally microgabbroic and rare Qtz-fsp patches. Magnetite up to 1/4 inch and euhedral. 10-15% po +/- cpy, locally up to 25% as semimassive stringers, stringer breccia veils, interstitial threads and networks and as local concentrations (cpy) in mass Qtz-feldspathic sections. Po+cpy later than myt. 56.5-74.7 previously sampled. Moderate fabric @ 60°C.A.		36		81	
				37		82	
				38		84	
				39		85	
				27140		86	
				41		87	
				42		88	
				43		90	
				44		91	
				45		92	
93.0	135.5	Diorite Typical fine grained dark green diorite with 3-5% fsp. phenocrysts & minor < 3% Qtz veining. Massive, non magnetic.		46		94	
				47		95	
				48		97	
				27149		98	

**Kingsbay Gold Corporation**

Property: .....

Logger: DMR

DDH: GL-14

Date: 5/3/2003

Page No. 2

Core Size: BQ

From	To	Feature	Relationships	Sample	From	To	Au		
		108.0 - 112.5 Granodiorite							
		"Salt & Pepper" mg granodiorite with 30-40% angular Xenoliths of diorite & gabbro - up to 3" in white Q-F matrix. 10% amphibole. Contact @ 70°C							
		115.0 - 125.3 Granodiorite							
		Similar to 108.0 - 112.5 with rare 1" Xenoliths @ 50°C							
		130.5 - 132.4 Granodiorite							
		Similar to 115.0 - 125.3. Rare QV 1/2" @ 30°C @ 50°C							
		133.9 - 134.5 Granodiorite							
		Same as 130.5 - 132.4							
155.5	203.5	Diorite - microgabbro							
		Similar to 93.0 - 155.5 but with patchy distribution of up to 5% white fsp phenocrysts and with minor sections with 10-25% amphibole phenocrysts up to 1/4"							
		Locally 2-3% fsp interstitial po		27060	1630	166.0			
		197.0 - 203.5 Silicified?							
		Becomes more siliceous - gradational contact with local 5% disseminated pyrite. Moderate fabric/banding @ 30°C							
203.5	225.3	Granophyre - granodiorite							
		Glassy - quartz feldspethic grey intrusive with 5-10% blue grey quartz in lower section. Lower contact sharp @ 20°C. Upper contact gradational with increasing Qtz-fsp content and decreasing fabric strength to 210.0. Weakly carbonatized.							
225.3	230.5	Microgabbro							
		Massive with 20% amphibole < 1/4" local pinkish hue to matrix.							

Kingsbay Gold Corporation

Property: .....

Logger: DMZ

Date: 5/3/2003

DDH: GL-14

Page No. 3

Core Size: BQ

From	To	Feature	Relationships	Sample	From	To	Au		
230.5	243.2	Granitised Gabbro - carbonitised Medium green fine grained mafic intrusive, with 30-40% irregular pink to grey fsp masses - crosscut by irregular network of calcite and amphibole fractures, and late calcite veins. Massive. Lower contact marked by 3" irregular milky quartz vein & upper contact by strongly carbonitised, moderately banded (E vein?) fq section. Banded @ 40°CA.							
243.2	251.1	Diorite Fine grained with 1-3% fsp phenocrysts. Weakly carbonitised & with 1-3% Calcite Veins. Contacted 30°CA.							
251.1	345.9	Granophyre Fine grained, light grey - med grey coloured, mod-strongly carbonitised and moderately banded/foliated @ 30°CA gtr fsp/epidote rock. Local sericite or distinct biotitic layering / patches parallel foliation. 311.5 - 326.4 - more mafic/amphibolitic & with up to 10% biotite 326.4 - 345.9 - more massive with weaker biotitic fabric, mostly gtz-fsp and somewhat similar to non-crystalline "Granophyre - Granodiorite". Contacts relatively sharp.							
345.9	445.0	Gabbro Variable fq to vca (almost pegmatitic) gabbro Minor py along late calcite fractures, occasional Q-Tow Veins. Grain size variations appear gradual with fq sections more amphibolitic - locally with heavy mt accumulation							



# Kingsbay Gold Corporation<sup>2</sup>

Property : <u>GARNET LAKE</u>
Township : <u>Belonger Twp., Q.N.T.</u>
Claim No. : <u>KRL 1143537</u>

Drill Hole GL-15.....

Date Drilled  
 Start : Sept 26, 2002  
 Completed : Sept 30, 2002

Drill Supervision:  
 Name : Ron Riset

Core Logging  
 Date Logged : March 07, 2003  
 Logged by : David M. Rigg

Assay Lab.:  
2002 - Accurately T. Bay  
 .....  
 .....

Special Comments: (Casing, water, etc.)  
Casing Pulled  
BQ, In house drilling services  
Core stored: Kenora, MNDM

David M. Rigg

**Location**  
**Collar Co-ordinates**

Grid 1 : <u>UTM15</u> .....			Grid 2 : .....			Grid 3 : .....		
Northing	Easting	Elevation	Northing	Easting	Elevation	Northing	Easting	Elevation
<u>5651479</u>	<u>513333</u>	<u>458</u>						

Deviation Measurements :      Collar Azimuth : 142.....      Collar Dip : -55.....  
 Method: N/A.....

Depth	Azimuth	Dip	Depth	Azimuth	Dip	Depth	Azimuth	Dip
<u>0</u>	<u>142°</u>	<u>-55</u>						



**Kingsbay Gold Corporation**

Property: GARNET LAKE

Logger: DM Rigg  
Date: 4 March 2003

DDH: GL-15  
Page No: 1

Core Size: BR

From	To	Feature	Relationships	Sample	From	To	Au		
0	4.0	Casing							
4.0	45.8	Diorite Fine grained, medium green coloured mafic intrusive with 1-3% plagioclase phenocrysts spotted throughout. Massive. Very poorly foliated @ 70°C.A.  Min (< 3%) milky Qtz-carbonate veins 1/2 to 1" wide @ 70°C.A spotted throughout this section. Rare irregular < 1" pink fq granitic irregular dykelets (at 24.0-25.0 feet).  Lower contact sharp @ 70°C.A. with 1" biotite rich alteration margin in Diorite.							
45.8	58.8	Granodiorite Pale grey-white, medium grained quartz-feldspathic intrusive with 5-10% ferrimagnesian minerals & common angular < 1" diorite Xenoliths - angular. Biotitic with minor chlorite. Common larger diorite Xenoliths up to 3-12" at 53.3-54.6 & 58.3-58.6.  Tr. 1/2% vfg disseminated bodies & rare chl-py seams on late fractures.							
58.8	63.0	Diorite Same as 4.0-45.8' Upper contact sharp @ 45°C.A. Lower contact @ 45°. Minor narrow GD & granophyric dykelets.							
63.0	68.2	Granodiorite Similar to 45.8-58.8' Upper 12" with green amphibole up to 15-20% (assimilation of wallrocks), up to 15-20% blue-green quartz and mg-cg texture. Local pink stained, local Xenoliths. Tr sulphide dissemin.							
68.2	71.0	Diorite Upper contact irregular @ 80°C.A. Lower contact - highly irregular. 5-10% plag, phenos.							
			Type - samples - check for Au in dissemin s = in GD.	27051	45.8	49.9			4.1'
				27052	49.9	54.0			4.1'

**Kingsbay Gold Corporation**

Property: .....

Logger: JMR  
Date: 4/3/2003

DDH: GT-15  
Page No. 2

Core Size: 30

From	To	Feature	Relationships	Sample	From	To	Au
71.0	81.4	Amphibolitic Granodiorite Amphibolitic rich 20-25% Quartz-feldspathic mg intrusive. Massive with v. minor gtz veins, locally pinkish stained + chlt + Tow. (fracture controlled) & similar in lower part to 63-68.20 with blue grey gtz.					
81.4	83.9	Diorite Upper contact - several irregular Amph. GD dykelets - irregular Lower contact - sharp @ 60° CA. Similar to 4.0-45.8 1-3% plagiophenes.					
	82.5-82.9	"Granophyre" Gassy, grey blue, fgy siliceous intrusive @ 70° CA. V. minor pink staining along & adjacent to fracture.					
83.9	85.0	Mafic Volcanic Xenolith Foliation - moderate to strong in matrix. & biotitic mafic volcanic with strongly folded Calcite, gtz veins. Foliation axial planar to folds. Fine grained. 3-5% local 1/8" amphibole needles - randomly oriented.					
85.0	88.3	Quartz Vein Massive milky quartz @ 70° CA to 2-1/2% potashy minor < 3% c.g. calcite - amphibole & chl. biot rich contact parallel partings.		27053	81.4	85.0	
				27054	85.0	88.3	
88.3	96.5	Diorite Same as 4.0-45.8					
96.5	112.2	Granodiorite Similar to 71.0-81.4 with weaker amphibole - ferromagnesian & local weak biotitic cleavage developed @ 45° CA. Lower Contact weakly - moderately sheared over 2.0 feet @ 55° CA.					

Kingsbay Gold Corporation

Property: GARNET LAKE

Logger: DMR

DDH: GT-15

Date: 11/3/2003

Page No. 3

Core Size: 300

From	To	Feature	Relationships	Sample	From	To	Au
112.2	185.0	Diorite					
	204	Same as 68.2-71.0.					
		Late calcite fractures @ $\pm 20^\circ CA$ , $\leq 1/16"$					
		115.0 - 116.0 "Amphibolitic G.D. dyke"					
		V. fg pink feldspar, massive matrix with bands of needle-like amphibole needles $\leq 50\%$ . Contacts relatively sharp but convoluted with diorite grey S. l. facies $\pm 1-2"$ of contact.					
		A fine grained dark mafic rx generally with 1-5% feldspar phenocrysts. Noticeable grain size variations and more amphibolitic sections with possible crude layering from almost pegmatitic amphibole + feldspar to mg amphibolitic - fg amphibolite to fg diorite in sections at 127.1 to 134.0 and 175.6 to 180.0. Noticeable interstitial cpy disseminations in narrow fg amphibolitic sections at 129.6 - 130.5 & 179.0-180.0. - $\leq 5\% - 10\%$ cpy.		27055	129.0	130.5	
		136.1 - 141.0 Granodiorite		27056	179.0	180.0	
		Pink, medium grained to grey mg granodiorite with sharp contacts.					
		137.75 - 139.1 Xenolithic					
		- highly irregular contacts with diorite - Xenoliths?					
		178.0 - 179.3 Granodiorite					
		Pink, medium grained, typical, 3-5% cpy in lower 3" as fractures & disseminations (remobilized)					
		179.7 - 180.7 Granodiorite					
		Grey, similar to 178.0-179.3 with 1" semi massive cpy at upper contact.					

3. 201 70

### Kings Bay Gold Corporation - Garnet Lake Project

Hole ID	Length (Feet)	Azimuth (Deg.)	Dip (Deg.)	UTM 15 - NAD 83			Started	Completed
				N	E	Elevation		
GL-01	216	122	-55	5651631	513549	445	JULY 5/02	JULY 10/02
GL-02	68.6	72	-55	5651631	513549	445	JULY 10/02	JULY 12/02
GL-03	356	168	-55	5651628	513554	444	JULY 13/02	JULY 20/02
GL-05	187	170	-50	5651461	513343	453	JULY 21/02	JULY 28/02
GL-06	147	142	-50	5651487	513343	458	JULY 29/02	AUG 4/02
GL-08	207	172	-50	5651447	513337	450	AUG 5/02	AUG 12/02
GL-10	573	142	-55	5651466	513350	451	AUG 13/02	AUG 20/02
GL-11	190	142	-40	5651484	513381	449	AUG 21/02	AUG 25/02
GL-12	215	197	-55	5651462	513354	451	SEPT 2/02	SEPT 7/02
GL-13	155	142	-43	5651459	513356	451	SEPT 8/02	SEPT 14/02
GL-14	445	142	-45	5651479	513333	458	SEPT 15/02	SEPT 25/02
GL-15	185	142	-55	5651479	513333	458	SEPT 26/02	SEPT 30/02
Total	2944.6							

**RECEIVED**  
AUG 28 2003  
GEOSCIENCE ASSESSMENT  
OFFICE



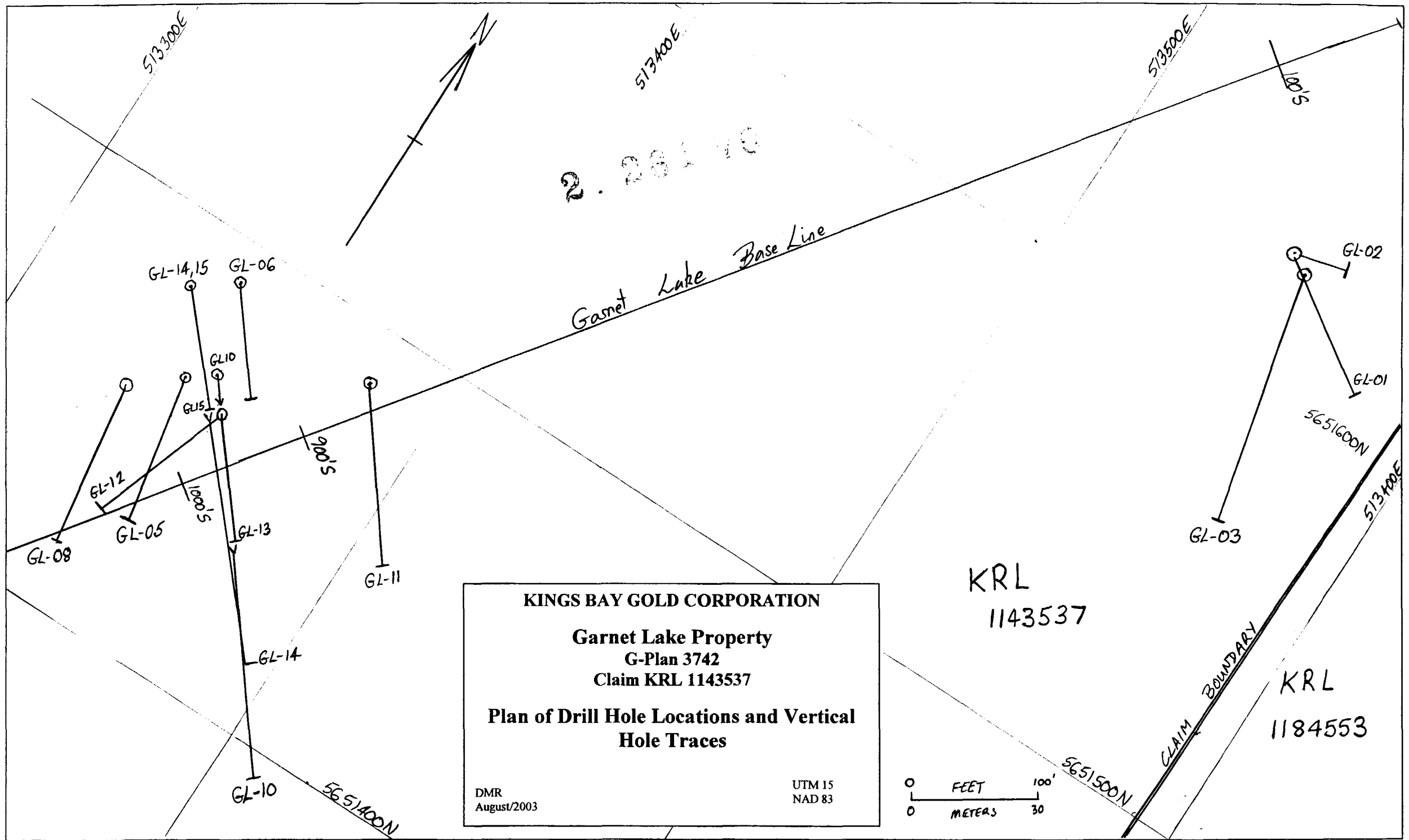

**KINGS BAY GOLD CORPORATION**

**Garnet Lake Property**  
**G-Plan 3742**  
**Claim KRL 1143537**

**Plan of Drill Hole Locations and Vertical Hole Traces**

DMR August/2003

UTM 15 NAD 83



NW

SE

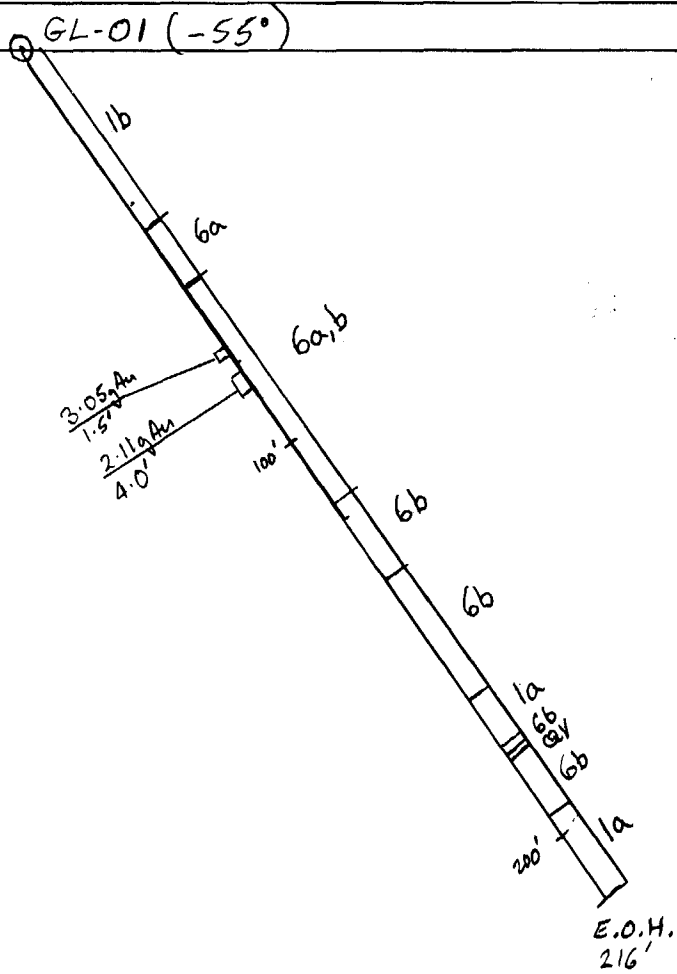

- 1 Gabbro -
  - a) fine grained,
  - b) med. to coarse grained,
  - c) differentiated
- 2 Diorite
- 3 Felsic Dykes -
  - a) Granodiorite,
  - b) Felsite,
  - c) Qtz-Fsp. Porphyry
- 4 Amphibolite
- 5 Granophyre
- 6 Meta Volcanic Rocks -
  - a) Basalt
  - b) Intermediate to Felsic
- Q Quartz Vein
- S Sulphide Zone
- Ch Chert

**KINGS BAY GOLD CORPORATION**

**Garnet Lake Property**  
**G-Plan 3742**  
**Claim KRL 1143537**

Cross Section, Drill Hole: GL-01  
 Scale: 1" = 40' Section Azimuth: 122°

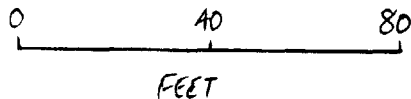

NW

SE

GL-02 (-55°)

1b

1a

S-1a

E.O.H.  
68.6'

2. 281 10

**LEGEND**

- 1 Gabbro -
  - a) fine grained,
  - b) med. to coarse grained,
  - c) differentiated
- 2 Diorite
- 3 Felsic Dykes -
  - a) Granodiorite,
  - b) Felsite,
  - c) Qtz-Fsp. Porphyry
- 4 Amphibolite
- 5 Granophyre
- 6 Meta Volcanic Rocks -
  - a) Basalt
  - b) Intermediate to Felsic
- Q Quartz Vein
- S Sulphide Zone
- Ch Chert

**KINGS BAY GOLD CORPORATION**

**Garnet Lake Property**

**G-Plan 3742**

**Claim KRL 1143537**

Cross Section, Drill Hole: GL-02

Scale: 1" = 20' Section Azimuth: 072

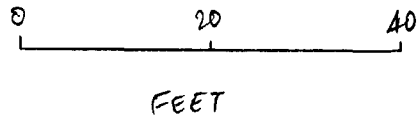

DMR  
August/2003

NW

SE

GL-03 (-55°)

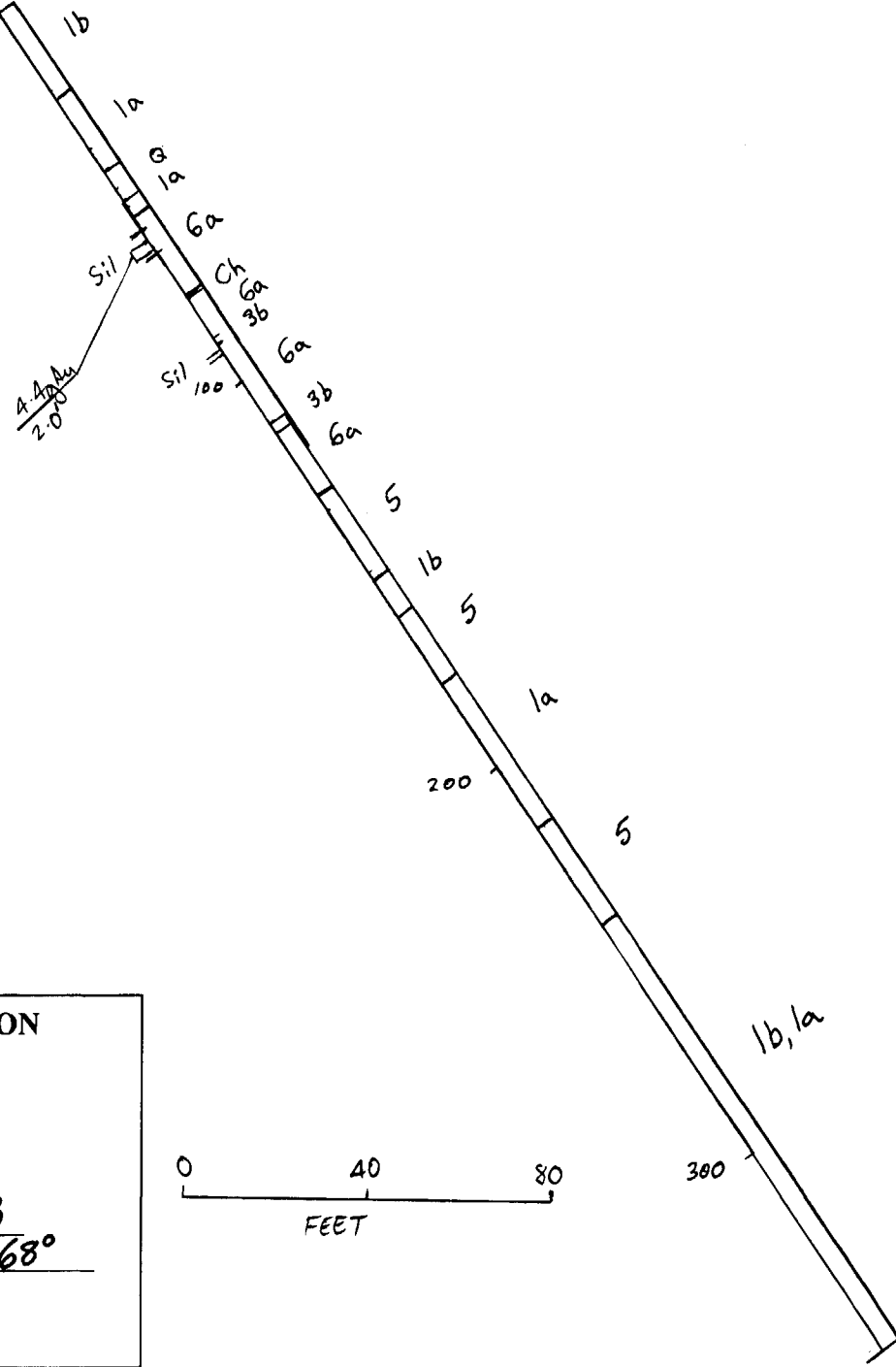

**LEGEND**

- 1 Gabbro -
  - a) fine grained,
  - b) med. to coarse grained,
  - c) differentiated
- 2 Diorite
- 3 Felsic Dykes -
  - a) Granodiorite,
  - b) Felsite,
  - c) Qtz-Fsp. Porphyry
- 4 Amphibolite
- 5 Granophyre
- 6 Meta Volcanic Rocks -
  - a) Basalt
  - b) Intermediate to Felsic

Q Quartz Vein    Sil Silicified  
 S Sulphide Zone  
 Ch Chert

**KINGS BAY GOLD CORPORATION**

**Garnet Lake Property**

**G-Plan 3742**

**Claim KRL 1143537**

Cross Section, Drill Hole: GL-03

Scale: 1" = 40' Section Azimuth: 168°

DMR  
August/2003

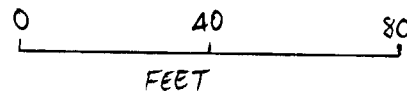

E.O.H. 356'

NW

SE

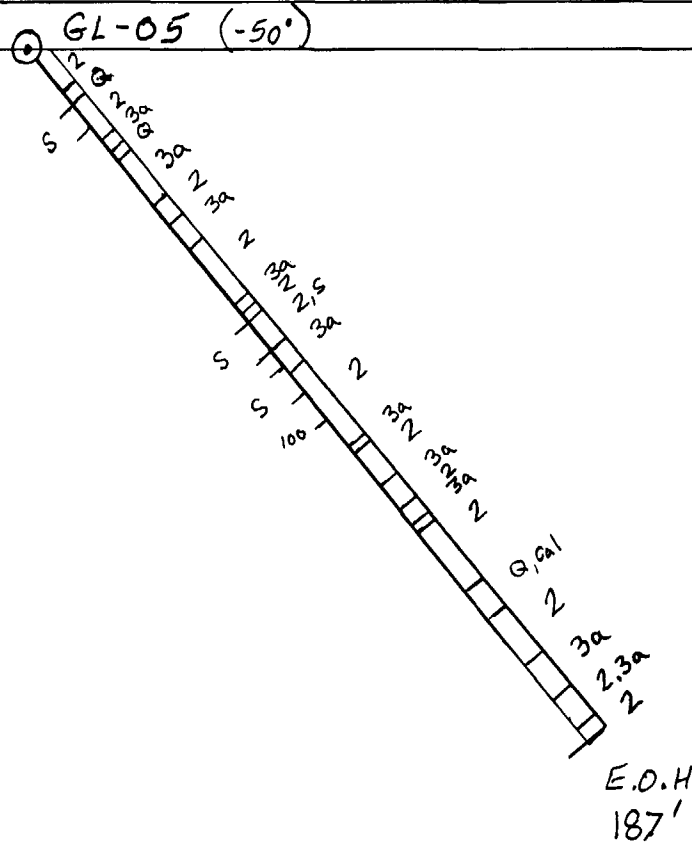

**LEGEND**

- 1 Gabbro -
  - a) fine grained,
  - b) med. to coarse grained,
  - c) differentiated
- 2 Diorite
- 3 Felsic Dykes -
  - a) Granodiorite,
  - b) Felsite,
  - c) Qtz-Fsp. Porphyry
- 4 Amphibolite
- 5 Granophyre
- 6 Meta Volcanic Rocks -
  - a) Basalt
  - b) Intermediate to Felsic

Q Quartz Vein *Cal Calcite*  
 S Sulphide Zone  
 Ch Chert

**KINGS BAY GOLD CORPORATION**

**Garnet Lake Property**  
**G-Plan 3742**  
**Claim KRL 1143537**

Cross Section, Drill Hole: GL-05  
 Scale: 1" = 46' Section Azimuth: 170°

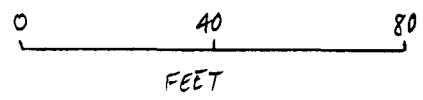

DMR  
 August/2003

NW

SE

GL-06  
(-50°)

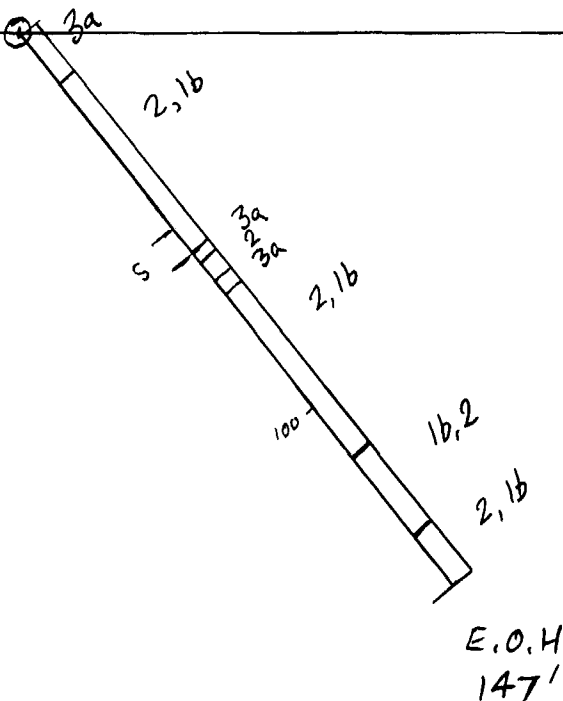

**LEGEND**

- 1 Gabbro -
  - a) fine grained,
  - b) med. to coarse grained,
  - c) differentiated
- 2 Diorite
- 3 Felsic Dykes -
  - a) Granodiorite,
  - b) Felsite,
  - c) Qtz-Fsp. Porphyry
- 4 Amphibolite
- 5 Granophyre
- 6 Meta Volcanic Rocks -
  - a) Basalt
  - b) Intermediate to Felsic

- Q Quartz Vein    F Feldspar
- S Sulphide Zone
- Ch Chert

**KINGS BAY GOLD CORPORATION**

**Garnet Lake Property**

G-Plan 3742

Claim KRL 1143537

Cross Section, Drill Hole: GL-06

Scale: 1" = 40' Section Azimuth: 142°

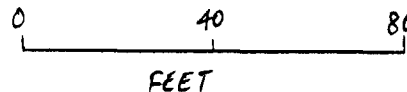

NW

SE

GL-08 (-50)

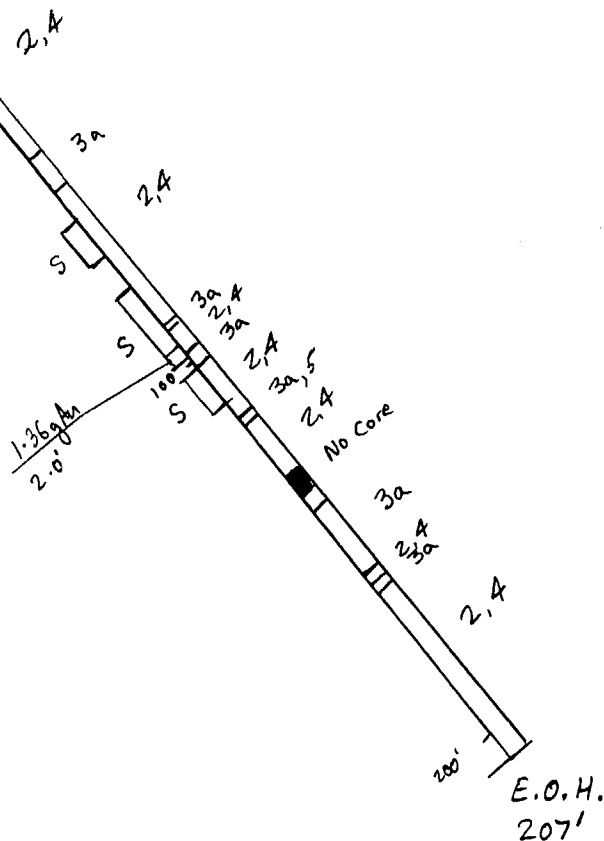

**LEGEND**

- 1 Gabbro -
  - a) fine grained,
  - b) med. to coarse grained,
  - c) differentiated
- 2 Diorite
- 3 Felsic Dykes -
  - a) Granodiorite,
  - b) Felsite,
  - c) Qtz-Fsp. Porphyry
- 4 Amphibolite
- 5 Granophyre
- 6 Meta Volcanic Rocks -
  - a) Basalt
  - b) Intermediate to Felsic

- Q Quartz Vein
- S Sulphide Zone
- Ch Chert

**KINGS BAY GOLD CORPORATION**

**Garnet Lake Property**

**G-Plan 3742**

**Claim KRL 1143537**

Cross Section, Drill Hole: GL-08

Scale: 1" = 40' Section Azimuth: 172°

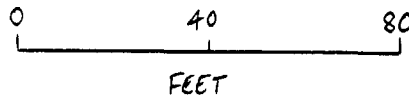

DMR  
August/2003

NW

SE

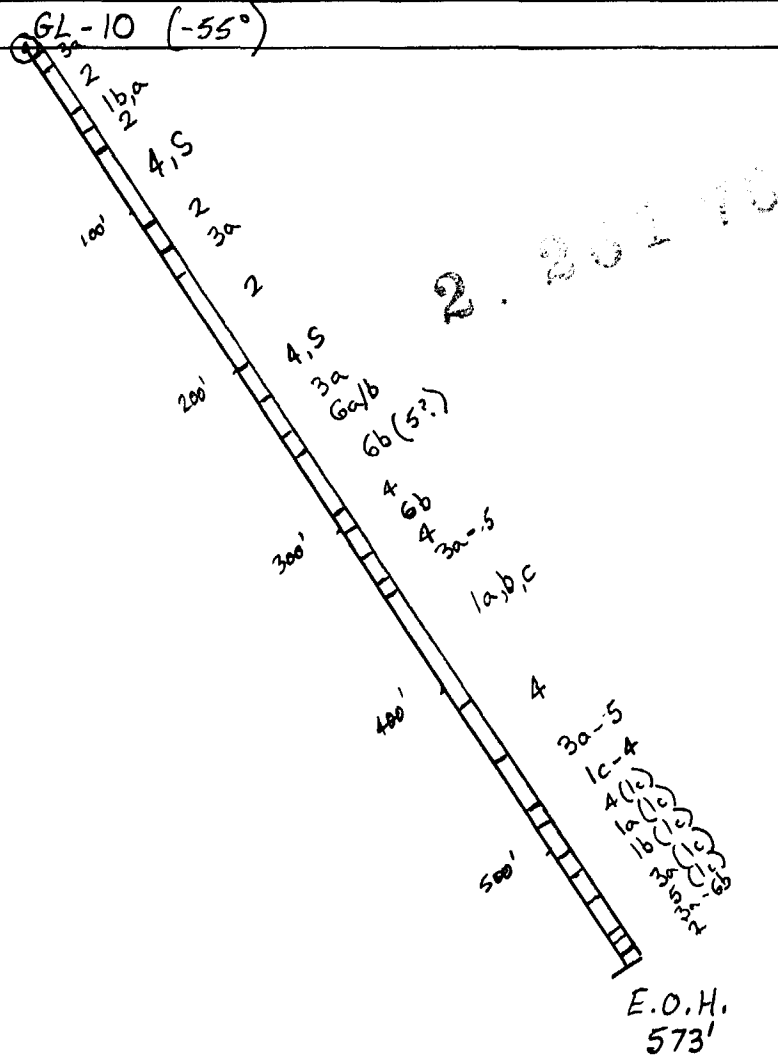

**LEGEND**

- 1 Gabbro -
  - a) fine grained,
  - b) med. to coarse grained,
  - c) differentiated
- 2 Diorite
- 3 Felsic Dykes -
  - a) Granodiorite,
  - b) Felsite,
  - c) Qtz-Fsp. Porphyry
- 4 Amphibolite
- 5 Granophyre
- 6 Meta Volcanic Rocks -
  - a) Basalt
  - b) Intermediate to Felsic
- Q Quartz Vein
- S Sulphide Zone
- Ch Chert

**KINGS BAY GOLD CORPORATION**

**Garnet Lake Property**

**G-Plan 3742**

**Claim KRL 1143537**

Cross Section, Drill Hole: GL-10

Scale: 1" = 100' Section Azimuth: 142°

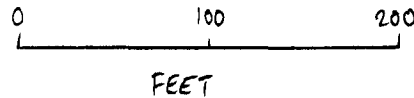

NW

SE

GL-11 (-40°)

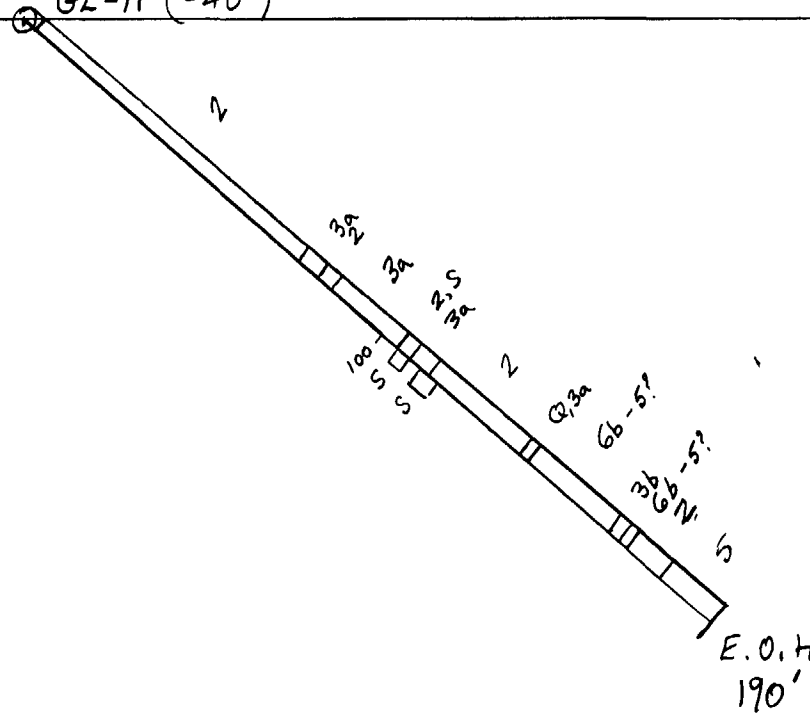

**LEGEND**

- 1 Gabbro -
  - a) fine grained,
  - b) med. to coarse grained,
  - c) differentiated
- 2 Diorite
- 3 Felsic Dykes -
  - a) Granodiorite,
  - b) Felsite,
  - c) Qtz-Fsp. Porphyry
- 4 Amphibolite
- 5 Granophyre
- 6 Meta Volcanic Rocks -
  - a) Basalt
  - b) Intermediate to Felsic
- Q Quartz Vein
- S Sulphide Zone
- Ch Chert

**KINGS BAY GOLD CORPORATION**

**Garnet Lake Property**

G-Plan 3742

Claim KRL 1143537

Cross Section, Drill Hole: GL-11

Scale: 1" = 40' Section Azimuth: 142°

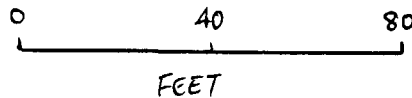

DMR  
August/2003

N

S

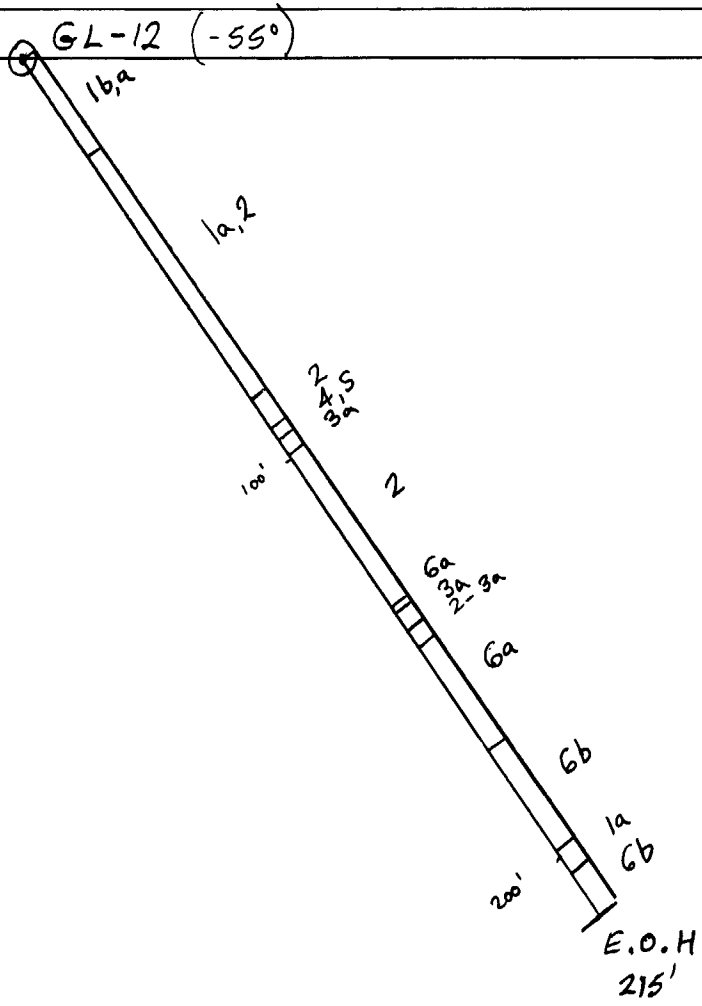

**LEGEND**

- 1 Gabbro -
  - a) fine grained,
  - b) med. to coarse grained,
  - c) differentiated
- 2 Diorite
- 3 Felsic Dykes -
  - a) Granodiorite,
  - b) Felsite,
  - c) Qtz-Fsp. Porphyry
- 4 Amphibolite
- 5 Granophyre
- 6 Meta Volcanic Rocks -
  - a) Basalt
  - b) Intermediate to Felsic
- Q Quartz Vein
- S Sulphide Zone
- Ch Chert

**KINGS BAY GOLD CORPORATION**

**Garnet Lake Property**

**G-Plan 3742**

**Claim KRL 1143537**

Cross Section, Drill Hole: GL-12

Scale: 1" = 40' Section Azimuth: 197°

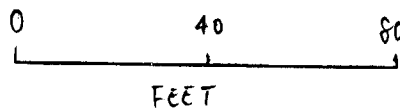

DMR  
August/2003

NW

SE

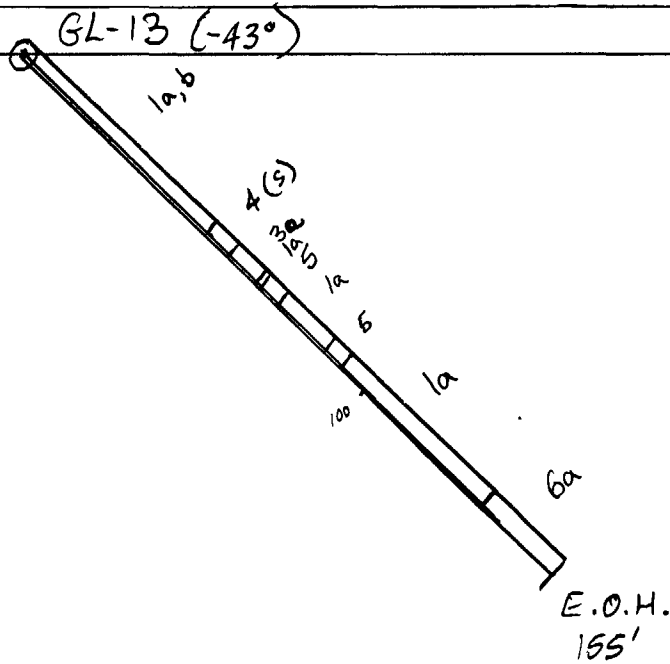

**LEGEND**

- 1 Gabbro -
  - a) fine grained,
  - b) med. to coarse grained,
  - c) differentiated
- 2 Diorite
- 3 Felsic Dykes -
  - a) Granodiorite,
  - b) Felsite,
  - c) Qtz-Fsp. Porphyry
- 4 Amphibolite
- 5 Granophyre
- 6 Meta Volcanic Rocks -
  - a) Basalt
  - b) Intermediate to Felsic
- Q Quartz Vein
- S Sulphide Zone
- Ch Chert

**KINGS BAY GOLD CORPORATION**

**Garnet Lake Property**

**G-Plan 3742**

**Claim KRL 1143537**

Cross Section, Drill Hole: GL-13

Scale: 1" = 40' Section Azimuth: 142°

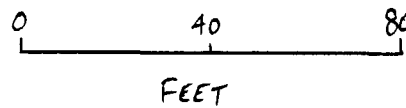

NW

SE

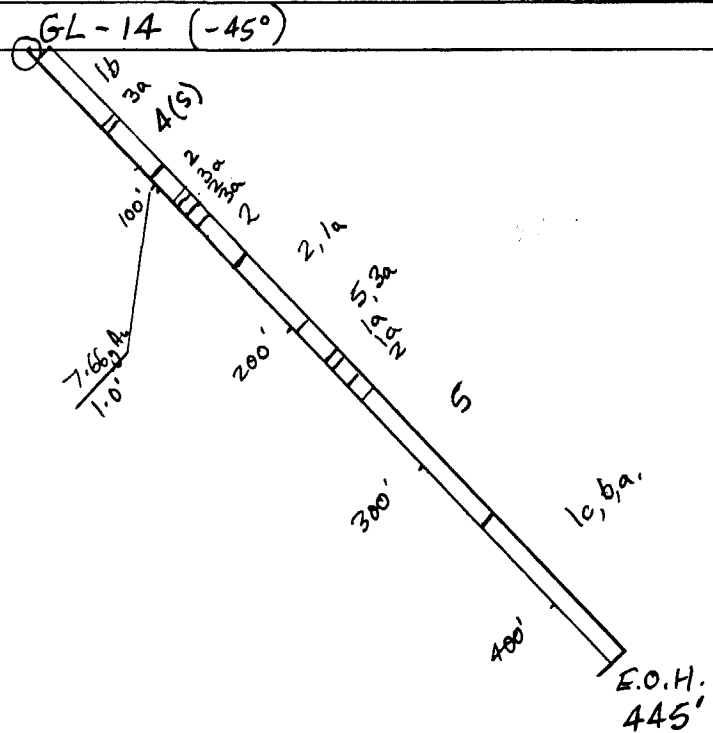

**LEGEND**

- 1 Gabbro -
  - a) fine grained,
  - b) med. to coarse grained,
  - c) differentiated
- 2 Diorite
- 3 Felsic Dykes -
  - a) Granodiorite,
  - b) Felsite,
  - c) Qtz-Fsp. Porphyry
- 4 Amphibolite
- 5 Granophyre
- 6 Meta Volcanic Rocks -
  - a) Basalt
  - b) Intermediate to Felsic
- Q Quartz Vein
- S Sulphide Zone
- Ch Chert

**KINGS BAY GOLD CORPORATION**

**Garnet Lake Property**

**G-Plan 3742**

**Claim KRL 1143537**

Cross Section, Drill Hole: GL-14

Scale: 1" = 100' Section Azimuth: 142°

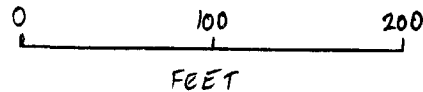

DMR  
August/2003



## Kings Bay Gold Corporation - Garnet Lake Project

Hole ID	Length (Feet)	Azimuth (Deg.)	Dip (Deg.)	UTM 15 - NAD 83			Started	Completed
				N	E	Elevation		
GL-01	216	122	-55	5651631	513549	445	JULY 5/02	JULY 10/02
GL-02	68.6	72	-55	5651631	513549	445	JULY 10/02	JULY 12/02
GL-03	356	168	-55	5651628	513554	444	JULY 13/02	JULY 20/02
GL-05	187	170	-50	5651461	513343	453	JULY 21/02	JULY 28/02
GL-06	147	142	-50	5651487	513343	458	JULY 29/02	AUG 4/02
GL-08	207	172	-50	5651447	513337	450	AUG 5/02	AUG 12/02
GL-10	573	142	-55	5651466	513350	451	AUG 13/02	AUG 20/02
GL-11	190	142	-40	5651484	513381	449	AUG 21/02	AUG 25/02
GL-12	215	197	-55	5651462	513354	451	SEPT 2/02	SEPT 7/02
GL-13	155	142	-43	5651459	513356	451	SEPT 8/02	SEPT 14/02
GL-14	445	142	-45	5651479	513333	458	SEPT 15/02	SEPT 25/02
GL-15	185	142	-55	5651479	513333	458	SEPT 26/02	SEPT 30/02
Total	2944.6							

**KINGS BAY GOLD CORPORATION**

**GARNET LAKE**

**Assay Results: Accurassay, Thunder Bay, Ontario**

Hole ID	Sample No.	From Feet	To Feet	Length Feet	Au ppb	Au gAu/t Metallics	Ag ppm	Cu ppm	Ni ppm	Zn ppm
GL-01	27098	76.0	77.5	1.5	3050					
GL-01	27099	81.5	85.5	4.0	2106					
GL-01	27100	96.0	101.0	5.0	18					
GL-01	27451	180.0	181.5	1.5	<5		1	369	56	
GL-01	27452	214.0	216.0	2.0	<5					
GL-02	27401	59.9	64.9	5.0	15					
GL-02	27402	64.9	68.2	3.3	12					
GL-03	27403	27.0	32.0	5.0	15					
GL-03	27404	46.7	50.0	3.3	58					
GL-03	27405	50.0	53.8	3.8	10					
GL-03	27406	60.1	63.9	3.8	1037		1	168		65
GL-03	27407	63.9	65.9	2.0	4414			698		
GL-05	27408	11.5	14.5	3.0		0.011				
GL-05	27409	14.5	17.5	3.0	123			3948		
GL-05	27410	17.5	20.8	3.3	74			6853		
GL-05	27411	73.0	77.0	4.0	358			4425		
GL-05	27412	77.0	80.5	3.5	350			2706		
GL-05	27413	85.5	90.0	4.5	24			498		
GL-05	27414	90.0	92.8	2.8	109			2339		
GL-06	27415	52.0	55.3	3.3	193			2165		
GL-06	27416	55.3	58.6	3.3	53			727		
GL-06	27417	102.8	107.8	5.0	100			1918		
GL-06	27418	107.8	112.5	4.7	119			3456		

Hole ID	Sample No.	From Feet	To Feet	Length Feet	Au ppb	Au gAu/t Metallics	Ag ppm	Cu ppm	Ni ppm	Zn ppm
GL-08	27270	20.0	22.0	2.0	689		4	6438	93	83
GL-08	27271	22.0	24.0	2.0	28		< 1	352	99	31
GL-08	27272	24.0	26.0	2.0	6		< 1	32	73	26
GL-08	27273	26.0	27.0	1.0	<5		< 1	22	65	24
GL-08	27274	61.0	62.0	1.0	94		2	1050	160	58
GL-08	27275	62.0	64.0	2.0	133		2	1271	174	63
GL-08	27276	64.0	66.0	2.0	91		3	1782	115	48
GL-08	27277	66.0	68.0	2.0	159		3	4494	126	53
GL-08	27278	80.0	83.0	3.0	5		1	459	105	48
GL-08	27279	83.0	85.0	2.0	10		3	787	721	51
GL-08	27280	85.0	87.0	2.0	35		2	1760	137	57
GL-08	27281	87.0	90.0	3.0	30		2	1262	98	48
GL-08	27282	90.0	92.0	2.0	696		2	3287	165	35
GL-08	27283	92.0	94.0	2.0	117		2	7403	106	34
GL-08	27284	94.0	96.0	2.0	859		12	10520	269	122
GL-08	27285	96.0	98.0	2.0	1358		17	14118	330	155
GL-08	27286	98.0	100.0	2.0	438		6	4581	231	71
GL-08	27287	100.0	102.0	2.0	518		4	2412	107	40
GL-10	27308	200.0	201.0	1.0	550		5	1093	112	61
GL-10	27309	201.0	202.0	1.0	249		7	16911	230	137
GL-10	27310	202.0	203.0	1.0	20		3	2229	232	59
GL-10	27311	203.0	204.0	1.0	42		3	2010	217	55
GL-10	27312	204.0	205.0	1.0	77		3	2183	132	56
GL-10	27313	205.0	206.0	1.0	94		3	1767	109	64
GL-10	27314	206.0	207.0	1.0	627		14	27679	119	213
GL-10	27315	207.0	208.0	1.0	1983		17	28940	179	184
GL-10	27316	208.0	209.0	1.0	129		6	5359	98	36
GL-10	27317	209.0	210.0	1.0	294		10	12555	90	102
GL-10	27318	210.0	212.0	2.0	415		6	8462	127	70
GL-10	27319	212.0	213.0	1.0	90		3	2552	85	34
GL-10	27320	213.0	214.0	1.0	1410		9	7783	209	88
GL-10	27321	214.0	215.0	1.0	266		4	4032	137	43
GL-10	27322	215.0	216.0	1.0	167		5	4036	168	43

Hole ID	Sample No.	From Feet	To Feet	Length Feet	Au ppb	Au gAu/t Metallics	Ag ppm	Cu ppm	Ni ppm	Zn ppm
GL-10	27323	216.0	217.0	1.0	7		2	349	44	49
GL-10	27324	217.0	218.0	1.0	40		2	1087	65	54
GL-10	27325	218.0	219.0	1.0	102		3	2001	93	58
GL-10	27326	219.0	220.0	1.0	53		4	2180	196	65
GL-10	27327	220.0	221.0	1.0	59		3	2210	62	66
GL-10	27328	85.0	87.0	2.0	176		6	5644	108	101
GL-10	27329	87.0	89.0	2.0	106		4	1589	192	71
GL-10	27330	89.0	90.0	1.0	104		5	1230	210	53
GL-10	27331	90.0	92.0	2.0	85		4	1306	119	50
GL-10	27332	92.0	94.0	2.0	33		3	532	132	44
GL-10	27333	94.0	95.0	1.0	19		4	776	100	32
GL-10	27334	95.0	96.0	1.0	1219		3	3453	197	23
GL-10	27335	96.0	97.0	1.0	23		2	1192	158	27
GL-10	27336	97.0	98.0	1.0	7		2	239	77	30
GL-10	27337	98.0	100.0	2.0	18		2	652	130	38
GL-10	27338	100.0	101.0	1.0	312		3	3425	98	71
GL-10	27339	101.0	102.0	1.0	77		2	1442	107	64
GL-10	27340	102.0	104.0	2.0	146		2	979	53	66
GL-10	27341	104.0	105.0	1.0	227		3	2824	269	63
GL-10	27342	105.0	106.0	1.0	25		2	684	62	58
GL-10	27343	106.0	107.0	1.0	529		8	10519	188	116
GL-10	27344	107.0	108.0	1.0	65		2	974	48	42
GL-10	27345	108.0	110.0	2.0	64		1	596	91	18
GL-10	27346	110.0	112.0	2.0	30		< 1	335	32	6
GL-10	27347	112.0	113.0	1.0	53		2	647	174	23
GL-10	27348	113.0	115.0	2.0	31		1	233	125	15
GL-10	27349	115.0	116.0	1.0	<5		< 1	5	53	9
GL-10	27350	116.0	117.0	1.0	1094		9	16688	83	211
GL-10	27453	64.5	67.5	3.0	72		3	1642	105	
GL-10	27454	67.5	72.5	5.0	12		1	372	117	
GL-10	27455	72.5	76.0	3.5	415		5	7060	104	
GL-10	27456	76.0	78.5	2.5	<5		1	32	111	
GL-10	27457	280.0	285.0	5.0	283					

Hole ID	Sample No.	From Feet	To Feet	Length Feet	Au ppb	Au gAu/t Metallics	Ag ppm	Cu ppm	Ni ppm	Zn ppm
GL-10	27458	293.0	296.0	3.0	7					
GL-10	27459	296.0	300.5	4.5	15					
GL-11	27079	105.0	108.4	3.4	965					
GL-11	27080	108.4	111.4	3.0	14					
GL-11	27081	111.4	113.6	2.2	24					
GL-11	27082	113.6	116.0	2.4	<5					
GL-11	27083	138.5	140.0	1.5	102					
GL-11	27084	154.0	158.5	4.5	<5					
GL-11	27085	158.5	162.5	4.0	<5					
GL-12	27086	92.8	94.8	2.0	160			4867	39	
GL-12	27087	94.8	98.0	3.3	99			1547	16	
GL-12	27088	151.7	156.7	5.0	<5					
GL-12	27089	156.7	159.2	2.5	37					
GL-12	27090	159.2	161.7	2.5	<5					
GL-12	27091	161.7	166.7	5.0	<5					
GL-12	27092	166.7	171.7	5.0	17					
GL-12	27093	174.0	179.0	5.0	50					
GL-12	27094	179.0	184.0	5.0	<5					
GL-12	27095	184.0	189.0	5.0	22					
GL-12	27096	189.0	194.0	5.0	<5					
GL-12	27097	204.7	209.0	4.3	<5					
GL-13	27057	53.3	56.7	3.5	67			361	73	
GL-13	27058	56.7	58.0	1.3	13			354	70	
GL-13	27059	73.2	74.8	1.6	157			2713	96	
GL-14	27119	57.0	58.0	1.0	12		1	93	14	20
GL-14	27120	58.0	59.0	1.0	<5		< 1	5	16	< 1
GL-14	27121	59.0	60.0	1.0	98		3	1094	73	95
GL-14	27122	60.0	62.0	2.0	538		4	3068	160	74
GL-14	27123	62.0	63.0	1.0	543		6	5481	289	61
GL-14	27124	63.0	65.0	2.0	278		5	2892	225	48

Hole ID	Sample No.	From Feet	To Feet	Length Feet	Au ppb	Au gAu/t Metallics	Ag ppm	Cu ppm	Ni ppm	Zn ppm
GL-14	27125	65.0	68.0	3.0	76		3	408	140	37
GL-14	27126	68.0	70.0	2.0	63		3	522	121	36
GL-14	27127	70.0	71.0	1.0	58		4	2492	99	29
GL-14	27128	71.0	72.0	1.0	142		3	502	83	29
GL-14	27129	72.0	73.0	1.0	77		4	684	503	27
GL-14	27130	73.0	74.0	1.0	21		4	1139	248	31
GL-14	27131	74.0	75.0	1.0	12		4	505	86	39
GL-14	27132	75.0	76.0	1.0	67		5	1774	106	37
GL-14	27133	76.0	77.0	1.0	27		4	618	124	43
GL-14	27134	77.0	78.0	1.0	19		4	336	85	44
GL-14	27135	78.0	79.0	1.0	15		4	641	120	35
GL-14	27136	79.0	81.0	2.0	27		5	2571	345	59
GL-14	27137	81.0	82.0	1.0	115		5	6348	152	58
GL-14	27138	82.0	84.0	2.0	92		6	5221	295	66
GL-14	27139	84.0	85.0	1.0	87		5	2784	219	52
GL-14	27140	85.0	86.0	1.0	599		13	16004	176	140
GL-14	27141	86.0	87.0	1.0	539		8	9687	121	110
GL-14	27142	87.0	88.0	1.0	486		7	7736	79	89
GL-14	27143	88.0	90.0	2.0	22		2	353	44	18
GL-14	27144	90.0	91.0	1.0	316		5	2903	62	62
GL-14	27145	91.0	92.0	1.0	676		8	6681	65	95
GL-14	27146	92.0	94.0	2.0	332		3	2407	96	67
GL-14	27147	94.0	95.0	1.0	7660		15	20609	109	160
GL-14	27148	96.0	97.0	1.0	158		3	2716	120	69
GL-14	27149	97.0	98.0	1.0	248		3	4177	124	60
GL-14	27060	163.0	166.0	3.0	6			147	186	
GL-14	27061	365.3	370.3	5.0	<5			10	217	
GL-14	27062	370.3	373.3	3.0	42			552	87	
GL-14	27063	373.3	376.3	3.0	<5					
GL-14	27064	376.3	379.3	3.0	<5					
GL-14	27065	379.3	382.3	3.0	<5			75	34	
GL-14	27066	382.3	387.3	5.0	11			78	62	
GL-14	27067	387.3	392.3	5.0	8			192	77	

Hole ID	Sample No.	From Feet	To Feet	Length Feet	Au ppb	Au gAu/t Metallics	Ag ppm	Cu ppm	Ni ppm	Zn ppm
GL-14	27068	392.3	397.3	5.0	10					
GL-14	27069	397.3	402.3	5.0	6			277	74	
GL-14	27070	422.2	425.2	3.0	32					
GL-14	27071	425.2	427.7	2.5	39					
GL-14	27072	427.7	430.7	3.0	11					
GL-14	27073	430.7	434.5	3.8	11					
GL-14	27074	434.5	437.5	3.0	22					
GL-14	27075	437.5	442.5	5.0	30					
GL-15	27051	45.8	49.9	4.1	12					
GL-15	27052	49.9	54.0	4.1	<5					
GL-15	27053	81.4	85.0	3.6	<5					
GL-15	27054	85.0	88.3	3.3	<5					
GL-15	27055	129.0	130.5	1.5	101			1288	116	
GL-15	27056	179.0	180.0	1.0	7641			20866	173	

20170



1070 LITHIUM DRIVE, UNIT 2 THUNDER BAY, ONTARIO P7B 6G3  
PHONE (807) 626-1630 FAX (807) 623 6820 EMAIL [accuracy@tbaytel.net](mailto:accuracy@tbaytel.net) WEB [www accurassay.com](http://www accurassay.com)

Kings Bay Gold Corporation  
Date Created: 02-10-24 04:44 PM  
Job Number: 200240863  
Date Recieved: 10/1/2002  
Number of Samples: 18  
Type of Sample: Core  
Date Completed: 10/10/2002  
Project ID: Hole #8

GL-08.

Page: 1

Accur. #	Client Tag	U ppm
33588	27270	6
33589	27271	6
33590	27272	6
33591	27273	<5
33592	27274	12
33593	27275	10
33594	27276	9
33595	27277	8
33596	27278	8
33597	27279	19
33598	27279	19
33599	27280	9
33600	27281	8
33601	27282	8
33602	27283	7
33603	27284	5
33604	27285	7
33605	27286	5
33606	27287	<5

Certified By: 

1070 LITHIUM DRIVE, UNIT 2 THUNDER BAY, ONTARIO P7B 6G3  
PHONE (807) 626-1630 FAX (807) 623 6820 EMAIL accuracy@tbaytel.net WEB www accurassay.com

## Certificate of Analysis

Tuesday, October 15, 2002

Kings Bay Gold Corporation  
152 Gull Lake Rd.  
Winnipeg, MB, CA  
R3T5T3  
Ph#: (204) 661-8852  
Fax#: (204) 224-0306  
Email kingsbaygold@yahoo.com

Date Received : 01-Oct-02  
Date Completed : 10-Oct-02  
Job # 200240863  
Reference : Hole #8  
Sample #: 18 Core

Accurassay #	Client Id	Au ppb	Pt ppb	Pd ppb	Rh ppb	Ag ppm	Co ppm	Cu ppm	Fe ppm	Ni ppm	Pb ppm	Zn ppm
33588	27270	689				4		6438				83
33589	27271	28				<1		352				31
33590	27272	6				<1		32				26
33591	27273	<5				<1		22				24
33592	27274	94				2		1050				58
33593	27275	133				2		1271				63
33594	27276	91				3		1782				48
33595	27277	159				3		4494				53
33596	27278	5				1		459				48
33597	27279	12				3		777				51
33598	Check 27279	9				3		799				52
33599	27280	35				2		1760				57
33600	27281	30				2		1262				48
33601	27282	696				2		3287				35
33602	27283	117				2		7403				34
33603	27284	859				12		10520				122
33604	27285	1358				17		14118				155
33605	27286	438				6		4581				71
33606	27287	518				4		2412				40

PROCEDURE CODES: AL4Au, AL4Ag, AL4Cu, AL4Zn, AL4ICPA

Certified By: 

AL917-0130-10/15/2002 05:00 PM



1070 LITHIUM DRIVE, UNIT 2 THUNDER BAY, ONTARIO P7B 6G3  
PHONE (807) 626-1630 FAX (807) 623 6820 EMAIL accuracy@tbaytel.net WEB www accurassay.com

Kings Bay Gold Corporation  
Date Created: 02-10-25 10:09 AM  
Job Number: 200240861  
Date Recieved: 10/1/2002  
Number of Samples: 43  
Type of Sample: Core  
Date Completed: 10/15/2002  
Project ID: Hole #10

GL-10.

Page: 1

Accur. #	Client Tag	U ppm
33506	27308	10
33507	27309	12
33508	27310	12
33509	27311	12
33510	27312	11
33511	27313	11
33512	27314	11
33513	27315	12
33514	27316	10
33515	27317	9
33516	27317	10
33517	27318	8
33518	27319	8
33519	27320	10
33520	27321	8
33521	27322	8
33522	27323	8
33523	27324	9
33524	27325	8
33525	27326	10
33526	27326	9
33527	27327	6
33528	27328	13
33529	27329	17
33530	27330	18
33531	27331	17
33532	27332	14
33533	27333	15
33534	27334	14
33535	27335	14
33536	27335	14
33537	27336	12

Certified By: 



1070 LITHIUM DRIVE, UNIT 2 THUNDER BAY, ONTARIO P7B 6G3  
PHONE (807) 626-1630 FAX (807) 623 6820 EMAIL accuracy@tbaytel.net WEB www accurassay.com

Kings Bay Gold Corporation  
Date Created: 02-10-25 10:09 AM  
Job Number: 200240861  
Date Recieved: 10/1/2002  
Number of Samples: 43  
Type of Sample: Core  
Date Completed: 10/15/2002  
Project ID: Hole #10

Page: 2

Accur. #	Client Tag	U ppm
33538	27337	13
33539	27338	12
33540	27339	10
33541	27340	8
33542	27341	10
33543	27342	9
33544	27343	10
33545	27344	7
33546	27344	6
33547	27345	5
33548	27346	<5
33549	27347	6
33550	27348	<5
33551	27349	<5
33552	27350	7

Certified By.



1070 LITHIUM DRIVE, UNIT 2 THUNDER BAY, ONTARIO P7B 6G3  
PHONE (807) 626-1630 FAX (807) 623 6820 EMAIL [accuracy@tbaytel.net](mailto:accuracy@tbaytel.net) WEB [www accurassay.com](http://www accurassay.com)

## Certificate of Analysis

Wednesday, October 16, 2002

Kings Bay Gold Corporation  
152 Gull Lake Rd.  
Winnipeg, MB, CA  
R3T5T3  
Ph#: (204) 661-8852  
Fax#: (204) 224-0306  
Email [kingsbaygold@yahoo.com](mailto:kingsbaygold@yahoo.com)

Date Received : 01-Oct-02  
Date Completed : 15-Oct-02  
Job # 200240861  
Reference : Hole #10  
Sample #: 43 Core

Accurassay #	Client Id	Au g/t	Pt g/t	Pd g/t	Rh g/t	Ag ppm	Co %	Cu %	Fe %	Ni %	Pb %	Zn %
33506	27308	0.550				5		0.1093				0.0061
33507	27309	0.249				7		1.6911				0.0137
33508	27310	0.020				3		0.2229				0.0059
33509	27311	0.042				3		0.2010				0.0055
33510	27312	0.077				3		0.2183				0.0056
33511	27313	0.094				3		0.1767				0.0064
33512	27314	0.627				14		2.7679				0.0213
33513	27315	1.983				17		2.8940				0.0184
33514	27316	0.129				6		0.5359				0.0036
33515	27317	0.301				10		1.1944				0.0104
33516	Check 27317	0.288				10		1.3166				0.0100
33517	27318	0.415				6		0.8462				0.0070
33518	27319	0.090				3		0.2552				0.0034
33519	27320	1.410				9		0.7783				0.0088
33520	27321	0.266				4		0.4032				0.0043
33521	27322	0.167				5		0.4036				0.0043
33522	27323	0.007				2		0.0349				0.0049
33523	27324	0.040				2		0.1087				0.0054
33524	27325	0.102				3		0.2001				0.0058
33525	27326	0.051				4		0.2153				0.0064
33526	Check 27326	0.055				4		0.2206				0.0066
33527	27327	0.059				3		0.2210				0.0066
33528	27328	0.176				6		0.5644				0.0101

PROCEDURE CODES: AL4Au3, AL4Ag, AL4Cu, AL4Zn, AL4ICPA

Page 1 of 3

Certified By: 

AL912-0130-10/16/2002 11:15 AM



1070 LITHIUM DRIVE, UNIT 2 THUNDER BAY, ONTARIO P7B 6G3  
PHONE (807) 626-1630 FAX (807) 623 6820 EMAIL accuracy@tbaytel.net WEB www accurassay.com

## Certificate of Analysis

Wednesday, October 16, 2002

Kings Bay Gold Corporation  
152 Gull Lake Rd.  
Winnipeg, MB, CA  
R3T5T3  
Ph#: (204) 661-8852  
Fax#: (204) 224-0306  
Email kingsbaygold@yahoo.com

2. 2002  
Date Received : 01-Oct-02  
Date Completed : 15-Oct-02  
Job # 200240861  
Reference : Hole #10  
Sample #: 43 Core

Accurassay #	Client Id	Au g/t	Pt g/t	Pd g/t	Rh g/t	Ag ppm	Co %	Cu %	Fe %	Ni %	Pb %	Zn %
33529	27329	0.106				4		0.1589				0.0071
33530	27330	0.104				5		0.1230				0.0053
33531	27331	0.085				4		0.1306				0.0050
33532	27332	0.033				3		0.0532				0.0044
33533	27333	0.019				4		0.0776				0.0032
33534	27334	1.219				3		0.3453				0.0023
33535	27335	0.020				2		0.1177				0.0029
33536	Check 27335	0.027				2		0.1207				0.0024
33537	27336	0.007				2		0.0239				0.0030
33538	27337	0.018				2		0.0652				0.0038
33539	27338	0.312				3		0.3425				0.0071
33540	27339	0.077				2		0.1442				0.0064
33541	27340	0.146				2		0.0979				0.0066
33542	27341	0.227				3		0.2824				0.0063
33543	27342	0.025				2		0.0684				0.0058
33544	27343	0.529				8		1.0519				0.0116
33545	27344	0.063				2		0.0969				0.0043
33546	Check 27344	0.069				2		0.0979				0.0041
33547	27345	0.064				1		0.0596				0.0018
33548	27346	0.030				< 1		0.0335				0.0006
33549	27347	0.053				2		0.0647				0.0023
33550	27348	0.031				1		0.0233				0.0015
33551	27349	<0.005				< 1		0.0005				0.0009

PROCEDURE CODES: AL4Au3, AL4Ag, AL4Cu, AL4Zn, AL4ICPA

Certified By: 

1070 LITHIUM DRIVE, UNIT 2 THUNDER BAY, ONTARIO P7B 6G3  
PHONE (807) 626-1630 FAX (807) 623 6820 EMAIL [accuracy@tbaytel.net](mailto:accuracy@tbaytel.net) WEB [www accurassay.com](http://www accurassay.com)

## Certificate of Analysis

Wednesday, October 16, 2002

Kings Bay Gold Corporation  
152 Gull Lake Rd.  
Winnipeg, MB, CA  
R3T5T3  
Ph#: (204) 661-8852  
Fax#: (204) 224-0306  
Email [kingsbaygold@yahoo.com](mailto:kingsbaygold@yahoo.com)

Date Received : 01-Oct-02  
Date Completed : 15-Oct-02  
Job # 200240861  
Reference : Hole #10  
Sample #: 43 Core

Accurassay #	Client Id	Au g/t	Pt g/t	Pd g/t	Rh g/t	Ag ppm	Co %	Cu %	Fe %	Ni %	Pb %	Zn %
33552	27350	1.094				9		1.6688				0.0211

PROCEDURE CODES: AL4Au3, AL4Ag, AL4Cu, AL4Zn, AL4ICPA

Certified By: 

AL912-0130-10/16/2002 11:15 AM



1070 LITHIUM DRIVE, UNIT 2 THUNDER BAY, ONTARIO P7B 6G3  
PHONE (807) 626-1630 FAX (807) 623 6820 EMAIL accuracy@tbaytel.net WEB www accurassay.com

Kings Bay Gold Corporation  
Date Created: 02-10-25 10:09 AM  
Job Number: 200240862  
Date Recieved: 10/1/2002  
Number of Samples: 32  
Type of Sample: Core  
Date Completed: 10/17/2002  
Project ID: Hole #14

GL-14.

Page: 1

Accur. #	Client Tag	U ppm
33553	27119	<5
33554	27120	<5
33555	27121	11
33556	27122	12
33557	27123	16
33558	27124	15
33559	27125	11
33560	27126	11
33561	27127	12
33562	27128	13
33563	27128	13
33564	27129	21
33565	27130	18
33566	27131	17
33567	27132	22
33568	27133	17
33569	27134	15
33570	27135	14
33571	27136	15
33572	27137	12
33573	27137	12
33574	27138	15
33575	27139	16
33576	27140	13
33577	27141	8
33578	27142	7

Certified By:



1070 LITHIUM DRIVE, UNIT 2 THUNDER BAY, ONTARIO P7B 6G3  
 PHONE (807) 626-1630 FAX (807) 623 6820 EMAIL accuracy@tbaytel.net WEB www accurassay.com

Kings Bay Gold Corporation  
 Date Created: 02-10-25 10:09 AM  
 Job Number: 200240862  
 Date Recieved: 10/1/2002  
 Number of Samples: 32  
 Type of Sample: Core  
 Date Completed: 10/17/2002  
 Project ID: Hole #14

2.23170

Page: 2

Accur. #	Client Tag	U ppm
33579	27143	<5
33580	27144	7
33581	27145	7
33582	27146	8
33583	27146	8
33584	27147	10
33585	Unknown	10
33586	27148	10
33587	27149	7

Certified By: 

1070 LITHIUM DRIVE, UNIT 2 THUNDER BAY, ONTARIO P7B 6G3  
PHONE (807) 626-1630 FAX (807) 623 6820 EMAIL accuracy@tbaytel.net WEB www accurassay.com

## Certificate of Analysis

Friday, October 18, 2002

Kings Bay Gold Corporation  
152 Gull Lake Rd.  
Winnipeg, MB, CA  
R3T5T3  
Ph#: (204) 661-8852  
Fax#: (204) 224-0306  
Email kingsbaygold@yahoo.com

Date Received : 01-Oct-02  
Date Completed : 17-Oct-02  
Job # 200240862  
Reference : Hole #14  
Sample #: 32 Core

Accurassay #	Client Id	Au g/t	Pt g/t	Pd g/t	Rh g/t	Ag ppm	Co %	Cu %	Fe %	Ni %	Pb %	Zn %
33553	27119	0.012				1		0.0093				0.0020
33554	27120	<0.005				<1		0.0005				<0.0001
33555	27121	0.098				3		0.1094				0.0095
33556	27122	0.538				4		0.3068				0.0074
33557	27123	0.543				6		0.5481				0.0061
33558	27124	0.278				5		0.2892				0.0048
33559	27125	0.076				3		0.0408				0.0037
33560	27126	0.063				3		0.0522				0.0036
33561	27127	0.058				4		0.2492				0.0029
33562	27128	0.143				3		0.0501				0.0030
33563	Check 27128	0.141				3		0.0504				0.0028
33564	27129	0.077				4		0.0684				0.0027
33565	27130	0.021				4		0.1139				0.0031
33566	27131	0.012				4		0.0505				0.0039
33567	27132	0.067				5		0.1774				0.0037
33568	27133	0.027				4		0.0618				0.0043
33569	27134	0.019				4		0.0336				0.0044
33570	27135	0.015				4		0.0641				0.0035
33571	27136	0.027				5		0.2571				0.0059
33572	27137	0.111				5		0.6497				0.0057
33573	Check 27137	0.119				5		0.6199				0.0059
33574	27138	0.092				6		0.5221				0.0066
33575	27139	0.087				5		0.2784				0.0052

PROCEDURE CODES: AL4Au3, AL4Ag, AL4Cu, AL4Zn, AL4CPA

Certified By: 

1070 LITHIUM DRIVE, UNIT 2 THUNDER BAY, ONTARIO P7B 6G3  
PHONE (807) 626-1630 FAX (807) 623 6820 EMAIL accuracy@tbaytel.net WEB www accurassay.com

## Certificate of Analysis

Friday, October 18, 2002

Kings Bay Gold Corporation  
152 Gull Lake Rd.  
Winnipeg, MB, CA  
R3T5T3  
Ph#: (204) 661-8852  
Fax#: (204) 224-0306  
Email kingsbaygold@yahoo.com

Date Received : 01-Oct-02  
Date Completed : 17-Oct-02  
Job # 200240862  
Reference : Hole #14  
Sample #: 32 Core

Accurassay #	Client Id	Au g/t	Pt g/t	Pd g/t	Rh g/t	Ag ppm	Co %	Cu %	Fe %	Ni %	Pb %	Zn %
33576	27140	0.599				13		1.6004				0.0140
33577	27141	0.539				8		0.9687				0.0110
33578	27142	0.486				7		0.7736				0.0089
33579	27143	0.022				2		0.0353				0.0018
33580	27144	0.316				5		0.2903				0.0062
33581	27145	0.676				8		0.6681				0.0095
33582	27146	0.308				3		0.2234				0.0064
33583	Check 27146	0.355				3		0.2579				0.0070
33584	27147	7.660				15		2.0609				0.0160
33585	Unknown	0.088				4		0.4656				0.0061
33586	27148	0.158				3		0.2716				0.0069
33587	27149	0.248				3		0.4177				0.0060

PROCEDURE CODES AL4Au3, AL4Ag, AL4Cu, AL4Zn, AL4ICPA

Certified By: 

AL912-0130-10/18/2002 09:23 AM



1070 LITHIUM DRIVE, UNIT 2 THUNDER BAY, ONTARIO P7B 6G3  
 PHONE (807) 626-1630 FAX (807) 623 6820 EMAIL [accuracy@tbaytel.net](mailto:accuracy@tbaytel.net) WEB [www accurassay.com](http://www accurassay.com)

## Certificate of Analysis

Monday, October 28, 2002

Kings Bay Gold Corporation  
 152 Gull Lake Rd.  
 Winnipeg, MB, CA  
 R3T5T3  
 Ph#: (204) 661-8852  
 Fax#: (204) 224-0306  
 Email [kingsbaygold@yahoo.com](mailto:kingsbaygold@yahoo.com)

Date Received : 25-Oct-02  
 Date Completed : 28-Oct-02  
 Job # 200240992  
 Reference :

Sample #: 149 Pulp's

Accurassay #	Client Id	Au g/t	Pt g/t	Pd g/t	Rh g/t	Ag ppm	Co %	Cu %	Fe %	Ni %	Pb %	Zn %
39394	27101									0.0208		
39395	27102									0.0139		
39396	27103									0.0112		
39397	27104									0.0658		
39398	27105									0.0201		
39399	27106									0.0940		
39400	27107									0.0583		
39401	27108									0.0154		
39402	27109									0.0252		
39403	27110									0.0250		
39404	Check 27110									0.0253		
39405	27111									0.0113		
39406	27112									0.0110		
39407	27113									0.0078		
39408	27114									0.0066		
39409	27115									0.0064		
39410	27116									0.0046		
39411	27117 <i>Other</i>									0.0027		
39412	27118									0.0179		
39413	27119 <i>GL14</i>									0.0017		
39414	Check 27119									0.0011		
39415	27120									0.0016		
39416	27121									0.0073		

PROCEDURE CODES: ALINI

Certified By: 

AL912-0130-10/28/2002 07:12 PM



1070 LITHIUM DRIVE, UNIT 2 THUNDER BAY, ONTARIO P7B 6G3  
PHONE (807) 626-1630 FAX (807) 623 6820 EMAIL accuracy@tbaytel.net WEB www accurassay.com

## Certificate of Analysis

2. 281 10

Monday, October 28, 2002

Kings Bay Gold Corporation  
152 Gull Lake Rd.  
Winnipeg, MB, CA  
R3T5T3  
Ph#: (204) 661-8852  
Fax#: (204) 224-0306  
Email kingsbaygold@yahoo.com

Date Received : 25-Oct-02  
Date Completed : 28-Oct-02  
Job # 200240992  
Reference :  
Sample #: 149 Pulp's

Accurassay #	Client Id	Au g/t	Pt g/t	Pd g/t	Rh g/t	Ag ppm	Co %	Cu %	Fe %	Ni %	Pb %	Zn %
39417	27122									0.0160		
39418	27123									0.0289		
39419	27124									0.0225		
39420	27125									0.0140		
39421	27126									0.0121		
39422	27127									0.0099		
39423	27128									0.0079		
39424	Check 27128									0.0087		
39425	27129									0.0503		
39426	27130									0.0248		
39427	27131									0.0086		
39428	27132									0.0106		
39429	27133									0.0124		
39430	27134									0.0085		
39431	27135									0.0120		
39432	27136									0.0345		
39433	27137									0.0152		
39434	Check 27137									0.0153		
39435	27138									0.0295		
39436	27139									0.0219		
39437	27140									0.0176		
39438	27141									0.0121		
39439	27142									0.0079		

GL14

PROCEDURE CODES: AL4NI

Certified By: 



1070 LITHIUM DRIVE, UNIT 2 THUNDER BAY, ONTARIO P7B 6G3  
 PHONE (807) 626-1630 FAX (807) 623 6820 EMAIL accuracy@tbaytel.net WEB www accurassay.com

## Certificate of Analysis

Monday, October 28, 2002

Kings Bay Gold Corporation  
 152 Gull Lake Rd.  
 Winnipeg, MB, CA  
 R3T5T3  
 Ph#: (204) 661-8852  
 Fax#: (204) 224-0306  
 Email kingsbaygold@yahoo.com

Date Received : 25-Oct-02  
 Date Completed : 28-Oct-02  
 Job # 200240992  
 Reference :  
 Sample #: 149 Pulp's

Accurassay #	Client Id	Au g/t	Pt g/t	Pd g/t	Rh g/t	Ag ppm	Co %	Cu %	Fe %	Ni %	Pb %	Zn %
39440	27143									0.0044		
39441	27144									0.0062		
39442	27145									0.0065		
39443	27146									0.0099		
39444	Check 27146									0.0094		
39445	27147									0.0109		
39446	27148									0.0120		
39447	27149									0.0124		
39448	27252									0.0059		
39449	27253									0.0138		
39450	27254									0.0094		
39451	27255									0.0077		
39452	27256									0.0154		
39453	27257									0.0137		
39454	Check 27257									0.0140		
39455	27258									0.0571		
39456	27259									0.0174		
39457	27260									0.0118		
39458	27261									0.0095		
39459	27262									0.0118		
39460	27263									0.0230		
39461	27264									0.0143		
39462	27265									0.0050		

GL14  
 ↓  
 other.

PROCEDURE CODES: ALANI

Certified By: 

AL912-0130-10/28/2002 07:12 PM

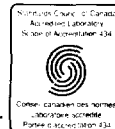

1070 LITHIUM DRIVE, UNIT 2 THUNDER BAY, ONTARIO P7B 6G3  
PHONE (807) 626-1630 FAX (807) 623 6820 EMAIL accuracy@tbaytel.net WEB www accurassay.com

## Certificate of Analysis

Monday, October 28, 2002

Kings Bay Gold Corporation  
152 Gull Lake Rd.  
Winnipeg, MB, CA  
R3T5T3  
Ph#: (204) 661-8852  
Fax#: (204) 224-0306  
Email kingsbaygold@yahoo.com

Date Received : 25-Oct-02  
Date Completed : 28-Oct-02  
Job # 200240992  
Reference :  
Sample #: 149 Pulp's

Accurassay #	Client Id	Au g/t	Pt g/t	Pd g/t	Rh g/t	Ag ppm	Co %	Cu %	Fe %	Ni %	Pb %	Zn %
39463	27266									0.0029		
39464	Check 27266									0.0034		
39465	27267									0.0067		
39466	27268									0.0013		
39467	27269									0.0398		
39468	27270									0.0093		
39469	27271									0.0099		
39470	27272									0.0073		
39471	27273									0.0065		
39472	27274									0.0160		
39473	27275									0.0150		
39474	Check 27275									0.0198		
39475	27276									0.0115		
39476	27277									0.0126		
39477	27278									0.0105		
39478	27279									0.0721		
39479	27280									0.0137		
39480	27281									0.0098		
39481	27282									0.0165		
39482	27283									0.0106		
39483	27284									0.0274		
39484	Check 27284									0.0264		
39485	27285									0.0330		

Other.  
↓  
GLO8

PROCEDURE CODES: ALANI

Certified By: 

AL912-0130-10/28/2002 07:12 PM



1070 LITHIUM DRIVE, UNIT 2 THUNDER BAY, ONTARIO P7B 6G3  
PHONE (807) 626-1630 FAX (807) 623 6820 EMAIL [accuracy@tbaytel.net](mailto:accuracy@tbaytel.net) WEB [www accurassay.com](http://www accurassay.com)

## Certificate of Analysis

Monday, October 28, 2002

Kings Bay Gold Corporation  
152 Gull Lake Rd.  
Winnipeg, MB, CA  
R3T5T3  
Ph#: (204) 661-8852  
Fax#: (204) 224-0306  
Email [kingsbaygold@yahoo.com](mailto:kingsbaygold@yahoo.com)

Date Received : 25-Oct-02  
Date Completed : 28-Oct-02  
Job # 200240992  
Reference :  
Sample #: 149 Pulp's

Accurassay #	Client Id	Au g/t	Pt g/t	Pd g/t	Rh g/t	Ag ppm	Co %	Cu %	Fe %	Ni %	Pb %	Zn %
39486	27286									0.0231		
39487	27287									0.0107		
39488	27288									0.0146		
39489	27289									0.0356		
39490	27290									0.0191		
39491	27291									0.0191		
39492	27292									0.0097		
39493	27293									0.0334		
39494	Check 27293									0.0335		
39495	27294									0.0169		
39496	27295									0.0203		
39497	27296									0.0132		
39498	27297									0.0142		
39499	27298									0.0062		
39500	27299									0.0054		
39501	27300									0.0055		
39502	27301									0.0096		
39503	27302									0.0136		
39504	Check 27302									0.0153		
39505	27303									0.0067		
39506	27304									0.0018		
39507	27305									0.0019		
39508	27306									0.0045		

PROCEDURE CODES: AL4NH

Certified By: 

AL912-0130-10/28/2002 07:12 PM



1070 LITHIUM DRIVE, UNIT 2 THUNDER BAY, ONTARIO P7B 6G3  
PHONE (807) 626-1630 FAX (807) 623 6820 EMAIL accuracy@tbaytel.net WEB www accurassay.com

## Certificate of Analysis

Monday, October 28, 2002

2002-10-28

Kings Bay Gold Corporation  
152 Gull Lake Rd.  
Winnipeg, MB, CA  
R3T5T3  
Ph#: (204) 661-8852  
Fax#: (204) 224-0306  
Email kingsbaygold@yahoo.com

Date Received : 25-Oct-02  
Date Completed : 28-Oct-02  
Job # 200240992  
Reference :

Sample #: 149 Pulp's

Accurassay #	Client Id	Au g/t	Pt g/t	Pd g/t	Rh g/t	Ag ppm	Co %	Cu %	Fe %	Ni %	Pb %	Zn %
39509	27307									0.0071		
39510	27308									0.0112		
39511	27309									0.0230		
39512	27310									0.0232		
39513	27311									0.0212		
39514	Check 27311									0.0227		
39515	27312									0.0132		
39516	27313									0.0109		
39517	27314									0.0119		
39518	27315									0.0179		
39519	27316									0.0098		
39520	27317									0.0090		
39521	27318									0.0127		
39522	27319									0.0085		
39523	27320									0.0213		
39524	Check 27320									0.0205		
39525	27321									0.0137		
39526	27322									0.0168		
39527	27323									0.0044		
39528	27324									0.0065		
39529	27325									0.0093		
39530	27326									0.0196		
39531	27327									0.0062		

PROCEDURE CODES: ALANI

Certified By: 

AL912-0130-10/28/2002 07:12 PM



1070 LITHIUM DRIVE, UNIT 2 THUNDER BAY, ONTARIO P7B 6G3  
PHONE (807) 626-1630 FAX (807) 623 6820 EMAIL accuracy@tbaytel.net WEB www accurassay.com

## Certificate of Analysis

Monday, October 28, 2002

Kings Bay Gold Corporation  
152 Gull Lake Rd.  
Winnipeg, MB, CA  
R3T5T3  
Ph#: (204) 661-8852  
Fax#: (204) 224-0306  
Email kingsbaygold@yahoo.com

Date Received : 25-Oct-02  
Date Completed : 28-Oct-02  
Job # 200240992  
Reference :  
Sample #: 149 Pulp's

Accurassay #	Client Id	Au g/t	Pt g/t	Pd g/t	Rh g/t	Ag ppm	Co %	Cu %	Fe %	Ni %	Pb %	Zn %
39532	27328									0.0108		
39533	27329									0.0194		
39534	Check 27329									0.0190		
39535	27330									0.0210		
39536	27331									0.0119		
39537	27332									0.0132		
39538	27333									0.0100		
39539	27334									0.0197		
39540	27335									0.0158		
39541	27336									0.0077		
39542	27337									0.0130		
39543	27338									0.0085		
39544	Check 27338									0.0111		
39545	27339									0.0107		
39546	27340									0.0053		
39547	27341									0.0269		
39548	27342									0.0062		
39549	27343									0.0188		
39550	27344									0.0048		
39551	27345									0.0091		
39552	27346									0.0032		
39553	27347									0.0188		
39554	Check 27347									0.0159		

GL10  
↑  
↓  
GL10

PROCEDURE CODES: AL4NI

Certified By: 

AL912-0130-10/28/2002 07:12 PM



1070 LITHIUM DRIVE, UNIT 2 THUNDER BAY, ONTARIO P7B 6G3  
PHONE (807) 626-1630 FAX (807) 623 6820 EMAIL accuracy@tbaytel.net WEB www accurassay.com

## Certificate of Analysis

Monday, October 28, 2002

Kings Bay Gold Corporation  
152 Gull Lake Rd.  
Winnipeg, MB, CA  
R3T5T3  
Ph#: (204) 661-8852  
Fax#: (204) 224-0306  
Email kingsbaygold@yahoo.com

Date Received : 25-Oct-02  
Date Completed : 28-Oct-02  
Job # 200240992  
Reference :

Sample #: 149 Pulp's

Accurassay #	Client Id	Au g/t	Pt g/t	Pd g/t	Rh g/t	Ag ppm	Co %	Cu %	Fe %	Ni %	Pb %	Zn %
39555	27348									0.0125		
39556	27349									0.0053		
39557	27350									0.0083		
39558	Unknown									0.0214		

PROCEDURE CODES: ALAM

Certified By: 

A259Z-0130-10/28/2002 07:12 AM

Kings Bay Gold Corporation  
 Date Created: 03-07-30 10:56 AM  
 Job Number: 200340106  
 Date Recieved: 2/26/2003  
 Number of Samples: 17  
 Type of Sample: Core  
 Date Completed: 2/28/2003  
 Project ID:

Accurassay #	Client Tag	Au PPB	Pt PPB	Pd PPB	Rh PPB	Ag PPM	Co PPM	Cu PPM	Fe PPM	Ni PPM	Pb PPM	Zn PPM
5558	27401	15										
5559	27402	12										
5560	27403	15										
5561	27404	58										
5562	27405	10										
5563	27406	1037				1		168				65
5564	27407	4414						698			42	
5565	27409	123						3948				
5566	27410	74						6853				
5567	27411	407						4368				
5568	27411	309						4483				
5569	27412	350						2706				
5570	27413	24						498				
5571	27414	109						2339				
5572	27415	193						2165				
5573	27416	53						727				
5574	27417	100						1918				
5575	27418	119						3456				

GL-02,03,05,06

2. 201.10

Kings Bay Gold Corporation  
Date Created: 03-07-30 10:56 AM  
Job Number: 200340107  
Date Recieved: 2/26/2003  
Number of Samples: 1  
Type of Sample: Core  
Date Completed: 2/28/2003  
Project ID:

Accurassay #	Client Tag	P1 g/t	P2 g/t	M1 g/t	Total g/t Met in Pulp Met Weight		
5576	27408	0.013	0.01	<0.005	0.011	4.57%	43.98

GL-05



1070 LITHIUM DRIVE, UNIT 2 THUNDER BAY, ONTARIO P7B 6G3  
PHONE (807) 626-1630 FAX (807) 623 6820 EMAIL [accuracy@tbaytel.net](mailto:accuracy@tbaytel.net) WEB [www accurassay.com](http://www accurassay.com)

## Certificate of Analysis

2. 3. 4. 5.

Thursday, April 17, 2003

Kings Bay Gold Corporation  
152 Gull Lake Rd.  
Winnipeg, MB, CA  
R3T5T3  
Ph#: (204) 661-8852  
Fax#: (204) 224-0306  
Email: [kingsbaygold@yahoo.com](mailto:kingsbaygold@yahoo.com)

Date Received : 14-Apr-03  
Date Completed : 16-Apr-03  
Job # 200340280

Reference :  
Sample #: 59 Core

Accurassay	Client Id	Au ppb	Pt ppb	Pd ppb	Rh ppb	Ag ppm	Co ppm	Cu ppm	Fe ppm	Ni ppm	Pb ppm	Zn ppm
21629	27051	12										
21630	27052	<5										
21631	27053	<5										
21632	27054	<5										
21633	27055	101						1288		116		
21634	27056	7641						20866		173		
21635	27057	67						361		73		
21636	27058	13						354		70		
21637	27059	157						2713		96		
21638	27060	<5						118		154		
21639 Check	27060	6						147		186		
21640	27061	<5						10		217		
21641	27062	42						552		87		
21642	27063	<5										
21643	27064	<5										
21644	27065	<5						75		34		
21645	27066	11						78		62		
21646	27067	8						192		77		
21647	27068	10										
21648	27069	7						265		72		
21649 Check	27069	5						290		76		
21650	27070	32										
21651	27071	39										

PROCEDURE CODES: AL4Au3, AL4Ag, AL4Cu, AL4Ni, AL4ICPAF

Page 1 of 3

Certified By:

AL917-0130-04/17/2003 08:59 AM

GL-15, 13, 14, 16, 11, 12, 01, 10.



1070 LITHIUM DRIVE, UNIT 2 THUNDER BAY, ONTARIO P7B 6G3  
 PHONE (807) 626-1630 FAX (807) 623 6820 EMAIL accuracy@tbaytel.net WEB www accurassay.com

## Certificate of Analysis

Thursday, April 17, 2003

Kings Bay Gold Corporation  
 152 Gull Lake Rd.  
 Winnipeg, MB, CA  
 R3T5T3  
 Ph#: (204) 661-8852  
 Fax#: (204) 224-0306  
 Email: kingsbaygold@yahoo.com

Date Received : 14-Apr-03  
 Date Completed : 16-Apr-03  
 Job # 200340280

Reference :

Sample #: 59 Core

Accurassay	Client Id	Au ppb	Pt ppb	Pd ppb	Rh ppb	Ag ppm	Co ppm	Cu ppm	Fe ppm	Ni ppm	Pb ppm	Zn ppm
21652	27072	11										
21653	27073	11										
21654	27074	22										
21655	27075	30										
21656	27076	11										
21657	27077	<5										
21658	27078	10										
21659	Check 27078	19										
21660	27079	965										
21661	27080	14										
21662	27081	24										
21663	27082	<5										
21664	27083	102										
21665	27084	<5										
21666	27085	<5										
21667	27086	160						4867		39		
21668	27087	78						1542		16		
21669	Check 27087	119						1552		16		
21670	27088	<5										
21671	27089	37										
21672	27090	<5										
21673	27091	<5										
21674	27092	17										

PROCEDURE CODES: AL4Au3, AL4Ag, AL4Cu, AL4NI, AL4CPAF

Certified By: 

AL917-0130-04/17/2003 08:59 AM

 1070 LITHIUM DRIVE, UNIT 2 THUNDER BAY, ONTARIO P7B 6G3  
 PHONE (807) 626-1630 FAX (807) 623 6820 EMAIL accuracy@tbyte!.net WEB www accurassay.com

## Certificate of Analysis

Thursday, April 17, 2003

 Kings Bay Gold Corporation  
 152 Gull Lake Rd.  
 Winnipeg, MB, CA  
 R3T5T3  
 Ph#: (204) 661-8852  
 Fax#: (204) 224-0306  
 Email: kingsbaygold@yahoo.com

 Date Received : 14-Apr-03  
 Date Completed : 16-Apr-03  
 Job # 200340280  
 Reference :  
 Sample #: 59          Core

Accurassay	Client Id	Au ppb	Pt ppb	Pd ppb	Rh ppb	Ag ppm	Co ppm	Cu ppm	Fe ppm	Ni ppm	Pb ppm	Zn ppm
21675	27093	50										
21676	27094	<5										
21677	27095	22										
21678	27096	<5										
21679 Check	27096	<5										
21680	27097	<5										
21681	27098	3050										
21682	27099	2106										
21683	27100	18										
21684	27452	<5				1		369		56		
21685	27453	72				3		1642		105		
21686	27454	12				1		372		117		
21687	27455	415				5		7060		104		
21688	27456	<5				1		37		110		
21689 Check	27456	<5				1		27		112		
21690	27457	283										
21691	27458	7										
21692	27459	15										
21726	27451	<5										

PROCEDURE CODES: AL4Au3, AL4Ag, AL4Cu, AL4Ni, AL4ICPAF

Page 3 of 3

Certified By:

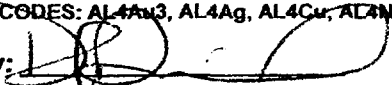

AL917-0130-04/17/2003 08:59 AM



1070 LITHIUM DRIVE, UNIT 2 THUNDER BAY, ONTARIO P7B 6G3  
PHONE (807) 626-1630 FAX (807) 623 6820 EMAIL [accuracy@tbaytel.net](mailto:accuracy@tbaytel.net) WEB [www accurassay.com](http://www accurassay.com)

Kings Bay Gold Corporation  
Date Created: 03-04-25 10:21 AM  
Job Number: 200340280  
Date Recieved: 4/14/2003  
Number of Samples: 59  
Type of Sample: Core  
Date Completed: 4/16/2003  
Project ID:

2. 1. 1. 10

Page: 1

Accur. #	Client Tag	Ag ppm	Al ppm	As ppm	B ppm	Ba ppm	Be ppm	Ca ppm	Cd ppm	Co ppm	Cr ppm	Cu ppm	Fe ppm	K ppm	Mg ppm	Mn ppm
21691	27458	<1	12387	<3	46	165	<1	24911	<10	34	94	186	48286	8788	>8,000	653
21692	27459	<1	8773	<3	51	87	<1	17107	<10	19	159	73	26745	4268	>8,000	345

Certified By:



1070 LITHIUM DRIVE, UNIT 2 THUNDER BAY, ONTARIO P7B 6G3  
PHONE (807) 626-1630 FAX (807) 623 6820 EMAIL accuracy@tbaytel.net WEB www accurassay.com

Kings Bay Gold Corporation  
Date Created: 03-04-25 10:21 AM  
Job Number: 200340280  
Date Recieved: 4/14/2003  
Number of Samples: 59  
Type of Sample: Core  
Date Completed: 4/16/2003  
Project ID:

2 . 0 . 0 . 0 . 0

Page: 2

Accur. #	Client Tag	Mo ppm	Na ppm	Ni ppm	P ppm	Pb ppm	Sb ppm	Se ppm	Si ppm	Sr ppm	Ti ppm	Tl ppm	V ppm	Y ppm	Zn ppm
21691	27458	<1	2195	63	413	8	<10	<1	602	15	3036	<1	35	22	67
21692	27459	<1	1488	55	687	5	<10	<1	583	20	1782	<1	21	11	34

Certified By:



Date: 2003-NOV-17

GEOSCIENCE ASSESSMENT OFFICE  
933 RAMSEY LAKE ROAD, 6th FLOOR  
SUDBURY, ONTARIO  
P3E 6B5

KING'S BAY GOLD CORPORATION  
152 GULL LAKE ROAD  
WINNIPEG, MANITOBA  
R3T 5T3 CANADA

Tel: (888) 415-9845  
Fax: (877) 670-1555

**Submission Number:** 2.26170  
**Transaction Number(s):** W0320.01336

Dear Sir or Madam

**Subject: Approval of Assessment Work**

We have approved your Assessment Work Submission with the above noted Transaction Number(s). The attached Work Report Summary indicates the results of the approval.

At the discretion of the Ministry, the assessment work performed on the mining lands noted in this work report may be subject to inspection and/or investigation at any time.

The 45 days outlined in the Notice dated September 29, 2003 have passed. Assessment work credit has been approved as outlined on the attached Work Report Summary. The assessment credit is being reduced by \$54,804.

The TOTAL VALUE of assessment credit that will be allowed, based on the information provided in this submission, is \$97,517.

If you have any question regarding this correspondence, please contact BRUCE GATES by email at [bruce.gates@ndm.gov.on.ca](mailto:bruce.gates@ndm.gov.on.ca) or by phone at (705) 670-5856.

Yours Sincerely,



Ron C. Gashinski  
Senior Manager, Mining Lands Section

**Cc:** Resident Geologist

David Michael Rigg  
(Agent)

King'S Bay Gold Corporation  
(Assessment Office)

Assessment File Library

King'S Bay Gold Corporation  
(Claim Holder)

Date / Time of Issue: Mon Nov 17 13:37:30 EST 2003

TOWNSHIP / AREA  
BELANGER

PLAN  
G-3742

ADMINISTRATIVE DISTRICTS / DIVISIONS

Mining Division Red Lake  
Land Titles/Registry Division KENORA  
Ministry of Natural Resources District RED LAKE

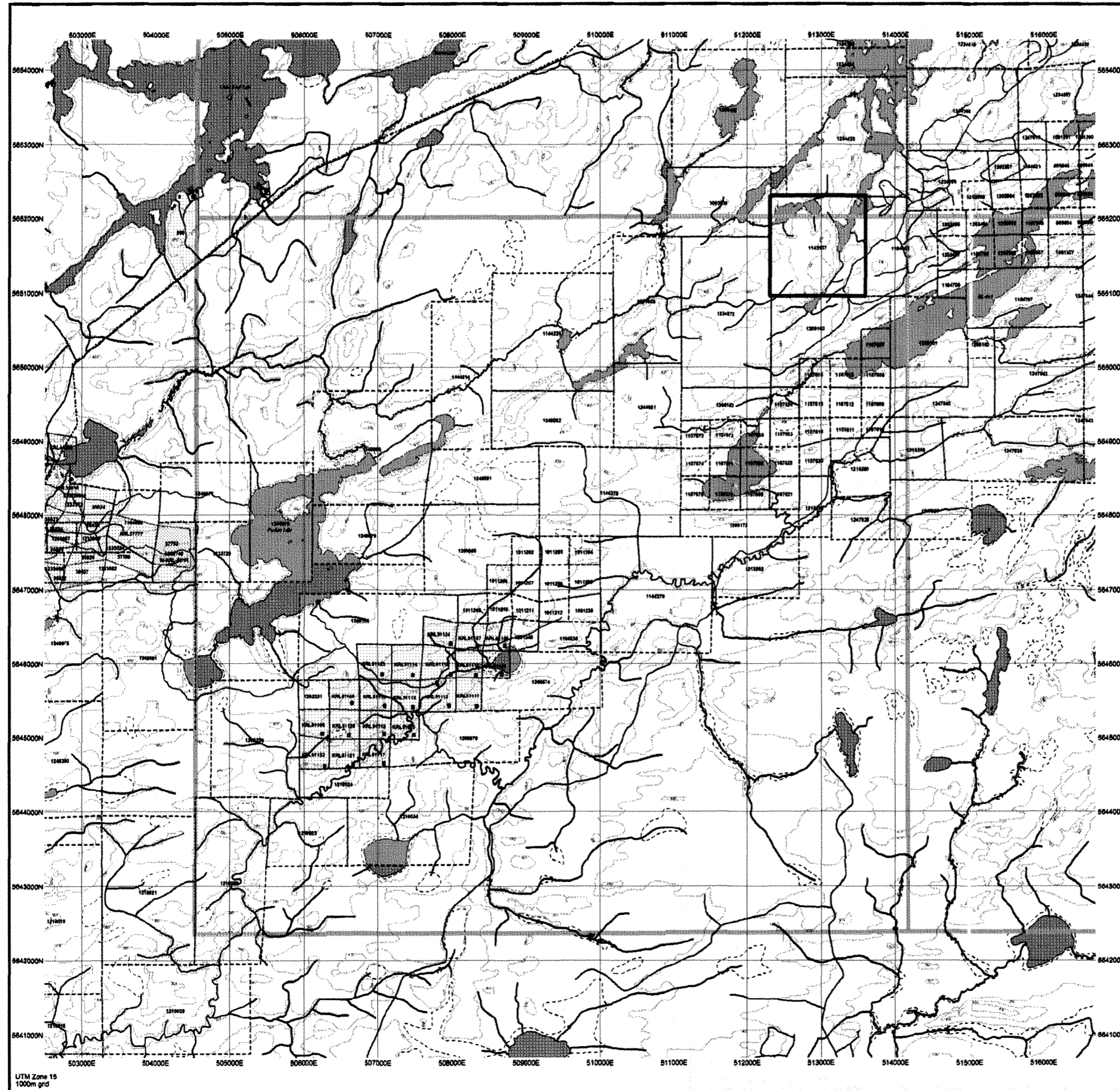

TOPOGRAPHIC

- Administrative Boundary
- Township
- Demarcation Lin
- Provincial Park
- Milieu Reserve
- Can. Pk. & Trce
- Outflow
- Mine Shaft
- Work Headframe
- Railway
- Stream
- Tier
- Natural Gas Pipeline
- Utilities
- Tower

Land Tenure

- Proposed Patent
- Surface And Mining Right
- Surface Rights Only
- Mining Rights Only
- Location Patent
- Surface And Mining Right
- Surface Rights Only
- Mining Rights Only
- License of Occupation
- Used Not Specified
- Surface And Mining Right
- Surface Rights Only
- Mining Rights Only
- Lease Use Permit
- Order In Council (Not Open For Bidding)
- Water Power Lease Agreement
- Mining Claim
- Filed Claim Mining Claims

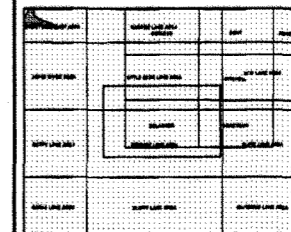

LAND TENURE WITHDRAWALS

- Area Withdrawn from Disposition
- Mining Area Withdrawal Types
- Surface And Mining Right Withdrawal
- Surface Rights Only Withdrawal
- Mining Rights Only Withdrawal
- Order In Council Withdrawal Types
- Surface And Mining Right Withdrawal
- Surface Rights Only Withdrawal
- Mining Rights Only Withdrawal

LAND TENURE WITHDRAWAL DESCRIPTIONS

MINISTRY	TYPE	DATE	DESCRIPTION
MR	W	July 1, 2001	15372 B.R.O. 18474 V.3
MR	W	Oct 4, 2001	Sec. 38 W.R.L.-0101 M-5 2001/004 18180

2.26170  
PDRILL  
ASSAY

